

F 19200E

F 19300 E

coords 19650 - 20100 N
19150 - 19250 E

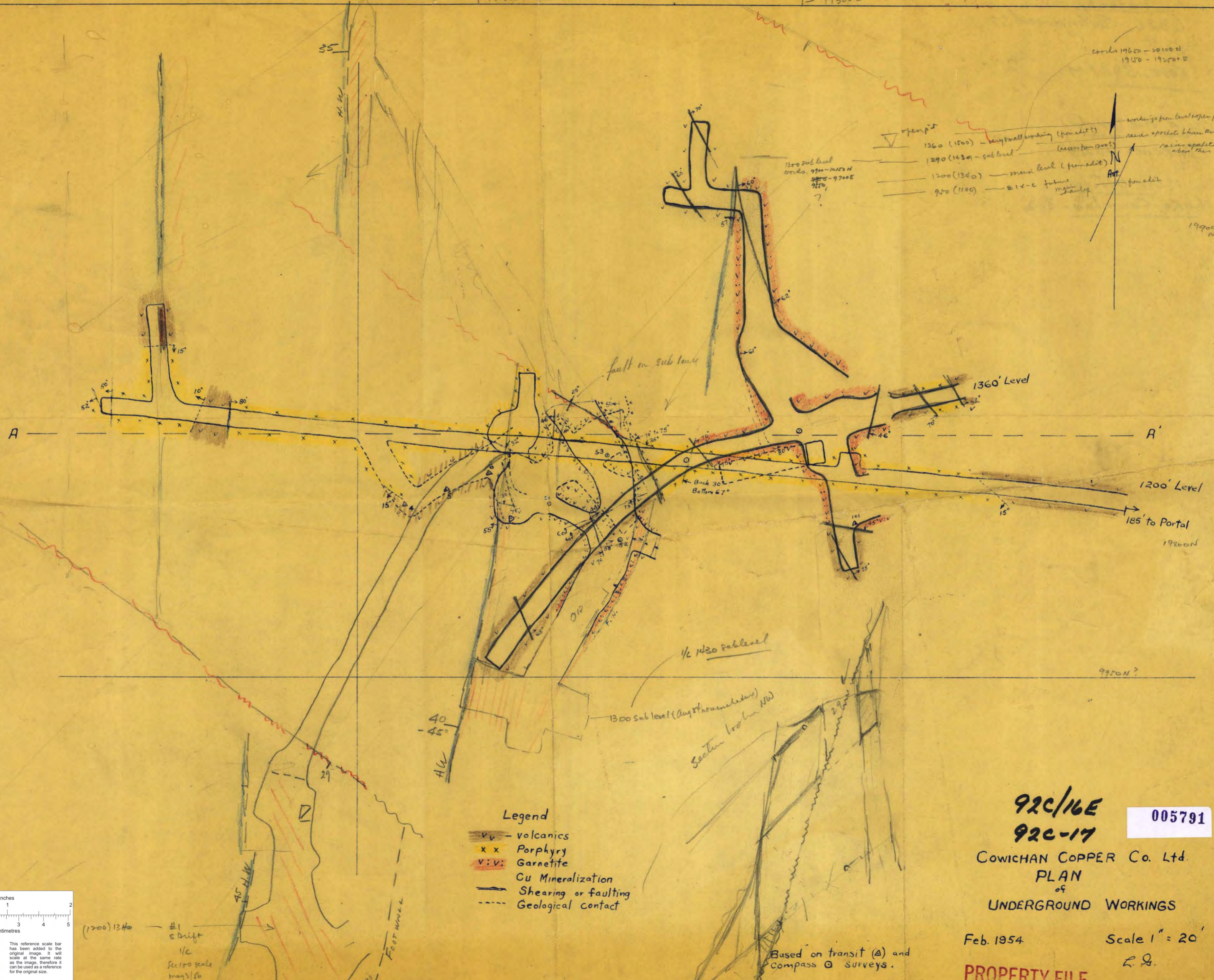

works from level open pit from
 raise + pocket below main level
 raise + pocket above main
 from adit

open pit
 1260 (1500) - very small working (from adit?)
 (access from 1200?)
 1290 (1430) - sub level
 1200 (1340) - main level (from adit)
 970 (1100) - #1 v-c future main shaft

19900 N

19200 N

9950 N?

Legend

- v v - volcanics
- x x - Porphyry
- v : v : - Garnetite
- shaded - Cu Mineralization
- - Shearing or faulting
- - - - Geological contact

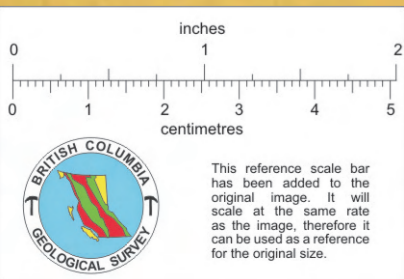

(1200) 1340 - #1
 Drift
 1/2
 See 100 scale
 May 3/56

92C/16E
 92C-17

005791

Cowichan Copper Co. Ltd.
 PLAN
 of
 UNDERGROUND WORKINGS

Feb. 1954

Scale 1" = 20'

PROPERTY FILE

Based on transit (Δ) and
Compass (⊙) surveys.