

SCALE: 1" = 1000'
(by comparison with other maps)
-20

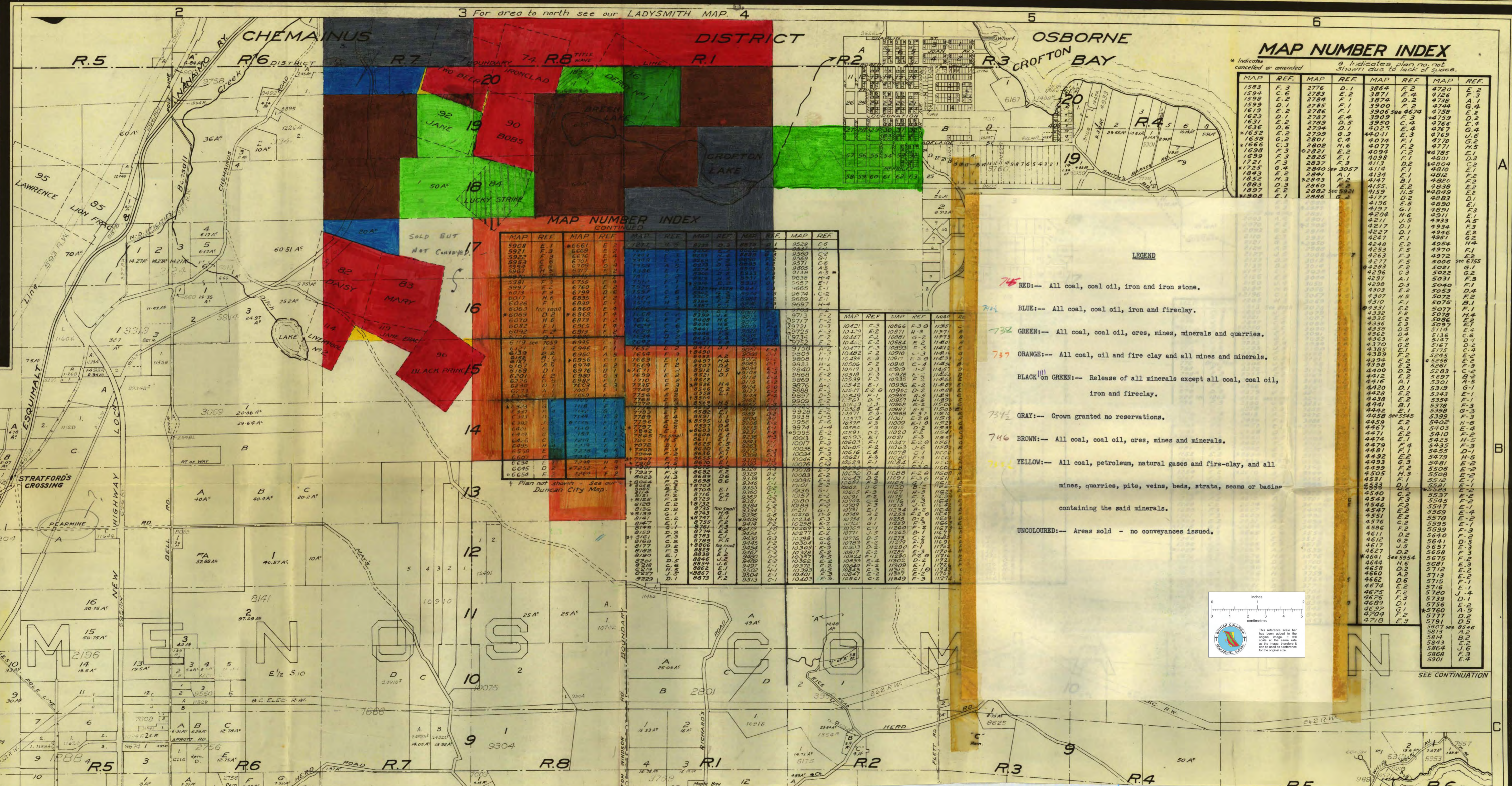
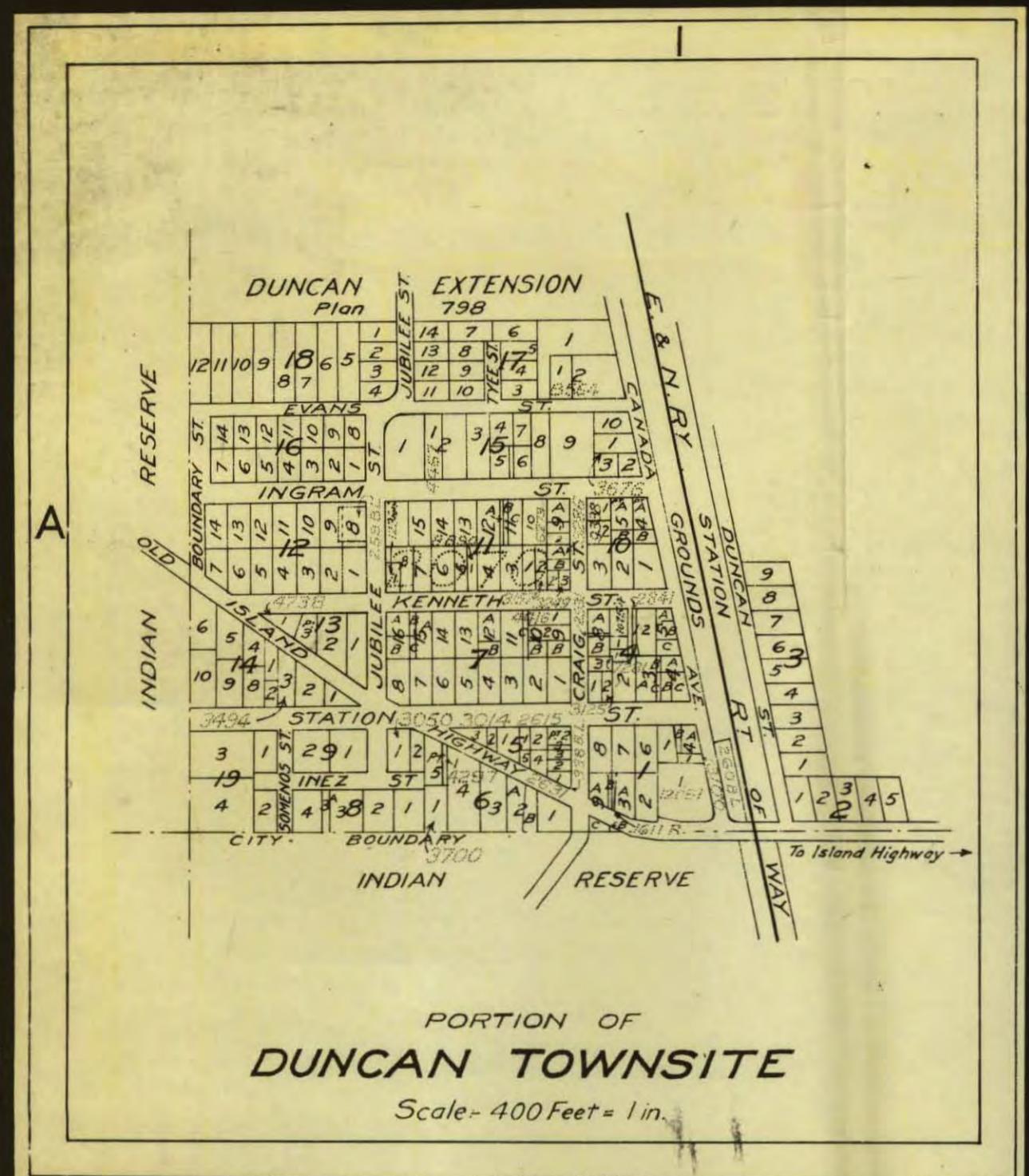

MAP NUMBER INDEX

* Indicates cancelled or amended. † Indicates plan not shown due to lack of space.

MAP	REF.	MAP	REF.	MAP	REF.	MAP	REF.
1583	F.3	2776	D.1	3864	E.2	4720	E.2
1594	C.6	2783	E.2	3871	E.4	4726	E.2
1598	E.2	2784	F.1	3874	D.2	4738	A.1
1599	D.1	2785	F.1	3900	F.1	4744	G.4
1619	E.2	2786	F.1	3906	F.1	4750	E.2
1623	D.1	2787	E.4	3909	F.3	4759	D.2
1632	E.2	2789	D.5	3950	C.4	4766	E.4
1636	D.6	2790	E.2	3956	F.1	4767	G.4
*1632	E.2	2799	G.3	4401	E.3	4769	U.6
1658	G.2	2801	C.4	4074	F.1	4770	G.5
1666	C.3	2802	H.6	4077	E.2	4771	H.5
1698	F.3	2821	E.2	4094	F.1	*4785	E.1
1699	F.3	2825	E.1	4098	F.1	4801	D.3
1721	F.3	2837	F.3	4114	F.1	4810	C.2
*1725	G.4	2840	SP.3057	4115	F.1	*4809	E.1
1843	E.2	2841	A.1	4134	E.1	4812	F.2
1852	H.3	2844	A.1	4147	B.1	4820	F.2
1883	D.3	2860	A.2	4158	E.2	4830	F.2
1897	E.2	2882	see 9321	4159	H.5	*4849	E.1
1908	E.1	2886	G.2	4177	D.2	4883	D.1
				4196	E.5	4890	F.3
				4197	G.1	4891	F.3
				4204	H.6	4911	E.1
				4210	D.1	4934	A.5
				4217	J.5	4934	F.3
				4227	D.1	4946	E.2
				4247	F.1	4951	G.2
				4253	F.5	4958	H.4
				4263	F.3	4970	F.4
				4272	F.3	4972	E.2
				4277	F.3	5006	see 6755
				4293	F.2	5022	G.2
				4296	C.1	5031	F.3
				4321	D.3	5040	F.1
				4303	E.2	5053	D.4
				4307	H.5	5072	F.2
				4310	F.1	5075	A.1
				4319	D.3	5077	E.2
				4331	E.2	5078	H.4
				4332	E.2	5086	E.2
				4336	D.5	5097	E.2
				4358	D.5	5114	E.2
				4362	E.2	5125	D.2
				4363	G.2	5127	D.2
				4370	E.2	5167	D.2
				4371	E.2	5175	D.2
				4389	F.2	5245	E.2
				4398	E.2	5256	F.3
				4400	D.2	5283	A.2
				4411	E.2	5297	A.2
				4416	A.1	5301	A.5
				4420	D.1	5319	G.1
				4428	E.2	5343	E.1
				4438	E.2	5359	E.2
				4441	B.1	5378	F.3
				4442	E.1	5398	G.3
				4458	see 5345	5399	F.3
				4459	E.2	5402	H.6
				4467	A.1	5403	F.2
				4471	E.2	5410	H.5
				4474	F.1	5425	H.5
				4479	F.4	5435	F.3
				4481	F.1	5455	D.2
				4492	E.2	5478	H.5
				4493	G.3	5481	E.2
				4499	F.2	5506	E.2
				4505	H.3	5508	F.3
				4531	F.1	5512	E.1
				4533	C.2	5521	E.2
				4540	C.2	5537	E.2
				4543	F.2	5545	F.2
				4546	E.2	5547	F.2
				4547	E.2	5569	E.4
				4551	F.2	5578	E.2
				4576	E.2	5595	F.3
				4586	F.2	5599	F.2
				4611	D.2	5640	F.2
				4612	E.2	5641	D.5
				4617	J.5	5657	E.1
				4627	D.2	5658	F.3
				4641	see 5354	5675	F.2
				4644	F.2	5681	E.3
				4658	D.2	5712	E.2
				4660	A.2	5713	E.2
				4662	A.2	5715	F.1
				4674	E.2	5716	F.1
				4675	F.2	5720	J.4
				4676	F.3	5739	D.1
				4689	D.1	5756	E.2
				4697	G.1	5760	A.5
				4704	F.2	5777	D.5
				4718	E.3	5791	D.5
						5807	see 8546
						5813	A.2
						5814	B.2
						5843	E.2
						5864	J.6
						5868	F.3
						5901	E.4

LEGEND

- RED:-- All coal, coal oil, iron and iron stone.
- BLUE:-- All coal, coal oil, iron and fireclay.
- GREEN:-- All coal, coal oil, ores, mines, minerals and quarries.
- ORANGE:-- All coal, oil and fire clay and all mines and minerals.
- BLACK OR GREEN:-- Release of all minerals except all coal, coal oil, iron and fireclay.
- GRAY:-- Crown granted no reservations.
- BROWN:-- All coal, coal oil, ores, mines and minerals.
- YELLOW:-- All coal, petroleum, natural gases and fire-clay, and all mines, quarries, pits, veins, beds, strata, seams or basins containing the said minerals.
- UNCOLOURED:-- Areas sold - no conveyances issued.

