

EN. 115

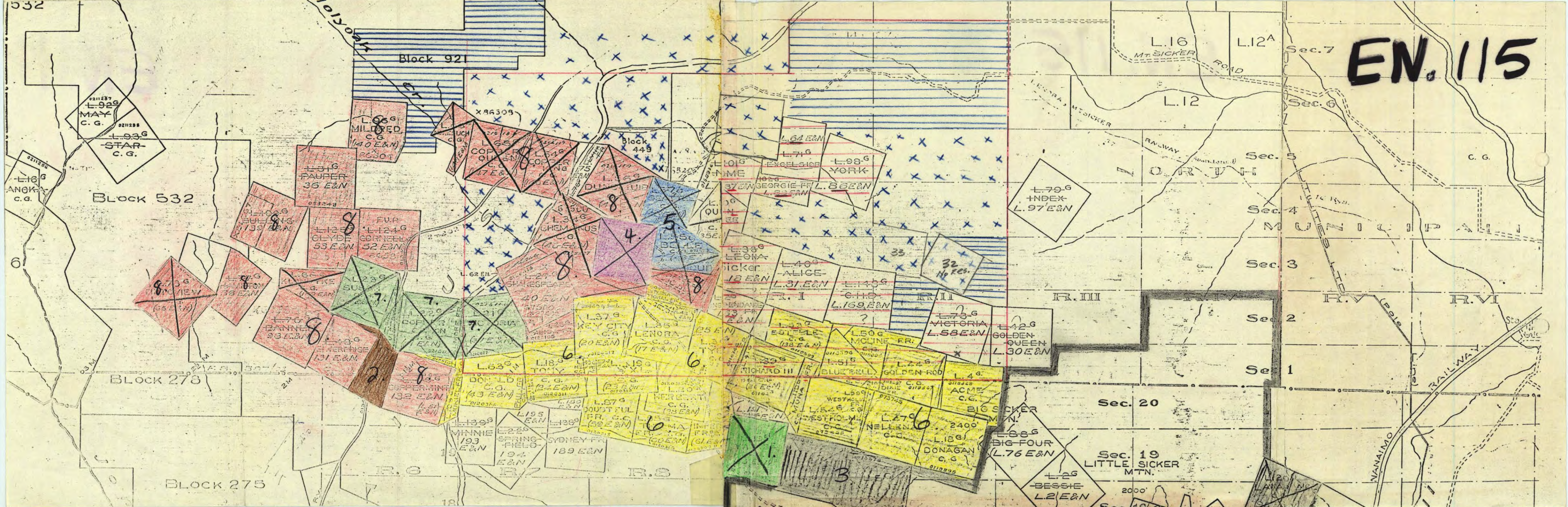

- ⊗ Reverted GOLD SILVER IN NAME OF CROWN
- 8. E&N LOTS - Reverted BASE METALS IN CROWN
- 7. BASE METALS HELD BY R.T. DUMOULIN - 850 West Hastings
- 6. GOLD SILVER BASE METALS HELD BY M.M. SICKER
- 5. BASE METALS HELD BY THOMAS & MARY CRAWFORD
- 4. BASE " " " N.H. CAUFIELD
- 3. BASE " " " DISTRICT OF COWICHAN?
- 2. " " " McMILLAN & BEDEL
- 1. " " " M.M. MELROSE.
- COAL, IRON, (AND NAT GAS), PIPECLAY AND ALL MINES & CONVEYS - C.P.O.G.
- BASE METALS HELD BY BAN - BLOCK NOT CONVEYED (Sept. 1963)
- COAL & IRON - C.P.O.G.

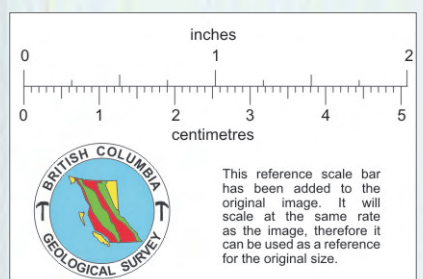

This reference scale bar has been added to the original image. It will scale at the same rate as the image, therefore it can be used as a reference for the original size.

also 850 West Hastings

005538