



To: Mineral Resources
Victoria

004955

Date: November 25, 1982

82 M 93

Re: Rouge Claims 82M12E
Approx. 119°31'30" - 51°41'45"

Please see enclosed copies of a location map and an assay sheet from the Rouge Claims:

The reason that this is submitted is that the claim holders maintain that there are a number of old workings on the property including a blacksmith shop and even iron rails. There is limited reference to the property under "MAD River" and "F. Allingham" from 1887 to 1901. We wondered if this should be included on the mineral inventory maps? However, perhaps we should wait until spring until we are able to confirm these reports by visual inspection. Tom Lewis of Noranda reports that there is an old cabin on the site.

White

Gordon P. E. White, P.Eng.
District Geologist

GPEW/lc
cc: Vic Preto

LOG NO:	150 T1
ACTION:	G MCA → T.K.
	For necessary action TK TK.
FILE NO:	Property Off.

/MINFILE

82M093 -01
PROPERTY FILE

N.T.S. 82 M 12 W

DATE JUNE 1/1979

PROPERTY ROUGE CLAIMS - PROPERTY EXAM

SAMPLE REPORT

MPLE NO.	LOCATION & DESCRIPTION	TYPE	WIDTH	ASSAYS				SAMPLED BY
				Pb	Ag	Au	Cu	
357J	CHIP SAMPLE ACROSS GALENA AND PYRITE MINERALIZED QUARTZ, LOCALLY AS HIGH AS 3% SULFIDES - AVE ~ 5.5% TAKEN ACROSS ALTERED COUNTRY ROCK	CHIP	~2m	3.8	3.34	Tr.	.03	BBH-TL. ↓
358J		"	~2.5m	.28	.27	Tr	Tr	
359J		"	~2m	.02	Tr	.003	Tr	
360J		"	~1.3m	.86	1.25	.003	Tr	
361J		"	~2m	.2	.16	Tr	Tr	

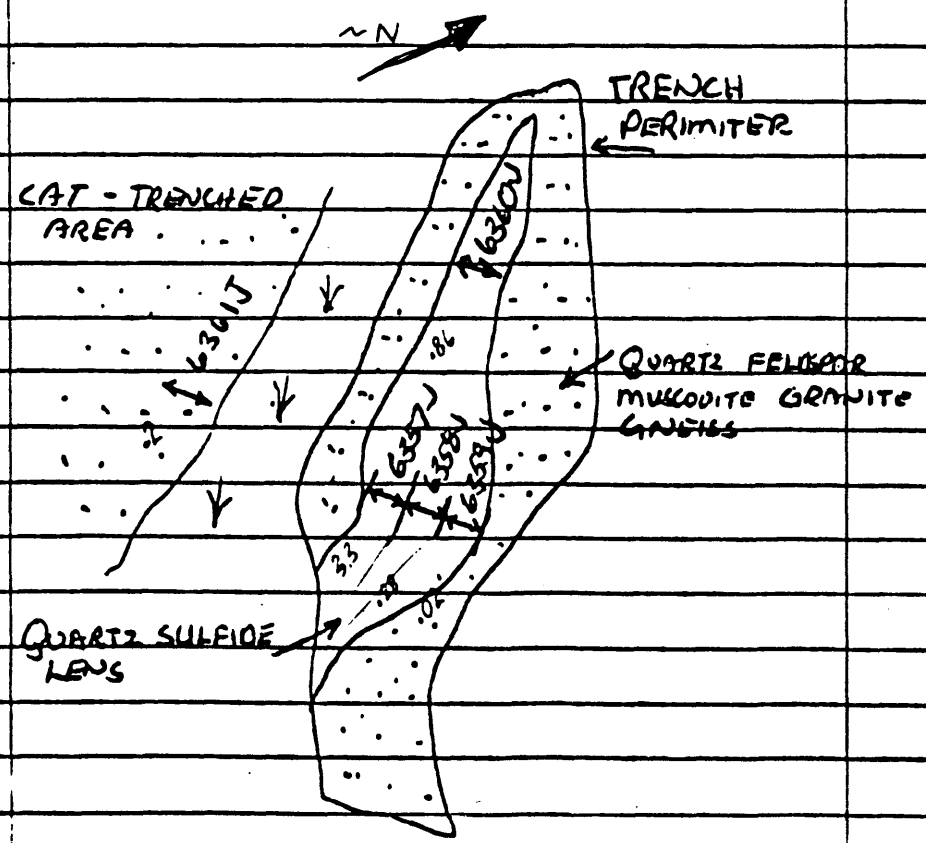

C

D

119°30'

51°45'

3E

6

5

4

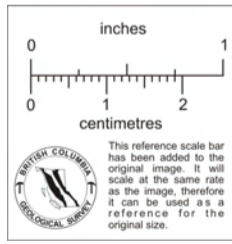
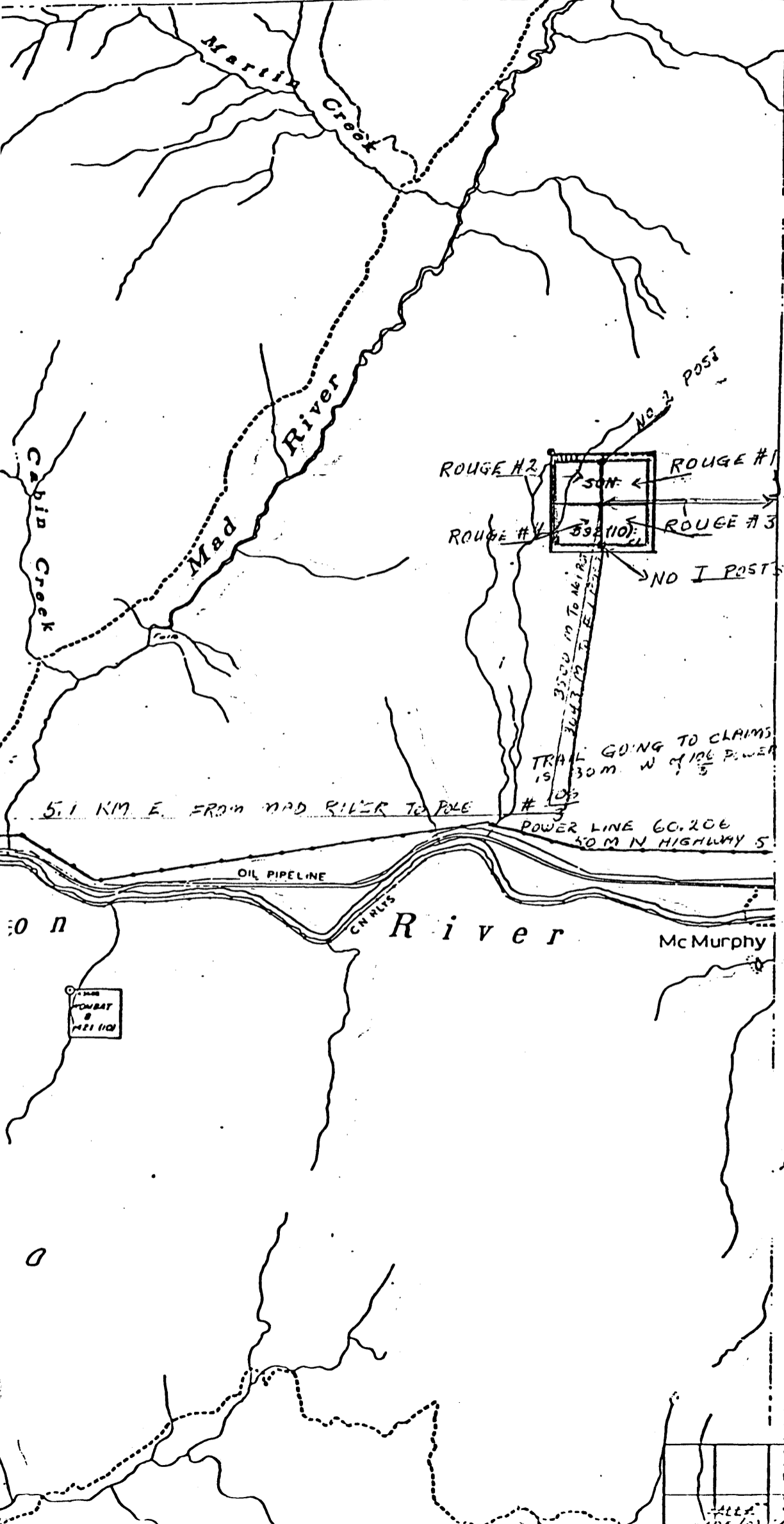

SURVEYED, THE MAP POSITION OF A
ON THE LOCATOR'S SKETCH, FOR FUR.
THE OFFICE OF THE MINING DIVISION