

004558

PROPERTY NAME: Yokohama NO. OF CLAIMS: 40 MINING DIVISION: KamloopsCLAIM NAMES: KEY EXPIRY DATE: About June 15/73LOCATION AND ACCESS: 38 miles via Hwy 97 to Westwood then 3-2 1/2 miles on Douglas Lk rd, then turn W past cattle guard to limestone quarry.OWNER: K. Colombo ADDRESS: Cacho Creek,DEAL ASKED: openPREVIOUS WORK: 1970- geol. geophys. & mag. by Vestalite (Dawson) for Dresser - negative results, has been drilled prior to this (4 holes at least)ORE POTENTIAL Low tonnage high grade possibilities

DESCRIPTION: Min. occurs in 1 mi. x 1 mi. 'window' of Cacho Creek side, exposed by erosion of Kamloops (Tertiary) volcanics. Small intrusion of Upper Mesozoic diorite also exposed along N side of window. Late pegmatite phases also intrude sediments. Sulphides are associated with two parallel bands of crystalline limestone trending N-S and dipping 40-60° W. and separated by 500' of barren siltstone or argillite. Min. occurs along foot wall of ls. horizon in contact zone of skarn minerals underlain by siltstone mineralized with pyrite over 10-15' thickness. Pyritic beds weather to give rusty zone which assists in tracing favourable horizon on surface. Min. is coarse, rosettes of MoS_2 alone or with Chalcopyrite. Fracture & discontinuous. Cpy. as seams or disseminated blebs in granular skarn zone. Ls beds appear to roll, steepening from 50° W for 40° to 60°

RECOMMENDATIONS:

No work is recommended on this property. Average grade is much too low to support med. tonnage operation with slope widths of say 10-15' and high grade zones are to evolve for systematic mining

REFERENCES: AS Rept. (K.M. 507) 2360 (Dawson) MMR 1264 pp 108 & 105, MMR 1955 p 79 sample sketch. Assay reports attached, plusEXAMINED BY: Jay MurphyDATE: 12/6/72

Yakahama

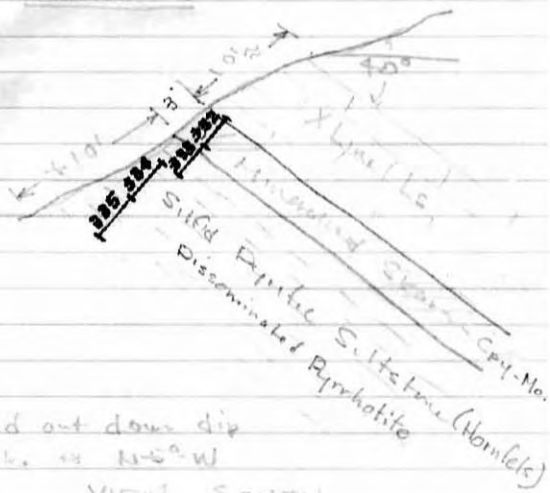

Staged out down dip
Strike is N-S-W

VIEW SOUTH

PROPERTY FILE

OFFICE

COPY

N^o

332

K

TO

Long hole

ASSAY FOR:

Au

Ag

Cu

Pb

Zn

Ni

Co

Mo

Mos₂

OR

DATE

21/6/72

PROJECT

G. Helena

SAMPLER

DESCRIPTION

25-6" channel

across garnetiferous

shale, via MoS₂ &

Fe sulphate, possible

Cpy

MAIL TO KAMLOOPS OFFICE

OFFICE

COPY

N^o

333

K

TO

Spring Lake

ASSAY FOR:

Au

Ag

(Cu)

Pb

Zn

Ni

Co

Mo

(Mos₂)

OR

DATE

2/6/52

PROJECT

Yukon

SAMPLER

10

DESCRIPTION

2'-6" pyrite

conglomerate adjacent to

fr. wall of 332

MAIL TO KAMLOOPS OFFICE

OFFICE

COPY

N^o

334

K

TO

LL

ASSAY FOR:

Au

Ag

Cu

Pb

Zn

Ni

Co

Mo

Mos₂

OR

DATE

21/6/72

PROJECT

Yokshane

SAMPLER

JDM

DESCRIPTION

3'-6" channel

across pyritic

hematite

MAIL TO KAMLOOPS OFFICE

OFFICE

COPY

N^o

335 K

TO

LL

ASSAY FOR: Au Ag Cu Pb Zn

Ni Co Mo

Mos₂

OR

DATE

21/6/72

PROJECT

Yukon

SAMPLER

JDM

DESCRIPTION

3'-6" channel

across prospects horizons

& argillites

MAIL TO KAMLOOPS OFFICE

To: CANADIAN SUPERIOR EXPLORATIONS
 #5 - 465 Victoria Street
 KAMLOOPS, B.C.
 ATTENTION: MR. JAY MURPHY

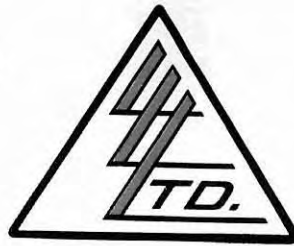

File No. 5423
 Date JUNE 23, 1972
 Samples CHIP

Certificate of
 ASSAY of
 LORING LABORATORIES LTD.

SAMPLE No.	% Cu	% MoS2
332	.03	.030
333	.02	.004
334	.01	.004
335	.01	.006

Yokohama, Keenawan
 PROPERTY FILE

I Hereby Certify THAT THE ABOVE RESULTS ARE THOSE
 ASSAYS MADE BY ME UPON THE HEREIN DESCRIBED SAMPLES

Rejects Retained one month.
 Pulps Retained one month
 unless specific arrangements
 made in advance.

C. L. McFarlane
 Licensed Assayer of British Columbia

OFFICE

COPY

N^o

330

K

TO

Loring

ASSAY FOR:

(Au)

Ag

(Cu)

Pb

Zn

Ni

Co

Mo

(Mos₂)

OR

H₂O, tungsten

DATE

17/6/72

PROJECT

Yokohama

SAMPLER

K. Colombo

DESCRIPTION

limy spongy

mass MOS₂, fluorescent

min. (CaCO₃?), minor

melanite, gypsum

MAIL TO KAMLOOPS OFFICE

To: CANADIAN SUPERIOR EXPLORATIONS
 #5 - 465 Victoria Street
 KAMLOOPS, B.C.
 ATTENTION: MR. JAY MURPHY



File No. 5404
 Date JUNE 15, 1972
 Samples CHIPS

Certificate of
 ASSAY of
 LORING LABORATORIES LTD.

SAMPLE No.	OZ./TON	%	%	%	%
	Gold	Cu	MoS2	WO3	Sn
330 - Yokohama	.010	.08	.498	Trace	.02
331 Fiddler	Trace	.07	---	----	--

I Hereby Certify THAT THE ABOVE RESULTS ARE THOSE
 ASSAYS MADE BY ME UPON THE HEREIN DESCRIBED SAMPLES

Rejects Retained one month.

Pulps Retained one month
 unless specific arrangements
 made in advance.

E. L. McFarlane

Licensed Assayer of British Columbia

To: CANADIAN SUPERIOR EXPLORATIONS
#5 - 465 Victoria Street
KAMLOOPS, B.C.
ATTENTION: MR. JAY MURPHY



File No. 5423
Date JUNE 23, 1972
Samples CHIP

Certificate of
ASSAY of
LORING LABORATORIES LTD.

SAMPLE No.	% Cu	% MoS2
332	.03	.030
333	.02	.004
334	.01	.004
335	.01	.006

*Yokohama
Kennellan*
PROPERTY FILE

I Hereby Certify THAT THE ABOVE RESULTS ARE THOSE
ASSAYS MADE BY ME UPON THE HEREIN DESCRIBED SAMPLES

Rejects Retained one month.

Pulps Retained one month
unless specific arrangements
made in advance.

C. L. McFarlane

Licensed Assayer of British Columbia