

82LSE055-07

004492

HR. 10530
82L/1W
82LSE055

ASSESSMENT REPORT
ON THE
1981 PROGRAM OF DIAMOND DRILLING
LYNX CLAIM (16 UNITS)
RECORD NO. 685(8)
TRAPP CREEK-KETTLE RIVER
KEEFER LAKE AREA
VERNON MINING DIVISION
CHERRYVILLE, BRITISH COLUMBIA
N. Lat. 50°06' W. Long. 118°23'
82-L-1W

for
HI-COR RESOURCES LTD.
Suite 980
789 West Pender Street
Vancouver, British Columbia

PROPERTY FILE

by
DONALD W. TULLY, P. ENG.

November 25, 1981

West Vancouver, B.C.

TABLE OF CONTENTS

	<u>Page</u>
INTRODUCTION.....	1
SUMMARY AND CONCLUSIONS.....	1
PROPERTY - LOCATION, ACCESS, PHYSIOGRAPHY.....	3
CLAIMS.....	3
HISTORY - PREVIOUS DEVELOPMENT.....	4
REFERENCES.....	6
REGIONAL AND LOCAL GEOLOGICAL SETTING.....	7
MINERALIZATION.....	8
RESULTS OF 1981 PROGRAM OF DIAMOND DRILLING.....	8
RECOMMENDATIONS.....	9
TIME-COST DISTRIBUTION.....	10
CERTIFICATE.....	11

MAPS

Figure 1 - Location Map.....	(Frontispiece)
Figure 2 - Topographic Plan (1 = 250,000).....	(Follows page 1)
Figure 3 - Topographic Plan (1 = 50,000).....	(Follows page 2)
Figure 4 - Claim Plan (modified after M82-L-1W).....	(Follows page 3)
Figure 5 - Regional Geology (After GSC Map 1059A - Vernon).....	(Follows page 4)
Figure 6 - Plan of 1981 Diamond Drill Holes....	(Follows page 5)
Figure 7 - Section Thru DD Holes H-1-81, H-2-81.....	(Follows page 6)
Figure 8 - Section thru DD Holes H-3-81, H-4-81.....	(Follows page 7)
Figure 9 - Section thru DD Hole H-5-81.....	(Follows page 8)
Figure 10 - Section thru DD Hole H-6-81.....	(Follows page 9)
Figure 11 - Section thru DD Hole H-7-81.....	(Follows page 10)
Figure 12 - Section thru DD Hole H-8-81.....	(Follows page 10)

APPENDIX

ASSAY CERTIFICATES #8109 - 3053
#8110 - 1663
#8111 - 0660

FIGURE I.
LOCATION MAP

Scale 1" = 30 miles
 NOVEMBER 25, 1981

EDMONTON

JASPER

VALEMOUNT

BLUE RIVER

WILLIAMS LAKE

CLEARWATER

**HI-COR
 RESOURCES LTD.
 LYNX CLAIM**

REVELSTOKE

ASHCROFT

KAMLOOPS

SALMON
 ARM

HIGHLAND
 VALLEY

AFTON

CRAIGMONT
 MINE

SPENCES
 BRIDGE

VERNON

LUMBY

LYTTON

MERRITT

FAUQUIER

97

KELOWNA

BRENDA
 MINE

PEACHLAND

VANCOUVER

HOPE

PRINCETON

PENTICTON

KEREMEOS

OLIVER

ROCK
 CREEK

GRAND
 FORKS

050Y005

GREENWOOD

BRITISH COLUMBIA
 WASHINGTON U.S.A.

Donald W. Tully

KILOMETRES
 0 10 20 30 40 50 100

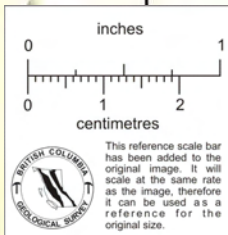

INTRODUCTION

This assessment report was prepared at the request of HI-COR RESOURCES LTD., Vancouver, British Columbia.

The 1981 program of diamond drilling was examined on the property on August 22, September 13, 25, October 13-14, and November 3-4, 1981.

The purpose of this report is to summarize the results of the 1981 program of diamond drilling done during the period September 9 through October 24, 1981.

A program of further mineral exploration is recommended.

SUMMARY AND CONCLUSIONS

The property comprises sixteen units covering 400 hectares. It is located some 45 road miles east of Lumby, British Columbia, near Trapp Creek on the Keefer Lake road, in the Vernon Mining Division. Road access to within one mile of the ground is excellent. A 4 WD vehicle is required to reach the drillsite location on the claim area.

The property was formerly the Kismet, Mountain View, Iron Ball, Snowdrop and Dewdrop claim group. Around 1933, a 75-foot adit was driven into the brow area of a south-facing slope. Substantial values in gold were reported across narrow widths. The workings have caved-in.

The ground was again staked in 1965-66 as observed from old claim tags and posts.

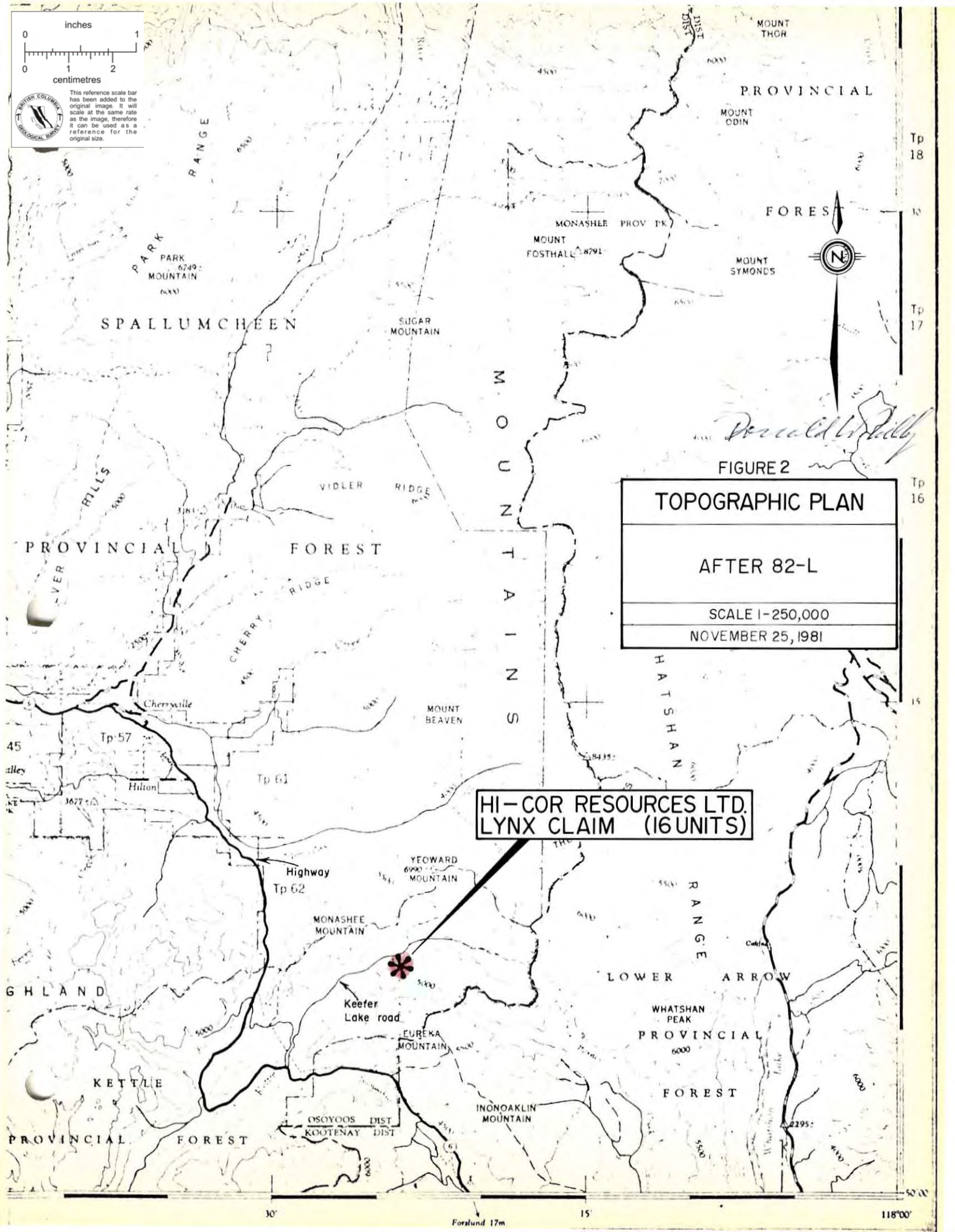
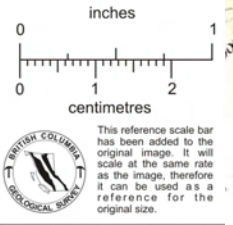

FIGURE 2

TOPOGRAPHIC PLAN

AFTER 82-L

SCALE 1-250,000

NOVEMBER 25, 1981

HI-COR RESOURCES LTD.
LYNX CLAIM (16 UNITS)

Tp 18
 10
 Tp 17
 Tp 16
 15
 50'N
 118°00'

30' Forlund 17m 15'

In the period September 9 through October 24, 1981, a program of eight BQ core size diamond drill holes were drilled on the LYNX claim in the area of the former Kismet workings. The diamond drilling was done by Tri-mac Diamond Drilling Limited, Suite 707, 543 Granville Street, Vancouver, British Columbia. The program totalled 1068.6 metres (3505 feet) of drilling.

The results showed a continuation of the vein in the old adit to the north-northeast for a length of about 80 metres (260 feet). This vein was intersected in D.D. Hole H-4-81 and assayed 0.832 ounces of gold over a core length of 1.07m (3.50 feet). The true width of this vein structure is probably about 3 feet at the location of the drill hole intersection.

During the progress of the work a new quartz vein carrying gold, pyrite and fine molybdenite was found near the collar of D.D. Hole H-7-81. This vein assayed 0.170 ounces of gold and 1.61 ounces of silver per s/t in a selected surface grab sample. An intersection of this vein in D.D. Hole H-7-81 showed an assay of 0.110 ounces of gold per s/t over a core length of 0.60m (2 feet). The true width is probably slightly less than the core intersection.

The vein structures were intersected carrying low values in the upper portion of D.D. Hole H-2-81.

It is concluded this zone of gold-bearing veins warrants further diamond drill testing and also a program of underground drifting on the known gold vein structure which appears to have the potential for economic lengths and widths of gold mineralization in a favourable geological environment.

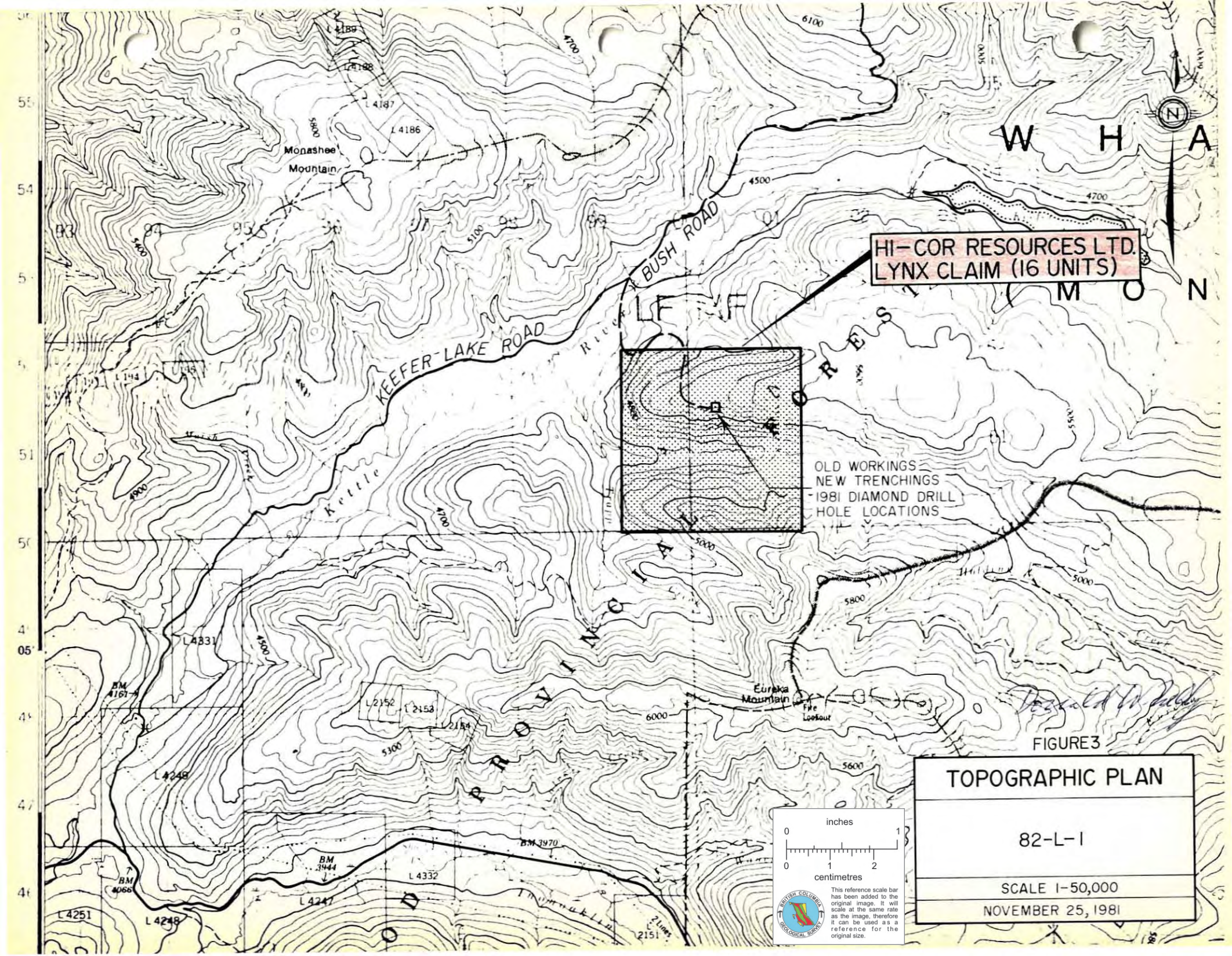

HI-COR RESOURCES LTD.
LYNX CLAIM (16 UNITS)

OLD WORKINGS
NEW TRENCHINGS
1981 DIAMOND DRILL
HOLE LOCATIONS

FIGURE 3

TOPOGRAPHIC PLAN

82-L-1

SCALE 1-50,000

NOVEMBER 25, 1981

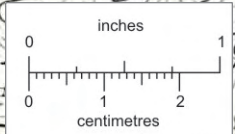

This reference scale bar has been added to the original image. It will scale at the same rate as the image, therefore it can be used as a reference for the original size.

Diamond drill testing as well as underground lateral development is recommended to further test this property.

PROPERTY - LOCATION, ACCESS, PHYSIOGRAPHY

The LYNX Mineral Claim consists of sixteen units situated about one mile south of the Keefer Lake Road. The road distance along Highway 6 from the town of Lumby to the Keefer Lake road turn-off is thirty-eight miles, thence some seven miles (12 Km) to a bridge crossing the Kettle River (Figures 1, 2, 3). A bush road leads southward from this point towards the property.

Most of the ground covered by the LYNX claim is lightly forested with poplar, spruce, fir and some cedar.

The northern sector of the property is a plateau around elevation 5200-5600 feet above sea-level. A steep south-facing slope occupies the central part of the claim. A tributary of Trapp creek flows westward through the central and southern portion of the claimed ground around elevation 4700 and controls the drainage pattern of the local area.

CLAIMS

The LYNX mineral claim comprises sixteen units located in the Vernon Mining Division about one and one-half miles (3 km) southwest of Keefer Lake. Information on file with the British Columbia Ministry of Energy, Mines and Petroleum Resources at Vernon, B.C., is as follows:

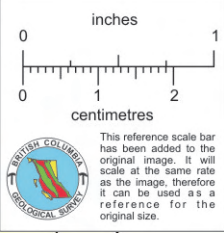

TO WEST SEE MAP B2L/2E

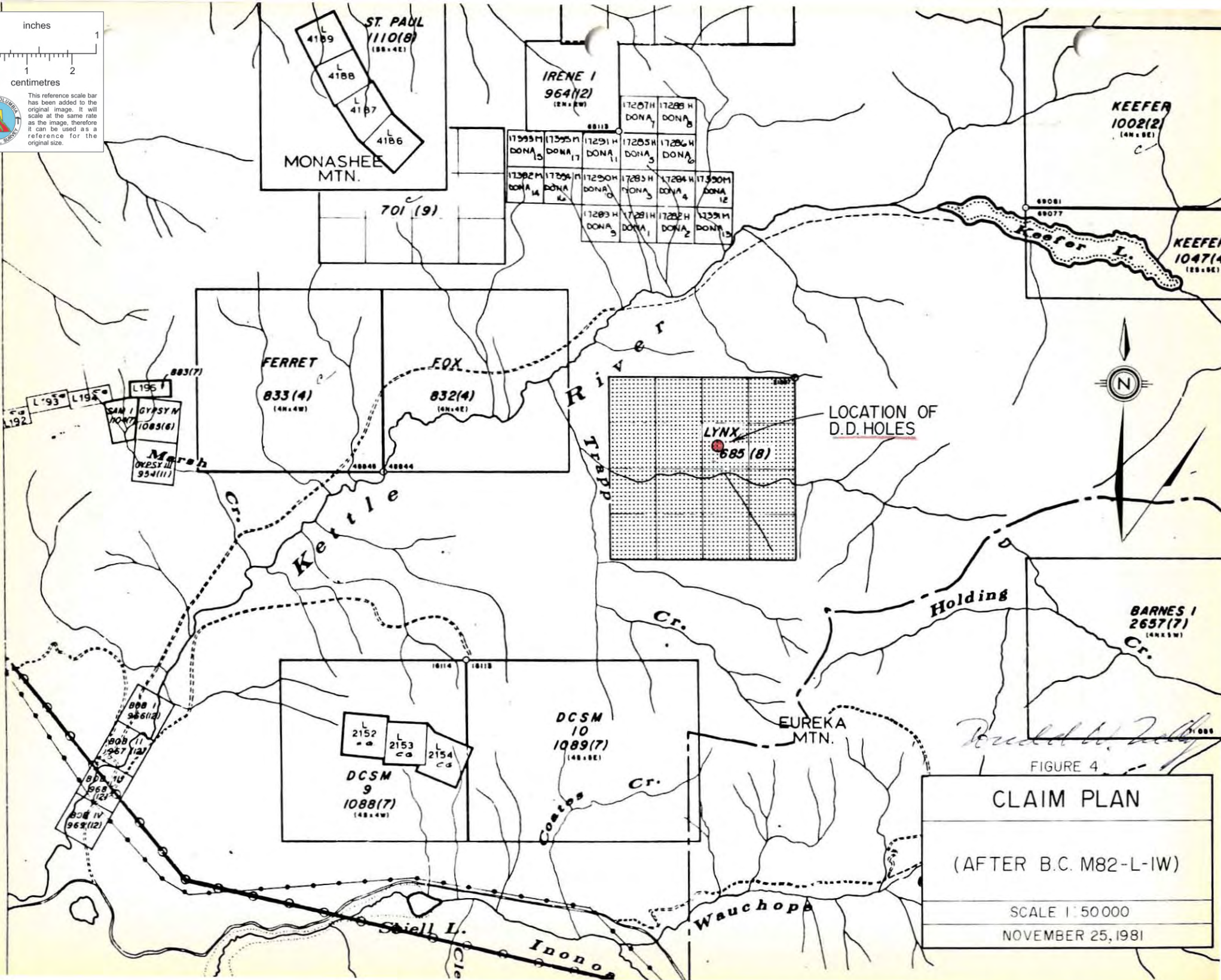

David B. Kelly

FIGURE 4

CLAIM PLAN
(AFTER B.C. M82-L-IW)
SCALE 1:50 000
NOVEMBER 25, 1981

<u>Claim Name</u>	<u>Record Number</u>	<u>Expiry Date</u>	<u>Recorded Holder</u>
LYNX (16 units)	685(8)	August 27, 1986	Hi-Cor Resources Ltd.

The claim is shown on British Columbia Ministry of Mines and Petroleum Resources Mineral Claim Map 82-L-1W (Figure 4).

The total claim area is 400 hectares.

HISTORY - PREVIOUS DEVELOPMENT

The history of the former Kismet, Mountain View, Iron Ball, Snowdrop and Dewdrop claims is somewhat obscure. The reference in the Report of the Minister of Mines, 1933 on page 156, gives some detail on the old workings as follows:

" Kismet

This group, including the Kismet, Mountain View, Iron Ball, Snowdrop, Dewdrop, and three other claims, and owned by A.O. Holmes, M.J. Doran, O.L. Willoughby, and associates, of Lumby, is situated on the north side of Trap creek, which flows into the Kettle river from the east, about 5 miles up-stream from the road crossing. The claims can be reached by trail 6 miles long. On the Kismet, in addition to numerous open-cuts, a 75-foot tunnel has been driven on a quartz vein in granite. The vein is from 6 inches to 3 feet in width and strikes in a northerly direction, while dipping steeply to the east. At the mouth of this drift the 3-foot vein is much oxidized and free gold can be panned. In the face of the drift the vein, 22 inches wide, contains mostly pyrite, arsenopyrite, and lesser amounts of galena. A chip-sample across

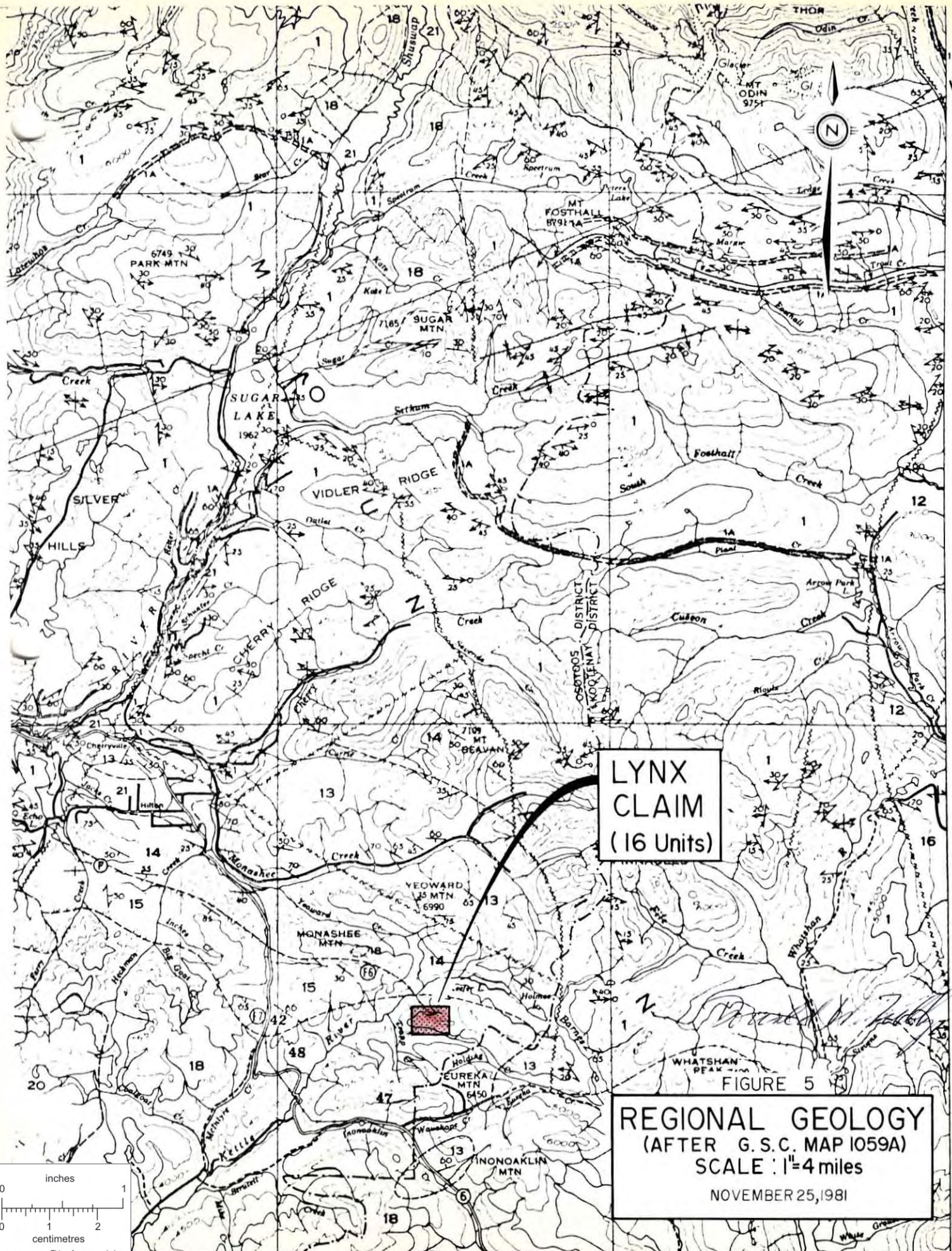

**LYNX CLAIM
(16 Units)**

REGIONAL GEOLOGY
(AFTER G. S. C. MAP 1059A)
SCALE : 1" = 4 miles
NOVEMBER 25, 1981

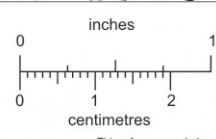

This reference scale bar has been added to the original image. It will scale at the same rate as the image, therefore it can be used as a reference for the original size.



30'

15'

118' 00"

50' 00"

" the face assayed: Gold, 1.04 oz per ton; silver, 0.06 oz per ton. The quartz appears to be widening on a fault in the face. On the surface, about 50 feet above and north of the tunnel, the vein has evidently split and the cuts show several stringers. On the Iron Ball, downhill and to the south-west, other quartz veins containing pyrite and arsenopyrite striking slightly east of north have been uncovered. It is possible that these may intersect the tunnel vein to the north. About 700 feet west of the Kismet and 200 feet lower, a 30-foot open-cut has uncovered a shear-zone $4\frac{1}{2}$ feet wide containing pyrite, pyrrhotite, and lesser amounts of arsenopyrite in a gangue of quartz and disintegrated granite. On the Dewdrop, west of the Iron Ball, open-cuts have uncovered north-striking quartz fissure-veins containing similar minerals in granite. Some free gold was panned in the oxidized ore.

Several cuts to the east of the Kismet tunnel have uncovered other fissure-veins in the granite, a 3-inch stringer assaying: Gold, 1 oz per ton; silver, 1 oz per ton. On the Mountain View, adjoining the Kismet on the south, downhill, several cuts and a 30-foot tunnel have been driven on an extremely sheared and faulted quartz vein in the altered limestone and argillite beds, remnants of which lie in contact with the granite in an easterly and westerly direction along the foot of the hill sloping towards Trap creek. It appears probable that the section of vein in these workings has been pushed downhill by the granite intrusive and is probably the top part of one of the fissures found above. Picked samples of the ore carry good values in gold and silver. The mineralization seen consisted of pyrite, galena, and jamesonite.

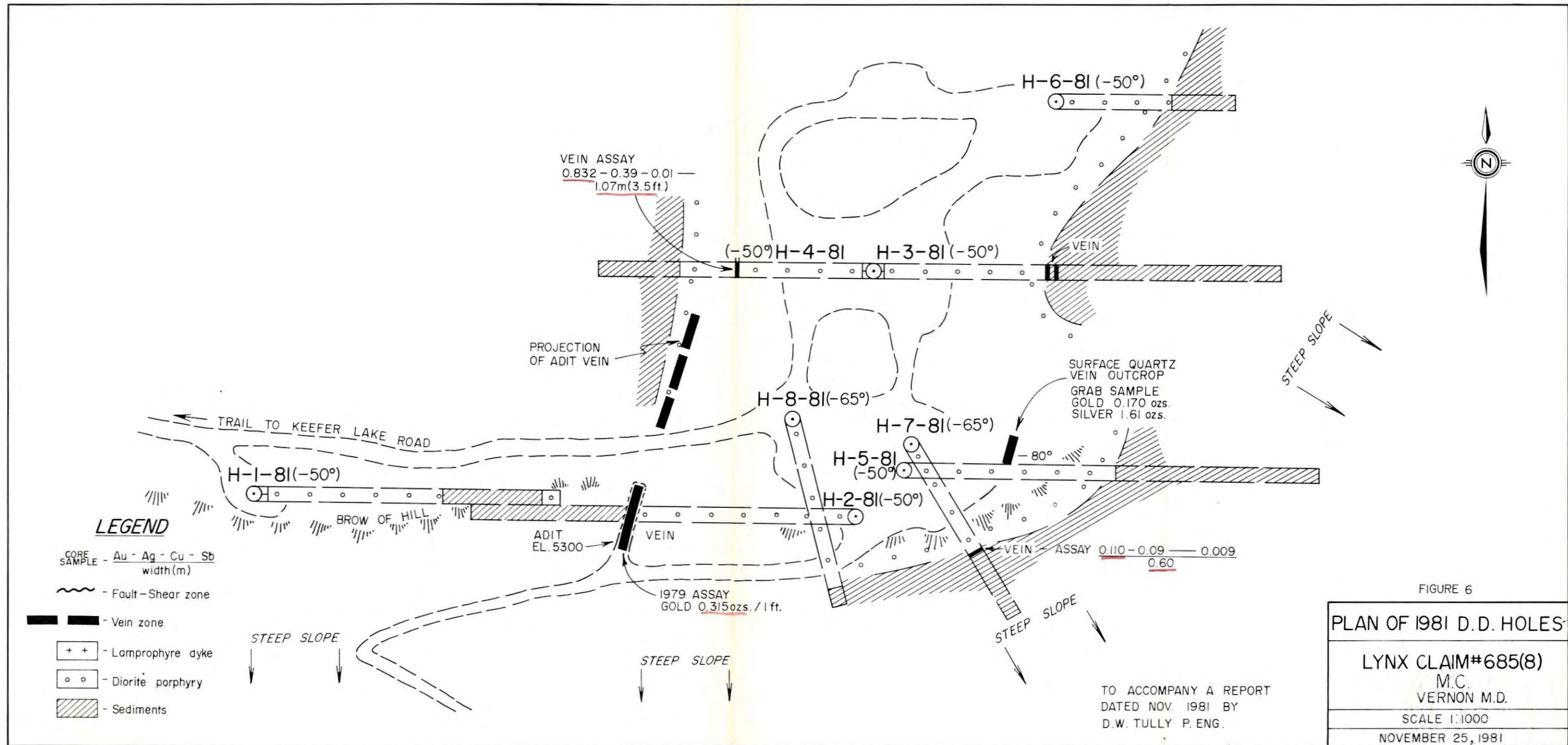

FIGURE 6

PLAN OF 1981 D.D. HOLES

LYNX CLAIM#685(8)
M.C.
VERNON M.D.

SCALE 1:1000
NOVEMBER 25, 1981

Donald W. Tully

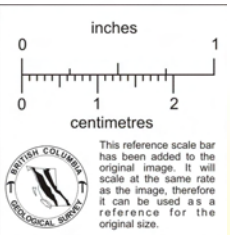

" A dense, highly altered siliceous igneous rock is found in the neighbourhood of the workings. This may possibly be an offshoot from the granite batholith.

The area covered by these claims and underlain chiefly by granitic rocks has undoubtedly been fissured by numerous quartz veins carrying gold and silver, and, although comparatively narrow, they appear to warrant further exploration in the hope of finding wider ore-bodies that will pay to mine. "

Old claim posts near the Kismet adit had claim tags dated in 1965 and 1966.

Hi-Cor Resources Ltd. did a substantial program of bulldozer trenching in August-September, 1980.

In the period September 9 through October, 1981, Hi-Cor Resources Ltd. drilled eight BQ core size diamond drill holes totalling 1,608.6 metres (3,505 feet) of drilling.

REFERENCES

Publications containing information pertinent to the LYNX claim area are:

Annual Report of the Minister of Mines, British Columbia for the year 1933 - p. 156

Geological Survey of Canada Memoir 296

Geological Survey of Canada Map 1059A

Geological Survey of Canada Open File 637

Report on the LYNX Claim (16 units) for Hi-Cor Resources Ltd., dated October 4, 1979 by Donald W. Tully, P.Eng.

Report on the LYNX Claim (16 units) for Hi-Cor Resources Ltd., dated April 3, 1981 by Donald W. Tully, P.Eng.

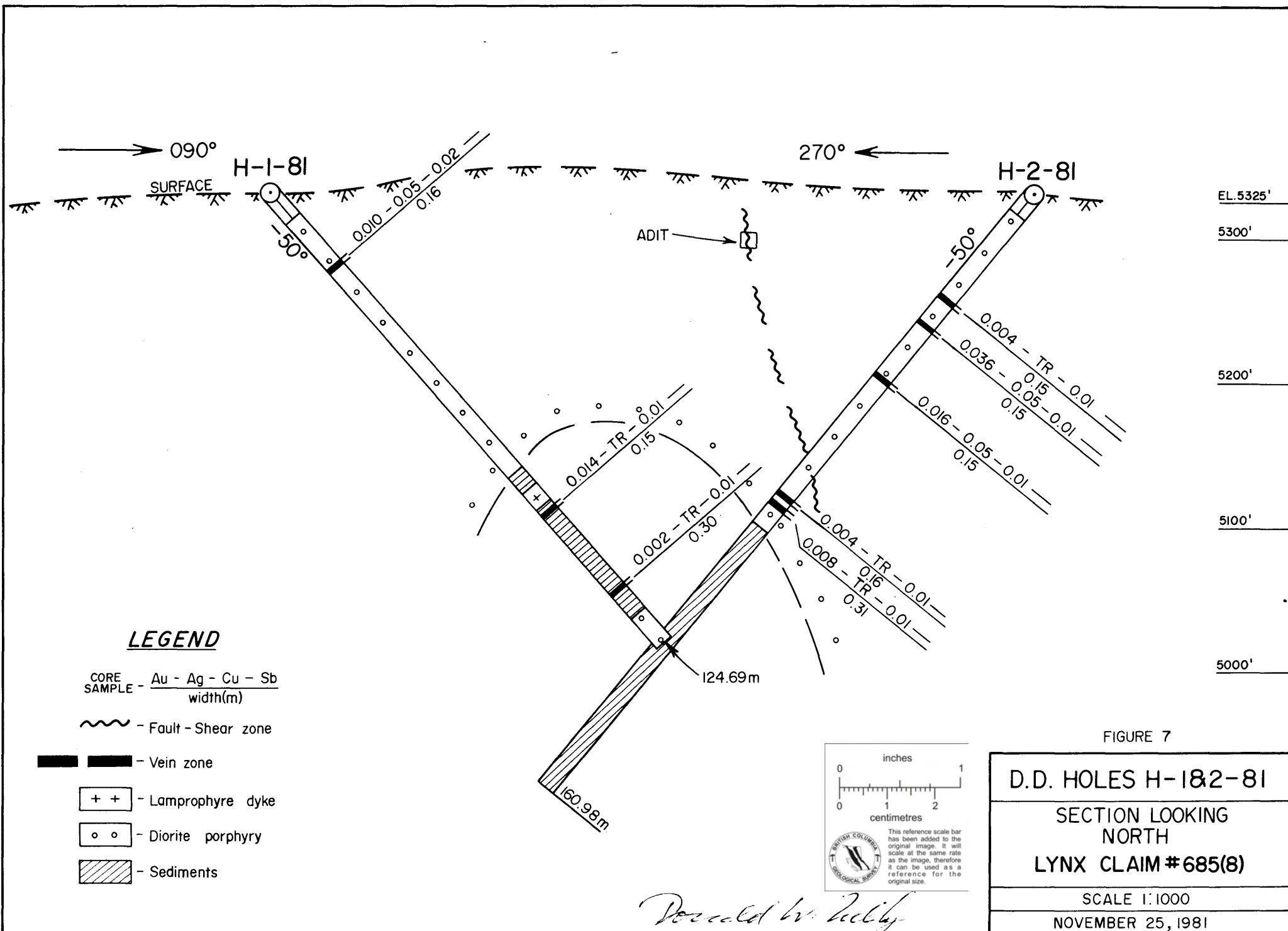

LEGEND

CORE SAMPLE - Au - Ag - Cu - Sb
width(m)

~ - Fault - Shear zone

█ - Vein zone

++ - Lamprophyre dyke

○ ○ - Diorite porphyry

▨ - Sediments

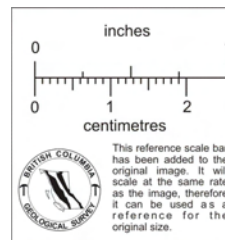

FIGURE 7

D.D. HOLES H-1&2-81
SECTION LOOKING NORTH
LYNX CLAIM #685(8)
SCALE 1:1000
NOVEMBER 25, 1981

Designed by Kelly

REGIONAL AND LOCAL GEOLOGICAL SETTING

The regional geology is shown on Geological Survey of Canada Map 1059A, Vernon, (Figure 5). Rock outcrop is sparse over the LYNX claim but the overburden appears to be relatively shallow.

The property is underlain by granitic rocks of Jura-Cretaceous age intruding bedded sediments and volcanics. A tentative table of formations on the ground is as follows:

<u>Formation</u>	<u>Description/Event</u>	<u>Age</u>
Sand, gravel and local glacial debris	Unconsolidated	Quaternary
	Erosional Unconformity	
Mineralization, quartz veining	Gold, silver, arsenopyrite, pyrite, galena and chalcopyrite	Probably Tertiary (?)
	Shearing, faulting and related tectonic activity	
Granitic intrusives	Diorite, diorite porphyry, granodiorite and lamprophyre dykes	Jura-Cretaceous (?)
	Shearing, folding, faulting and related tectonic activity	
Sediments (Inlier)	Quartzite, conglomerate, slate, limestone and volcanics	

Structural trends are north-south with dips varying from very flat to the east to nearly vertical in the rock exposures seen in the recently trenched areas on the property.

270° ←

H-4-81 H-3-81

→ 90°

Projected position of ADIT on STRIKE (60m off section to south)

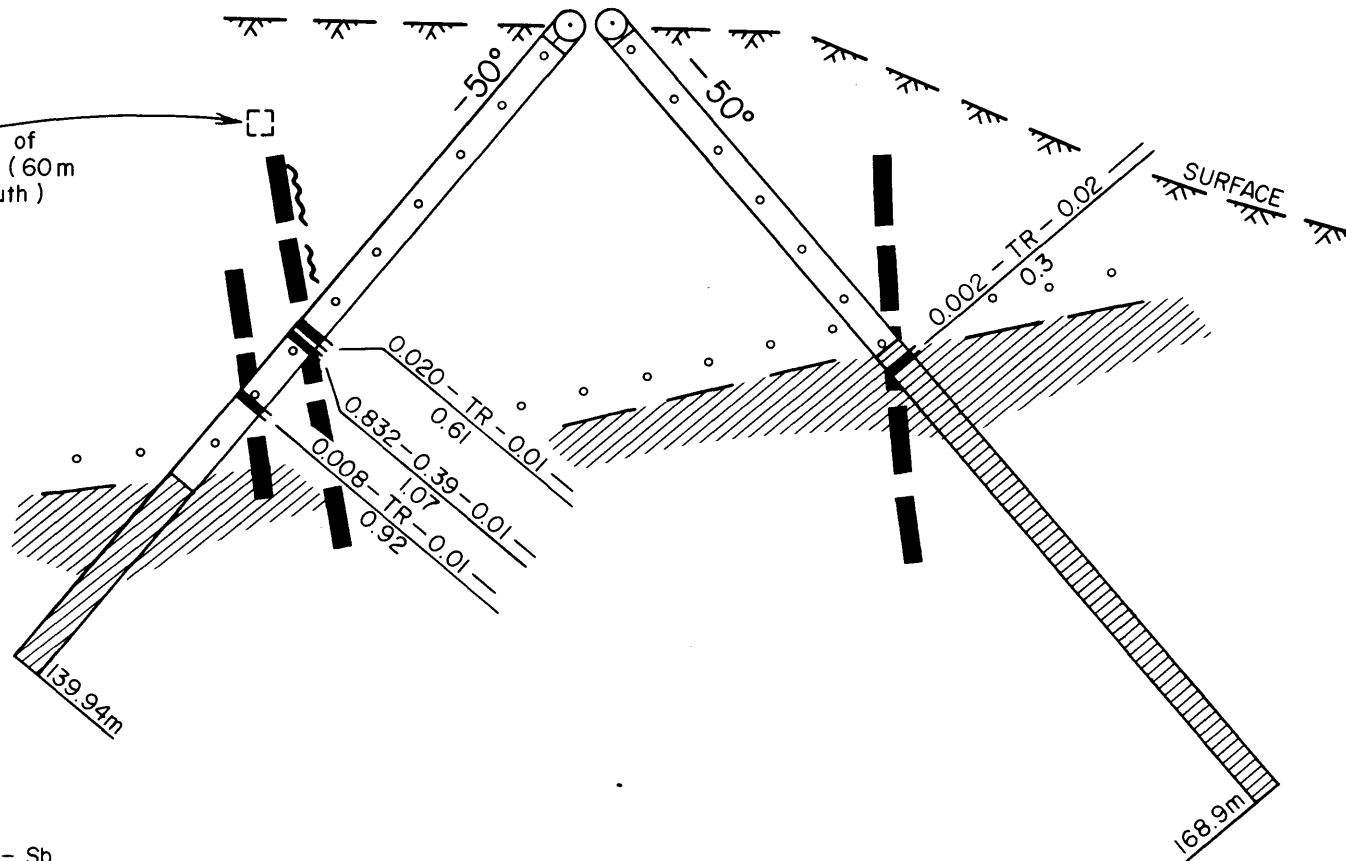

LEGEND

CORE SAMPLE - Au - Ag - Cu - Sb
width(m)

~ - Fault - Shear zone

█ - Vein zone

++ - Lamprophyre dyke

○ ○ - Diorite porphyry

▨ - Sediments

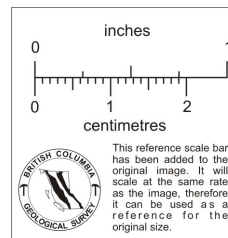

FIGURE 8

D.D. HOLES H-3 & 4-81

SECTION LOOKING NORTH

LYNX CLAIM #685(8)

SCALE 1:1250

NOVEMBER 25, 1981

Donald W. Kelly

MINERALIZATION

Where exposed by the former workings and in the new trenchings, the sericitized granitic rock is rusty-weathering as a result of the oxidation of the pyrite disseminated through the granitic-type groundmass. Boulders in the overburden along the south-facing slope in the area of the Kismet workings show abundant limonite gossan.

The gold-bearing quartz veins and veinlets are grey to bluish-grey in color and invariably carry fine seams of pyrite (1-2mm) with splashes of chalcopyrite and small amounts of stibnite.

The known gold-bearing vein structures are fissure-type, strike slightly east of north and dip steeply to the east.

RESULTS OF THE 1981 DIAMOND DRILL PROGRAM

The following is a summary of the drill holes and results of the split-core assay intersections:

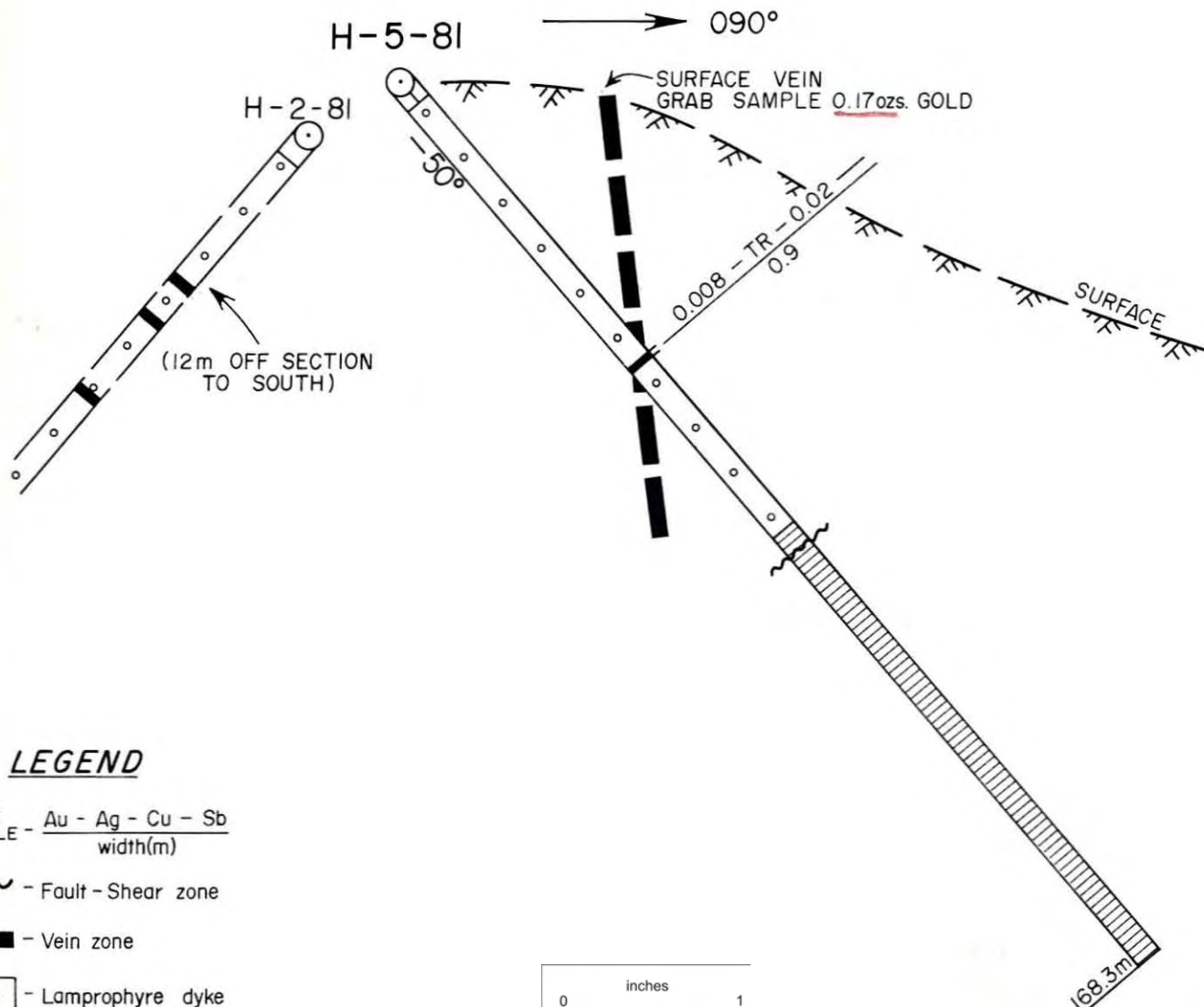

EL. 5350
5300'
5200'
5100'
5000'

LEGEND

CORE SAMPLE - Au - Ag - Cu - Sb
width(m)

~~~~~ - Fault - Shear zone

███ - Vein zone

++ - Lamprophyre dyke

○○ - Diorite porphyry

▨ - Sediments

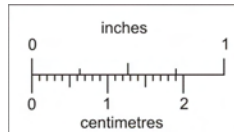

This reference scale bar has been added to the original image. It will scale at the same rate as the image, therefore it can be used as a reference for the original size.



*Donald G. Kelly*

FIGURE 9

|                       |
|-----------------------|
| D. D. HOLE H-5-81     |
| SECTION LOOKING NORTH |
| LYNX CLAIM #685(8)    |
| SCALE 1:1000          |
| NOVEMBER 25, 1981     |

| DD Hole # | Dir'n            | Dip             | Depth            | Intersection |       | Width<br>(metres) | Gold<br>ozs                                     | Silver<br>ozs | Copper<br>% | Antimony<br>% |
|-----------|------------------|-----------------|------------------|--------------|-------|-------------------|-------------------------------------------------|---------------|-------------|---------------|
|           |                  |                 |                  | From         | To    |                   |                                                 |               |             |               |
| H-1-81    | 090 <sup>o</sup> | 50 <sup>o</sup> | 124.70m          |              |       |                   | Low gold values in three vein structures        |               |             |               |
| H-2-81    | 270 <sup>o</sup> | 50 <sup>o</sup> | 160.98m          | 35.52        | 35.67 | 0.15              | 0.036                                           | 0.05          | 0.01        | N/A           |
| H-3-81    | 090 <sup>o</sup> | 50 <sup>o</sup> | 168.90m          |              |       |                   | Low gold values in one vein structure           |               |             |               |
| H-4-81    | 270 <sup>o</sup> | 50 <sup>o</sup> | 140.24m          | 53.96        | 55.03 | 1.07              | 0.832                                           | 0.39          | 0.01        |               |
|           |                  |                 |                  |              |       |                   | Low gold values in two parallel vein structures |               |             |               |
| H-5-81    | 090 <sup>o</sup> | 50 <sup>o</sup> | 168.00m          |              |       |                   | Low gold values in one vein structure           |               |             |               |
| H-6-81    | 090 <sup>o</sup> | 50 <sup>o</sup> | 74.10m           |              |       |                   | No quartz veins intersected                     |               |             |               |
| H-7-81    | 150 <sup>o</sup> | 65 <sup>o</sup> | 114.60m          | 72.60        | 73.20 | 0.60              | 0.110                                           | 0.09          | N/A         | 0.009         |
|           |                  |                 |                  |              |       |                   | Low gold values in two parallel vein structures |               |             |               |
| H-8-81    | 165 <sup>o</sup> | 50 <sup>o</sup> | 117.10m          | 28.05        | 28.20 | 0.15              | 0.024                                           | 0.11          | N/A         | 0.004         |
| Total     |                  |                 | <u>1,068.62m</u> | (3,505 feet) |       |                   |                                                 |               |             |               |

### RECOMMENDATIONS

It is recommended that a program of diamond drilling be carried out to extend the strike and down-dip projections of the two known vein structures and also search for additional gold-bearing vein zones.

A program of at least 50 metres of underground drifting is proposed to determine the nature of the apparent ore value in the vein structure intersected in diamond drill hole H-4-81 from the present adit opening.

Respectfully submitted,

*Donald W. Tully*

November 25, 1981

Donald W. Tully, P. Eng.

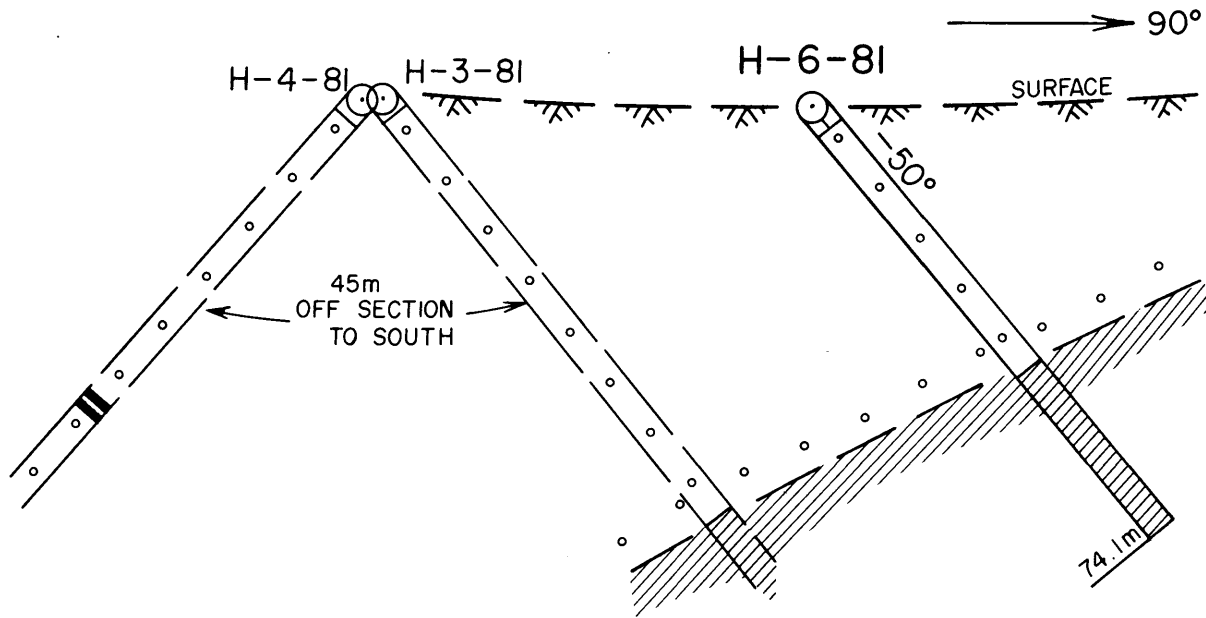

EL. 5350'  
 5300'  
 5200'  
 5100'  
 5000'

**LEGEND**

CORE SAMPLE -  $\frac{\text{Au} - \text{Ag} - \text{Cu} - \text{Sb}}{\text{width(m)}}$

~~~~~ - Fault - Shear zone

▬▬▬ - Vein zone

++ - Lamprophyre dyke

○○ - Diorite porphyry

▨▨▨ - Sediments

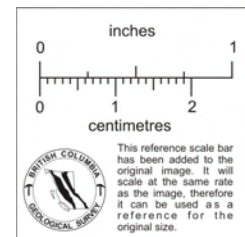

FIGURE 10

| |
|-----------------------|
| D. D. HOLE H-6-81 |
| SECTION LOOKING NORTH |
| LYNX CLAIM #685(8) |
| SCALE 1:1000 |
| NOVEMBER 25, 1981 |

Ronald W. Kelly

TIME - COST DISTRIBUTION

HI-COR RESOURCES LTD.

10.

LYNX mineral claim

Record No. 658(8)

Itemized cost statement - 1981 diamond drill program

| | <u>Ck. #</u> | <u>Amount</u> | <u>Total</u> |
|---------------------------------|--------------|------------------|----------------------|
| Diamond drilling - | | | |
| Tri-Mac Drilling Ltd. | 119 | \$ 488.20 | |
| " " " | 120 | 300.00 | |
| " " " | 123 | 10,000.00 | |
| " " " Abaton | 176 | 20,000.00 | |
| " " " | 127 | 79,284.08 | |
| " " " | 142 | 1,733.66 | |
| " " " | 143 | <u>35,357.05</u> | \$ 147,162.99 |
| Cat work - | | | |
| Macal Services Ltd. | 126 | 29,540.00 | |
| Ghost River Logging | 129 | 600.00 | |
| Macal Services Ltd. | 141 | <u>26,030.00</u> | 56,170.00 |
| Room and board (drill crew) - | | | |
| Marcel Carriere | 114 | 66.21 | |
| Spruce Grove Resort | 115 | 1,331.74 | |
| Marcel Carriere | 117 | 143.33 | |
| Spruce Grove Resort | 130 | 6,295.30 | |
| Diamond Motor Inn | 135 | <u>306.00</u> | 8,142.58 |
| 4 x 4 rental - | | | |
| Louis Carriere | 113 | 100.00 | |
| " " | 116 | 120.00 | |
| Tri-Mac Drilling Ltd. | 118 | 24.25 | |
| Eric Chapman | 131 | 600.00 | |
| " " | 139 | 500.00 | |
| Louis Carriere (estimate) | A/P | <u>1,600.00</u> | 2,944.25 |
| Gas & Oil - | | | |
| Denu Mines & Development Ltd. | 10-1 | | 1,331.31 |
| Water tank repairs - | | | |
| Denu Mines & Development Ltd. | 10-1 | | 690.53 |
| Travel - | | | |
| Dennis Vigouret | 11-1 | | 194.34 |
| | | | <u>216,636.00</u> |
| Engineer's fees and expenses - | | | |
| Don Tully Engineering | | | <u> </u> |
| | Total | | \$ <u> </u> |

Vancouver, B.C.
December 14, 1981

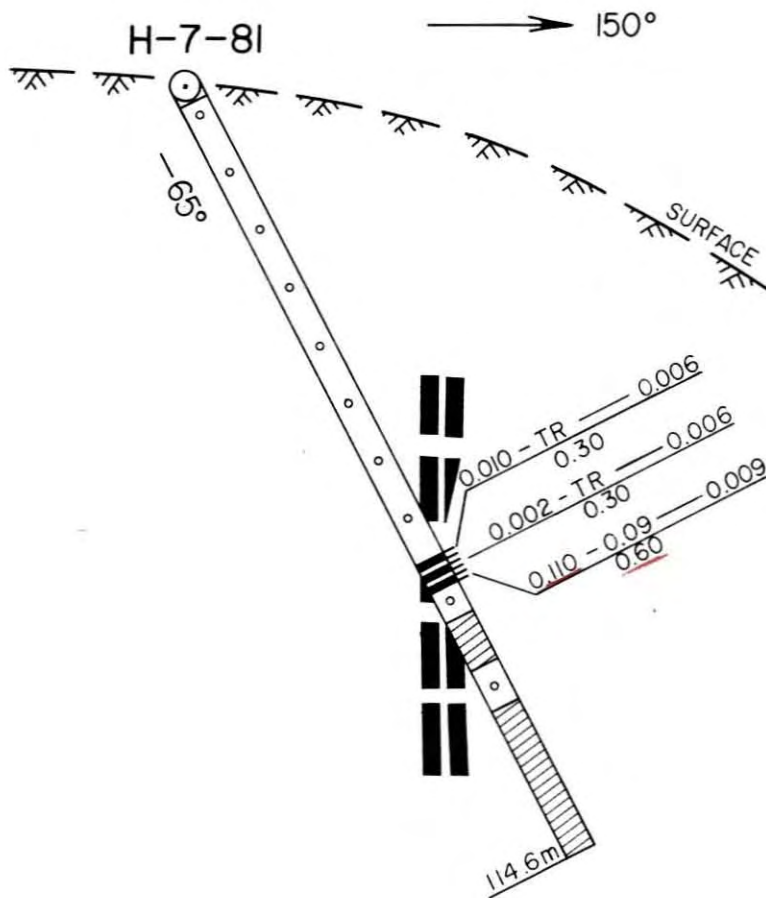

EL. 5335'

5300'

5200'

5100'

5000'

LEGEND

CORE SAMPLE - Au - Ag - Cu - Sb
width(m)

~~~~~ - Fault - Shear zone

███ - Vein zone

++ - Lamprophyre dyke

○○ - Diorite porphyry

▨ - Sediments

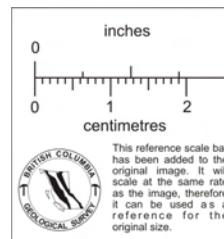

FIGURE 11

**D. D. HOLE H-7-81**

SECTION LOOKING  
NORTH EAST

LYNX CLAIM #685(8)

SCALE 1:1000

NOVEMBER 25, 1981

*Donald W. Kelly*

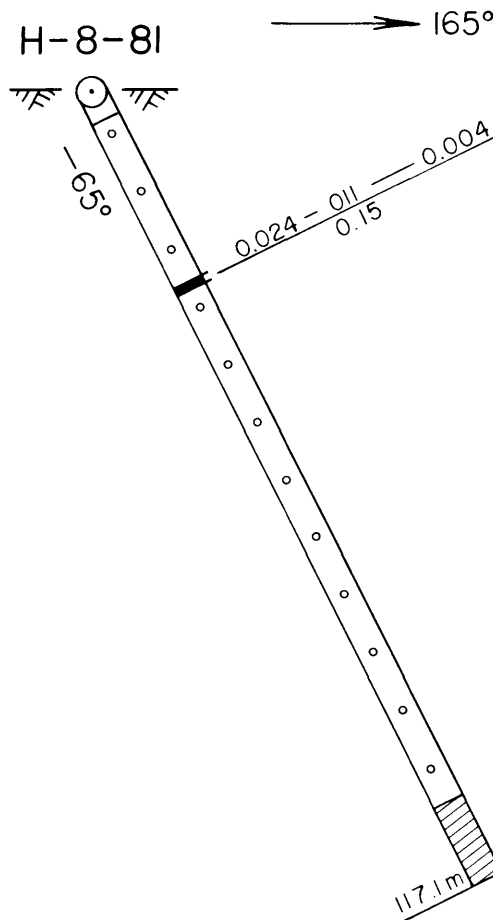

EL. 5340'

5300'

5200'

5100'

5000'

**LEGEND**

CORE SAMPLE -  $\frac{\text{Au - Ag - Cu - Sb}}{\text{width(m)}}$

~~~~~ - Fault - Shear zone

■ ■ - Vein zone

++ - Lamprophyre dyke

○ ○ - Diorite porphyry

▨ - Sediments

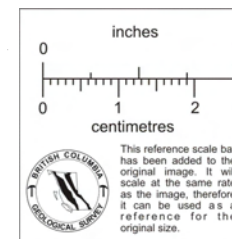

FIGURE 12

D. D. HOLE H-8-81

SECTION LOOKING
EAST

LYNX CLAIM #685(8)

SCALE 1:1000

NOVEMBER 25, 1981

Donald W. Kelly

HOLE No. H-1-81

CLAIM LYNX #685(8)

Loc'n Unit 2W-25
PROPERTY

COMPANY HI-COR RESOURCES LTD.

DIAMOND DRILL CORE LOG - SAMPLE RECORD

HOLE DEPTH 124.70m (409 ft.)

CORE SIZE 36mm

HOLE DIRECTION 090°

DIP 50

collar ELEV. 5300' PAGE No. 1 of 1

| LENGTH
IN METRES | | DESCRIPTION | MINERALIZATION | SAMPLE
No. | ASSAYS | | | | | |
|---------------------|--------|--|----------------|---------------|--------|----|-------------|-----------|-----------|------|
| FROM | TO | | | | From | To | Length
M | AU
OZS | AG
OZS | KN |
| 0.0 | 6.10 | Casing | | | | | | | | |
| | 19.05 | Diorite porphyry, dark phase with plagioclase phenocrysts
m.g. with limonite on fractures | | | | | | | | |
| | 19.21 | 3 cm seam massive py. in dark altered diorite por. | | 865R | | | 0.16 | 0.010 | 0.05 | 0.02 |
| | 76.07 | Diorite porphyry | | | | | | | | |
| | 81.10 | Quartzite with pelite and garnets, and black shale
bedding @ 60° c/a | | | | | | | | |
| | 85.87 | Lamprophyre dyke - micaceous, dark | | | | | | | | |
| | 86.89 | Quartzite with pelite and garnets, black shale bands | | | | | | | | |
| | 87.04 | 2 cm zone of diss. py. and fine quartz veinlet | | 866R | | | 0.15 | 0.014 | Tr | 0.01 |
| | 109.15 | Quartzite, pelite and black shale, as above | | | | | | | | |
| | 109.45 | Grey quartz vein zone with sparse py. | | 867R | | | 0.30 | 0.002 | Tr | 0.01 |
| | 115.55 | Quartzite, pelite and black shale bands as above | | | | | | | | |
| | 124.39 | Diorite porphyry dyke, dark phase, m.g. | | | | | | | | |
| | 124.70 | Pelite with scattered garnets | | | | | | | | |
| | | END OF HOLE | | | | | | | | |

LEGEND

C/A - CORE AXIS

Bx - BRECCIATED

NA - NOT ASSAYED

Diss. - DISSEMINATED

f.g. - fine-grained

m.g. - med. grained

py - PYRITE

Mg - MAGNETITE

Pb - GALENA

Zn - SPHALERITE

Po - PYRRHOTITE

NOTE: CORE STORED AT COLLAR OF HOLE

CORE Logged by: D.W. Tully, P.Eng.

CORE Split by: D.W. Tully, P.Eng.

HOLE STARTED: September 9, 1981

HOLE FINISHED: September 11, 1981

HOLE No. H-2-81

CLAIM LYNX #685(8)

LOC'n Unit 2W-2S
PROPERTY

COMPANY HI-COR RESOURCES LTD.

DIAMOND DRILL CORE LOG - SAMPLE RECORD

HOLE DEPTH 160.98m (528 ft)

CORE SIZE 36 mm

HOLE DIRECTION 270°

DIP 50°

collar ELEV 5325 ft PAGE No. 1 of 1

| LENGTH IN METRES | | DESCRIPTION | MINERALIZATION | SAMPLE No. | ASSAYS | | | | | |
|------------------|--------|--|----------------|------------|--------|----|----------|--------|--------|------|
| FROM | TO | | | | From | To | Length M | AU OZS | AG OZS | EN |
| 0.0 | 5.18 | Casing | | | | | | | | |
| | 28.20 | Diorite porphyry, dark phase, plagioclase phenocrysts with broken ground limonitic stain on fracture planes @ 4.88, 6.10, 8.84, 9.15, 11.58, 11.89, 13.41, 13.72, 15.55, 24.76 | | | | | | | | |
| | 28.35 | 3 cm quartz vein with fine cupy. and py. seams | | 868R | | | 0.15 | 0.004 | Tr | 0.01 |
| | 35.52 | Diorite porphyry, as above | | | | | | | | |
| | 35.67 | 2 cm quartz vein with fine tetrahedrite and py. | | 869R | | | 0.15 | 0.036 | 0.05 | 0.01 |
| | 50.15 | Diorite porphyry, as above | | | | | | | | |
| | 50.30 | 3 cm quartz vein with fine tetrahedrite and py. | | 870R | | | 0.15 | 0.016 | 0.05 | 0.01 |
| | 57.62 | Diorite porphyry, as above | | | | | | | | |
| | 60.06 | Diorite porphyry, grey altered with phantom phenocrysts | | | | | | | | |
| | 74.39 | Diorite porphyry, broken ground @ 64.6, 64.8, 67.9, 68.3 | | | | | | | | |
| | 75.00 | Recemented fault breccia | | | | | | | | |
| | 81.55 | Diorite porphyry | | | | | | | | |
| | 81.71 | 2 cm quartz vein with py. | | 871R | | | 0.16 | 0.004 | Tr | 0.01 |
| | 84.45 | Diorite porphyry | | | | | | | | |
| | 84.76 | 2 cm quartz vein with fine tetrahedrite, cupy., py. | | 872R | | | 0.31 | 0.008 | Tr | 0.01 |
| | 90.24 | Diorite porphyry, as above | | | | | | | | |
| | 160.98 | Pelite with quartzite beds and banding @ 60-80° c/a | | | | | | | | |

END OF HOLE

LEGEND NOTE: CORE STORED AT COLLAR OF HOLE

C/A - CORE AXIS

Bx - BRECCIATED

NA - NOT ASSAYED

Dis. - DISSEMINATED

f.g. - fine-grained

m.g. - med. grained

py - PYRITE

Mg - MAGNETITE

Pb - GALENA

Zn - SPHALERITE

Po - PYRRHOTITE

CORE Logged by: D.W. Tully, P.Eng.

CORE Split by: D.W. Tully, P.Eng.

HOLE STARTED: September 13, 1981

HOLE FINISHED: September 18, 1981

HOLE No. H-3-81

COMPANY HI-COR RESOURCES LTD.

HOLE DEPTH 168.9m (554 ft)

CORE SIZE 36 mm

HOLE DIRECTION 090°

CLAIM LYNX #685(8)

DIAMOND DRILL CORE LOG - SAMPLE RECORD

DIP 50°

Loc'n
PROPERTY Unit 2W-25

collar ELEV. 5350 ft PAGE No. 1 of 2

| LENGTH
IN METRES | | DESCRIPTION | MINERALIZATION | SAMPLE
No. | ASSAYS | | | | | |
|---------------------|------|--|----------------|---------------|--------|-----|-------------|-----------|-----------|------|
| FROM | TO | | | | From | To | Length
M | AU
OZS | AG
OZS | ZN |
| 0.0 | 2.74 | Casing | | | | | | | | |
| | 17.1 | Diorite porphyry, dark phase, albite-like phenocrysts
limonite on fracture faces @ 4.9, 6.4, 7.9, 11.6,
13.1, 14.3 | | | | | | | | |
| | 18.6 | Grey phase of diorite porphyry with phantom phenocrysts
with gradational contacts | | | | | | | | |
| | 34.2 | Diorite porphyry, dark phase, broken ground @ 20.4,
22.9, 23.8, 25.3, 26.8, 33.8 | | | | | | | | |
| | 43.9 | Grey altered phase of diorite porphyry | | | | | | | | |
| | 54.0 | Diorite porphyry, dark phase, with gradational contacts
with broken ground @ 40. , 44.2 | | | | | | | | |
| | 61.3 | Grey altered phase of diorite porphyry, as above | | | | | | | | |
| | 62.5 | Diorite porphyry, dark phase, as above | | | | | | | | |
| | 66.2 | Grey altered phase, as above | | | | | | | | |
| | 71.3 | Diorite porphyry, dark phase, as above | | | | | | | | |
| | 74.4 | Pelite, garnetiferous quartzite & black shale beds | | | | | | | | |
| | 74.7 | Bluish grey quartz veinlet zone | | 634R | | 0.3 | 0.002 | Tr | | 0.01 |
| | 79.0 | Pelite with quartzite bands and garnetiferous zones | | | | | | | | |
| | 99.7 | Conglomerate with black shale bands @ 20° c/a | | | | | | | | |

LEGEND

NOTE: CORE STORED AT COLLAR OF HOLE

C/A - CORE AXIS

Bx - BRECCIATED

NA - NOT ASSAYED

Dis. - DISSEMINATED

f.g. - fine-grained

m.g. - med. grained

py - PYRITE

Mg - MAGNETITE

Pb - GALENA

Zn - SPHALERITE

Po - PYRRHOTITE

CORE Logged by: D.W. Tully, P.Eng.

CORE Split by: D.W. Tully, P.Eng.

HOLE STARTED: September 26, 1981

HOLE FINISHED: September 30, 1981

HOLE No. H-4-81

COMPANY HI-COR RESOURCES LTD.

HOLE DEPTH 140.24m (460 ft)

CORE SIZE 36 mm

HOLE DIRECTION 270°

CLAIM LYNX #685(8)

DIAMOND DRILL CORE LOG - SAMPLE RECORD

DIP 50°

LOC'n Unit 2W-25

collar ELEV. 5350 ft PAGE No. 1 of 1

| LENGTH IN METRES | | DESCRIPTION | MINERALIZATION | SAMPLE No. | ASSAYS | | | | | |
|------------------|--------|---|----------------|------------|--------|----|----------|--------|--------|------|
| FROM | TO | | | | From | To | Length M | AU OZS | AG OZS | EN |
| 0.0 | 3.05 | Casing | | | | | | | | |
| | 39.33 | Diorite porphyry, dark phase, plagioclase with broken ground sections | | | | | | | | |
| | 39.94 | Diorite porphyry, with grey green alteration | | | | | | | | |
| | 52.44 | Diorite porphyry, broken ground @ 49.4, 50.9 | | | | | | | | |
| | 53.05 | Vein zone of grey quartz with fine diss. py. | | 873R | | | 0.61 | 0.020 | Tr | 0.01 |
| | 53.96 | Diorite porphyry, with grey alteration, broken ground | | | | | | | | |
| | 55.03 | Vein zone of grey quartz, fine tetrahedrite and diss.py. | | 874R | | | 1.07 | 0.832 | 0.39 | 0.01 |
| | 58.54 | Diorite porphyry, grey alteration | | | | | | | | |
| | 65.85 | Diorite porphyry, dark phase with plagioclase phenocrysts | | | | | | | | |
| | 66.77 | Vein zone, grey quartz, fine py. and pyrr. seams | | 875R | | | 0.92 | 0.008 | Tr | 0.01 |
| | 79.88 | Diorite porphyry, as above | | | | | | | | |
| | 103.35 | Pelite with 30% quartzite beds @ 50-60° c/a and local horizons of cherty conglomerate | | | | | | | | |
| | 125.61 | 70% black shale with pelite bands @ 45-60° c/a | | | | | | | | |
| | 140.24 | Quartzite with 20% pelite bands and shale bands @ 60-70° c/a | | | | | | | | |
| | | END OF HOLE | | | | | | | | |

LEGEND

C/A - CORE AXIS

Bx - BRECCIATED

NA - NOT ASSAYED

Diss. - DISSEMINATED

f.g. - fine-grained

m.g. - med. grained

py - PYRITE

Mg - MAGNETITE

Pb - GALENA

Zn - SPHALERITE

Po - PYRRHOTITE

NOTE: CORE STORED AT COLLAR OF HOLE

CORE Logged by: D.W. Tully, P.Eng.

CORE Split by: D.W. Tully, P.Eng.

HOLE STARTED: September 20, 1981

HOLE FINISHED: September 25, 1981

HOLE No. H-5-81

CLAIM LYNX #685(8)

Loc'n Unit 2W-25
PROPERTY

COMPANY HI-COR RESOURCES LTD.

DIAMOND DRILL CORE LOG - SAMPLE RECORD

HOLE DEPTH 168.00m (551 ft)

CORE SIZE 36mm

HOLE DIRECTION 090°

DIP 50°

collar ELEV 5350 ft PAGE No. 1 of 1

| LENGTH IN METRES | | DESCRIPTION | MINERALIZATION | SAMPLE No. | ASSAYS | | | | | |
|------------------|-------|--|----------------|------------|--------|----|----------|--------|--------|------|
| FROM | TO | | | | From | To | Length M | AU OZS | AG OZS | KN |
| 0.0 | 4.9 | Casing | | | | | | | | |
| | 53.7 | Diorite porphyry, dark phase, with grey altered gradational zones having phantom albite-like phantom phenocrysts | | | | | | | | |
| | 54.6 | Vein zones of bluish-grey quartz veinlets, fine py. seams | | 635R | | | 0.9 | 0.008 | Tr | 0.02 |
| | 86.3 | Diorite porphyry as above, with gradational phases | | | | | | | | |
| | 89.3 | Conglomerate with pelite bands @ 50° c/a | | | | | | | | |
| | 90.2 | Ground core (fault zone ?) | | | | | | | | |
| | 92.7 | Conglomerate as above | | | | | | | | |
| | 127.1 | Black shale with fine diss. py. | | | | | | | | |
| | 159.5 | Pelite with grey bedding @ 40° c/a | | | | | | | | |
| | 168.0 | Black shale with fine diss. py. | | | | | | | | |
| | | END OF HOLE | | | | | | | | |

LEGEND

C/A - CORE AXIS

Bx - BRECCIATED

NA - NOT ASSAYED

Diss. - DISSEMINATED

f.g. - fine-grained

m.g. - med. grained

py - PYRITE

Mg - MAGNETITE

Pb - GALENA

Zn - SPHALERITE

Po - PYRRHOTITE

NOTE: CORE STORED AT COLLAR OF HOLE

CORE Logged by: D.W. Tully, P.Eng.

CORE Split by: D.W. Tully, P.Eng.

HOLE STARTED: October 4, 1981

HOLE FINISHED: October 10, 1981

HOLE No. H-7-81

COMPANY HI-COR RESOURCES LTD.

HOLE DEPTH 114.60m (376 ft)

CLAIM LYNX #685(8)

CORE SIZE 36 mm

HOLE DIRECTION 150°

Loc'n Unit 2W-2S

DIAMOND DRILL CORE LOG - SAMPLE RECORD

DIP 65°

collar ELEV. 5335 ft PAGE No. 1 of 1

| LENGTH IN METRES | | DESCRIPTION | MINERALIZATION | SAMPLE No. | ASSAYS | | | | | | Sb % |
|------------------|--------|---|----------------|------------|--------|----|----------|--------|--------|------|-------|
| FROM | TO | | | | From | To | Length M | AU OZS | AG OZS | Cu % | |
| 0.0 | 1.8 | Casing | | | | | | | | | |
| | 18.60 | Diorite porphyry, dark phase with gradational grey phases carrying phantom phenocrysts, limonite on fracture faces of broken ground @ 1.8m, 7.3, 12.8, 14.6 | | | | | | | | | |
| | 21.30 | Fault zone in diorite porphyry with limonite @ 18.9, 19.8 | | | | | | | | | |
| | 71.00 | Diorite porphyry, as above section | | | | | | | | | |
| | 71.30 | Grey quartz veinlets with fine py. and stibnite | | 639R | | | 0.30 | 0.010 | Tr | | 0.006 |
| | 72.00 | Diorite, grey altered phase | | | | | | | | | |
| | 72.30 | Grey quartz veinlets with fine py. and stibnite | | 640R | | | 0.30 | 0.002 | Tr | | 0.006 |
| | 72.60 | Diorite porphyry | | | | | | | | | |
| | 73.20 | Grey quartz veinlets with fine py. and stibnite | | 641R | | | 0.60 | 0.110 | 0.09 | | 0.009 |
| | 79.60 | Diorite porphyry | | | | | | | | | |
| | 85.70 | Inclusion of quartzite | | | | | | | | | |
| | 86.60 | Ground core | | | | | | | | | |
| | 93.00 | Diorite porphyry | | | | | | | | | |
| | 114.60 | Quartzite with black shale bands @ 70° c/a | | | | | | | | | |
| | | END OF HOLE | | | | | | | | | |

LEGEND

C/A - CORE AXIS
 Bx - BRECCIATED
 NA - NOT ASSAYED
 Dis. - DISSEMINATED
 f.g. - fine-grained
 m.g. - med. grained

NOTE: CORE STORED AT BRIDGE OVER KETTLE RIVER on KEEFER LAKE ROAD
 py - PYRITE

Mg - MAGNETITE
 Pb - GALENA
 Zn - SPHALERITE
 Po - PYRRHOTITE

CORE Logged by: D.W. Tully, P.Eng.
 CORE Split by: D.W. Tully, P.Eng.
 HOLE STARTED: October 15, 1981
 HOLE FINISHED: October 18, 1981

HOLE No. H-8-81

COMPANY HI-COR RESOURCES LTD.

HOLE DEPTH 117.10m (384 ft)

CORE SIZE 36mm

HOLE DIRECTION 165°

DIP 65°

CLAIM LYNX #685(8)

DIAMOND DRILL CORE LOG - SAMPLE RECORD

LOC'n Unit 2W-25

collar ELEV 5340 ft. PAGE No. 1 of 1

| LENGTH IN METRES | | DESCRIPTION | MINERALIZATION | SAMPLE No. | ASSAYS | | | | | | Sb % |
|------------------|--------|---|--|------------|--------|----|----------|--------|--------|----|-------|
| FROM | TO | | | | From | To | Length M | AU OZS | AG OZS | CN | |
| 0.0 | 4.30 | Casing | | | | | | | | | |
| | 28.05 | Diorite porphyry, dark phase, with faces @ 10.4, 10.7, 15.2, 15.5, and fault breccia at 27.7 - 18.1 | limonite on fracture
16.2, 16.5, 26.2 | | | | | | | | |
| | 28.20 | Grey quartz vein zone with fine py | and stibnite | 638R | | | 0.15 | 0.024 | 0.11 | | 0.004 |
| | 105.80 | Diorite porphyry, dark phase with phases @ 41 - 43, 62 - 65, slight between 88.1 and 105.8, very broken ground 99.4 - 105.8 | grey gradational
greenish tinge | | | | | | | | |
| | 117.1 | Quartzite with pelite beds and black shale bands @ 60-70° c/a | | | | | | | | | |

LEGEND

C/A - CORE AXIS
 Bx - BRECCIATED
 NA - NOT ASSAYED
 Dis. - DISSEMINATED
 f.g. - fine-grained
 m.g. - med. grained

NOTE: CORE STORED AT BRIDGE OVER KETTLE RIVER

ON KEEFER LAKE ROAD
 py - PYRITE
 Mg - MAGNETITE
 Pb - GALENA
 Zn - SPHALERITE
 Po - PYRRHOTITE

CORE Logged by: D.W. Tully, P.Eng.
 CORE Split by: D.W. Tully, P.Eng.
 HOLE STARTED: October 19, 1981
 HOLE FINISHED: October 24, 1981

General Testing Laboratories

A Division of SGS Supervision Services Inc.

1001 EAST PENDER ST., VANCOUVER, B.C., CANADA, V6A 1W2
 PHONE (604) 254-1647 TELEX 04-507514 CABLE: SUPERVISE



TO:
DON TULLY ENGINEERING LTD.
 102 - 2222 Bellvue Ave.,
 West Vancouver, BC..
 V7V 1C7
HI-COR

CERTIFICATE OF ASSAY

No.: 8109-3053 DATE: Oct. 16/81

We hereby certify that the following are the results of assays on: **Ore**

| MARKED | GOLD | SILVER | Copper | XXX | XX | XXX | XXX | XXX |
|--------|-------|--------|--------|--|----|-----|-----|-----|
| | oz/st | oz/st | Cu (%) | | | | | |
| 864 R | 0.170 | 1.61 | 0.02 | <i>- SURFACE - GRAB NEAR COLLAR Hole #3</i>
<i>VEIN</i>
<i>D.D. Hole #2</i>
<i>D.D. Hole #4</i> | | | | |
| 868 R | 0.004 | trace | 0.01 | | | | | |
| 869 R | 0.036 | 0.05 | 0.01 | | | | | |
| 870 R | 0.016 | 0.05 | 0.01 | | | | | |
| 871 R | 0.004 | trace | 0.01 | | | | | |
| 872 R | 0.008 | trace | 0.01 | | | | | |
| 873 R | 0.020 | trace | 0.01 | | | | | |
| 874 R | 0.832 | 0.39 | 0.01 | | | | | |
| 875 R | 0.008 | trace | 0.01 | | | | | |

NOTE: REJECTS RETAINED ONE MONTH PULPS RETAINED THREE MONTHS ON REQUEST PULPS AND REJECTS WILL BE STORE FOR A MAXIMUM OF ONE YEAR

REPORTS ARE THE CONFIDENTIAL PROPERTY OF CLIENTS PUBLICATION OF STATEMENTS, CONCLUSION OR EXTRACTS FROM OR REGARDING OUR REPORTS IN NOT PERMITTED WITHOUT OUR WRITTEN APPROVAL ANY LIABILITY ATTACHED THERETO IS LIMITED TO THE FEE CHARGED.

L. Wong
 L. Wong

PROVINCIAL ASSAYER

Analytical and Consulting Chemists, Bulk Cargo Specialists, Surveyors, Inspectors, Samplers, Weighers

MEMBER: American Society For Testing Materials • The American Oil Chemists Society • Canadian Testing Association
 REFEREE AND OR OFFICIAL CHEMISTS FOR: National Institute of Oilseed Products • The American Oil Chemists' Society
 OFFICIAL WEIGHMASTERS FOR: Vancouver Board Of Trade

General Testing Laboratories

A Division of SGS Supervision Services Inc.

1001 EAST PENDER ST., VANCOUVER, B.C., CANADA, V6A 1W2
 PHONE (604) 254-1647 TELEX 04-507514 CABLE: SUPERVISE



TO:
DON TULLY ENGINEERING
 102 - 2222 Bellvue Ave.,
 West Vancouver, B.C.
HI-COR

CERTIFICATE OF ASSAY

No.: 8110-1663 DATE: Oct.27/81

We hereby certify that the following are the results of assays on: **Ore**

| MARKED | GOLD | SILVER | Copper | XXX | XXX | X XX | XXX | XXX |
|--------|-------|--------|--------|----------|-----|------|-----|-----|
| | oz/st | oz/st | Cu (%) | | | | | |
| 865 R | 0.010 | 0.05 | 0.02 | } H-1-81 | | | | |
| 866 R | 0.014 | trace | 0.01 | | | | | |
| 867 R | 0.002 | trace | 0.01 | | | | | |
| 634 R | 0.002 | trace | 0.01 | - H-3-81 | | | | |
| 635 R | 0.008 | trace | 0.02 | - H-5-81 | | | | |

REJECTS RETAINED ONE MONTH PULPS RETAINED THREE MONTHS ON REQUEST PULPS AND REJECTS WILL BE STORE FOR A MAXIMUM OF ONE YEAR.

ALL REPORTS ARE THE CONFIDENTIAL PROPERTY OF CLIENTS. PUBLICATION OF STATEMENTS, CONCLUSION OR EXTRACTS FROM OR REGARDING OUR REPORTS IN NOT PERMITTED WITHOUT OUR WRITTEN APPROVAL. ANY LIABILITY ATTACHED THERETO IS LIMITED TO THE FEE CHARGED.

L. Wong

PROVINCIAL ASSAYER

Analytical and Consulting Chemists, Bulk Cargo Specialists, Surveyors, Inspectors, Samplers, Weighers

MEMBER American Society For Testing Materials • The American Oil Chemists Society • Canadian Testing Association
 REFEREE AND OR OFFICIAL CHEMISTS FOR: National Institute of Oilseed Products • The American Oil Chemists' Society
 OFFICIAL WEIGHMASTERS FOR: Vancouver Board Of Trade

General Testing Laboratories

A Division of SGS Supervision Services Inc.

1001 EAST PENDER ST., VANCOUVER, B.C., CANADA, V6A 1W2
 PHONE (604) 254-1647 TELEX 04-507514 CABLE: SUPERVISE



TO:
 DON TULLY ENGINEERING LTD.
 102 - 2222 Bellvue Ave.,
 West Vancouver, B.C.

CERTIFICATE OF ASSAY

No.: 8111-0660 DATE: Nov. 16/81

We hereby certify that the following are the results of assays on: Ore

| MARKED | GOLD | SILVER | Antimony | XXX | XXX | XXX | XXX | XXX |
|--------|-------|--------|----------|-----|-----|-----|-----|-----|
| | oz/st | oz/st | Sb (%) | | | | | |
| 638 R | 0.024 | 0.11 | 0.004 | | | | | |
| 639 R | 0.010 | trace | 0.007 | | | | | |
| 640 R | 0.002 | trace | 0.006 | | | | | |
| 641 R | 0.110 | 0.09 | 0.009 | | | | | |

REJECTS RETAINED ONE MONTH PULPS RETAINED THREE MONTHS ON REQUEST PULPS AND REJECTS WILL BE STORE FOR A MAXIMUM OF ONE YEAR

ALL REPORTS ARE THE CONFIDENTIAL PROPERTY OF CLIENTS. PUBLICATION OF STATEMENTS, CONCLUSION OR EXTRACTS FROM OR REGARDING OUR REPORTS IS NOT PERMITTED WITHOUT OUR WRITTEN APPROVAL. ANY LIABILITY ATTACHED THERETO IS LIMITED TO THE FEE CHARGED.

L. Wong
 L. Wong
 PROVINCIAL ASSAYER

Analytical and Consulting Chemists, Bulk Cargo Specialists, Surveyors, Inspectors, Samplers, Weighers

MEMBER American Society For Testing Materials • The American Oil Chemists Society • Canadian Testing Association
 REFEREE AND OR OFFICIAL CHEMISTS FOR: National Institute of Oilseed Products • The American Oil Chemists' Society
 OFFICIAL WEIGHMASTERS FOR: Vancouver Board Of Trade