

1970

004431

Property File

082LNW027

CAMVEL ASSOCIATES

DEBBIE LYNN

Mineral Claims ~~Report~~ # 1, 2, and 3.Description of deposit

The above claims owned by Camvel Associates of Sicamous, B.C. are located approximately one mile due east of Quartzite Point on Shuswap Lake, some six miles northeast of Sicamous. The deposit is 900' above the lake level, 3,000' up a logging road that starts at the lakeshore about one-half mile northwest of a navigation marker on Quartzite Point. This road runs approximately parallel to the claims' centre line. (See attached map)

The deposit consists of a massive band of milky white to translucent, medium grained quartzite containing some bluish coloring near the base of the deposit. Map 1059A of the Geological Survey of Canada, show the rocks as a part of the Monashee group of the Shuswap Terrain, probably Paleozoic in age, consisting of highly metamorphosed granitic gneiss. The band is interbedded in shistose rocks of micaceous sericitic rock on the upper side of a major fault zone trending to the northwest approximately at right angles to the strike of the quartzite outcrop.

The claims cover an outcrop of banded quartzite well exposed 2,000' along a north 40° east strike. It disappears under overburden for some 1,000' appearing again where a year-round creek crosses the property at right angles, and is apparent for a further 1,200'. The main outcrops are sparsely covered by a carpet of moss with knobs of glossy white quartzite outcropping over a large area. The few trees in this area are of small diameter. The bedding planes, where apparent, seem to dip 4° - 5° to the southeast. The vertical interval is indeterminate, possibly, block-faulted but indicate a depth of approximately 65' or more.

The exposed width over the upper outcrop is in the order of 400' or more. Steep west dipping joints that strike north 60° east are abundant at ½ inch to 6 inch spacing. The bedding planes. Much of the rock is a translucent to milky-white showing some staining apparent on exposed highly fractured and jointed surfaces. Ground water has carried staining to some depth. When exposed to the weather this staining tends to disappear.

Obstacles to the public release of this originally private company report were deemed no longer to remain by D.Z. Hora, the recipient of the report from the company. (According to the recipient, there was an understanding of confidentiality as long as certain conditions existed. Since these conditions no longer endured, the reports could be removed from confidentiality.)

Con't...

To date work on the deposit consists of blast holes near the edges of the benches. Assays of samples depend on the degree of staining and vary from 98.5% to 99.76%  $S_1O_2$  content.

The quartzite from the upper area of this exposure is pure white for the most part and contains little or no staining, is coarsely crystalline, is very brittle showing a relatively even fracture pattern or crushing. This feature would indicate relatively even particle size and minimal amounts of fines upon crushing. It is extremely homogenous, almost entirely devoid of internal bedding or laminations. This material is undoubtedly a potential source of silica for industrial uses where a high degree of purity is required. Assays taken indicate that some areas would not meet high purity requirements but certainly would not affect its suitability for say stucco concrete aggregates, chicken grit, etc.

Some assays taken at different times and areas of exposure are as follows:

<u>Sample</u>	<u><math>S_1O_2</math></u>	<u><math>Al_2O_3</math></u>	<u>CaO</u>	<u>FeO (total)</u>
1A	99.02	0.28	0.53	0.07
1B	99.76 ✓	0.14	0.01	0.03
2A Upper exposure	99.60 ✓	0.17	0.07	0.04
2B	99.02	0.24	0.13	0.23
3A	99.68 ✓	0.13	0.04	0.35
3B	98.76 ✓	0.31	0.03	0.04
4A Lower exposure	98.5 ✓	0.29	0.46	0.84
4B	98.9 ✓	0.13	0.87	0.57

The altitude of the outcrops is excellent for a quarrying operation by the benching method. There is plenty of water available at the site for washing the overburden and other development requirements.

The property is accessible for commercial exploitation by land or water with a minimum amount of road building. Very little, if any, rock work would be required to link up with present logging roads to the Solscua area. The altitude of the overland route would be 3,500'.



CLAIM MAP SHOWING  
 QUARTZ OUTCROPS AND  
 DRIFT COVERED AREAS

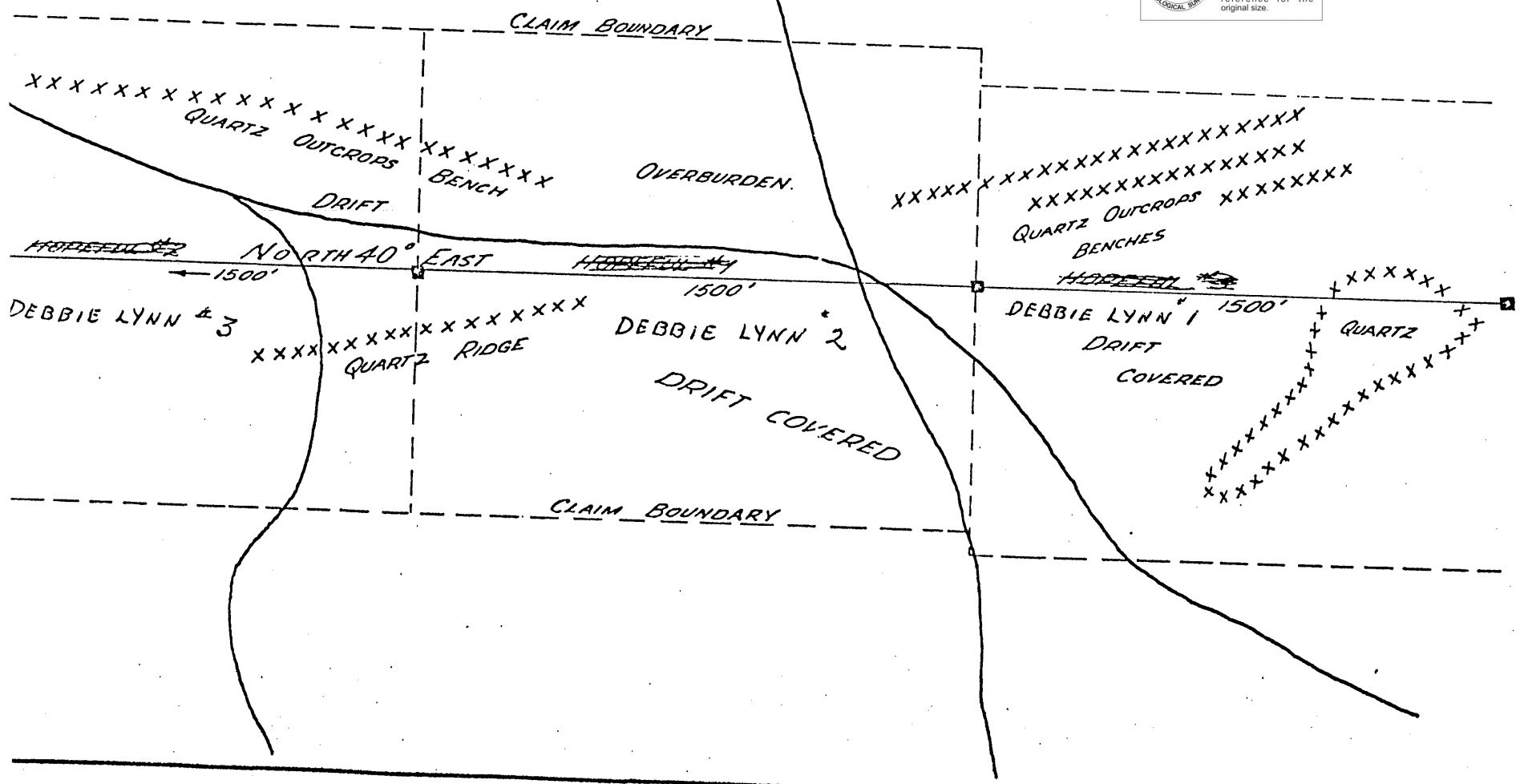
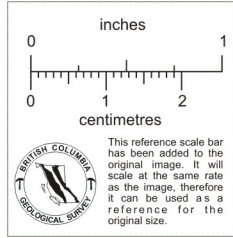



QUARTZITE POINT MARKER

SHUSWAP

LAKE BOOMING GROUND

LOGGING ROAD

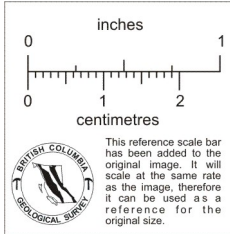

~~DEBBIE LYNN #1~~  
DEBBIE LYNN #3

DEBBIE LYNN #2

~~DEBBIE LYNN #1~~  
DEBBIE LYNN #4

40° EAST  
NORTH TOWNSHIP 22 RANGE 8  
WEST OF THE 6<sup>TH</sup> MERIDIAN

**CAN TEST LTD.**  
CHEMISTS, ANALYSTS AND CONSULTANTS

1650 PANDORA STREET, VANCOUVER 6, B.C.

Telephone 251-  
Telex 04-50.

Philmar Holdings Ltd.

507 - 540 Burrard Street

Vancouver, B.C.

**Certificate of Assay**

File No. 5941 A

Date October 12, 1973

We hereby Certify that the following are the results of assays made by us upon submitted Quartzite samples.

Sample Identification	GOLD	SILVER	Silica	Iron	Alumina	Calcium		
	Ounces Per Ton	Ounces Per Ton	Percent	Percent	Percent	Percent	Percent	Percent
00029			(SiO <sub>2</sub> )	(Fe <sub>2</sub> O <sub>3</sub> )	(Al <sub>2</sub> O <sub>3</sub> )	(CaO)		
00030			99.04	0.014	0.12	0.33		
00031			99.26	0.010	0.14	0.29		
00032			99.18	0.007	0.11	0.36		
			99.22	0.006	0.11	0.33		

Note: Samples also contain phosphorus.

cc: D.W. Pringle  
310 - 1720 W 12th Ave.  
Vancouver, B.C.

CAN TEST LTD.

Note: Pulps retained three months.

Rejects retained two weeks.

ALL REPORTS ARE THE CONFIDENTIAL PROPERTY OF CLIENTS. PUBLICATION OF STATEMENTS, CONCLUSIONS OR EXTRACTS FROM OR REGARDING OUR REPORTS IS NOT PERMITTED WITHOUT OUR WRITTEN APPROVAL. ANY LIABILITY ATTACHED THERETO IS LIMITED TO THE FEE CHARGED.

FRANK MITCHELL  
L & A RANCH LIMESTONE  
VERNON

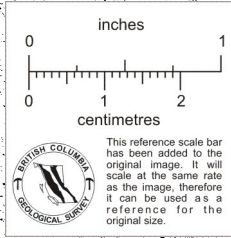

21.3 acres of limestone

Limestone

Limestone  
F - Fordkin - F  
Platform

Main Road

Pasture

O.K.  
Lake  
Landing

CPR.

Creek

CPR.

Vernon City 1/2  
→

Property File  
82L SW 097