

To: Gold Commissioner,  
Government Agent,  
Ministry of Regional and Economic Development,  
P.O. Box 380,  
Revelstoke, B.C. V0E 2S0.

Property File  
082 LNE 018

10 ROSEVIEW DRIVE N.E.  
CALGARY,  
004409  
ALBERTA. T2K 1N7  
June 23<sup>rd</sup> 1991

Dear Mr Welock,

It is with regret that I wish to  
officially relinquish my Three G's, 4 Post Claim (2924)  
at Three Valley Gap. Interesting monazite - graphite  
showing which I and Teck investigated. Following  
reports, assays, colleges are self explanatory. Graphite-  
rare - earth samples given to Dan Hora + Dr  
Simard of BC Govt Victoria (industrial minerals). As you  
can see Teck expended over 2000 dollars on this  
project whereas my expenses were 1500 dollars.

Some harassment on the road up from  
the motel with hunters and ski-do fanatics.  
but on the whole very enjoyable. Better luck  
next time

Sincerely,

G. E. Thomas

P.S. Thanks for your patience with Calgary Old Age Pensioners

RECORD OF 4 POST CLAIM - MINERAL TENURE ACT

SECTION 23

MAP NO. 82L/16W.

RECORD NO. 2924

MINING RECEIPT NO. 1000029 RECORDED BY Revelstoke B.C. DATE OF RECORD July 1 1991

DO NOT WRITE IN THIS SHADED AREA

GOLD COMMISSIONER

W. B. Welock

REVELSTOKE MINING DIVISION

APPLICATION TO RECORD A 4 POST CLAIM

GODFREY. E. THOMAS  
NAME OF LOCATOR

AGENT FOR SELF  
NAME

10 ROSEVIEW DRIVE N.W  
ADDRESS

10 ROSEVIEW DRIVE N.W  
ADDRESS

CALGARY, ALBERTA T2K1N7

CALGARY, ALBERTA

289.494 HOME T2K1N7  
TELEPHONE 265 7605 Office POSTAL CODE

289.494 HOME T2K1N7  
TELEPHONE 265 7605 Office POSTAL CODE

VALID SUBSISTING F.M.C. NO. 295730

VALID SUBSISTING F.M.C. NO. 295730

FMC CODE \_\_\_\_\_

FMC CODE \_\_\_\_\_

hereby apply for a record of a 4 post claim for the location as outlined on the attached copy of mineral titles reference map

No. 82L/16W in the REVELSTOKE Mining Division.

ACCESS: Describe how you gained access to the location; include references to roads, trails, topographic features, permanent landmarks, and a description of the legal post location.

FORESTRY ROAD OFF Trans Canada Highway east of Three Valley Gap (see attached aerial photograph + Map. L.C. P # 1 implanted 1400 metres due east of Three Valley Gap Metal complex

I have securely fastened the metal identification tag embossed "LEGAL CORNER POST" to the legal corner post (or witness post\*) and impressed this information on the tag:

LEGAL CORNER POST

TAG NO. 109781

CLAIM NAME THREE G'S

LOCATOR GODFREY. E. THOMAS

FMC NO. 295730

AGENT FOR SELF

FMC NO. 295730

DATE COMMENCED JULY 1st 1990

TIME 8. a.m

DATE COMPLETED 10. a.m July 1st 1990

TIME 10. a.m

NUMBER OF CLAIM UNITS

N 5 S 0 E 4 W 0

IDENTIFICATION POSTS NOT PLACED

were CLAIM POST # 4

because NEAR VERTICAL TERRAIN.

\*If a witness post was placed for the legal corner post:  
Bearing from witness post to true position of legal corner post is \_\_\_\_\_ degrees,  
at a distance of \_\_\_\_\_ metres.  
Bearing from identification post to witness post \_\_\_\_\_ degrees, at a distance of \_\_\_\_\_ metres.

NOTE: Legal corner post can be witnessed only if it was not feasible to place any posts.

I have complied with all the terms and conditions of the Mineral Tenure Act Regulation pertaining to the location of 4 post claims and have attached a plan of the location on which the positions of the legal corner post and all corner posts (and witness and identification posts if applicable) are indicated.

G. E. Thomas

Signature of Locator

**PAID**  
\$100.00  
JUL 5 1990  
GOVERNMENT AGENT  
REVELSTOKE  
TRANS. # 1000029  
RECORDING STAMP

**M82L/16W**

(FOR PLACER SEE P 82L/16W)

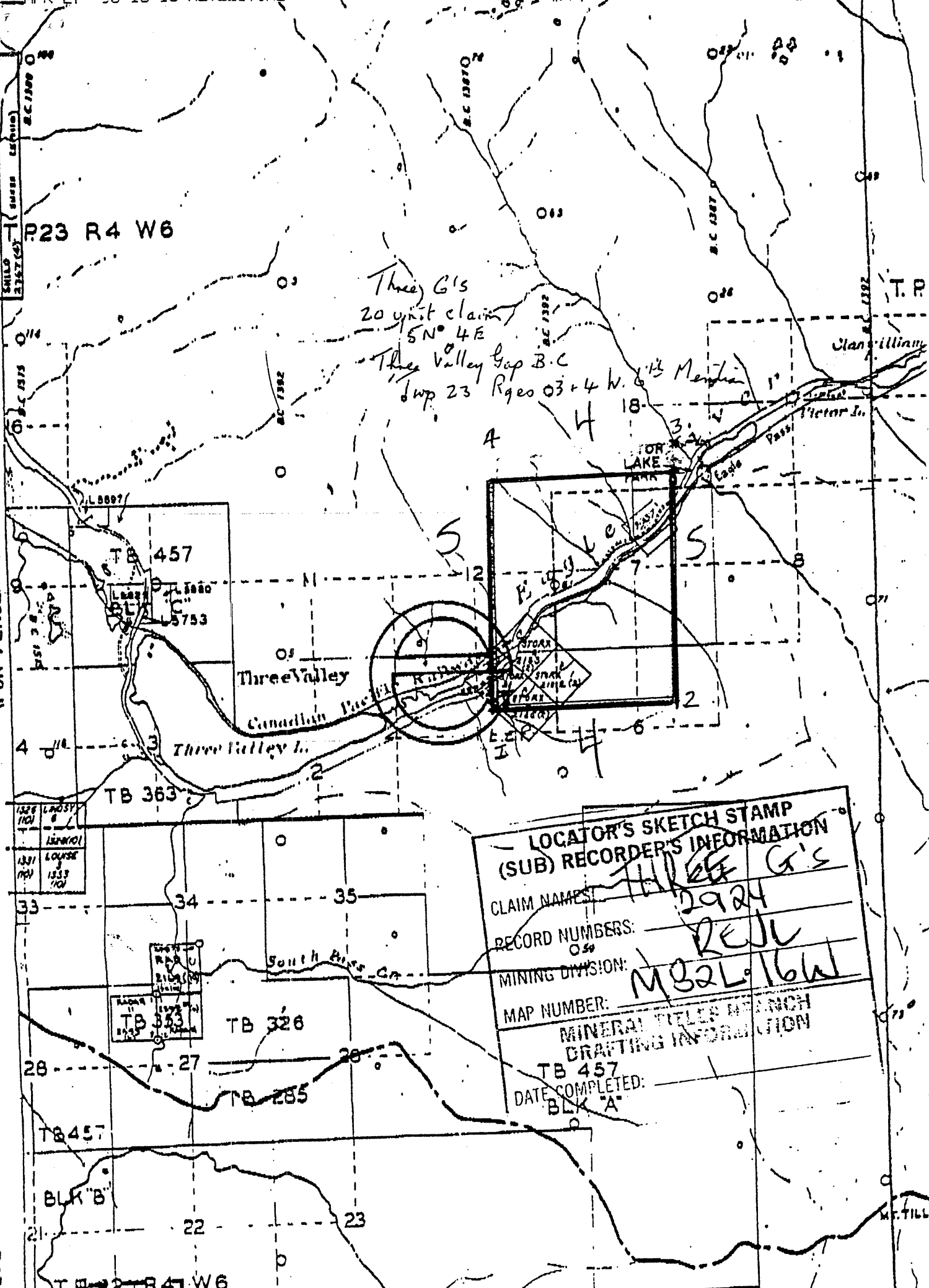

Three G's  
 20 unit claim  
 SN 4E  
 Three Valley Gap B.C.  
 Twp 23 Rges 03 + 4 W. 6

LOCATOR'S SKETCH STAMP	
(SUB) RECORDER'S INFORMATION	
CLAIM NAME:	THREE G'S
RECORD NUMBERS:	2924
MINING DIVISION:	RELL
MAP NUMBER:	M82L/16W
MINERAL TITLES BRANCH	
DRAFTING INFORMATION	
TB 457	
DATE COMPLETED:	BLK "A"

R23 R4 W6

TB 457

TB 363

TB 326

TB 285

TB 457

BLK "B"

T. R. 22 TR 4 W 6

T. R.

Clanwilliam

Victor L.

LAKE

Three Valley

Three Valley L.

South Pine Cr.

M. TILL