

004175

82K/2W

82K/SE-2C

cloudy

May 28/62

Plains Table survey of St. Patrick

- Δ1 on dump. lower adit
- Δ2 on partial cap of adit - no ore
- Δ3 Sand of low cut of olive green mica schist. highly cementated. white quartz lenses. roads in general 135/90
 L₁ 137/20, 150/34
 L₂ cross w/ h/ b 333/94

- at roads
- mica from

- Δ4 roadcut outcrop of grey cementated rusty mica schist. f = cleavage
 146/81E
 L₁ 325/9 but highly cementated
 or L₂ w/ h/ b 100/76



as mine desc 3.5' from N
 " " " " N 15'
 4.5' wide
 20' east of grey schist

Rain

- Δ5 cleavage - f = 146/85 S intersected grey with thin luff greenish mica schist beds

5' raise @ 00
 low rounded ore
 in a buffer

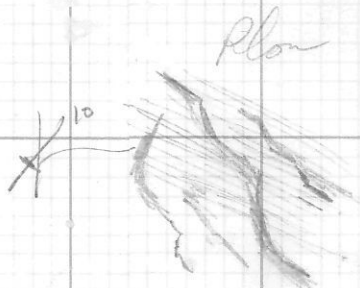

PROPERTY FILE

46 in some stumpy mainly
olive green schist / 165/90

l₃ cunks 103/75

50' due 50/16 168/85E in green schist

48. Green mica schist with quartz
rocks + lenses. l₂ = quartz rocks 339/6
N 160/55E with crenulations

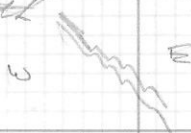

Just above 48 is a big fold of this
type

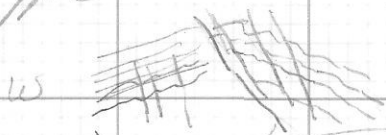

E

fracture - sort of
irregular fracture
clearly

Just above l₂ 349/4

49 on 14 cone of ore from 48. on
west of small fault fold 336/15

410 small ledge of buff weather
grey fine stalker l₃ in road
170/90 ± to be 6' ± strike
W of Δ beyond (W) of which is
green schist
A @ SE corner of oc 20' EW
30' N along rd.

Δ 13 on SW corner of spec of very schist
 155/15 E $\frac{1}{2}$ - $\frac{1}{4}$ " slip plane layers
 in bedded with greenish quartz
 schist

Δ 14 347/7 b2. in fairly clean iron
 line, green schist but schist
 between 14 + 13 is all somewhat line
 East of Δ 14 is fairly clean ls
 this is grey finely textured non striated
 ls with few micaceous whorls
 and odd bit of eyes. 10/60 E
 10' below foliation flattens in dip
 10/60 b2 354/13

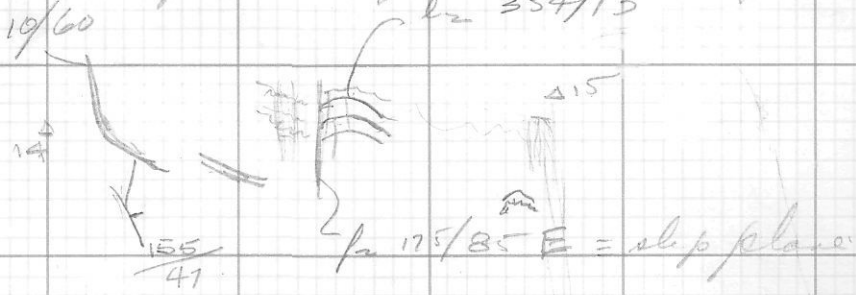

Isoclinal fold axial planes curve with
 foliation

Δ 15 @ NE corner of sublynes of
 ls 20' @ about 150° & 10'
 below Δ 15 is line schist in FW
 of ls. Clean ls is about 10' thick
 and goes down hill E of this schist
 into cover. Cumulated $\frac{1}{2}$ E
 w folds 3

339/12 axes of phase II folds
Probably ls is pinched or sliced 30-
40' due E of $\Delta 15$.

$\Delta 16$ on E contact of ls above
 $\Delta 14$ Ls is contorted but
dips steep 165/25E

$\Delta 17$ another? fairly clean grey ls
to west 10' thick with a
green schist on west. Lr ^{in situ 342/25} of 170/90 - 80°W

$\Delta 18$ beds of 175/60°E on wedge
of eastern ls hard clean schist
than any schist to W Lr 352/17
with a cross ripple

$\Delta 19$ of 158/77E in green schist thin
light green beds intersected by
clearance containing quartz lenses
76 + quartz lenticles of 172/76°W
Lr 342/21

$\Delta 20$ Lr 340/14 / 165/90 grey schist
in road cut. Oc extends 20'
beyond 20 on line 19-20

$\Delta 21$ on oc of green schist about
8' E of E edge of ls from $\Delta 18-16$
X

to contact 20' on line 12-20 near
about 170°. About 10' of ls exposed
at S end of grey stuffy.

25' @ 300° from s 21 to E end of
trench along down hill @ 240°
Rubble of ls in NE end of trench.

222 in same trench about outside
of ls of green schist 160/70E

15-20' on line 21-22 beyond 22
to small ocs of grey ls from A 17
6' exposed.

A 23 on W contact of dark grey schist
with green schist to west. Same
contact is about 10 feet east of s 21
of green schist 155/72E but across
creeks offset contact

A 24 is on E. contact of grey schist of 23 on
top of hill contact was 155° for 15' S
15' N. but goes right at
the points. Grey schist is about
20 wide.

A 25 is on NE corner of ocs of green
schist ext 5' W. of contact of A 23

A 26 is on same contact as A 24

PROPERTY FILE

$\Delta 27$ on SE corner of pit at head
 of old trench running $slit 160^\circ$ to $\Delta 21$
 Strong contact face of green schist
 on wall of pit 163/90. light shad
 E wall 10' long 10' high

Grey ls on W wall strong lincation
 394/25 on N wall 5' of curled
 grey schist \rightarrow ~~rust~~ siderite, ~~bedding~~
 green schist wall and ls on ~~west~~
 wall no siderite just curled grey
 schist.

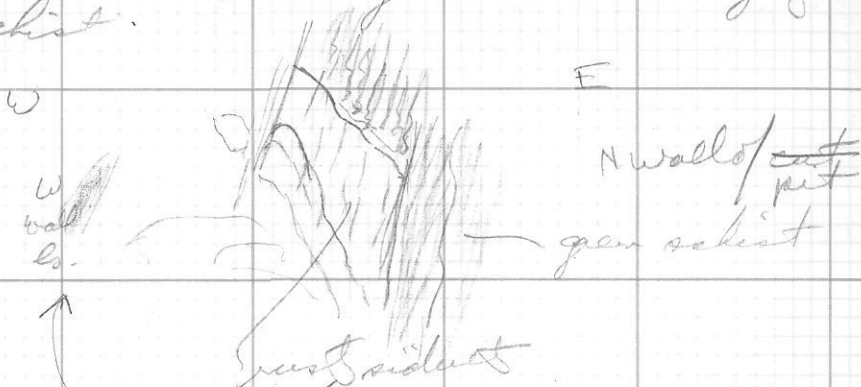

This is ls from $\Delta 18$.

$\Delta 28$ Round pit center 8' NE of Δ

Pit is in grey ls with green lining
 schist on east wall

Is 5' thick with siderite on E wall
 5 side of pit west wall on N side
 of pit 1' on N wall 3' on S wall
 Linc schist 162/60E f.

From this pit see as small hole
 vis to $\Delta 29$

western margin of grey ls layer not
 exposed probably at least

10' W of $\Delta 28$ Emory is 6' E
of $\Delta 30$ along a line of old pits
which extend to shaft collar
at $\Delta 31$. Contact seems to be
10' E of $\Delta 31$ then schist in
back of inclined shaft.

clean ggs to @ $\Delta 30$ of 150/67 E

$\Delta 36$ on small outcrop of green
schist on strike from E wall of pit
 $\Delta 27$

$\Delta 33$ on green ggs contact S side of
line of trenches following a fault
which affects green ggs contact 10' left
ggs W of green - some contact also @ $\Delta 36$
@ $\Delta 34$ fault strikes S dips steeply
east. It is 5' NW of $\Delta 33$ and has
attitude 25/75 SE 200' of
dipgrade on dump

$\Delta 35$ is on western side of ggs pit
(on out of green) NW of fault. Contact
strikes about 150°. Stuppis and
outcrops 30-40' N of trench.

PROPERTY FILE

pts A30-31 probably on shear
with gny schist with lenses
ling gny schist + selenite + galena
on shear

A31 collar of shaft up bank to NE
small ore-banded lg 195/44 E gny
crystallized schist to NE

¹⁵⁰
₅₅ A315 lowest ore of ls 150/55 E
are 25' due W of A3

A39 in NW of steep 125/45 SE layer of ls in
rusty galena schist

A47 trench contains blocks of selenite
+ galena some selenite in shear zone
Blocks may have come from replaced
ling beds. Trench slipped may
have extended to stops below.

A45 N of A line 355/10 of 165/27 E
Inter-layered ls + gny + open schist

A43 in center of road. ling schist in cut
looks to E 155/50 E 6" rust selenite
+ galena? in lenses in small folds
Galena on dump @ A31 contains
minor pyrite cleavages warped.

SA F62-1

Vegetation on B5 pile $\Delta 34$

+ pyrite in shaled galena sp F62-2

In big new stepping H of $\Delta 43$ sec of
clean gyls + big schist. Uniform
attitude no shearing. none

BIC
STRIPPING

38



PROPERTY FILE

DDH#1 Green schist $\pm 6'$
 Gyg schist to 38
 Green to end

#2 0-35 gyg schist
 35-80 green schist
 80-82 gyg ls

2 other holes #4 - 70' 57-76 gyg
 #3 - 32' in green

these holes must exist
 from A 33
 Park Loch drill.

PROPERTY FILE

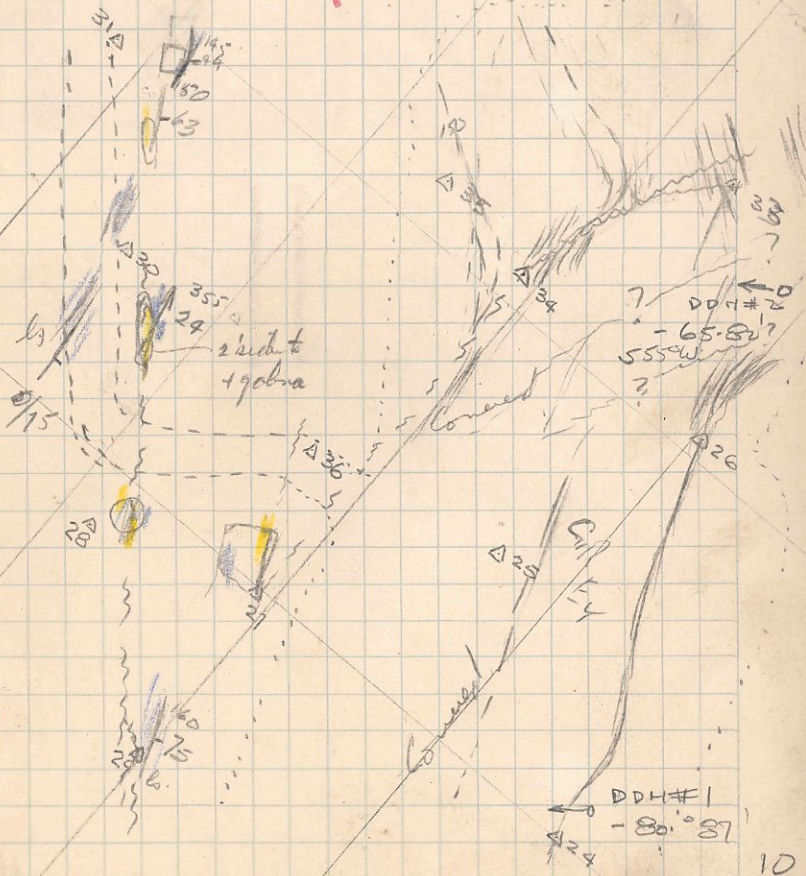

Δ W1 slip on SE wall. 155/67 SE strong
 back. slickensides more or less down
 the dip. XC to EC, 465' ^{str} grey schist
 in the @ fault with ls beneath - W of
 schist



I see schist on both walls to
 this XC line comes in above
 than grey schist but eventual all
 green schist to 2+10, where more
 ls comes into HW of fault on some
 strata. Grey + buff white blocky ls
 115/30H at 2+15 ←
 XC W @ 2+30 ^{guts}

Cr 355/10

white lining
 layers in green
 schist

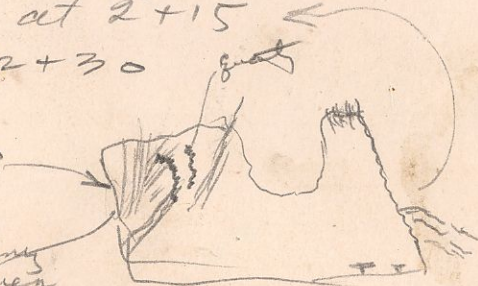

160
78
29

CO. CR.

Δ20

Δ22

Δ21

Δ19

Δ17

Δ18

Δ16

Δ14

Δ13

8

51

PROPERTY FILE

11

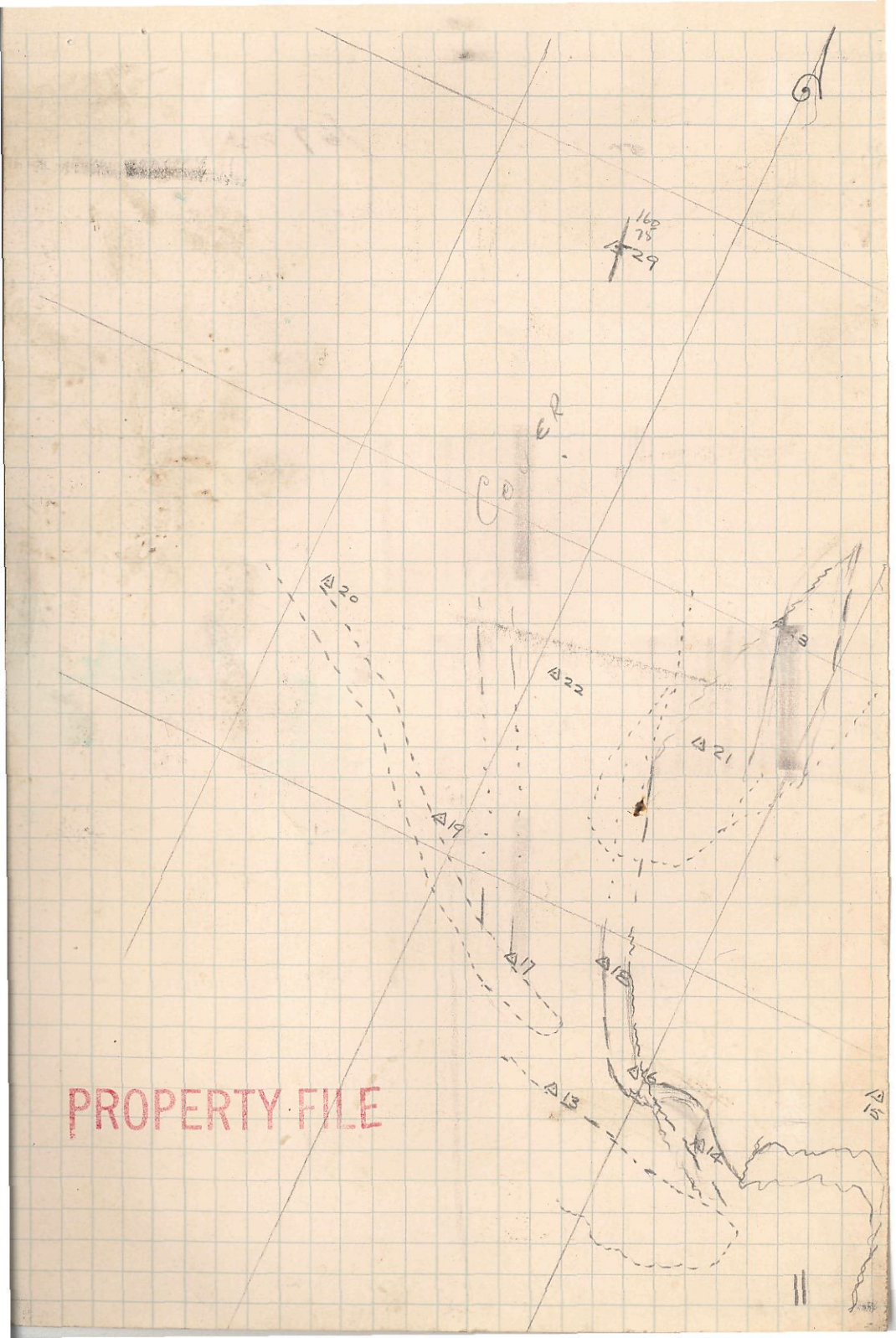

OP91

224 5579

B.

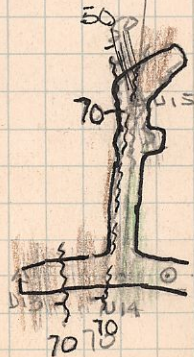
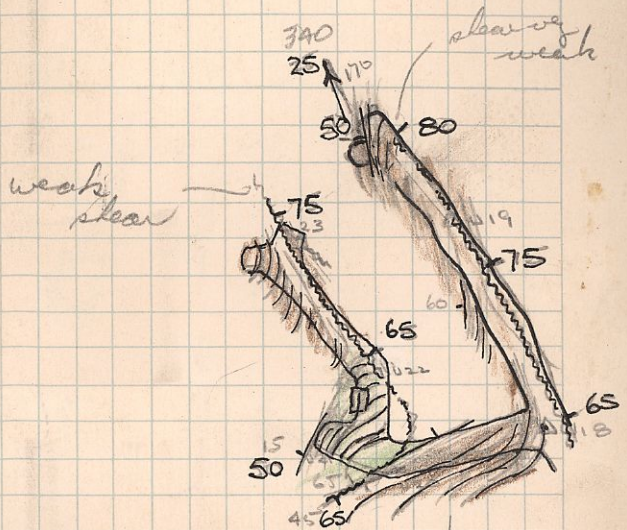

PROPERTY FILE

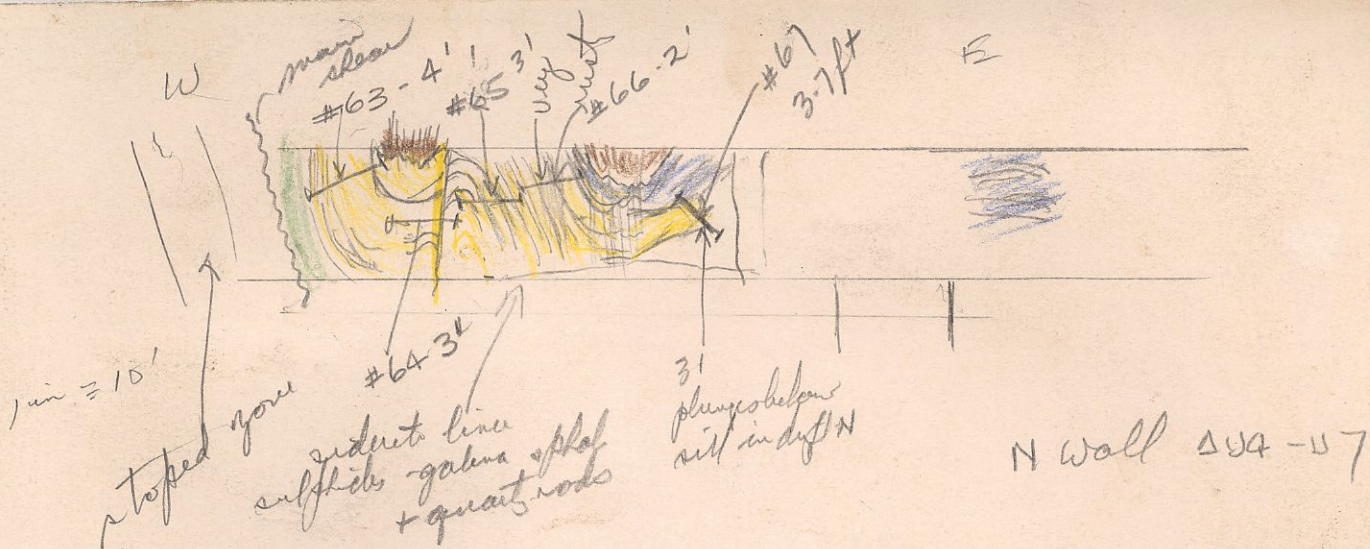

#64 high in sphal galena on ward
near shear lower lying schist
on E end.

Specimens F2-3

F2-4

of high grade for
this section near
sample #63 + #64.

355
15

60

754 483 2750

160
60

10

55

70

50

70

170

55

2

line of
grey schist
to fault
low dip to NW.

folded + grey schist
on sample

Mathew Miner
March 1962
New Hornil Silver
570 West Hastings ST
Vancouver B.C.

highly contorted grey schist overlain by
grey g.

PROPERTY FILE

In top of raise above 157 ls-schist
 contact 175/75°E block of quartz on W
 green schist on E on sub level below
 ls 5/55E shear from level 150/65E



#68-3 1/2 coarse sulfide
 galena sphal +
 siderite

70° raise + shear 48+10 above level.
 Sublevel 25' above level.
 This shear is in back of raise
 + is one on E side of drift below



main
lot + sidest
+ gaba

W
N
E

20/27 in face

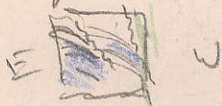

gg
selut

gg
a