

CORPORATE SHELLS WANTED. Mining or industrial. Charter reporting issuers preferred. Principals only. Reply Box 777, The Northern Miner.

Equipment for Sale

USED EQUIPMENT FOR SALE

- 2 - Atlas K Locos
- 3 - Eimco 12B
- 3 - IR XLE Compressors 400 H.P. 2000 cfm
- 1 - Link Belt LS 98 Crawler Crain
- Jaeger 350 cfm Portable Compressor - 200 H.P.
- GD Compressors 18 psi Trailer Mounted
- Lot four in. pipe
- Lot 20 lb. rail

Contact:

IN-CON Engineering Inc.
Tel. (416) 252-2219
Telex 06-984659 -
(PH BUS SVC TOR)

For Sale

only steel bins
30' dia. x 48' wall x 17' cone bottom
only Eimco drum filters
11'6" dia. x 16"
quantity of 3 cond. trail-
able #12 to 4/0. New and
steel pipe, victaulic
red, 2" to 16" with
ngs and fittings.
KVA diesel driven Gener-
trailers 2400/4160 volts
our used equipment
ments call Gerry or Bob
819-732-8818
8775
egault Metal Inc.
Amos, Que.

OISTS, Ball Mills, Crushers, ors, Conveyors, all sizes, best /m. Sims Industries Ltd., 758 wn Rd., Mississauga, Ont. 4-4983. tf

Hydraulic Jumbo Drills, pow- service and personnel trucks, vell Equipment Limited, 2018 y, Sudbury, Ont. P3A 4R7 -8190. tf

IT FIND IT, call Jerry Klein, in Steel & Mill Supplies, 650 Ave., Cote St. Luc, Que. 514) 488-6241 or 487-2022. g

MENT SALE. Kitchens 400, nan camps available, recrea- ine dry, helicopter kitchen, ars. Incinerators and misc. t. All equipment 1980 or good condition, reasonably ous inquiries only please. 23 or 964-2266 evenings. tf

ER DAY FLOTATION Mill- an be moved. Wm. Sims .td., 758 Southdown Rd., , Ontario (416) 272-4983. h

FOR SALE. Jet Piercing 200, crawler type, com- pressor, Gardner Denver model SP1200 CFM with 34TA generator package JKWD311. Good running uipment J.L., 2, 8 Avenue, le, Quebec J0S 1J0. 23. g

Conwayto Syndicate, owners of 60,000 acres he region. The ground has been farmed out to Bow Valley and Cominco for a total commitment of \$5.75 million on the Syndicate land.

Aber recently raised \$124,800 through a flow-through offering which will be used on three gold exploration projects in the N.W.T. A drill was recently moved to the company's Blackridge claim in the Hood River area and drilling is expected to begin immediately, the company says. Surface sampling returned 0.22 oz. gold over 30 ft. in a poorly mineralized zone. The discovery has never been systematically explored and is open in all directions.

Aber says reconnaissance mapping is planned for claims adjoining the Indin Lake discovery of Echo Bay Mines, adding an option has also been taken on a gold prospect 45 miles northeast of Yellowknife. Gold values there occur in a pyritic formation similar to Echo Bay's Lupin operation.

Windflower-Granges in joint venture

VANCOUVER - **Windflower Mining** has concluded a joint venture agreement with **Granges Exploration** on the **Goldfinch** property southeast of Revelstoke, B.C.

Granges has optioned the property for exploration expenditures totalling \$1.5 million plus cash payments of \$410,000 over the life of the agreement which runs five years.

At that point, Granges would have earned a 60% interest or higher, depending on Windflower's desire to stay in the venture. By declining to participate past that point, Windflower would be reduced to a 20% net profits interest.

Exploration is scheduled to begin there immediately and Windflower notes that a previously drilled hole returned 0.73 oz. gold over 11 ft. in 1976. Windflower itself plans an exploration program shortly on a gold property near Burns Lake, B.C.

People

CANADA TUNGSTEN - Wayne Lenton appointed president and chief executive officer, succeeding James Foreman who has resigned.

INTERNATIONAL PRECIOUS METALS INSTITUTE - Sebastian P. Musco elected president for 1985-86 at its 9th annual conference held recently in New York City.

TERRA MINES - Larry E. McDannold appointed director; Garry M. Paul...

obtained in earlier work.

There is a theory regarding the Hemlo camp that the Golden Giant mine is on one edge of synclinal structure that could be repeated to the north. Noranda, it seems, is not ready to give up that Pryme area yet although it may reduce the size of the total claim group in which it has an interest by returning some of the ground to Pryme and **International March Resources** under terms of the original option agreement.

Noranda drilling Phoenix tailings

VANCOUVER - A grade evaluation is under way on mill tailings from the old Phoenix mine near Greenwood, B.C. The work is being conducted by **Noranda Exploration** which has the option to earn a 51% interest with joint venture partner **Kettle River Resources** holding the balance.

A number of closely spaced 2-in.-diameter drill holes will be utilized to test the tailings which were produced from 1959-62 when the highest grade copper-gold ore was mined from the old Phoenix pit. There was no gold recovery system installed at the time and it is estimated only 60% of the metal was recovered in flotation concentrate. Besides drilling, a number of test pits will be excavated and a bulk sample submitted for metallurgical work to determine recovery methods.

Some 4.6 million tons of tailings are believed to exist on the property and a Kettle River spokesman says discovery of an acceptable recovery system could see production and some cash flow by 1986.

Meanwhile, drilling on the Canbec property near Greenwood has been halted because of the forest fire situation in the region. **Canbec Resources** has a 40% interest, Noranda 30.6% and Kettle River 29.4%.

One hole has been completed so far and a second was stopped when the fire hazard became too extreme. Several more holes are planned to test the down dip extension of the Marshall zone where gold-bearing sulphides are known to exist.

Noranda has partially completed a mapping program along with several hundred feet of trenching and is awaiting assay results.

Troymin Resources exploration results

Results from a preliminary exploration program for gold on a 2,770-acre property near Star Lake, Man., are expected by **Troymin Resources** of Calgary to be in by the end of August.

... mine.
I. H. M. Duluth, Minn.

Sapaw **003982** after was revived ld prices were at an all-time high, and extensive underground exploration was done on its former gold producing property near Atikokan, Ont.

Nothing of economic grade was detected, however. Sapawe is now dormant and its stock has not traded since a 1974 cease trading order, which is still in effect, was issued.

Sapawe did, however, lease its Atikokan property to **Atiko Gold Mines**. Atiko is now attempting to do some financing in order to take another look at the property. If it meets with success, there could be some royalty payments down the road for Sapawe.

There is a strong but highly erratic gold vein system on that Atikokan ground, so don't throw away those Sapawe share certificates just yet.

Work begins at Galactic

VANCOUVER - Construction work is under way at **Galactic Resources'** Summitville property in Colorado towards a production start in May, 1986.

Against a backdrop of low gold prices and generally depressed equity markets, the company managed to raise approximately \$23.5 million recently through the sale of common stock, warrants and three series of debentures.

It also has a financing commitment from the Bank of America for \$US25 million, which would probably be used to expand the project at a later date.

The company has ambitious plans for the heap leach property and is projecting no less than 125,000 oz. of gold production next year, at an operating cost of \$US165 per oz. which The Northern Miner gathers is well below the industry average for heap leaching.

Bechtel Civil and Minerals has a \$US19-million engineering, procurement and construction contract for the project, including crushing facilities, conveyors, stacker, leach pad circulating system, recovery plant and related facilities at a fixed price.

The performance guarantee referred to by Galactic in the past appears to be more a performance bonus awarded to Bechtel if it meets projected design parameters.

The construction phase is scheduled for completion by mid-March next year, with actual gold production starting about...

GRANGES EXPLORATION LTD. (GXL-T, Amex, London)

WINDFLOWER MINING LTD. (WFL-V)

DOROTHY RESERVES 150,000 TONNES 0.24 OZ. GOLD/T, 8.2 GRAMS

NEW DOROTHY NORTH ZONE ASSAYS OVER 80 M. STRIKE LENGTH

<u>HOLE NO.</u>	<u>LENGTH</u>	<u>OZ. GOLD/T</u>
117	15.95 ft.	0.15
120	15.25	.25
also	10.43	.35
126	11.85	.34

G.C.N.L.

NEW DRILL HOLE ASSAYS FROM EAST ZONE.

132 3.28 2.7

140 Significant intersection in for assay

A \$3,000,000 underground program of drifting, raising, bulk sampling and a metallurgical mill test will start immediately on the Goldfinch gold property 30 miles southeast of Revelstoke, B.C., which is owned by Granges 60%, the operator, and Windflower 40%.

The companies have reported new reserves and drill hole results from the Dorothy vein and the East zone. See table above.

82KNW076,073

Surface drilling has indicated promising results from two additional mineralized zones, both of which will add substantially to the potential of the property. Drilling to date on the Dorothy, Dorothy North and East zones indicate in the order of 100,000 ounces of gold available to underground mining, with additional potential along strike of the major structure which runs for 6 km across the property.

NOV 23 1987

The Dorothy North zone appears to be a separate and distinct zone occurring 100 meters north and along strike of the original Dorothy discovery. The companies expect that with further drilling the Dorothy North could easily carry another 150,000 tonnes of similar 0.24 oz. gold per ton grade.

224

The East zone is en-echelon quartz veining that is characterized by low sulphide content but carrying high grade visible free gold averaging 1.0 oz. gold per ton, containing at least 20,000 ounces with a considerable potential. The strike length is 100 meters and open and drilled to at least 80 meters below surface. Closer spaced drill testing from surface and underground is required to establish an accurate ore reserve.

In other areas of the property, a number of holes were drilled between ore zones and, although they intersected quartz veining, only low grade mineralization was encountered.

Metallurgical bench tests on samples from previous drilling indicated in excess of 90% recovery of gold content. Additional on-site pilot mill testing on large bulk samples from underground development will be done to confirm the results.

Windflower Mining Ltd WFL
 Shares issued: 3,529,500 Nov 24 close: \$1.30
 News Release

Granges Exploration Ltd (GXL) S.W.
 Messrs G. Ryznar and Mike Muzylowski report:

The companies will proceed immediately into the next stage of exploration on their joint venture Goldfinch property located southeast of Revelstoke, BC. This next stage will consist of underground development work, bulk sampling, and mill testing of ore in preparation for future production. Costs for this stage of exploration and development are estimated to be in the order of \$3,000,000.

Surface drilling to date has confirmed ore reserves on the original discovery zone, the Dorothy vein at 150,000 metric tons at .24 oz/ton, and has indicated very promising results from two additional mineralized zones, both of which will add substantially to the potential of the property. Results of the drilling to date on the combined Dorothy, Dorothy North and East zone now indicate in the order of 100,000 oz of gold available to underground mining, with additional potential along strike of the major structure which runs for 6km across the property.

The Dorothy North zone appears to be a separate and distinct orebody occurring 100m north and along strike of the original Dorothy North could easily carry another 150,000m tons of similar grade to the main Dorothy zone. The following drill hole intercepts are from the Dorothy North zone and occur over a strike length of 80m. The zone is still open along strike and at depth.

DRILL HOLE No.	INTERSECTION Ft	GOLD oz/t
117	19.95	.15
120	15.25	.25
and	10.43	.35
126	11.85	.34

At the present time additional drill testing from surface is continuing on the East zone as well.

This is a zone of en-echelon quartz veining that is characterized by its low sulphide content but commonly carrying high grade visible free gold. The latest intersection from the zone is as follows:

DRILL HOLE No. Ft	INTERSECTION Oz/T	GOLD
132	3.28	2.7

More recent reports from the field indicate that drill hole No. 140 has returned another significant in the East zone and assays will be released when available.

With grades averaging approximately 1.0 oz gold/ton this East zone now appears very significant. It is expected that a reserve from this zone alone, of at least 20,000 oz of gold. Strike length is now in the order of 100m, and the intersection of drill hole No. 140 mentioned above now establishes a down dip extent of at least 80m. Closer spaced drill testing from surface and/or from underground is required to establish an accurate ore reserve.

A number of drill holes were drilled in between ore zones and although they intersected quartz veining, only low grade gold mineralization was encountered. Although assays are still not available from these holes only narrow mineralized intersections were encountered. More problematic, however, is the fact that the drilling indicated the mineralized zone to be cut off by a fault, thus limiting its extent. More detailed geological study of the Scott Creek zone now required.

Metallurgical bench tests on samples from previous drilling indicated in excess of 90% recovery of gold content. Additional on-site pilot mill testing on larger bulk samples from underground development will be done to confirm the above noted results.

82K/W073,074

Windflower Mining Ltd WFL
 Shares issued: 3,529,500 Nov 27 close: \$1.57
 News Release

Mr G. Ryznar reports: S.W.

Drill Testing by Granges Exploration Ltd. on the Goldfinch property, located near Revelstoke, BC continues to return excellent results. The latest reported intersection from the Dorothy vein is as follows:

HOLE No.	INTERSECTION	OZ AU/TON
132	16.40 ft	.47
	6.6 ft	.17

This is a rather significant drill hole as it intersects the Dorothy vein at a vertical depth of 328 ft below surface, in an area where it was previously thought that the ore zone was bottoming out.

Windflower Mining Ltd

Shares issued: 3,334,500

WFL

Sep 16 close: \$2.65

News Release

Mr G. Ryznar reports:

9/17/87

The company reports the following progress on the company's Goldfinch Property located near Revelstoke, B.C. and currently being drill tested by Granges Exploration Ltd. under the terms of a joint venture agreement.

Drill hole assays from drill hole No 93 are: intersection-4.9 ft; gold assay-1.48 oz/ton.

This intersection confirms and extends the high grade east zone some 196 feet south of drill hole no. 42 which was drilled in 1986 and returned values of 32.26 grams/tonne or .94 oz gold/ton across a 25 feet interval. A total of 7 drill holes have now intersected this eastzone which now appears to have a strike length of at least 328 feet. Further drill testing may well extend this strike length considerably. 82KNW076

The high grade east zone is parallel to, but separate and distinct from the main sulphide rich dorothy vein on which most of the drilling has been done to date. It is characterized by vein quartz commonly bearing visible free gold, generally of relatively high grade. The arithmetic average of the grade from the seven drill holes in the zone is .91 oz gold/ton over an average width of approximately 2 metres.

Drilling is also continuing on the extreme south end of the main zone, on section 60S with excellent results. The latest assays received from this location are as follows: drill hole No 94; intersections 2.5 feet and 2.14 feet; gold assays .283 oz/ton and .454 oz/ton.

Drill testing is continuing with three drill on the property. It is expected that drilling will continue until mid November. In addition, Granges Exploration Ltd and the company are holding discussions with local mining contractors with respect to underground testing and development on the property.

Granges/Windflower plan \$3-million work program

VANCOUVER — A \$3-million underground exploration program is planned by Granges Exploration and Windflower Mining on their Goldfinch property near Revelstoke, B.C. Granges President Michael Muzylowski believes there could be "a small mine there," suggesting that a milling rate of 200 tons per day might be viable.

Expenditures will be shared 60/40 by Granges and Windflower and the program will run through the winter months. The program will involve about 1,800 ft of underground development and both companies have ample working capital to fund the work.

The Main or Dorothy ore zone will be reached by what he describes as a "form of decline." Once access is achieved, parallel drifts will be established in both the Main and East zones, of which the latter grades approximately 1 oz gold per ton. Muzylowski claims this higher grade zone "will pay for everything," noting there are about 25,000 tons in this area.

The Main zone, which grades approximately 0.25 oz, varies in width from 5-30 ft but averages 10-12 ft, he says. The smaller East zone, which Muzylowski points out "now appears very significant" averages about 6.5 ft. N.M.

Surface drilling has outlined a reserve of 165,000 tons grading 0.24 oz in the Dorothy vein, the original discovery zone. In addition, Muzylowski confirms that drilling has indicated "very promising results from two additional mineralized zones, both of which will add substantially to the potential of the property." NOV 30/87

Exploration work to date on the combined Dorothy, Dorothy North and East zone has blocked out approximately 100,000 oz of gold, all of which is amenable to underground mining. Additional potential exists along a major structure which runs for over 3.5 miles across the property.

Muzylowski expects the Dorothy North could easily carry another 165,000 tons of 0.25-oz material because it is still open along strike and to depth. Recent drill results from this zone included: 15.9 ft of 0.15 oz, 15.3 ft of 0.25 oz, 10.4 ft grading 0.35 oz and 11.9 ft of 0.34 oz.

Drilling is continuing in the East zone which has extensive enechelon quartz veining characterized by low sulphide content and sometimes visible gold. One recent intersection returned 3.3 ft of 2.7 oz; the zone has a strike length of 325 ft and a dip extension of 260 ft.

Reserves there are estimated to be about 20,000 oz. "However, closer-spaced drill testing from surface or from underground is required to establish an accurate ore reserve," he adds.

Muzylowski says the joint venture has access to a pilot mill which will be used to process material from the underground program. Preliminary metallurgical test work has indicated an over 90% recovery rate for the gold. Besides providing a good bulk sample, the underground program will determine ground conditions and the continuity of the zones which for the most part have been defined by fairly close-spaced drilling, he notes.

82KNW073,076

GCNL 172

HOLE #87-U-2
#4A Vein

K-2 RESOURCES INC. (KTR-V) Sept 8/87

82KNW076 (?) [or 82KNW095 (?)]

From	To	Width	Oz. Gold/t	Oz. Silver/t	Lead%	Zinc%
131	134.5	3.5'	.001	2.13	7.42	9.51
134.5	137	2.5	.048	15.98	15.16	19.38
combined values		6.0'	.02	7.9	7.42	9.51
#4 Vein						
263.25	267.2	4.0'	.232	14.67	12.98	13.11

K-2 Resources president Bryan Glen has reported assays from hole 87-U-2 on the Camborne-Revelstoke, B.C. property. Assays are awaited from holes 87-U-4 through 87-U-6. Hole 87-U-7 is now being drilled and will be followed by 87-U-8/87-U-9. Phase two deeper drilling will be depend on results.

The tailings pond drilling is 50% complete and samples are in for assay. Tailings are estimated to total 100,000 to 140,000 tons. (SEE GCNL No.136)

Windflower extends zone on B.C. Goldfinch prospect

VANCOUVER — Drilling has extended the high grade East zone at Windflower Mining's Goldfinch property near Revelstoke, B.C. The property falls under an option agreement with Granges Exploration, the operator for the program.

Hole No 93 returned 4.9 ft of 1.48 oz gold in the East zone. This zone is parallel to, but separate from, the main sulphide-rich Dorothy vein where drilling has largely been concentrated to date. The new zone is characterized by vein quartz commonly bearing free gold with generally high grades and the arithmetical average of the seven drill holes is 0.91 oz gold over an average width of 6.5 ft.

According to Gerald Ryznar, Windflower's president, the zone was actually encountered by accident last year. They were drilling into the main zone and hit the structure while doing so. The East zone has been extended 196 ft south of drill hole No 42 which was completed in 1986 and returned values of 0.94 oz gold across a 25-ft interval. He notes that seven holes have now intersected the zone which appears to have a strike length of at least 328 ft. "Further drill testing may well extend this strike length considerably," he predicts.

Drilling is under way on the extreme south end of the Main

zone where hole No 94 returned 2.5 ft of 0.28 oz gold and 7.0 ft of 0.45 oz. Mr Ryznar says this hole is almost 1,000 ft south of No 93. Granges and Windflower are discussing an underground exploration and development program with local contractors. An old mine tunnel exists on the property which would probably be slashed out and extended, he says. This would allow close-spaced drilling from the underground to firm up reserves for a production decision.

82KNW073,076
N.M. 9/28/87

K-2 Resources Inc

Shares issued: 1,836,468 Aug 12 close: \$1.50
News Release

KTR

Mr Bryan Glen reports:

SW

Assays have been received from the first drillhole in the company's underground drilling program below the 10 level (lowest mined level) on the Camborne property. 82KNW076
Hole 87-U-1 cut the mineralized zone near the bottom of the known reserve in the old mine workings. In drilling to intercept the No. 4 vein (main target) the vein known as the 4A vein was intersected between 141.75 feet and 146 feet. This vein is 100 ft. in the hanging wall of the No. 4 vein and assayed .001 oz Au ton, .51 oz Ag ton, 16.79% Pb and 6.76% Zn.

Hole 87-U-2, 50 feet above 87-U-1, cut the No. 4 vein from 263.25 ft to 267.25 ft. Hole 87-U-3 is a flat hole above the 10 level and was designed primarily to seek an upward extension of the 4A zone. It did not produce significant mineralization. Hole 87-U-4 is 50 ft. southwest, and below 87-U-1 and cut the No. 4 vein from 374.75 ft. to 381.25 ft. Assays are pending for holes 87-U-2 through 87-U-4.

Drilling is now in progress with hole 87-U-5 below and northwest of 87-U-1, and further holes are planned.

The good results from the No. 4 vein intersection demonstrate that the No. 4 vein is open at depth and carries good mineralization. Further deeper drilling is expected to define and expand the known reserves. Having already added to K-2's known reserve, the company is optimistic that the drilling program will continue to produce good results from phase I of the program.

K-2 Resources Inc

Shares issued: 1,836,468 Aug 13 close: \$1.50
News Release

KTR

Mr Bryan Glen reports:

Assays have been received from the first drillhole in the company's underground drilling program below the 10 level (lowest mined level) on the Camborne property.

SW

Hole 87-U-1 cut the mineralized zone near the bottom of the known reserve in the old mine workings. In drilling to intercept the No. 4 vein (main target) the vein known as the 4A vein was intersected between 141.75 feet and 146 feet. This vein is 100 ft. in the hanging wall of the No. 4 vein and assayed .001 oz Au ton, .51 oz Ag ton, 16.79% Pb and 6.76% Zn.

The hole 87-U-1 continued and had an excellent 8.5 foot intersection in the No. 4 vein. This is the primary target of the 1987 drill program and assayed at .20 oz Au ton, 16.34 oz Ag ton, 16.79% Pb and 15.73% Zn. 82KNW076

Hole 87-U-2, 50 feet above 87-U-1, cut the No. 4 vein from 263.25 ft to 267.25 ft. Hole 87-U-3 is a flat hole above the 10 level and was designed primarily to seek an upward extension of the 4A zone. It did not produce significant mineralization. Hole 87-U-4 is 50 ft. southwest, and below 87-U-1 and cut the No. 4 vein from 374.75 ft. to 381.25 ft. Assays are pending for holes 87-U-2 through 87-U-4.

Drilling is now in progress with hole 87-U-5 below and northwest of 87-U-1, and further holes are planned.

The good results from the No. 4 vein intersection demonstrate that the No. 4 vein is open at depth and carries good mineralization. Further deeper drilling is expected to define and expand the known reserves. Having already added to K-2's known reserve, the company is optimistic that the drilling program will continue to produce good results from phase I of the program.

WINDFLOWER MINING LTD. (WFL-V) GCNL

HIGH GOLD ASSAYS REPORTED - Windflower Mining Ltd. has reported drilling by 82KxW076, 073 GRANGES EXPLORATION LTD. on the Goldfinch property near Revelstoke, B.C. returned one of the highest grade intersections drilled to date. Drill Hole #72, cut 18.2 ft., true width 13.1 ft. assaying 2.48 oz.gold/ton. Much of the gold in this drill core occurs as free gold in a carbonate rich zone within the main quartz vein system. A 1 ft. section assayed 37.0 oz.gold/ton.

Drill holes 73 to 79 have intersected low values over narrow widths. These holes were drilled on the periphery of the ore zone where problems in tracing the mineralization have been encountered previously. Hole #75, returned 2.4 ft. grading 0.19 oz./ton. Mineralized vein quartz has been intersected in Drill Hole #80, which may indicate the zone opening to the south. Assays will be available soon

K-2 RESOURCES INC. (KTR-V) GCNL

DRILL PROGRESS NEAR - K-2 Resources Inc. completed 2600 REVELSTOKE REPORTED feet of surface diamond drilling 82KxW076 covering 9 exploration zones at their K-2/Camborne Camp property near Revelstoke, B.C., in June. At least 2 holes will require follow-up drilling with 2 more zones requiring further drilling, depending on assay results.

Underground diamond drilling started on July 7 with a view to adding to the existing reserve of No.4 vein.

Hole 87-U1 cut what is believed to be the 4A vein zone in the hanging wall of No.4 vein at a depth of 128 feet and continuing intermittently to 135 feet. The veining indicates good mineralization and is in for assay. A 4-foot vein, intersected from 142 to 146 feet carries substantial sphalerite, galena and pyrites and appears to be a significant intersection. The core is being split for assay. Hole 87-U1 will continue to a planned depth of 300 feet to intercept its primary target, No.4 vein, below the 10 level.

Seven more underground holes, to a depth of 300 to 400 feet, will complete the first underground phase. Deeper drilling may possibly be called for after evaluation of Phase I results.

WINDFLOWER MINING LTD. (WFL-V) GCNL

NEW ZONE DISCOVERED - Gerald Ryznar, P.Eng., president 82KxW076 of Windflower Mining Ltd., has reported discovery of a new mineralized zone of quartz-carbonate vein and quartz stockwork along Scott Creek, some 500 metres north of the gold bearing quartz vein presently being drilled. The Goldfinch property is 50 km southeast of Revelstoke B.C. The dimensions of the new zone are impressive, extending for a strike length of 500 metres with widths generally 3 to 4 metres and occasionally as wide as 10 metres. Assays of grab samples and narrow chip samples have varied from 0.09 oz. to .78 oz.gold/ton). Preparations are underway for an immediate program of surface trenching prior to diamond drill testing. (See GCNL NO.145, P.1 for recent assay results from drilling on the Goldfinch main zone.

Windflower Mining Ltd
Shares issued: 3,334,500

WFL
Jul 28 close: \$3.10
News Release

Granges Exploration Ltd (GXL)

Mr. Gerald Ryznar reports:

Windflower advises that recent drilling by Granges Exploration Ltd. on Windflower's Goldfinch property near Revelstoke, B.C. returned one of the highest grade intersections ever drilled on the claim group. Drill hole No. 72, a fill-in hole at about section 231 N assayed as follows:

82KxW076

DRILL HOLE NO.	LENGTH OF INTERSECTION (FEET)	TRUE WIDTH (FEET)	GOLD ASSAY OZ./TON
72	18.2	13.1	2.48

Much of the gold in this drill core occurs as free gold in a carbonate rich zone within the main quartz vein system. A 0.3 meter (1 foot) section of core assayed as high as 1270 grams/tonne (37.0 oz gold/ton).

Drill holes 73 to 79 have intersected only low values over narrow widths, however, these holes were drilled on the periphery of the ore zone where problems in tracing the mineralization have been encountered previously. For example, drill hole No. 75, drilled on section 430 N returned a 0.72 meter (2.4 foot) intersection grading 6.42 grams gold per tonne (0.19 oz/ton). Nevertheless, latest field reports indicate that mineralized vein quartz has been intersected again in drill hole No. 80, which may be an indication of the zone opening to the south. Assays from this hole will be made available as soon as possible.

WIN MAY 87

Windflower mobilizes drill crew

REVELSTOKE, BC—Windflower Mining Ltd. (VSE-WFL) is mobilizing a diamond drill crew in preparation for the 1987 exploration season on the 6,000-acre Goldfinch property 25 miles southeast of Revelstoke in southeast British Columbia.

Three drills are to be used in a 15,000-foot drill program to further evaluate structures delineated in last year's successful exploration work. With joint venture partner Granges Exploration Ltd. (TSE-GXL), the companies completed 61 holes totalling 20,231 feet in 1986. From the drill data to date, ore reserves are conservatively estimated at 200,000 tons averaging 0.30 ounces of gold per ton between surface and the 330-foot level. Gerald Ryznar, president of Windflower, says the potential for adding to these reserves along strike and at depth is considered high.

The gold-bearing structure is known to continue for some 1,150 feet along strike with lower grade intercepts continuing for over 400 feet to the north and 330 feet south along strike. The mineralization is open in both directions.

Reserves on the main deposit (Main Zone or Dorothy Vein) are contained in a sulphide-rich quartz vein cutting the stratigraphy and schistosity of the host Lardeau Group sediments. The zone strikes north-west/southeast with the dip nearly vertical. Situated at an elevation of approximately 3,500 feet, the area is accessible south from Revelstoke or north from Nakusp by all-weather roads.

Located 40 to 100 feet east of the Main Zone is a high-grade quartz vein known as the East Zone that contains considerable visible gold in association with minor disseminated pyrite, galena, sphalerite with a trace of chalcopyrite. Also another quartz vein with significant gold values across

narrow widths was intercepted at depth in a number of drill holes some 40-60 feet west of the Main Zone.

Ryznar says a feasibility study is in progress and contingent on results, an underground exploration and development program on the Main Zone may be undertaken in the latter half of 1987.

82KNW073
076

SW June 25, 87
Windflower Mining Ltd WFL
Shares issued: 3,334,500 Jun 24 close: \$2.65
82KNW076
Granges Exploration Ltd (GXL)
News Release

Mr. Gerald Ryznar reports:
Granges Exploration Ltd. has advised that diamond drilling on Windflower's Goldfinch property, located southeast of Revelstoke, B.C., is now underway. The first diamond drill hole of this year's program, drill hole 69, is presently drilling at a depth of approximately 243 meters (800 feet), and is almost completed. The drill hole is located on section 253N and is designed to test continuity of ore between wider spaced ore grade intersections obtained in the 1986 drill program. Field reports indicate promising looking intersections of vein quartz with associated sulphides from at least two different zones. Assays will be released as soon as results are available. Another diamond drill is presently in transit to the property and is expected to be drilling soon.

New zone find for Windflower

Exploration crews on Windflower Mining's Goldfinch property in the Revelstoke division of British Columbia have discovered a new mineralized zone of quartz-carbonate vein and quartz stockwork along Scott Creek, some 500 m north of the gold-bearing quartz vein currently being drilled, President Gerald Ryznar says.

The new zone extends for 500 m with widths generally 3-4 m and occasionally as wide as 10 m, he says. To date significant gold values have been obtained from surface samples along more than 100 m. Assays of grab samples and narrow chip samples have varied from 3 g to 26.7 g (0.09 oz to 0.78 oz) per ton.

Preparations are under way for an immediate program of surface trenching prior to diamond drill testing, Mr Ryznar says.

N.M.

82KNW076

Windflower Mining Ltd WFL
Shares issued: 3,334,500 Jul 31 close: \$2.90
GOLDFINCH
Mr. Gerald Ryznar reports: 82KNW076
News Release

The company announces that exploration crews on Windflower's Goldfinch property have recently discovered a new mineralized zone of quartz-carbonate vein and quartz stockwork along Scott Creek, some 500 meters north of the gold bearing quartz vein presently being drilled.

The dimensions of the new zone are impressive, extending for a strike length of 500 meters with widths generally 3 to 4 meters and occasionally as wide as 10 meters. To date significant gold values have been obtained from surface samples along more than 100 meters of the structure. Assays of grab samples and narrow chip samples have varied from 3 grams to 26.7 grams gold/tonne (0.09 oz to 0.78 oz/ton). Preparations are underway for an immediate program of surface trenching prior to diamond drill testing. This new mineralized zone could have major implications in increasing the potential of Windflower's Goldfinch property.

SW

GCNL 127 WINDFLOWER MINING LTD. (WFL-V) JUNE 25/87

* GRANGES EXPLORATIONS LTD. (GXL-T, American, London)
FIRST 1986 DRILL HOLE - Gerald Ryznar, P.Eng., president of Windflower Mining Ltd., reports being advised by Granges Exploration Ltd. that diamond drilling on Windflower's "Goldfinch" property, located south-east of Revelstoke, B.C., is now underway. The first diamond drill hole of this year's program, Hole 69, is drilling at a depth of 243 metres (800 ft.), and is almost completed. The hole is located on section 253 N and is designed to test continuity of ore between wider spaced ore grade intersections obtained in the 1986 drill program.

Field reports indicate promising looking intersections of vein quartz with associated sulphides from at least two different zones. Another diamond drill is presently in transit to the property and is expected to be drilling soon.

82KNW076

82K/13E

Three drills now testing Granges' B.C. gold bet

VANCOUVER — Probably better than most companies, Granges Exploration recognizes the importance of a drill hole. That fact alone best explains why the company will complete 15,000 to 20,000 ft of drilling this year on Windflower Mining's Goldfinch property near Revelstoke, B.C. At this early stage, the property has the earmarks of at least a **small producer, a hypothesis** that could be proven out by year-end.

Granges originally planned 3,500 ft of drilling this season but results have been so encouraging that it has added another two drills. The three drill rigs are testing a major shear-fault structure that runs for at least 1,650 ft along strike and hosts gold in at least three separate lenses. Two of these zones are approximately 325 ft apart and drilling recently picked up a third and deeper zone.

The latest results included final assay confirmations on hole WIN-42 which returned 33.5 ft grading 0.73 oz gold including 5 ft of 4.3 oz. Hole WIN-49 returned 25.8 ft grading 0.22 oz gold including 12.3 ft averaging 0.3 oz. A 15-ft intercept in WIN-41 averaged 0.2 oz which included 3 ft of 0.48 oz and WIN-44 gave 18 ft grading 0.18 oz including 5 ft averaging 0.38 oz. All these are core lengths because it's difficult to accurately determine true widths on a consistent basis owing to the changing dip of the vein structures. They dip from 50° to vertical and occasionally reverse dip and pinch and swell along strike, notes Granges.

82KNW073, 076

Generally widths vary from 6-10 ft and sometimes from 20-33 ft according to George Zbitnoff, Granges' vice-president exploration. Vein material is generally gold-bearing but higher grade values occur in shoots which is typical for this type environment. There is a tremendous amount of silicification in the area, notes Windflower President Gerald Ryznar, so the potential for expanding reserves is substantial.

Gold values have been found in 80% of the holes and the structure has been tested across 1,000 ft of strike and to a depth of approximately 500 ft. Hole spacing has been 100 ft but Granges has been "filling in the gaps" with close-spaced holes in order to assess tonnage and grade more accurately.

Some metallurgical test work is planned this winter and initial indications show the gold is associated with sulphides (pyrite, chalcopyrite) although some of it occurs in the free state. There is no arsenopyrite, so flow sheet design would be fairly straight-forward.

The geological staff have not found any large intrusive in the region which could be the source of the gold but they haven't ruled out finding one eventually. The prospect is located on a major regional break and Granges points out that geophysics has not been much help as an exploration tool because of graphite in the host rock, so drilling has really told the story.

Mr Zbitnoff feels the project has a better-than-50-50 chance of being a producer and he argues they have "barely scratched the surface" of the project area. There is good road access right to the drill site and property elevation is approximately 3,500 ft. The company will keep drilling until weather conditions drive them out which should be by year-end.

GRANGES EXPLORATION LTD. (GXL-T, Amex, London)

NOV 27 86
WINDFLOWER MINING LTD. (WFL-V) NOV 26/86

HOLE NO.	INTERCEPT	GRAM/TONNE	OZ. GOLD/TON
64	6.6 Ft.	6.8	.2
	4.9	3.23	.094
	-	2.55	.074
65	6.56	11.8	.344
including	3.28	14.9	.435
66	5.5	15.04	.439
67	5.2	3.67	.107
55	1.3	1.22	.036

FINAL ASSAY RESULTS FROM GOLD - Granges Exporation FINCH PROJECT FOR 1986 SEASON Ltd. and Windflower Mining Ltd. have

reported assays from five additional holes on the Revelstoke Goldfinch property. Drill Hole #64 intersection is significant as it confirms the presence of the east zone, which is known for its frequent occurrence of high grade gold values (e.g. Drill Hole #57 intersected 267 grams gold/tonne (7.79 oz./ton) over .20 meters). This eastern zone has now been traced by surface drilling for some 100 metres (328 ft.) along strike and to a vertical depth of 70 metres (230 ft.) below surface. Drill Hole #65, another test of the eastern-most structure, drilled below drill Hole #61.

Drill Hole #66, a "fill-in" hole on section 230N returned gold assays from the main zone at a vertical depth of 70 m (230 ft.). Drill Hole #67 drilled on section 365N intersected the Main Zone. Drill Hole #55, was drilled on section 480N at the extreme north end of the Zone. This northerly hole did not intersect the main mineralized horizon due to a possible strike change.

Drilling on the property has now been suspended for the season. Metallurgical testing and engineering studies will be continuing and plans for next season's program will be formulated. (See Previous assay result in GCNL NO.217, 212 and 209).

N Miner Mar 9/87 82KNW076

Windflower's Goldfinch Property has Mine-Making Potential

VANCOUVER — Granges President Mike Muzykowski is considering an underground exploration program to further explore the continuity of gold mineralization on the Windflower Mining Ltd. Goldfinch property, 45 miles SE of Revelstoke, B.C. A successful 60-hole drilling program during 1986 indicated 200,000 tons grading 0.30 oz. gold per ton. Granges will earn a 60% interest in the property by spending Cdn. \$1,500,000 on exploration by 1988 (Cdn. \$1,000,000 expended to date). Windflower will retain a 40% participating interest.

The main vein system has a strike length of over 1,300 ft. with widths varying from 6 to 30 ft.

and grades averaging 0.09 to 1.04 oz. Au per ton. The gold zone is open at depth. (A 33 ft. intersection averaged 0.465 oz. Au per ton.)

Granges will activate a major exploration program in April/May 1987. The gold zone has only been tested to a shallow vertical depth of 300 ft. The focus of the 1987 program is to establish continuity of the zone below 300 ft.

The shear structure which hosts the deposit is 6 km. long. Several additional gold targets were located and will be tested in 1987.

A metallurgical study is underway to determine gold recovery.

GCNL #202 21 OCT 1986

GRANGES EXPLORATION LTD. (GXL-T, AMEX, London)

WINDFLOWER MINING LTD. (WFL-V)

HOLE	LENGTH OF INTERSECTION	GOLD ASSAY
WIN 41	4.58 m 15ft.	6.851 grams/tonne, 0.20 oz/t.
includes	0.92 3	16.300 0.475
WIN 42*	10.21 33.5	24.87 0.725
includes	1.52 5	147.72 4.3
WIN 43	1.52 5	10.506 0.306
WIN 44	5.48 18	6.024 0.176
includes	1.52 5	13.128 0.383
	0.61 2	6.575 0.192
WIN 47	0.95 3.1	4.13 0.120
WIN 49	7.85 25.8	7.456 0.217
includes	3.76 12.3	10.190 0.297

AMONG MORE GOOD ASSAYS IS ONE - George Zbitnoff, vice OF 0.725 OZ.GOLD/T OVER 33.5 FT. president of Granges Exploration Ltd. and Gerald Ryznar, P.Eng., president of Windflower Mining Ltd. report more assays from Windflower's Goldfinch property which Granges is diamond drilling. The property lies 45 miles SE of Revelstoke, B.C. The drill test began this past July and is continuing with 3 drills on the property. This work has traced a mineralized gold-bearing vein structure for some 300 metres (about 1000 feet) of strike length with widths commonly from 1.8 to 3 m (6 to 10 ft.) up to 6 to 10 m (20 to 33 ft.).

Final assay confirmations on samples from Drill Hole WIN 42 have now been received and have increased the preliminary assay's previously announced intersection of 33.5 feet from 0.465 to 0.725 ounce gold per ton.

GRANGES EXPLORATION LTD. (GXL-T, Amex, London) 12 NOV 86

WINDFLOWER MINING LTD. (WFL-V) GCNL 217

HOLE NO.	INTERCEPT	GRAM/TONNE	OZ. GOLD/TON
NO.59	2.7 ft.	4.32	0.126
	2.16	3.18	0.093
	1.0	1.14	0.033
	3.28	1.66	0.048
NO.61	17.6	7.98	0.233
including	8.73	14.27	0.416
Second Intercept	6.76	48.17	1.405

FURTHER HIGH GRADE - George Zbitnoff, vice president GOLD VALUES REPORTED exploration, Granges Exploration Ltd., and Gerald Ryzner, P.Eng., president of Windflower Mining Ltd., report assay results from the drilling program on Windflower's Revelstoke property. Drill hole #61 intersected the main mineralized zone below Hole #51 at a vertical depth of 110 metres (360 ft.) and intersected another parallel structure east of the main zone.

It now appears that this 6.76 foot high grade intersection of 48.17 grams may be the down dip extension of a previously released intersection in drill hole #42 which assayed 15.95 grams/tonne (0.465 oz/ton) across 10.21 metres (33.5 ft.).

Drilling is continuing to establish continuity of the zones along strike and down dip. (See also GCNL NO.212, P.1, Nov.4/86 and No.209, P.1 Oct.30/86).

GCNL #209 30 OCT 1986

GRANGES EXPLORATION LTD. (GXL-T, AMEX, London)

WINDFLOWER MINING LTD. (WFL-V)

FURTHER GOLD - George Zbitnoff, vice-president ASSAYS REPORTED exploration, Granges Exploration Ltd., and Gerald Ryznar, P.Eng. president of Windflower Mining Ltd., report that diamond drilling, now continuing with 3 drills on the north extension of the main mineralized zone on Windflower's property 45 miles SE of Revelstoke, B.C., indicates gold mineralization as far north as grid 480N. This gives the gold bearing zone a strike length of at least 420 meters (1378 feet). Visible gold has recently being reported from 3 of the most northerly drill holes in which mineralized intersections of from 0.20 to 1.5 meters (5 ft.) have been encountered. Assay results now available are shown in the table.

SECTION	HOLE	INTERCEPT	GOLD ASSAY
420 N	57	0.66 ft.	15.50 g/tonne, (0.45 oz/t)
450 N	56	3.14	6.719 0.195
	includes	0.43	23.8 0.694
307 N	51	63.7	5.082 0.148
	includes	15.3	7.219 0.210

Diamond drill hole 52 returned lower but significant gold values over 3 intersections: 1.99 m (6.5 ft.) of 2.927 g/t, 0.085 oz/ton; 2.12 m, 6.95 ft. of 1.896 g/t, 0.055 oz/ton; and 0.26 m (0.85 ft.) of 2.03 g/t 0.059 oz/ton. On Section 307N, Drill Hole 51 returned a very significant intersection from a vertical depth of about 65 m (213 ft.).

Diamond drill hole 58 on section 480N has reportedly intersected 3 mineralized zones varying in width from 0.98 m, 3.2 ft. to 3 m, 10 ft. Assays are awaited. Visible gold has again been reported in another drill hole, No. 61 on grid section 307N.

GRANGES EXPLORATION LTD. (GXL-T, Amex, London) 4 NOV 86

WINDFLOWER MINING LTD. (WFL-V) GCNL 217

FINAL ANALYSIS SHOWS - George Zbitnoff, vice-SHARPLY RICHER ASSAY president exploration of Granges Exploration Ltd., and Gerald Ryznar, P.Eng., president of Windflower Mining Ltd., report that final assay results from Drill Hole No.57 are now available. Previously released preliminary assays (GCNL 209(86) p.1 refers) indicated a gold intersection of 15.5 grams per tonne across 0.20 meters (0.66 feet) for this hole. The final and correct assay for this intersection is now as indicated below:

Hole 57, 0.66 ft. of 262 gr/T, 7.64 oz./ton. The marked difference in the assays is due primarily to the occurrence of substantial amounts of free gold in the drill core.

This high grade intersection, located on grid section 420 N, occurs at a vertical depth below surface of 125 m, 410 ft., and is a very strong indication of the continuance or down dip extension of the main mineralized zone at this depth.

GCL #190 2 OCT 1986

GRANGES EXPLORATION LTD., (GXL-T, AMEX, London)

WINDFLOWER MINING LTD., (WFL-V)

Under an option agreement, Granges can earn a 60% interest in the Goldfinch property, located at 3,500 feet elevation on the west side of Incomappleux River which flows into the NE arm of Upper Arrow Lake, about 45 miles SE of Revelstoke, B.C. by spending \$1,500,000 on exploration over four years ending in 1988. Granges has spent approximately \$500,000 to date, and expects to continue drilling until the second half of November. Wildflower may retain a 40% working interest or dilute through non-participation.

82K/13E
(082KNW073, 076)

A third drill rig is to start work by Oct. 3, 1986, to speed definition drilling in the zones. The gold is in a quartz pyrite vein zone in a graphitic argillite host rock. Samples are being collected with which to start metallurgical studies.

The assay results reported to date are over a north-south strike length of 330 meters, 1,080 feet, widths varying from 1.6 to 43.5 ft., gold values from 0.04 to 1.38 oz. gold/t with an arithmetic average width of 8.56 ft. and an arithmetic gold average of 0.229 oz. gold/t. The deepest intersection was cut at 345 feet below surface. Deeper holes will be drilled in the current phase of testing. Several of the holes have cut two or more bands of gold mineralization which are being further tested. Several parallel gold zones are also to be drill tested.

SEE TABLE AND DRILL HOLE SKETCH OVERLEAF for all of the assays reported from the property drilling to date.

HOLE NO.	LENGTH OF INTERSECTION	OZ. GOLD/T				
? Drilled in 1985	5.0 ft.	0.12		26	9.0	.05
WIN 8	12.5	.606			including 6.0	.059
10	17.0	.354		27	including 2.1	.065
including 10.0		.551		28	6.0	.046
11	18.7	.142			7.0	.056
including 4.1		.465		and 1.9		.435
12	10.2	.331		29	1.6	.174
14	9.0	.207		30	5.97	.069
and 6.3		.098		and 8.0		.102
15	3.0	.104		31	8.0	.124
17	3.0	.05		32	6.0	.306
18	11.0	.58		33	9.02	.417
19	4.2	.04		34	10.4	1.38
WIN 20	7.0	.038		and 15.5		.452
and 3.0		.075		WIN 35	6.0	.065
including 1.2		.096		and 3.5		.121
21	21.9	.11		36	6.0	.118
including 7.8		.169		37	6.0	.09
22	3.0	.23		including 1.5		.232
23	43.5	.096		and 1.0		.066
including 7.5		.16		38	6.7	.575
24	3.0	.394		Cores From holes Win 39,40,41,42, and 43		
25	2.4	.106		have been submitted for assay with the		
				results expected shortly.		

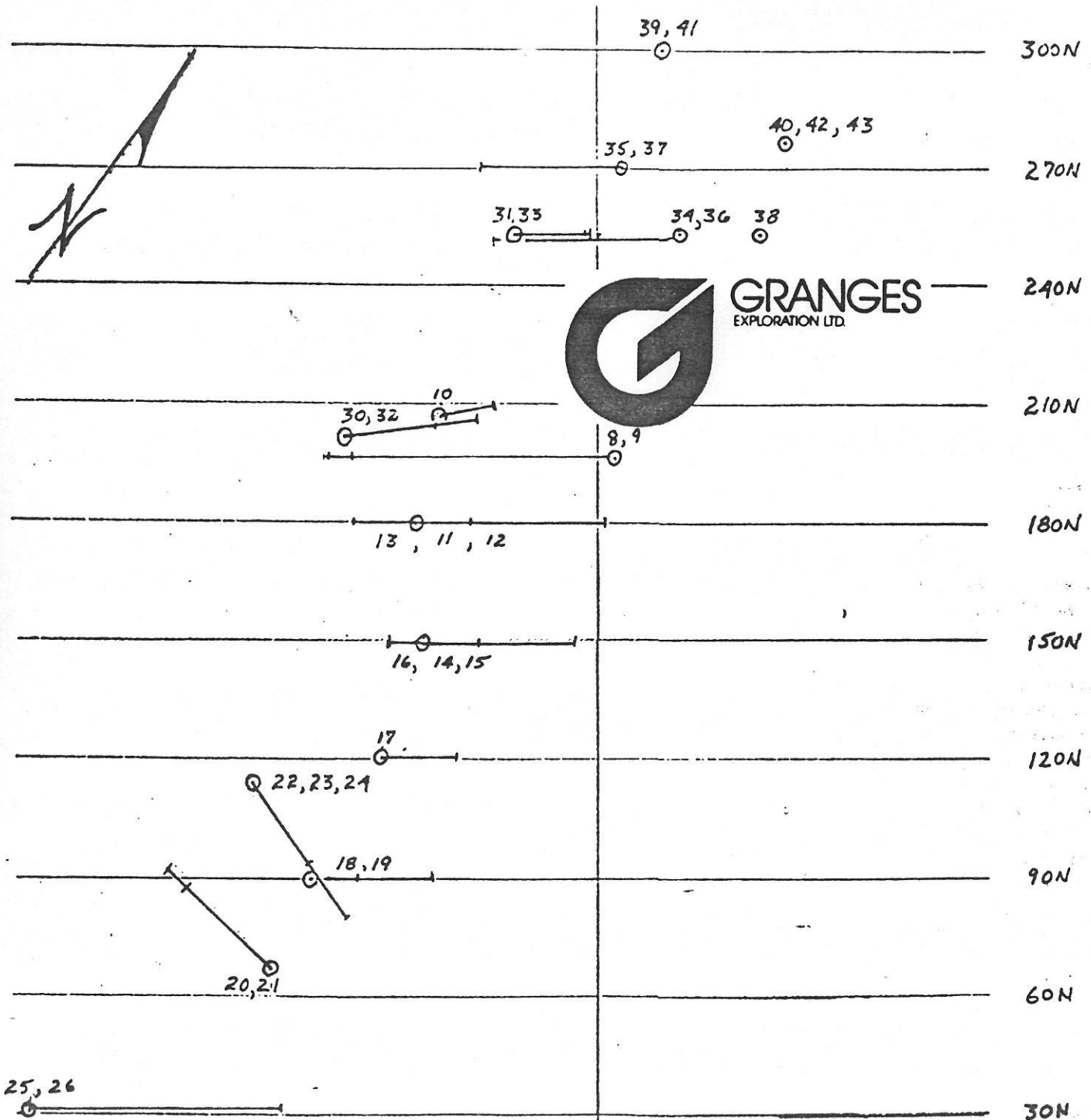

GRANGES
EXPLORATION LTD.

WINDFLOWER MINING LTD. - GRANGES EXPLORATION LTD.
1986 Drill Hole Locations, Goldfinch Group, British Columbia
Scale 1:1500

27

29

28

30S

0
1
2
3
4
5
6
7
8
9
10
11
12
13
14
15
16
17
18
19
20
21
22
23
24
25
26
27
28
29
30
31
32
33
34
35
36
37
38
39
40
41
42
43

GRANGES EXPLORATION LTD. (GXL-T; AMEX; LONDON, U.K.)

WINDFLOWER MINING LTD. (WFL-V)

HOLE	INTERCEPT LENGTH	GOLD ASSAY	
WIN 32	1.83m 6.0 ft.	10.52 g/t	0.306 oz/t
WIN 33	2.75 9.02	14.3	0.417
WIN 34	3.17 10.4	47.2	1.38

DRILL CUT 1.38 OZ. GOLD - In presenting recent drill results, George Zbitnoff, vice president Exploration of Granges Exploration Ltd., and Gerald Ryznar, P. Eng., president of Windflower Mining Ltd., announce that diamond drilling is continuing on Windflower's property some 45 miles SE of Revelstoke, B.C.

Two diamond drills are testing on the northern extension of the main mineralized zone which previously returned values as high as 0.6 oz. gold/ton across 12.5 feet. Recent results indicate the main zone extends to the north and continues to carry excellent gold values. The results shown in the table are from 3 diamond drill holes in the north extension of the main zone. Drill testing of targets further to the south, with drill holes Win 25 to Win 27, has returned encouraging values. See GCNL 175(86) p.1 for recent previous drill results.

N.M.I.N.E.R
29 SEPT 1986

Granges/Windflower results excellent

Two diamond drills now are on the Revelstoke, B.C., property of Windflower Mining, George Zbitnoff, vice-president exploration of Granges Exploration and Gerald Ryznar, P. Eng., president of Windflower, report. 82KNW073-76

The program is testing the northern extension of the main mineralized zone which previously returned values as high as 0.6 oz gold per ton across 12.5 ft. Recent results indicate the main zone extends to the north and continues to carry excellent gold values.

The following results are from three holes drilled on the north extension of the main zone:

Drill hole	Length of intersection	gold per ton
Win 32	6 ft	0.306 oz
Win 33	9.02 ft	0.417 oz
Win 34	10.4 ft	1.38 oz

Drill testing of targets further to the south, with drill holes Win 25 to Win 27, has returned encouraging values.

GCNL 183 23 SEPT 86

N.M.I.N.E.R
13 OCT 1986

Assays excellent for Granges Expl. and Windflower

Granges Exploration, and Windflower Mining, which continue to report excellent results from drilling on the Revelstoke, B.C., property of Windflower, say three drills are now at work on the property.

The companies says preliminary assays for one of the latest holes, WIN 42, show an intersection of 33.5 ft at a grade of 0.465 oz gold per ton, including 25.5 ft. at a grade of 0.60 oz gold per ton.

The hole was drilled on section 277m N, or 25 m north of hole WIN 34, which returned 1.38 oz gold across 10.4 ft. (N.M., Sep 29/86). 82KNW073076

GCNL #193 7 OCT 1986

GRANGES EXPLORATION LTD. (GXL-T, AMEX, London)

WINDFLOWER MINING LTD. (WFL-V)

ANOTHER GOOD GOLD- Gerald Ryznar, P. Eng., president of INTERCEPT REPORTED Windflower Mining Ltd., and George Zbitnoff, vice president exploration, Granges Exploration Ltd. report that the diamond drilling program on Windflower's Goldfinch group of mineral claims 45 miles SE of Revelstoke, B.C., continues to return excellent assay results. Shown in the table are results of preliminary assays for diamond drill hole WIN 42, drilled on section 277m N, being 25 meters north of hole WIN 34 which also returned excellent gold values - 11.38 oz. gold/t across 10.4 feet.

HOLE	INTERCEPT LENGTH	GOLD ASSAY	
WIN 42	10.21 m., 33.5ft.	15.956 grams/tonne	0.465 oz/t.
	includes 7.77 25.5	20.59	0.60

Diamond drilling is now continuing with 3 drills on the property. SEE GCNL 190(86) p.1 for recent review of property work in which the importance of the discovery is indicated by the dimensions of the mineralized zone and the parallel structures.

82KNW073076

GCNL 159
GRANGES EXPLORATION LTD. (GXL-T)
WINDFLOWER MINING LTD. (WFL-V) AUG 19/86

FOLLOW-UP DRILL HOLES UNDERWAY - No.4 diamond drill TO GOOD GRADE GOLD INTERSECTION hole is underway on the Windflower Mining gold property located between Fish Creek and Scott Creek south of Revelstoke, near Trout Lake, B.C. The hole, Win No.8 returned an intersection of 0.606 oz.gold/t over a core length of 12.5 feet. This is the first hole in the 1986 program and is on a parallel structure to the 1985 intersection of 5 feet of 0.12 oz.gold/t. Visual examination of cores from the next holes appear to indicate they have intersected the same mineralized horizon as that intersected in the No.8 hole. Should the next hole return similar results, another drill machine will be brought onto the property.

Under their option agreement, Granges can earn a 60% interest in the property by spending \$1,500,000 over four years. Windflower may retain a 40% working interest or dilute its interest through no participation.

GRANGES EXPLORATION LTD. (GEX-T; American; London; U.K.)
GCNL 166 WINDFLOWER MINING LTD. (WFL-V) AUG 28/86

HOLE	GRID SECTION	INTERCEPT LENGTH	GOLD ASSAY
WIN 12	180 Meters N	3.11m 10.2 ft.	11.38 g/T 0.331oz/t
WIN 14	149 N	2.74 9.0	7.09 0.207
	and	1.92 6.3	3.36 0.098
WIN 15	149 N	0.91 3.0	3.6 0.104

FURTHER ENCOURAGING - G. Ryznar, P. Eng., president of GOLD ASSAYS REPORTED Windflower Mining Ltd., reports assay results from five more diamond drill holes drilled by Granges Exploration Ltd. on Windflower's Goldfinch property 45 km SE of Revelstoke, B.C., on the west side of the Incomappleux River which flows into the Northeast Arm of Upper Arrow Lake. No significant gold mineralized intersection was cut in Holes WIN 13 and 16 in grid sections 180 and 149 meters north, respectively.

Mr. Ryznar and Granges' president Mike Muzykowski comment, "From the results to date it now appears that the mineralized zone has a northerly plunge and a second drill is being moved onto the property to test this north end of the zone where the mineralization appears to carry higher gold values. Meanwhile, the one drill continues to move south along strike of the zone, drill testing various showings and strong geochemical responses with a good success ratio.

"Drill testing on Grid Section 67 meters north has again intersected a very wide and apparently well mineralized zone." See GCNL 162(86) p.2 for previous drill results.

GCNL #171 5 SEPT 1986

GRANGES EXPLORATION LTD. (GXL-T; AMEX; LONDON, U.K.)
WINDFLOWER MINING LTD. (WFL-V)

HOLE	GRID SECTION	INTERCEPT LENGTH	GOLD ASSAY
WIN 17	120 m North	0.92 m 3.0 ft.	1.56 g/T 0.05oz/t
WIN 18	90 m North	3.35 11.0	19.88 0.58
WIN 19	90 m North	1.28 4.2	1.42 0.04
WIN 20	675 m North	2.14 7.0	1.3 0.038
	and	0.92 3.0	2.58 0.075
		0.36 1.2	3.28 0.096

MORE GOLD ASSAYS REPORTED - G. Ryznar, P. Eng. president reports assays from 4 more holes diamond drilled by Granges Exploration Ltd. on Windflower's Goldfinch property near Revelstoke, B.C. (SEE GCNL 166(86) p.1 for previous report of drill results).

Hole WIN 18 is about 100 metres south of drill hole WIN 8 which assayed 0.606 oz.gold/ton over 12.5 feet. Drilling north of hole WIN 8 is scheduled to begin soon.

GRANGES EXPLORATION LTD. (GXL-T, Amex; London)
WINDFLOWER MINING LTD. (WFL-V) GCNL 156
DRILL TEST STARTS ON - Diamond drill testing by Granges GOLD PROSPECT IN B.C. Exploration Ltd. on Windflower Mining Ltd.'s Goldfinch gold prospect near Revelstoke, B.C. started last week. To date, three holes totalling 956 feet have been drilled and all encountered galena and/or pyrite mineralization which, president G. Ryznar, P.Eng., says are the usual gold indicator minerals on the property.

GCNL #175 11 SEPT 1986

GRANGES EXPLORATION LTD. (GXL-T; AMEX; LONDON, U.K.)
WINDFLOWER MINING LTD. (WFL-V)

HOLE	INTERSECTION	GOLD ASSAY
WIN 21	6.7m 21.98 ft.	3.98 gr./t 0.11 Oz/t
	includes 2.38 7.8	5.79 0.169
WIN 22	0.91 3.0	7.90 0.23
WIN 23	13.26 43.5	3.29 0.096
	includes 2.28 7.5	5.5 0.16
WIN 24	0.91 3.0	13.5 0.394

In presenting results from the most recent drilling, G. Ryznar, P. Eng., president of Windflower Mining Ltd., and George Zbitoff, vice president exploration of Granges Exploration Ltd., report that a second diamond drill is now drilling on Windflower's Goldfinch property, some 45 miles SE of Revelstoke, B.C. This second drill will test the northerly strike extension of the main mineralized zone. The first drill will continue to move in a southerly direction testing a variety of geochemical and geological targets.

For recent previous drill results, see GCNL 171(86) p.1 and 166 p.1.

82K13E
 (082KNW073-076)

GCNL #195 11-Oct-78

MADISON OILS LIMITED

82K/13E 02376
082KNW006

SIX MONTHS ENDED 30 JUNE,	1978	1977
Oil/Gas Revenue	\$29,805	\$26,088
General, Admin. Expense	11,094	6,389
Production Costs, Etc.	14,999	17,298
Expl'n., Geological Exp.	912	1,386
Lease Rentals	80	88
Depletion, Deprec'n.	3,455	3,341
Net Loss	735	2,414
Working Capital	\$9,604	\$7,726

ACTIVITIES & INTERESTS
BRIEFLY REVIEWED

In August, Madison Oils Limited acquired an option, good through February 1980, on the 10-claim Camborne gold property on Lexington Mountain in Revelstoke mining division, B.C. Richard S. Westbury, president, says there are a number of old workings on the property from which past production was reportedly some 17,487 ounces of gold and 5,321 ounces of silver.

Limited reconnaissance included an electromagnetic survey over a small area that suggests the Eva vein probably does extend further west than was believed. Assays of surface, dump and float material have returned values comparable to material mined in the past, which is encouraging.

The impact of the new Saskatchewan oil taxation system has yet to be assessed, says Mr. Westbury, adding that the rules are extraordinarily complex and their effects a mystery to the entire industry.

On other matters, Mr. Westbury briefly notes that Madison owns a gross overriding royalty interest on two small tracts in the Arrowood area, SE of Calgary near a recent reported gas discovery and close to a current drilling well. The Greenan 6-10 gas well (Madison 30%) should shortly resume production after long delay. A recent hearing before the Energy Resources Conservation Board in Calgary may result in useful additional income being received by Madison from the Erskine area.

GCNL #32 16 FEB 82

Lucky Strike Resources Ltd. secretary W.V. Graham reports that an application to relist the company's shares on Vancouver Stock Exchange has been submitted and that arrangements are being made for an underwriting of units comprising one share plus 2 warrants. The proceeds from the underwriting would be used to pay Lucky Strike's share of costs of additional work on the 32,000 acres of oil and gas leases in Rosebud county, Ontario, as well as its work commitments on its 60% owned Camborne gold properties near Revelstoke, B.C., in the spring and summer of 1982. Lucky Strike's offices are at 401-543 Granville St., Vancouver.

GRANGES EXPLORATION LTD. (GXL-T; American; London, U.K.)

82K/13E 082KNW076

HOLE	INTERCEPT LENGTH	OZ. GOLD/TON
WIN 11	18.7 ft.	0.142
Includes	4.1	0.465
WIN 10	17.0	0.354
Includes	10.0	0.551

82KNW073, 076 (13E)

GCNL 192
AUG 22/86

ENCOURAGING GOLD - Diamond drill testing by Granges Exploration Ltd. continues on the Goldfinch claims of Windflower Mining Ltd. southeast of Revelstoke, B.C. Results of Holes 10 and 11 are shown in the table.

Because of structural complications, drill hole WIN 9 may not have intersected the zone, however some sections will be sampled and assayed.

Drill hole WIN 11 is on a section 30 meters further south along strike from drill hole WIN 8.

Drilling is continuing. See GCNL 159(86) p.2 for previous drill results.

GCNL 148 WINDFLOWER MINING LTD. (WFL-V) 86.08.01
GRANGES EXPLORATION LTD. (GXL-T, American; London)

DRILL TEST STARTING ON - G. Ryznar, P.Eng., president of B.C. GOLD-SILVER CLAIMS Windflower Mining Ltd., announces that diamond drill testing of Windflower's "Goldfinch" property located south east of Revelstoke, B.C., will start in the next few days. (13E) 82KNW073, 076

The drilling is being funded by Granges Exploration Ltd., who are in their second year of an option agreement with Windflower on this property whereby Granges can earn 60% working interest (subject to certain net smelter return royalties to property vendors) by spending \$1,500,000 by 1990. Windflower would then retain 40% working interest.

Granges' drill test last year returned a number of significant intersections, the best being 0.23 oz. gold and 1.16 oz. silver per ton over 7.5 feet.

This season's drilling will test several new target areas disclosed by exploration earlier this summer, extensions to surface showings of mineralization and extensions to mineralization intersected in 1985 drilling.