

CRITERION N° 1
" " 2
ROSSLAND
Scale 1" = 40'

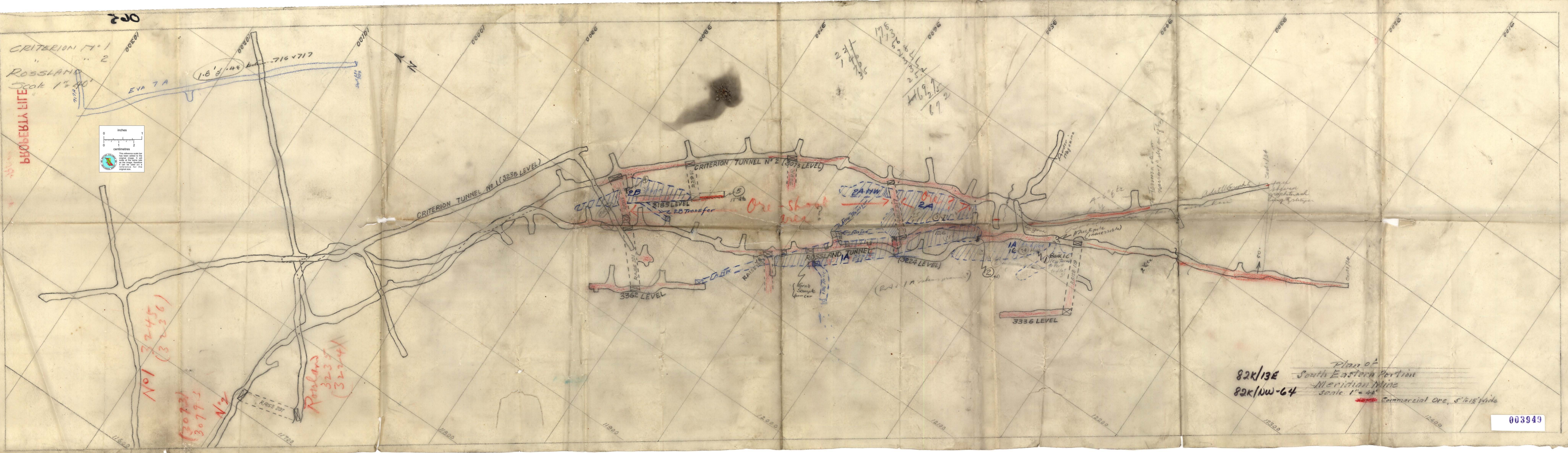
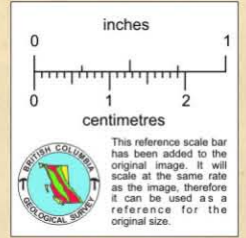

No 1 (3245)
(3236)

Rosland
3235
(3224)

82K/13E
82K/NW-64
Plan of
South Eastern Portion
Meridian Mine
Scale 1" = 40'
Commercial Ore, 5' to 15' wide

003949