

6" wide to 3' stepped above
 floor steps 3' wide
 Dip 65 W. Steep ...

stepped above

stepped

6" cliff
 grade

Rec
 40/10W

Patchwork of ...

11N
 9E

PROPERTY FILE

1 IN = 30 FT

MIDNIGHT 3157 1IN=30FT.

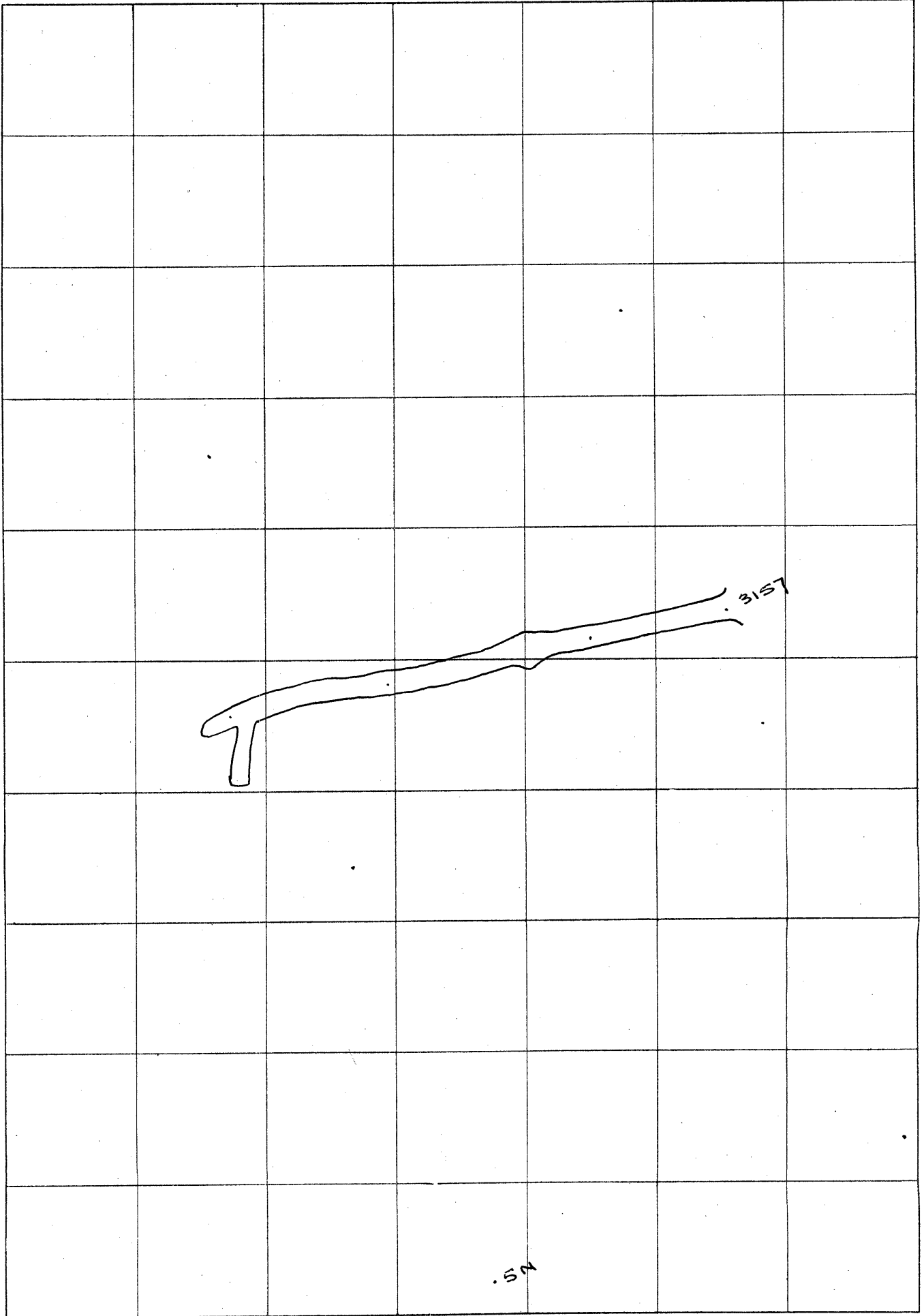

PROPERTY FILE

MIDNIGHT 3100

All this marking is
soft soapy serpentine
may be lost - light green
slips

S+004

Centocla Campyloche
with 1/2 layers of
white serpentine up to
15" thick more total
step vertical to
stage 11

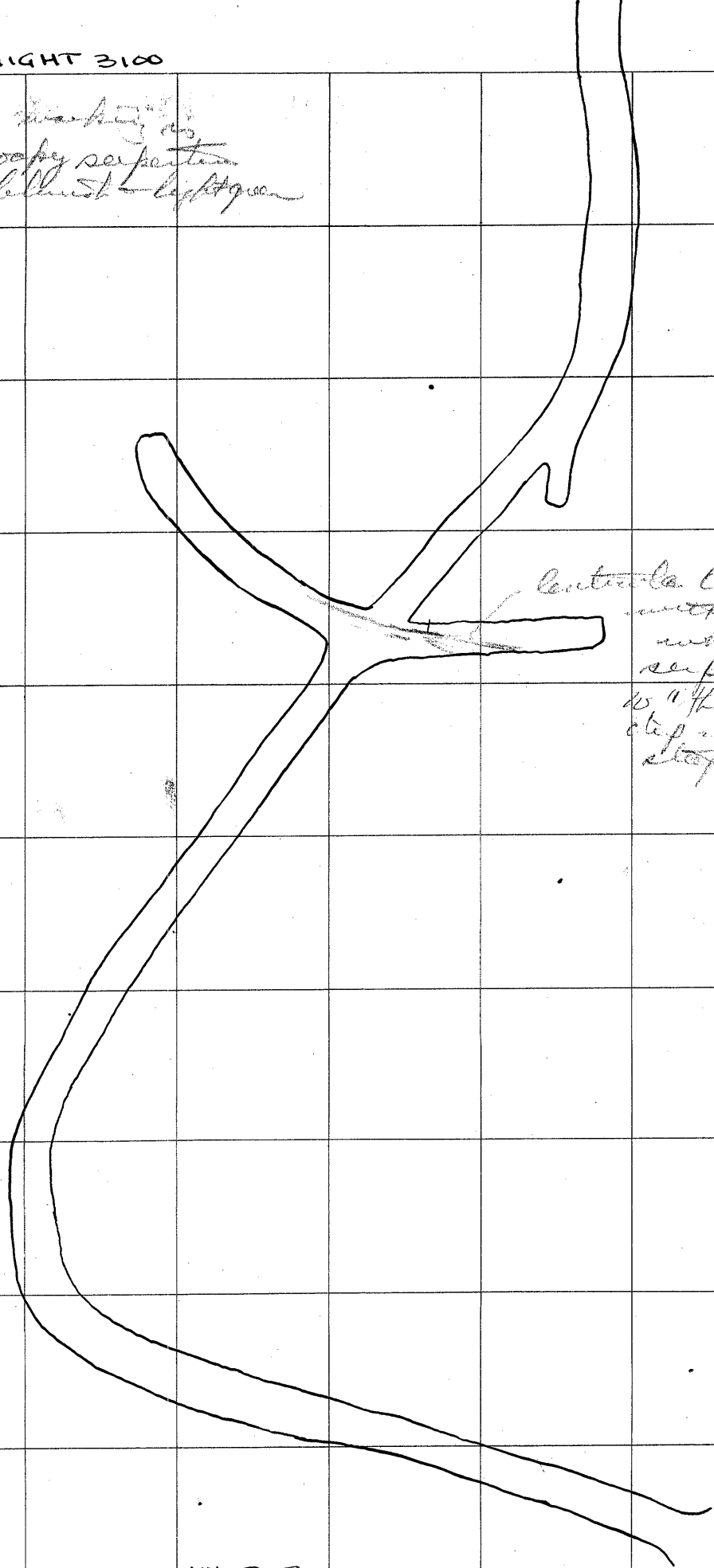

1" = 30 FT

PROPERTY FILE

10x01

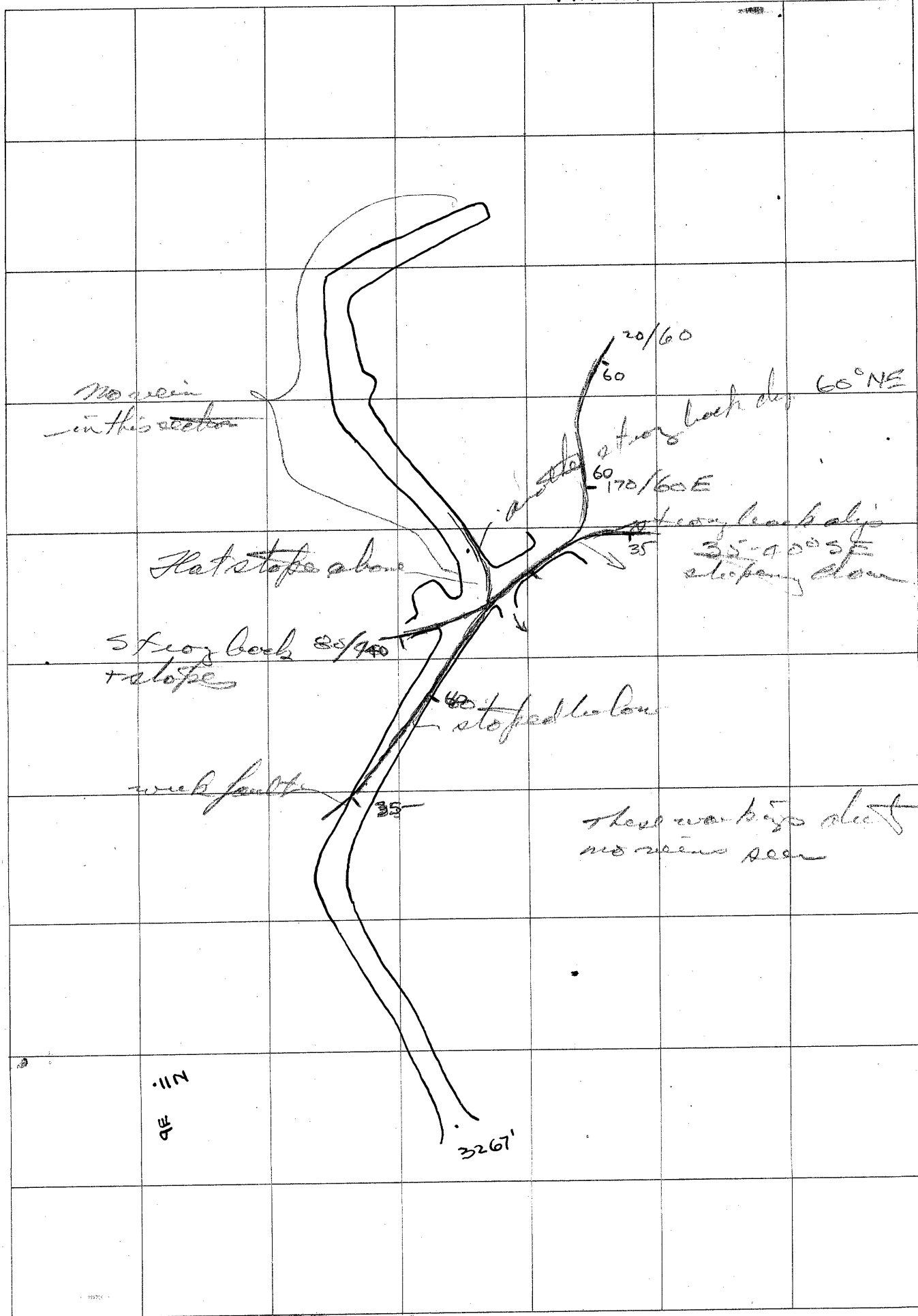

1" = 30 FT

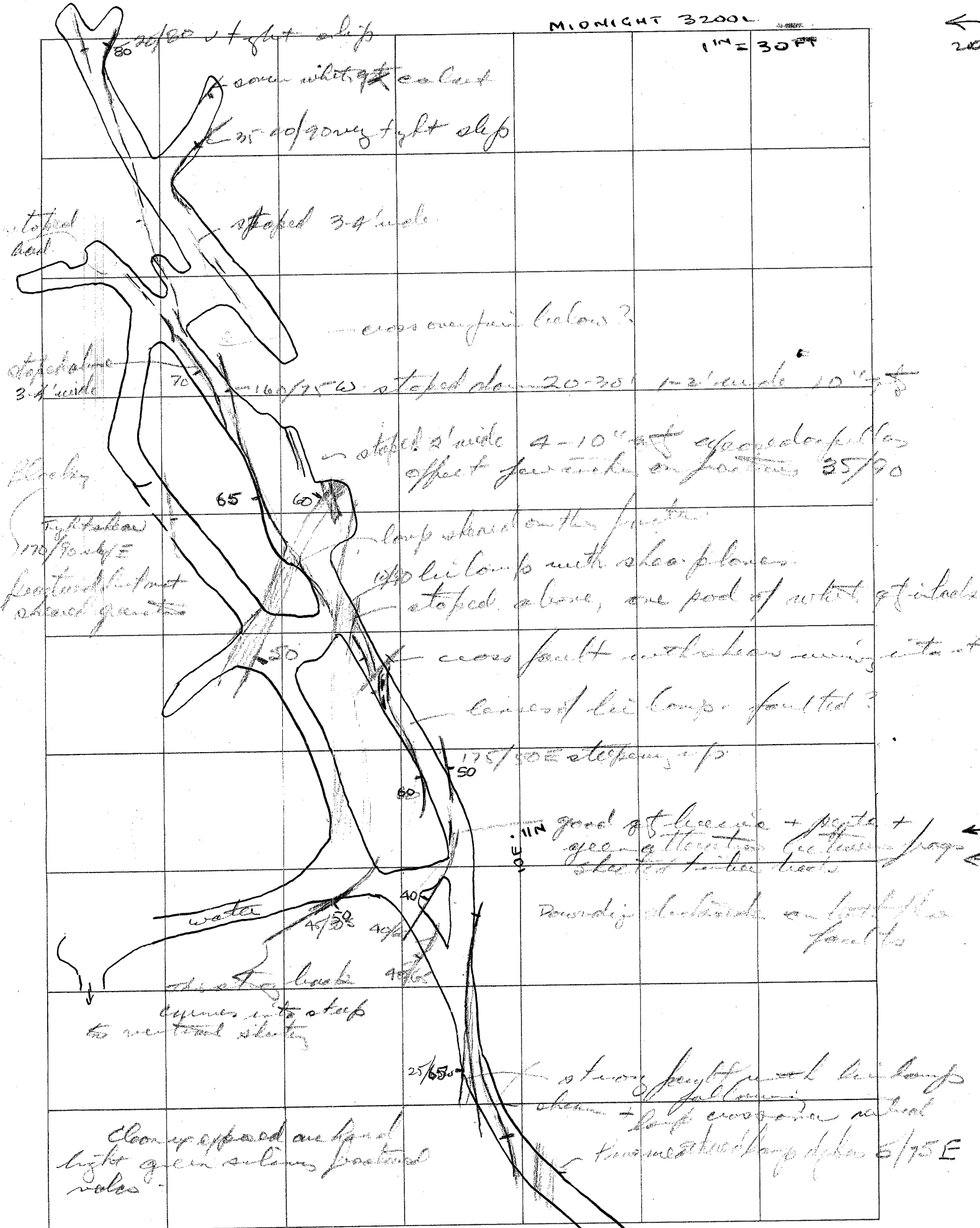

PROPERTY FILE

3200 PORTAL

MIDNIGHT
3100

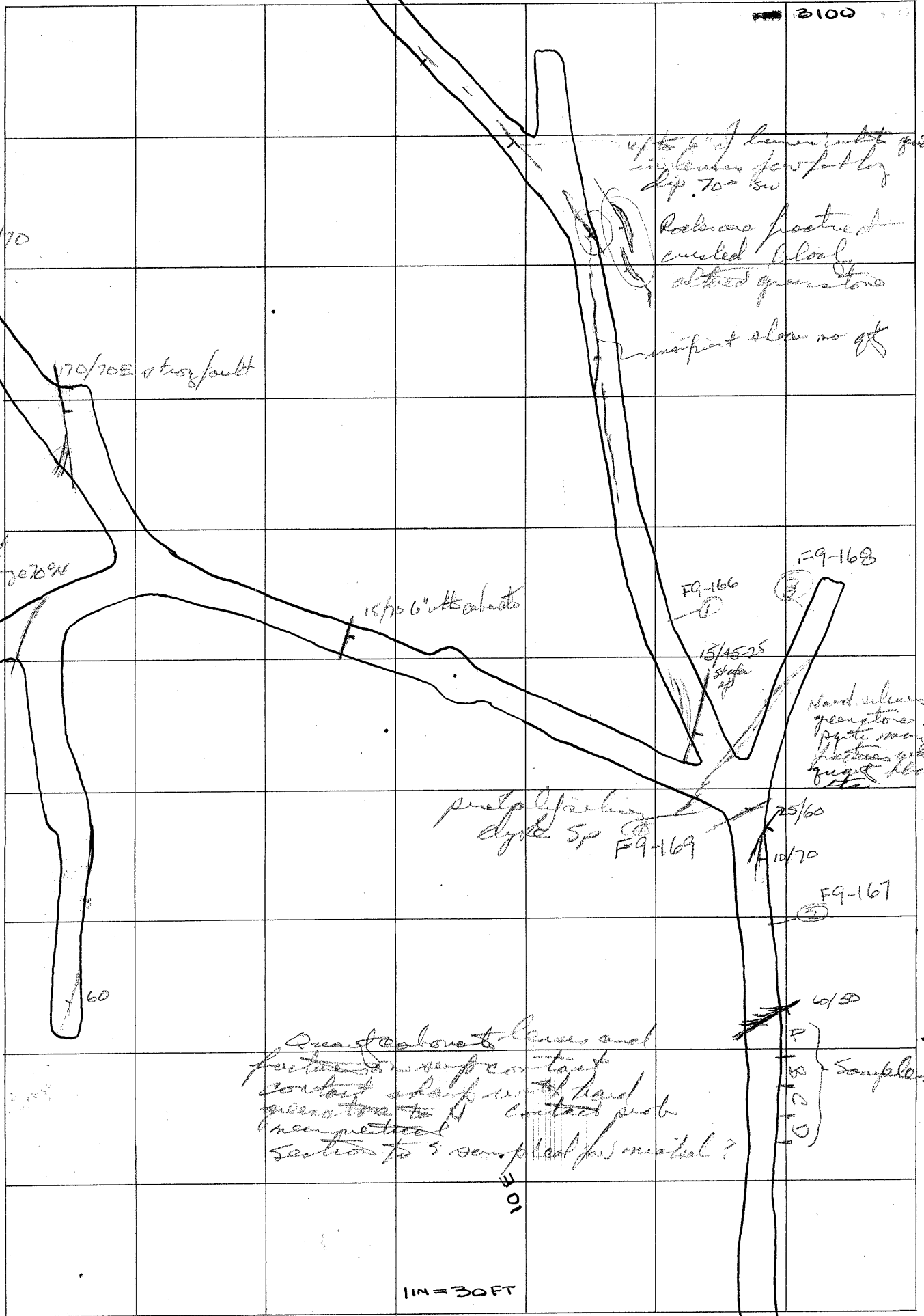

up to 6" of lamination with part
in lamination few feet long
dip 70° SW
Rocks are fractured
cracked along
other granitoids
insipient cleavage of

fault trace
cleaves plunge 20° NW
17/18 25/65 E

15/15 6" with calcite

F9-166

F9-168

15/15 25
5' dip
18

hard siliceous
granitoides dark
pyrite iron
fractures with
quartz etc.

pyrite facies
dyke 5' F9-169

25/60

10/70

F9-167

60

Quartz calcite lenses and
fractures in contact
contact sharp with hard
granitoides to contact prob
near vertical
sections to 3 sampled for material?

60/30

Samples
10
15
20
30

9N

10 E

1 IN = 30 FT

PROPERTY FILE