

DETAIL SHOWING  
ASSAYS AND GEOLOGY  
TUNNELS NOS. 1 & 2.  
SCALE: 1" = 30'

**LEGEND**  
Granite  
Limestone  
Veins

Survey by compass by Johns and in part by Starr.  
Contours approximate only.  
Assay figures in following order:  $\frac{1}{2}$  No. width, feet - Oz Au - Oz Ag.  
Those marked "M" taken by McLaughlin, others by Frith.

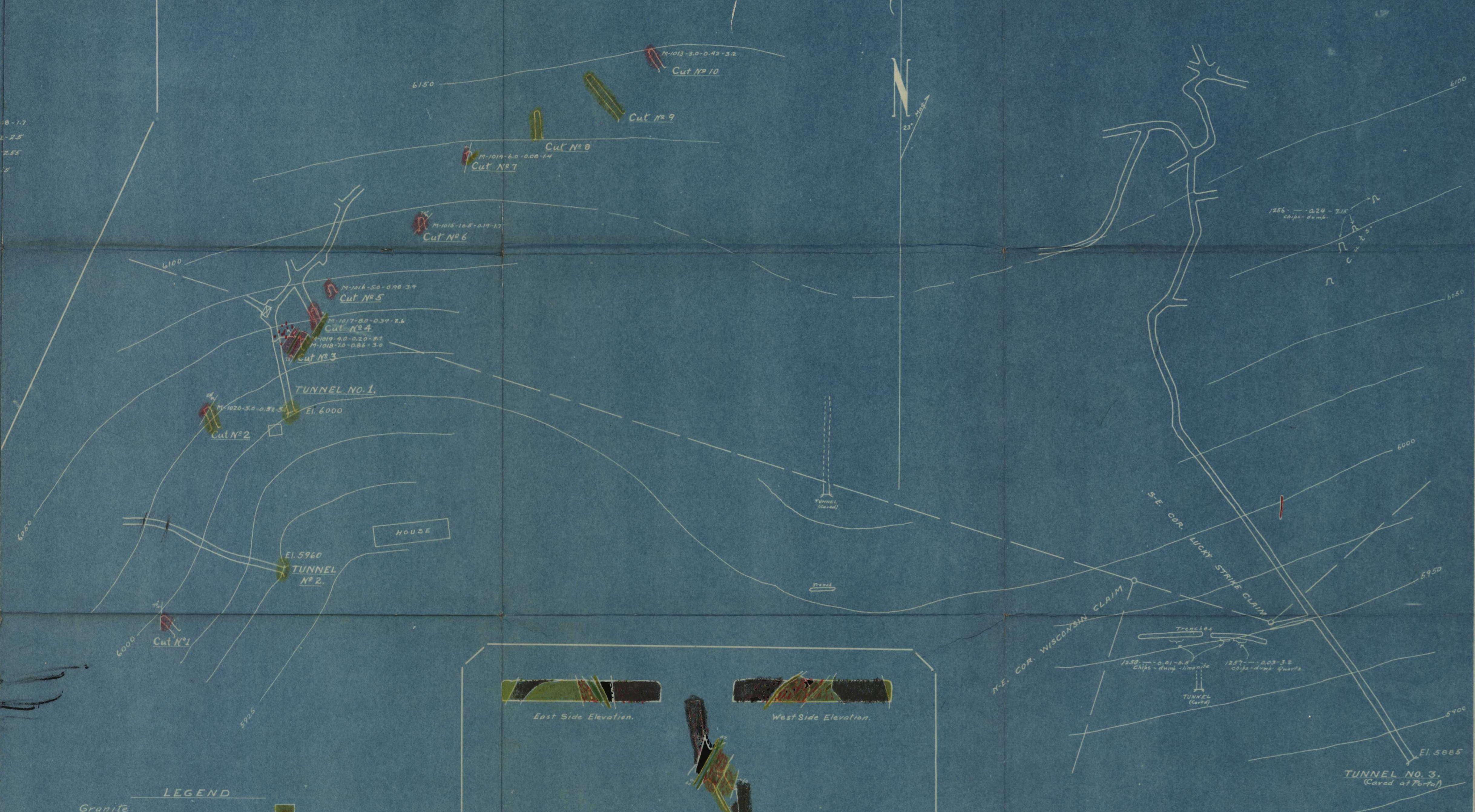
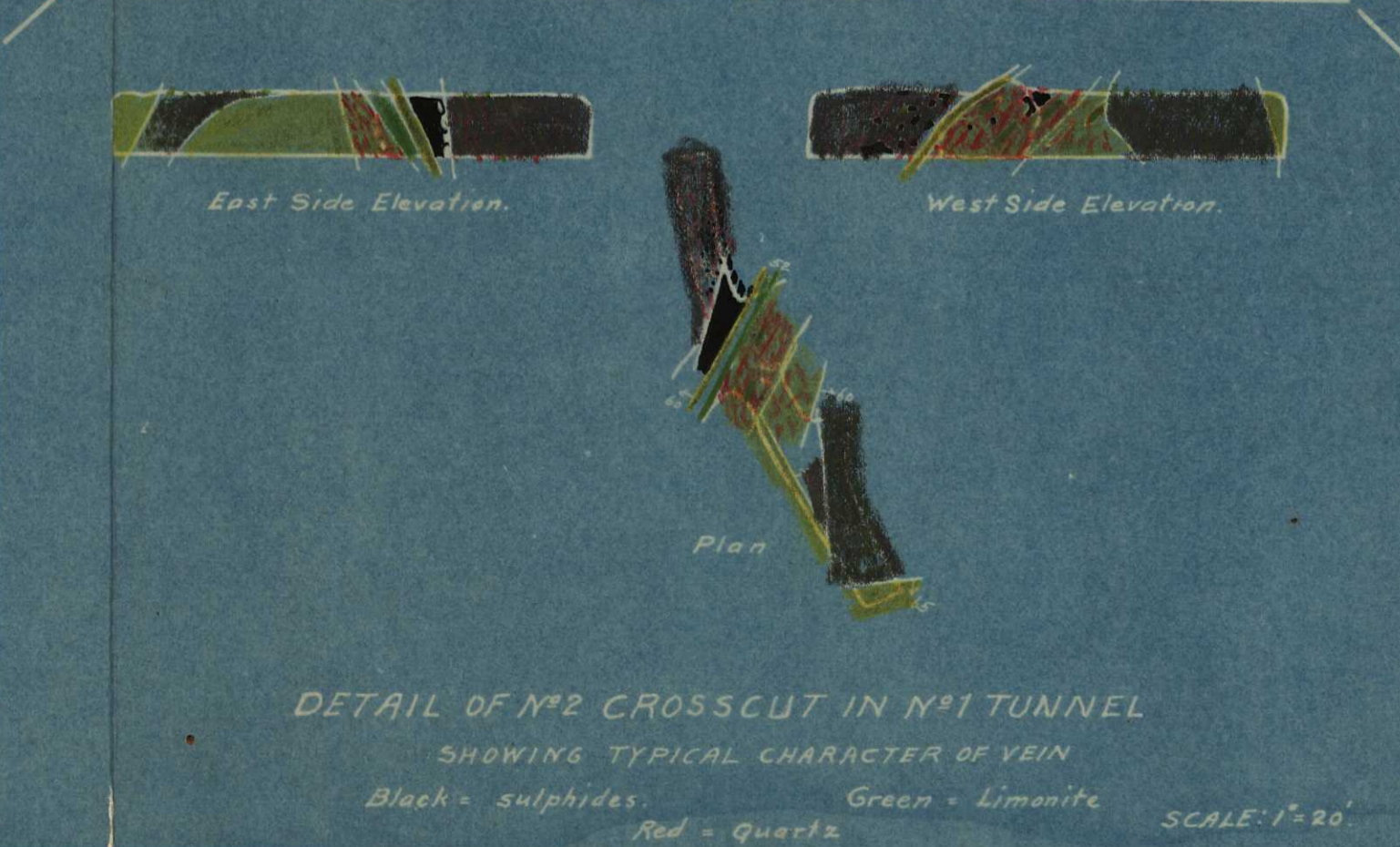

**WISCONSIN MINE**  
MIDGE CREEK, NEAR NELSON B.C.  
SCALE: 1" = 50'

*Return to  
Chas. C. Starr*

002587

