

LEGEND

Claims: **valid** **superimposed or cancelled**

Line:

Location line:

Length indication:

Identification: **GREY COPPER** **L580**

17.68A

Topography:

SCALE

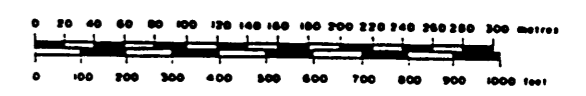
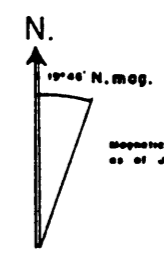

FIGURE 4.

To accompany a Report by
Donald W. Tully, P.Eng.,
dated December 31, 1990



Magnetic declination for the northern part of B.C. as of July 1, 1990. Declination decreases 7.4' annually.

Ostler & Linn - Figure 3

AVRIL EXPLORATIONS INC. **002069**

CROWN GRANT SURVEYS:
1895 to 1901

PURCELL PROPERTY
49° 59.3' N., 117° 11' W.

SLOCAN M.D., BRITISH COLUMBIA N.T.S. 82 F/14
JOHN OSTLER; M.Sc., P.Geol. DECEMBER, 1990
MICHAEL LINN, B.Sc.

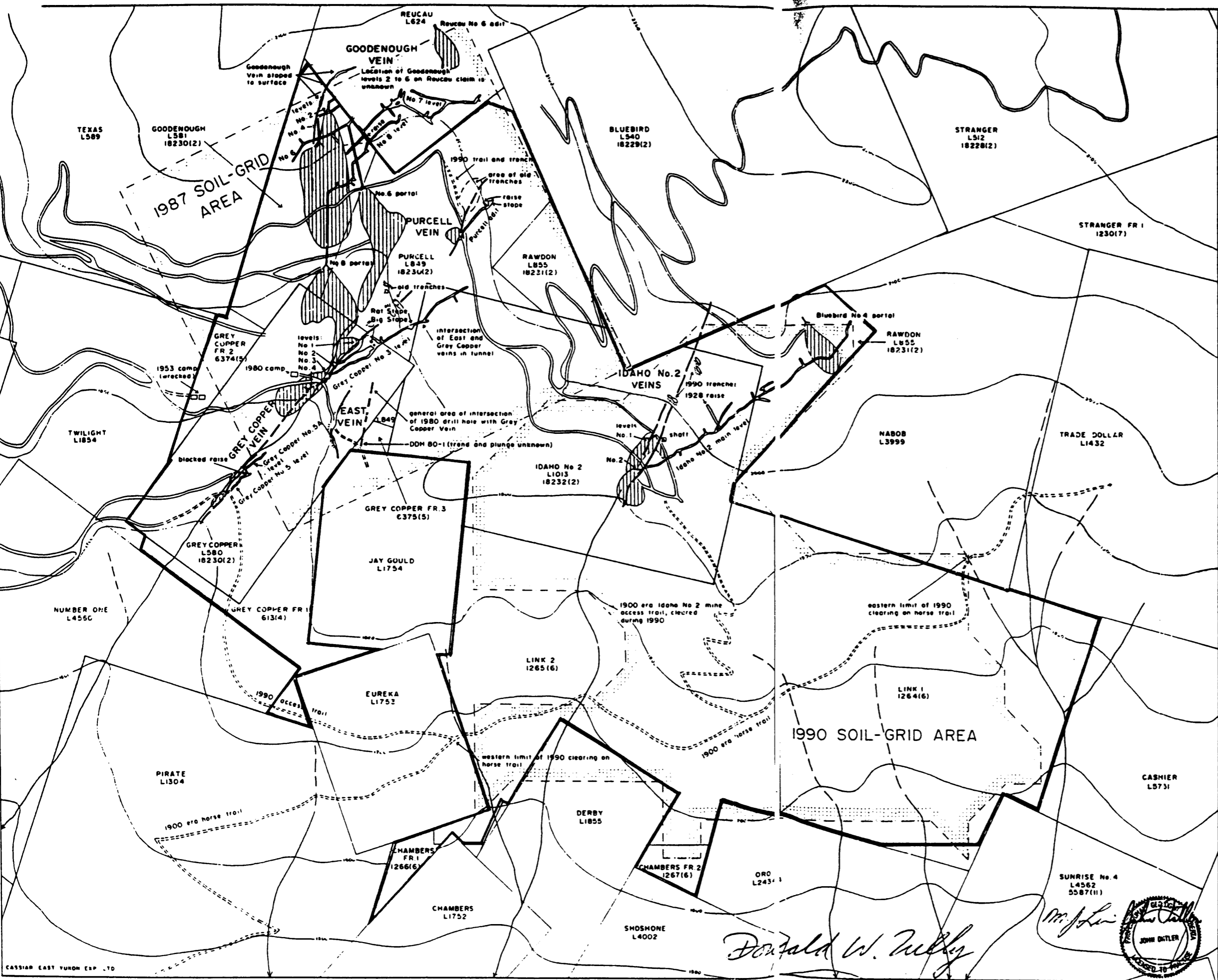

LEGEND

- Topography: creek, intermittent creek, contour in metres, road, trail
- Workings: trench, ore dump, portal, tunnel or raise, shaft
- Limit of soil grid area: defined, approximate, assumed
- Claims: claim boundary, Purcell Property boundary
- SUNRISE No. 4 ← claim name
L4562 ← surveyed lot number, if any
5587(11) ← record number, if any

SCALE

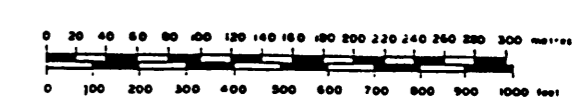
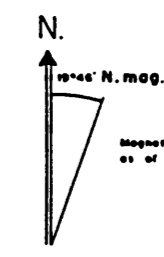

FIGURE 5.

To accompany a Report
by Donald W. Tully, P.Eng.,
dated December 31, 1990



Magnetic declination for the northern part of N.T.S. Map 82 F/14 as of July 1, 1990. Declination decreases 7.4' annually

Ostler & Linn - Figure 4

AVRIL EXPLORATIONS INC.
**ROADS, TRAILS, WORKINGS
and SOIL-GRID AREAS**
PURCELL PROPERTY
49° 59.3' N., 117° 11' W.
SLOCAN M.D., BRITISH COLUMBIA N.T.S. 82 F/14
JOHN OSTLER, M.Sc., P.Geol. DECEMBER, 1990
MICHAEL LINN, B.Sc.

Donald W. Tully

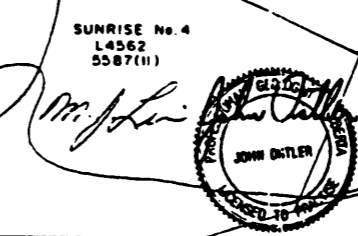

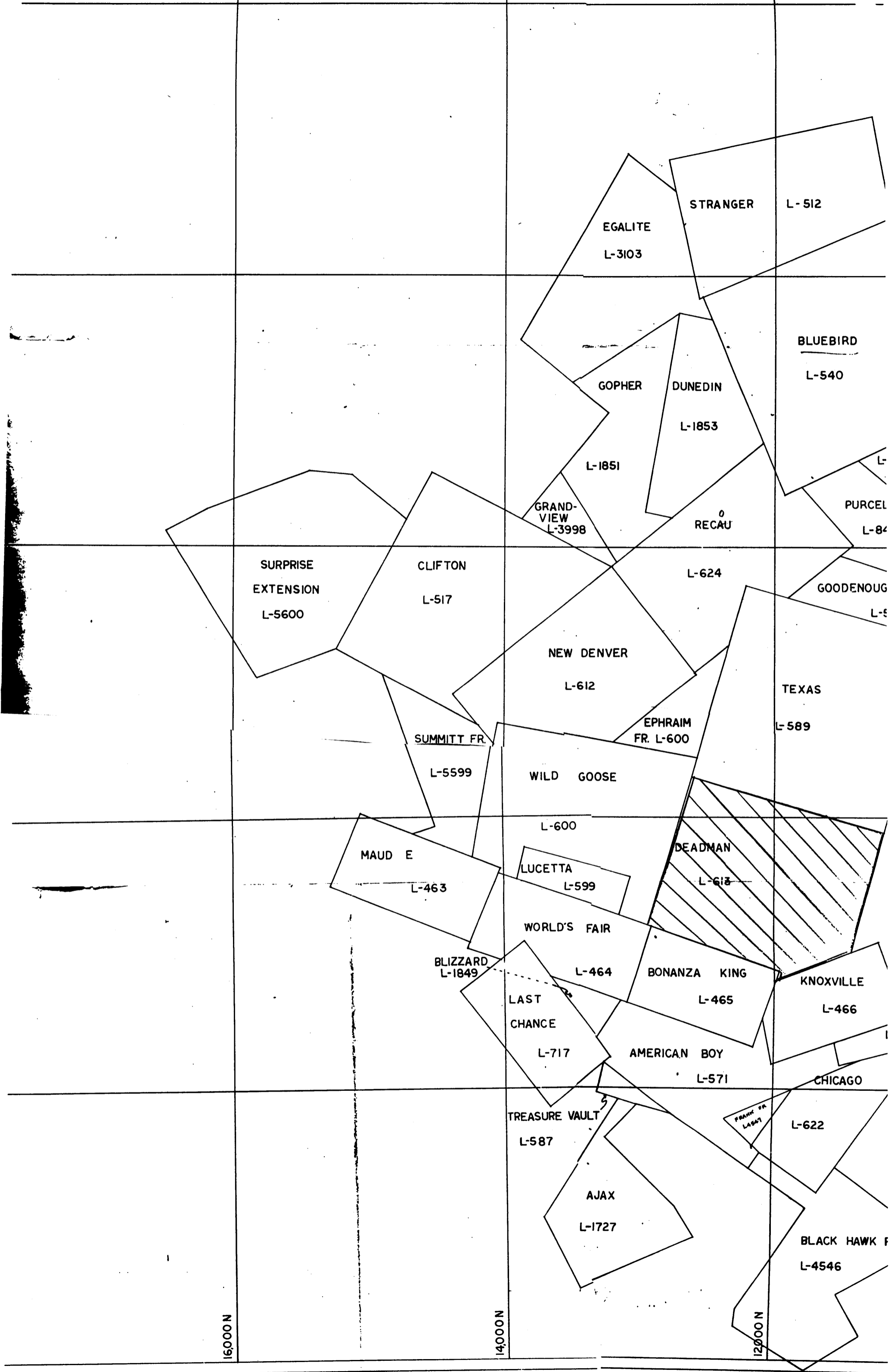

STRANGER L-512

EGALITE
L-3103

BLUEBIRD
L-540

GOPHER L-1851
DUNEDIN
L-1853

GRAND-VIEW
L-3998

RECAU

PURCEL
L-84

SURPRISE
EXTENSION
L-5600

CLIFTON
L-517

L-624

GOODENOUG
L-9

NEW DENVER
L-612

TEXAS
L-589

EPHRAIM
FR. L-600

SUMMITT FR.

L-5599

WILD GOOSE

L-600

MAUD E

L-463

LUCETTA
L-599

DEADMAN

L-618

WORLD'S FAIR

BLIZZARD
L-1849

L-464

BONANZA KING

L-465

KNOXVILLE

L-466

LAST
CHANCE

L-717

AMERICAN BOY

L-571

CHICAGO

TREASURE VAULT

L-587

FRANK FR.
L-547

L-622

AJAX

L-1727

BLACK HAWK F

L-4546

16000 N

14000 N

12000 N

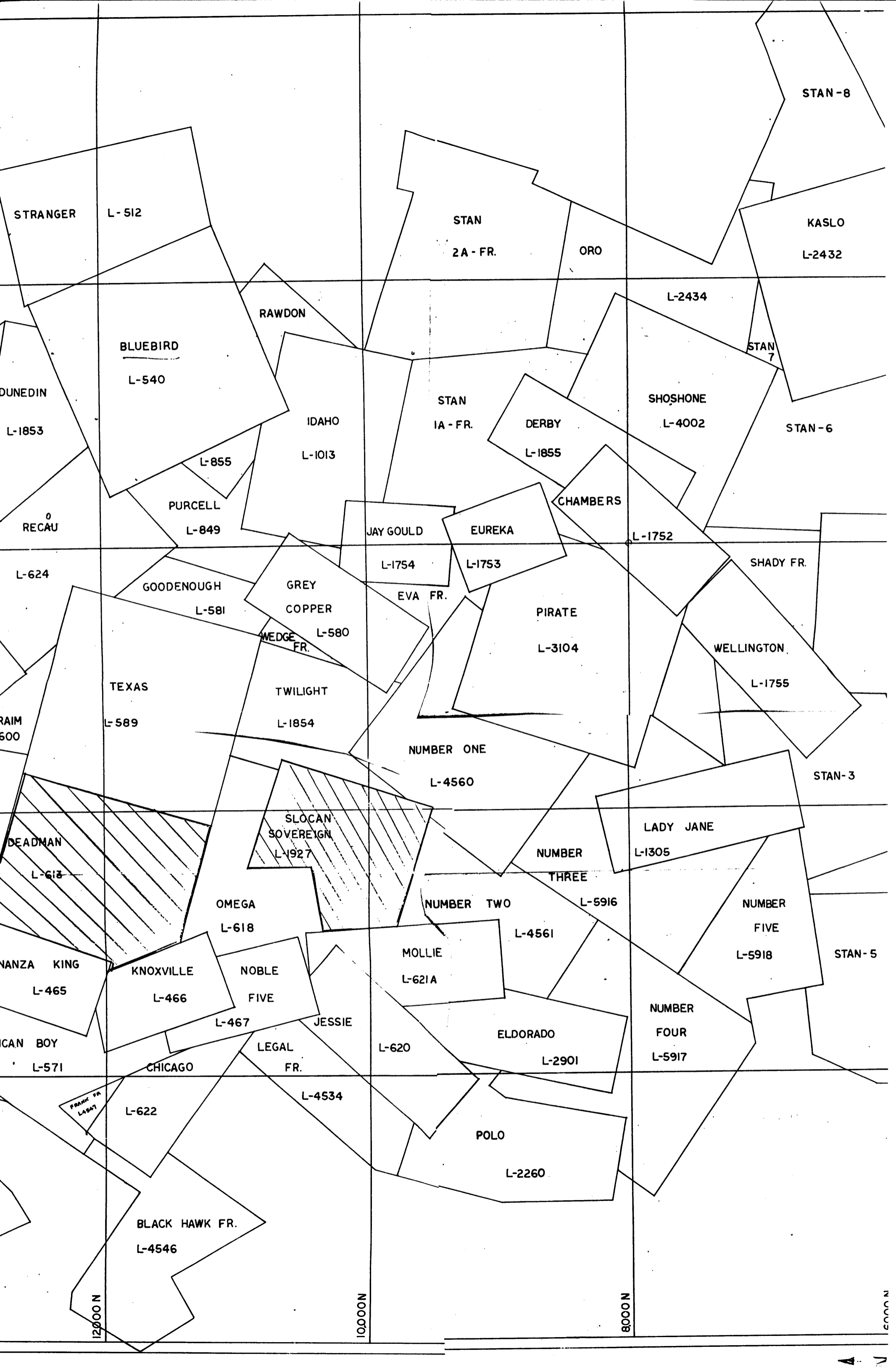

STAN-8

STRANGER L-512

STAN
2A - FR.

ORO

KASLO
L-2432

L-2434

BLUEBIRD
L-540

RAWDON

STAN
7

DUNEDIN
L-1853

IDAHO
L-1013

STAN
IA - FR.

SHOSHONE
L-4002

STAN-6

L-855

DERBY
L-1855

PURCELL
L-849

CHAMBERS

JAY GOULD
L-1754

EUREKA
L-1753

L-1752

L-624

GOODENOUGH
L-581

GREY
COPPER
L-580

EVA FR.

PIRATE
L-3104

SHADY FR.

WEDGE
FR.

WELLINGTON
L-1755

TEXAS
L-589

TWILIGHT
L-1854

NUMBER ONE
L-4560

STAN-3

SLOCAN
SOVEREIGN
L-1927

LADY JANE
L-1305

NUMBER
THREE

L-5916

NUMBER TWO

NUMBER
FIVE
L-5918

STAN-5

OMEGA
L-618

L-4561

MOLLIE
L-621A

NUMBER
FOUR
L-5917

NANZA KING
L-465

KNOXVILLE
L-466

NOBLE
FIVE
L-467

JESSIE

ELDORADO
L-2901

AMERICAN BOY
L-571

CHICAGO

LEGAL
FR.

L-620

L-4534

POLO

L-2260

L-622

BLACK HAWK FR.
L-4546

FRANK FR.
L-847

12000 N

10000 N

8000 N

6000 N

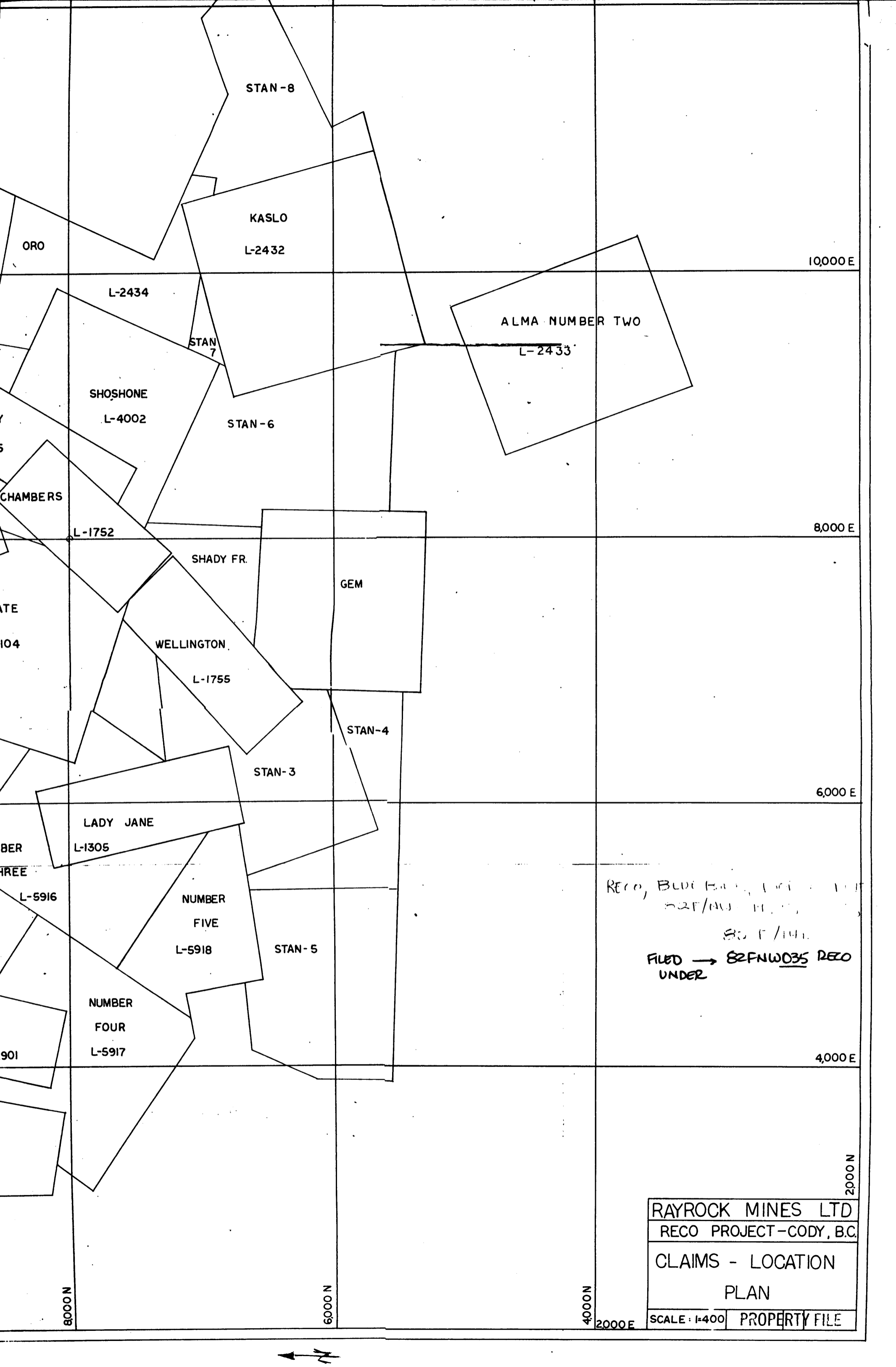

STAN-8

KASLO
L-2432

10,000 E

L-2434

ALMA NUMBER TWO
L-2433

STAN-7

SHOSHONE
L-4002

STAN-6

8,000 E

L-1752

SHADY FR.

GEM

WELLINGTON

L-1755

STAN-4

6,000 E

STAN-3

LADY JANE

L-1305

RECO, BLUE BOOK, 1911-1912, 1913, 1914, 1915, 1916, 1917, 1918, 1919, 1920, 1921, 1922, 1923, 1924, 1925, 1926, 1927, 1928, 1929, 1930, 1931, 1932, 1933, 1934, 1935, 1936, 1937, 1938, 1939, 1940, 1941, 1942, 1943, 1944, 1945, 1946, 1947, 1948, 1949, 1950, 1951, 1952, 1953, 1954, 1955, 1956, 1957, 1958, 1959, 1960, 1961, 1962, 1963, 1964, 1965, 1966, 1967, 1968, 1969, 1970, 1971, 1972, 1973, 1974, 1975, 1976, 1977, 1978, 1979, 1980, 1981, 1982, 1983, 1984, 1985, 1986, 1987, 1988, 1989, 1990, 1991, 1992, 1993, 1994, 1995, 1996, 1997, 1998, 1999, 2000.
FILED -> 82FNW035 RECO UNDER

L-5916

NUMBER FIVE

L-5918

STAN-5

4,000 E

NUMBER FOUR

L-5917

2000 N

RAYROCK MINES LTD	
RECO PROJECT-CODY, B.C.	
CLAIMS - LOCATION PLAN	
SCALE: 1:400	PROPERTY FILE

8000 N

6000 N

4000 N

2000 E

