

Kellogg Ex 1072
 1/4 E.M. & 1/4 B.M.
 GEODESIC SECTION
 QUEEN BESS MINE

← S 60° W

→ N 60° E

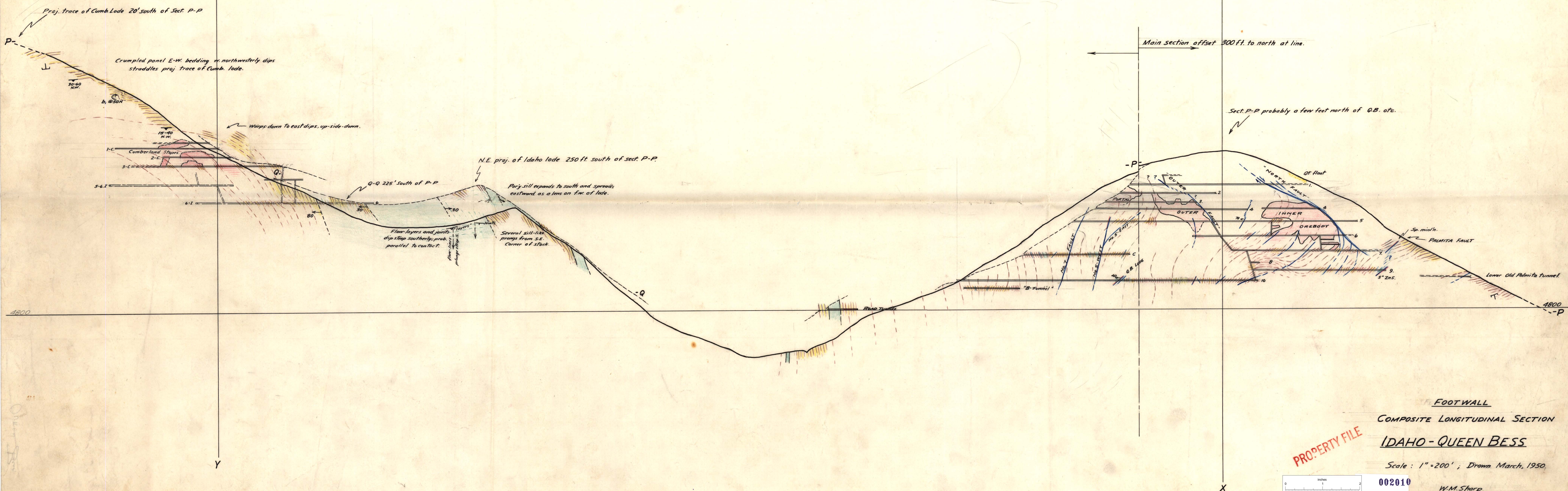

FOOTWALL
 COMPOSITE LONGITUDINAL SECTION
 IDAHO-QUEEN BESS

Scale: 1" = 200'; Drawn March, 1950.

002010
 W.M. Sharp

PROPERTY FILE

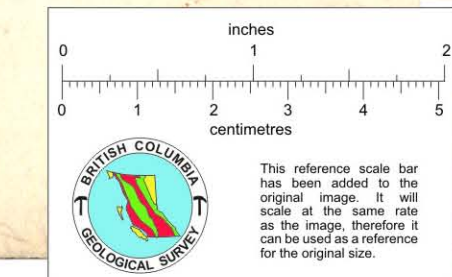

323