

May 13, 1947.

Mr. R. Crowe-Swords, President,  
Santiago Mines Ltd.  
423 Hamilton St.  
Vancouver, B. C.

*Bosun Group*

Re: ALPHA CLAIM

Dear Sir:-

The workings on the Alpha Vein, as shown to Mr. Buckham by Mr. Harris who did part of the work, are not on the Alpha claim but are, in part at least on the Cornercracker claim. The sketch herewith shows the position of the Alpha vein with respect to the Bosun Vein, and the Alpha tunnels on a larger scale.

In the open cut at elevation 3150 (50 feet below the summit of the ridge) there is one inch of quartz with a few spots of galena. It strikes N 60° E and dips 65° south.

In the tunnel at elevation 2925 there is a six inch vein consisting of sheared rock with from 0 to 1 inch of quartz and occasional traces of zinc blende. It is cut off at 30 feet from the portal by a cross fault. The strike is N 75° E and the dip 72° south.

In the lowest tunnel, at elevation 2575, the shearing is about a foot wide and quartz varies from nil to upwards of an inch in a few places. Traces of zinc were noted and there is a small pile of blende on the dump amounting to perhaps two or three hundred pounds. There are two parallel shears striking from S 75° W to due west, and dipping about 75° south.

The sketch of the tunnels and their relative positions to each other and to the Bosun vein are only approximate. There seems to be no certainty that the three workings are on the same shear. The workings all show very weak and narrow mineralization, so much so as to make one wonder why so much work has been done.

As indicated on the sketch, it is out of the question to drill to cut the Alpha vein from the Bosun workings on account of the distance between them as well as the poor showing.

Yours truly,

CAS

Lower Tunn from SE of Alpha  
 a few hundred feet & extending  
 from Bosun Ext. #1, across ancient  
 ground & into or near to Concracker line.

↑  
 North.

Open cut  
 ± 50'  
 Below  
 Summit  
 Aneroid  
 3150



Aneroid 2925  
 This tunnel bears  
 S 25° W to Silverton point (on lake shore)



Aneroid 2575

Alpha Workings of Bosun group.  
 Bearing from working to working and distances estimated

Scale: 1" = 100'

Silverton, BC

Apr 9 1947

--- = vein or shearing.



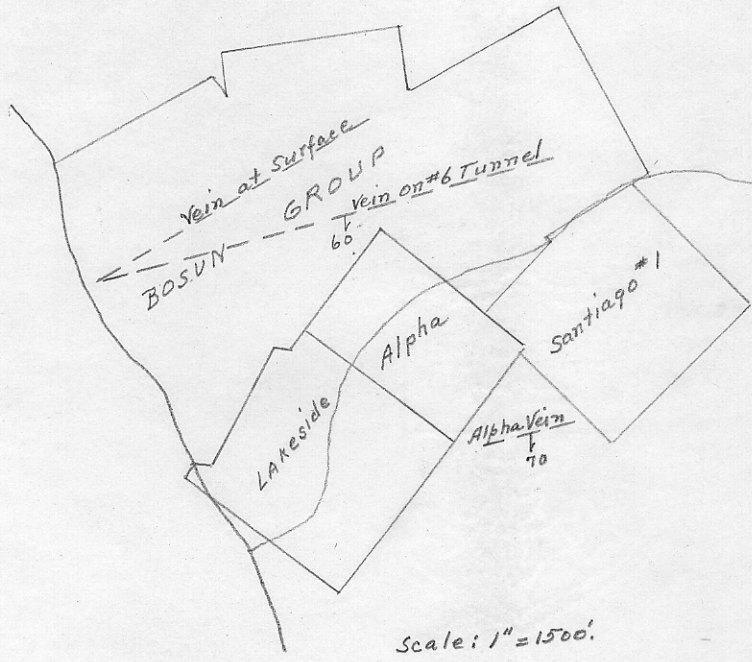

65 El. 3150

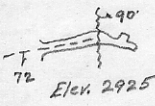

Scale: 1" = 100'

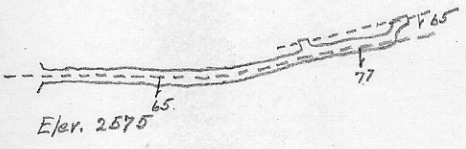

SKETCH SHOWING RELATIVE POSITIONS  
BOSUN and ALPHA VEINS  
(Approximate)