

Property File

082F NW003

001944

413 Granville St.

Silverton, B. C.
October 11, 1952.

Mr. R. Crowe-Swords,
414 Credit Foncier Building,
Vancouver 1, B. C.

Dear Mr. Crowe-Swords:-

Yesterday I visited the BOSUN MINE with Mr. Postlethwaite, and the following is a description of what I saw there at the shaft at level No. 7, and at the new raise in No. 7 level west drift. A sketch is enclosed which can be superposed on the main 40 scale plan of the mine.

SHAFT & STOPE AT No.7 level station.

A raise was started on a streak of galena on the east side of the station which was widened out to a small stope about fifteen feet long and twenty feet high. This extends nearly across the width of the shaft, as shown on the sketch. Above the top of the stope a small raise (which I did not climb) extends a considerable distance over the east side of the shaft and parallel to it in dip, as far as I could see. The pillar between the shaft and stope appears to be between six and seven feet in thickness and comparatively solid. Everything has been well timbered and appears to be entirely safe until the timber begins to rot, however some of the shaft timbering between the 6th and 7th levels should be reinforced before long as some of the timber joints are showing signs of rot.

NEW RAISE, 7 Level, west drift

The exact location of this raise is shown on the sketch. A quartz and calcite seam was followed up from the level to the vicinity of "A" where lead and a little zinc began to show and continues to the top of the raise. The width varies from eight to eighteen inches; the grade, when the width is considered, is not good enough to be commercial but appears to improve upward from "A". The top of the raise is approximately below where a toe of ore was mined along the bottom of the #6 level drift some time ago, so the prospects for ore between the top of the raise and the #6 drift look good.

A small raise for an ore pass is now being driven from the #7 level at a point a few feet west of the above described raise.

Apparently the small stope over the shaft at #7 level destroys the usefulness of the shaft for deeper use according to the letter of the law, but it is little more than a bulge in the raise and it seems to me that it is safe enough so that Mr. Peck would be justified in OKing the further use of the shaft. *I have not contacted Mr Peck*

I am feeling fairly well and slowly getting my strength back. I plan to start W.E.Co work monday.

Regards, Yours sincerely,

CS

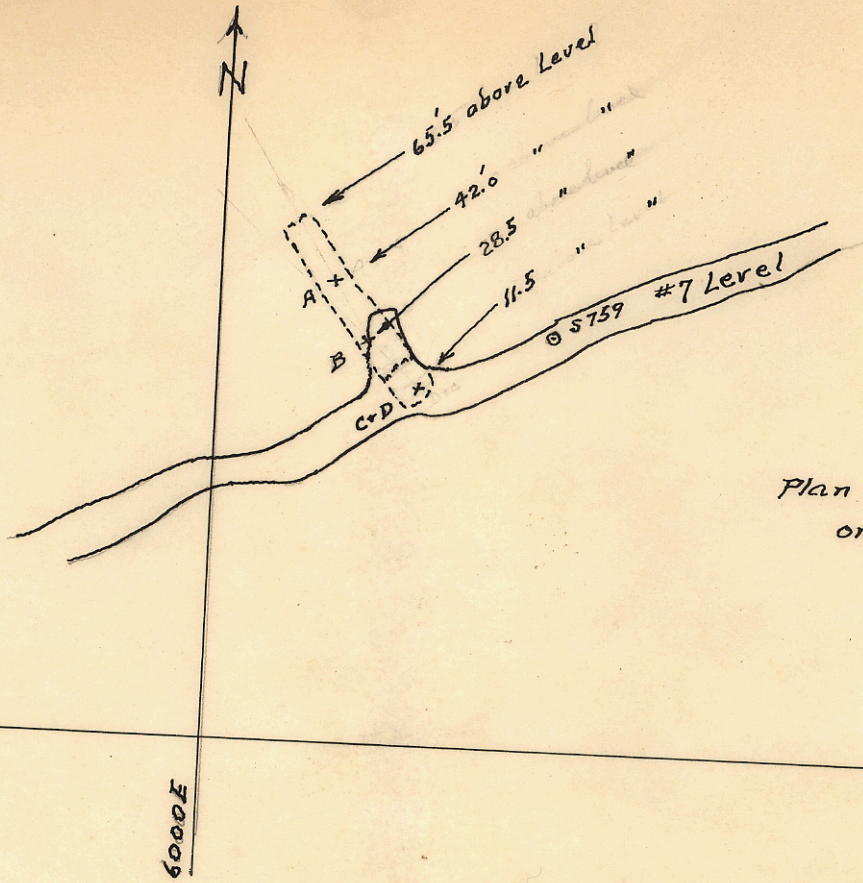

Level 7. - Plan.
Plan of New Raise
on #7 Level.

Oct 10, 1952
Compass survey
C.C.S.

5000 N

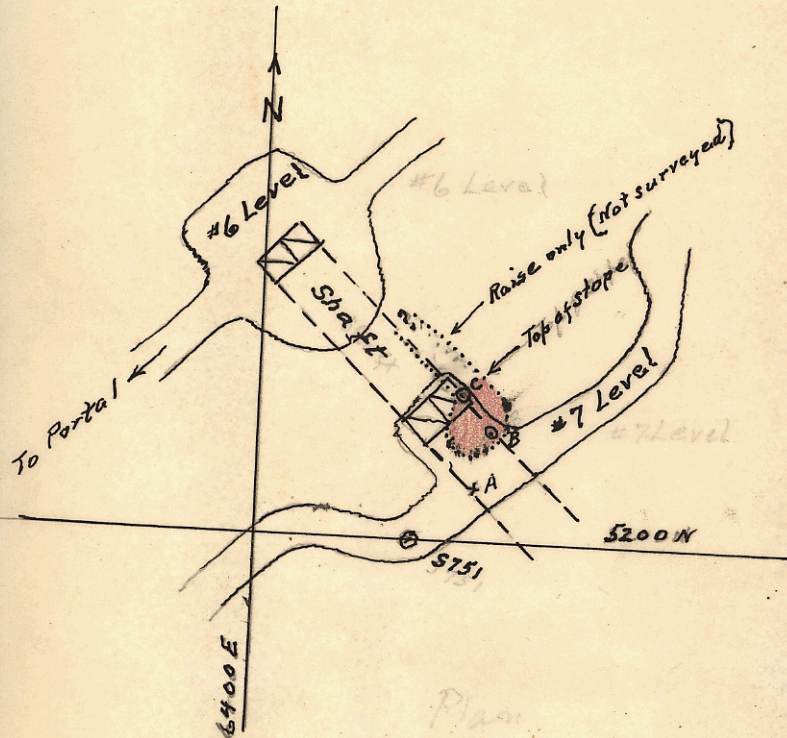

Plan
Plan of Small Stope
at Shaft on #7 Level.

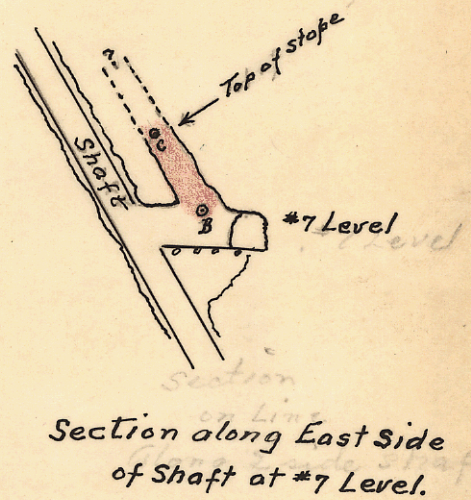

Section
Section along East Side
of Shaft at #7 Level.

PARTS OF BOSUN MINE

Silverton, B.C.

Scale: 1" = 40' 40"

Compass Survey.

C.C. Starr, Oct. 10, 1952