

PROPERTY FILE

West side of dig surface
1964

Crown adit in draw in section
to determine Cedar Creek

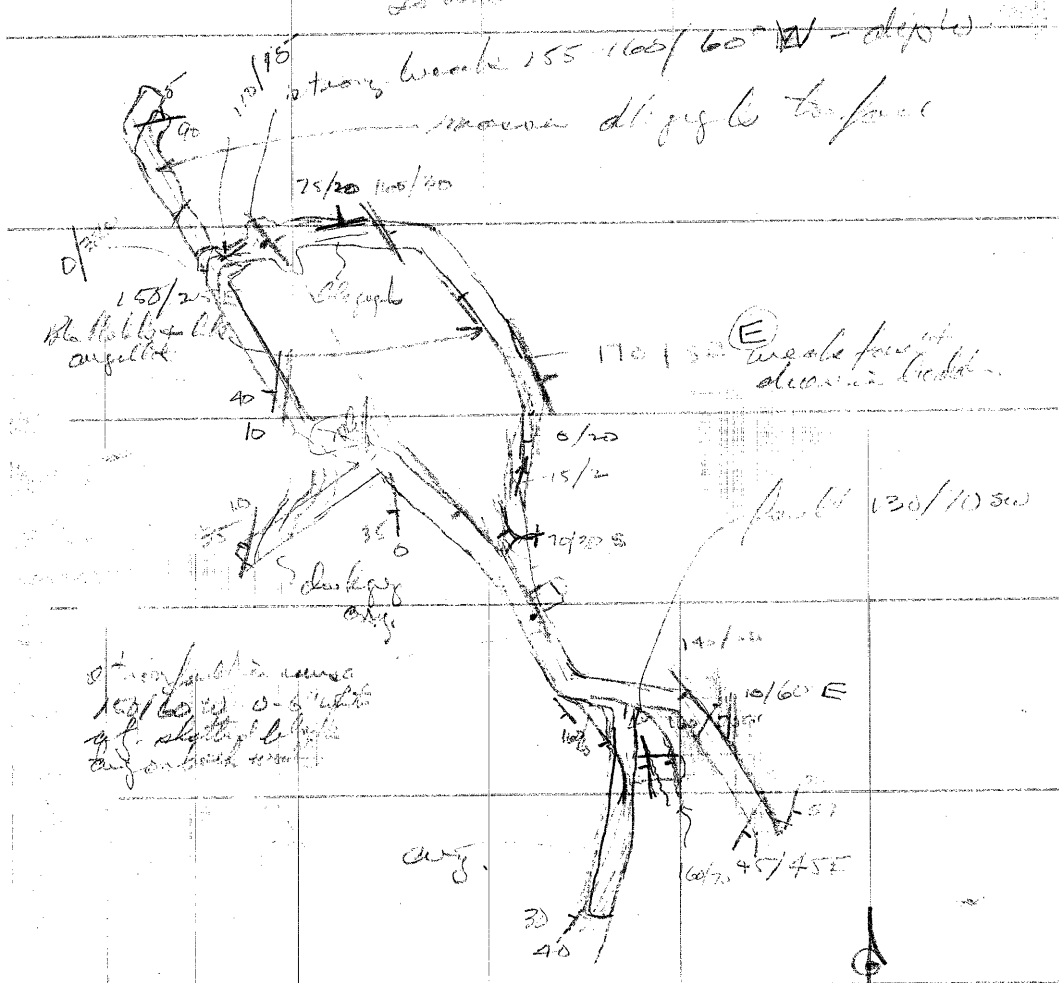

5' deep shaft in narrow
100/60 W 0-5' depth
of slightly below
top of bed

Compass orientation 1" = 40'

Remains to open on nearby creek
slope find out date large shaft
but 2 prospects 75' W / 10/30 E

001721

82FNE012 CROWN

304