

PROPERTY FILE BRICAN RESOURCES LTD.

808 - 602 WEST HASTINGS ST., VANCOUVER, B.C. V6B 1P1 CANADA

82E SW #59
021 VICTORIA
128 GOLD STANDARD. 001519
WRS -> PROPERTY FILE
CORPORATE OFFICE: (604) 681-2725
EXPL. OFFICE: (604) 542-8960
FAX: (604) 688-0598
N.A.S.D.A.Q. (U.S.) - BRIIF
LISTED V.S.E. - BRI

June 5, 1989

NEWS RELEASE

89-6

IMMEDIATE START PLANNED ON DRILL PROGRAM FOR JOLLY GOLD PROJECT

Brican Resources Ltd. is pleased to announce that Minnova Inc. plans a June, 1989 start on a diamond drill program on Brican's Jolly gold project, located in the Camp McKinney gold mining district near Rock Creek, B.C.

The Jolly property held by Minnova under option from Brican is a mesothermal gold prospect of a type similar to the deposits at Bralorne, B.C. or in the Mother Lode Belt, California. Gold in these deposits occurs in quartz veins and quartz-carbonate sheared and altered zones in basic volcanic and intrusive rocks.

At Camp McKinney, 1.4 miles to the west of the Jolly property, gold occurs in a mineralized quartz vein within an east-west trending structure. Production from the Cariboo-Amelia mine on this vein in the period 1894-1962 was 137,000 tons of ore grading 0.60 oz/ton gold and 0.24 oz/ton silver. (A previous hand sorted shipment of 25 tons of ore averaged 2.15 oz/ton gold and 5.2 oz/ton silver.)

East-west fault structures appear to control major creeks on the Jolly property. Sampling in these creeks has returned some very good grade gold samples including an altered zone in Rock Creek running 0.28 oz/ton gold over 3 feet and a grab sample from the same zone that assayed 1.74 oz/ton gold.

Strong north-northeast trending shear structures up to 100 feet in width also occur on the Jolly property and appear to be offset by the east-west zones. These shear zones commonly contain quartz-carbonate veins, pyrite and strong chlorite, talc, carbonate and serpentine alteration. In these zones the best mineralization found to date is in a copper-lead-zinc bearing quartz vein, from which a grab sample taken by Minnova ran 2.57 oz/ton gold and 2.40 oz/ton silver.

The geological setting and the results of sampling to date indicate strong potential for a gold deposit to occur on the property, either in the wide shear structures, or in quartz veins as at Camp McKinney.

Minnova conducted geophysical and geochemical surveys on the property in 1988. The results of these surveys, in combination with property geology and the high gold values from rock sampling have provided some very attractive drill targets.

The diamond drill program planned for June, 1989 will use 3,900 feet of diamond drilling in 7 holes to test these targets paying particular attention to those zones that appear to be along the trend of the mine at Camp McKinney. (See map on reverse.)

Brican looks forward to releasing the results of this drilling as soon as they are available.

Elsewhere in B.C., Brican is developing a \$300,000 to \$500,000 grid drilling program on its Man copper-gold property.

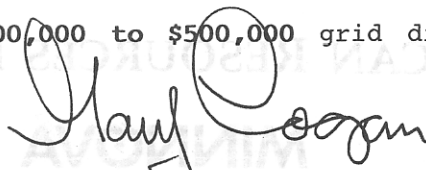
Gary Logan, B.Sc.
President

GROWTH THROUGH EXPLORATION IN NORTH AMERICA

JOLLY PROPERTY - PROPOSED DRILLING

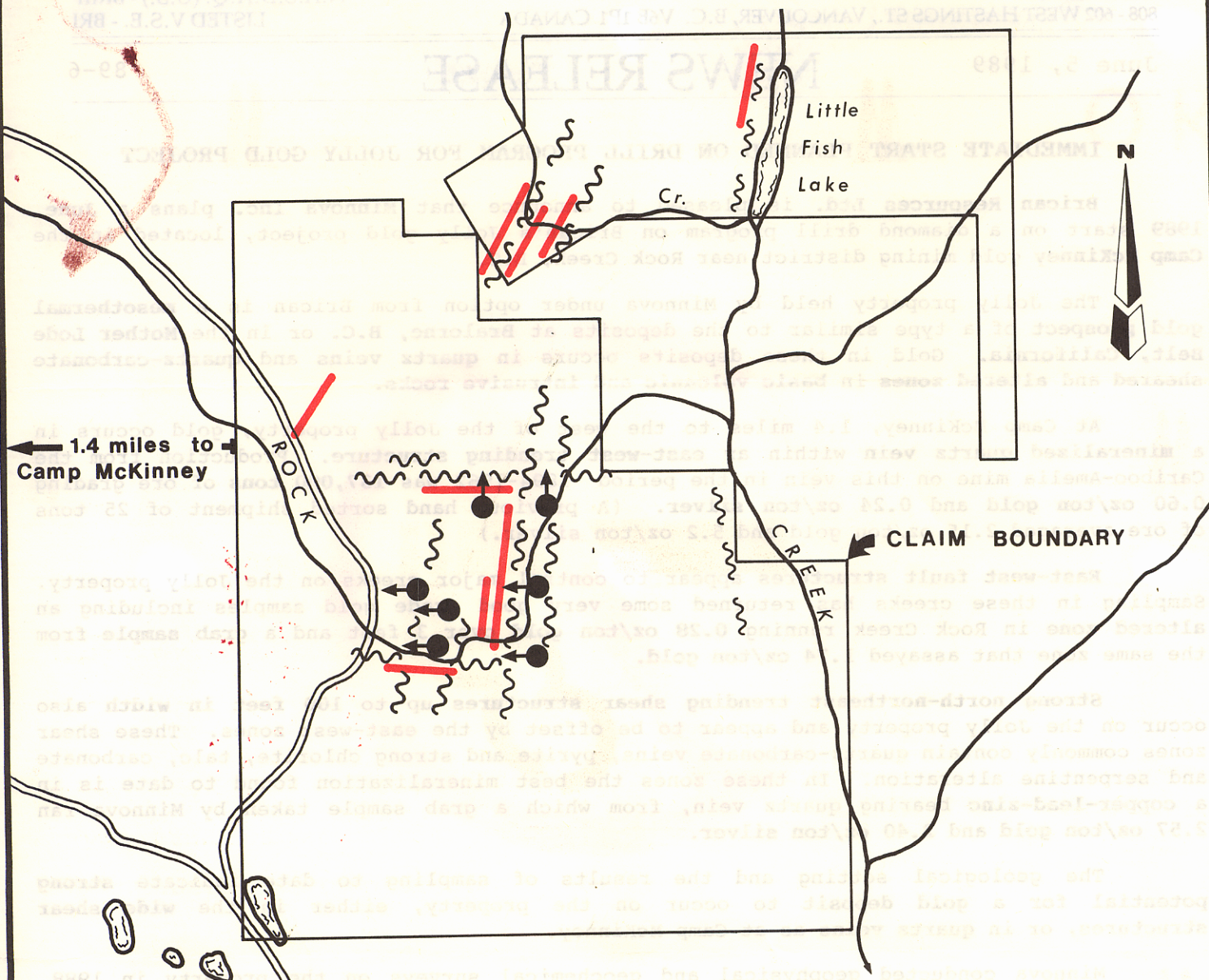

1.4 miles to
Camp McKinney

CLAIM BOUNDARY

- → PROPOSED DIAMOND DRILL HOLE
- ⋈ FAULT ZONE
- VEINS and MINERALIZATION

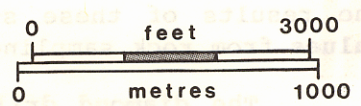

BRICAN RESOURCES LIMITED
MINNOVA

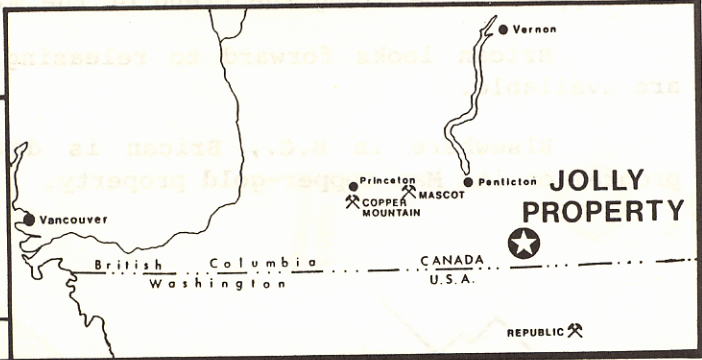

June 1989 82 E/3 Greenwood M.D.

REPUBLIC