

ORZENE
New?

1993

000847

PROPERTY SYNOPSIS

1. PROPERTY NAME:

ZALMAC PROPERTY - P and Z claims;
Lightning Peak Area,
Vernon Mining Division, British Columbia

2. PROPERTY OWNER:

ZALMAC MINES LTD.,
P.O. Box 298,
Vernon, B.C. V1T 6M2
Telephone: (604) 542-5173
Fax: (604) 542-7115

Contact Person: R.W. (Bob) Yorke-Hardy, A.Sc.T.,
Manager of Exploration and Development

3. EXPLORATION TARGETS:

- a). High grade vein type gold-silver-base metal deposits occurring in North-South, Northeast-Southwest and/or East-West trending fault systems hosted in a roof pendant of Permian aged metamorphic rocks intruded by Cretaceous aged granitic rocks;
- b). Large tonnage "Skarn-type" deposits containing copper-gold and/or silver-lead-zinc mineralization hosted in limestone or limey volcanic sequences of roof pendant mentioned above;
- c). Large tonnage "Porphyry Copper-Molybdenum deposit hosted mainly in Cretaceous granitic rocks north-east of roof pendant;
- d). Skarn associated industrial mineral deposits of garnet and wollastonite associated with limestone sequences of roof pendant mentioned above.

4. PROPERTY LOCATION, GEOLOGY AND DESCRIPTION:

The property is situated 68 kms. south-east of Vernon, B.C. and is accessed via series of logging roads after leaving Hwy. #6 on the Monashee Pass, some 52 kms. south-east of Lumby B.C.. The claims are located immediately north of Lightning Peak on map sheets N.T.S. 82L/15E & 16W.

The claims are underlain by remnants of a roof pendant of metamorphosed, Anarchist Group rocks including various volcanics, sandstones and limestones of Permian age which have been intruded by Nelson and Valhalla intrusives of Cretaceous age. These rock units have in turn been intruded by Tertiary volcanics in the form of dykes and as a volcanic plug which forms the core of Lightning Peak itself.

The region has been structurally well prepared by four sets of faults/shears which cross the lithology at various angles. Mineralizing fluids from intruding rock units have been able to invade the overlying Anarchist rocks which host most of the known mineral showings.

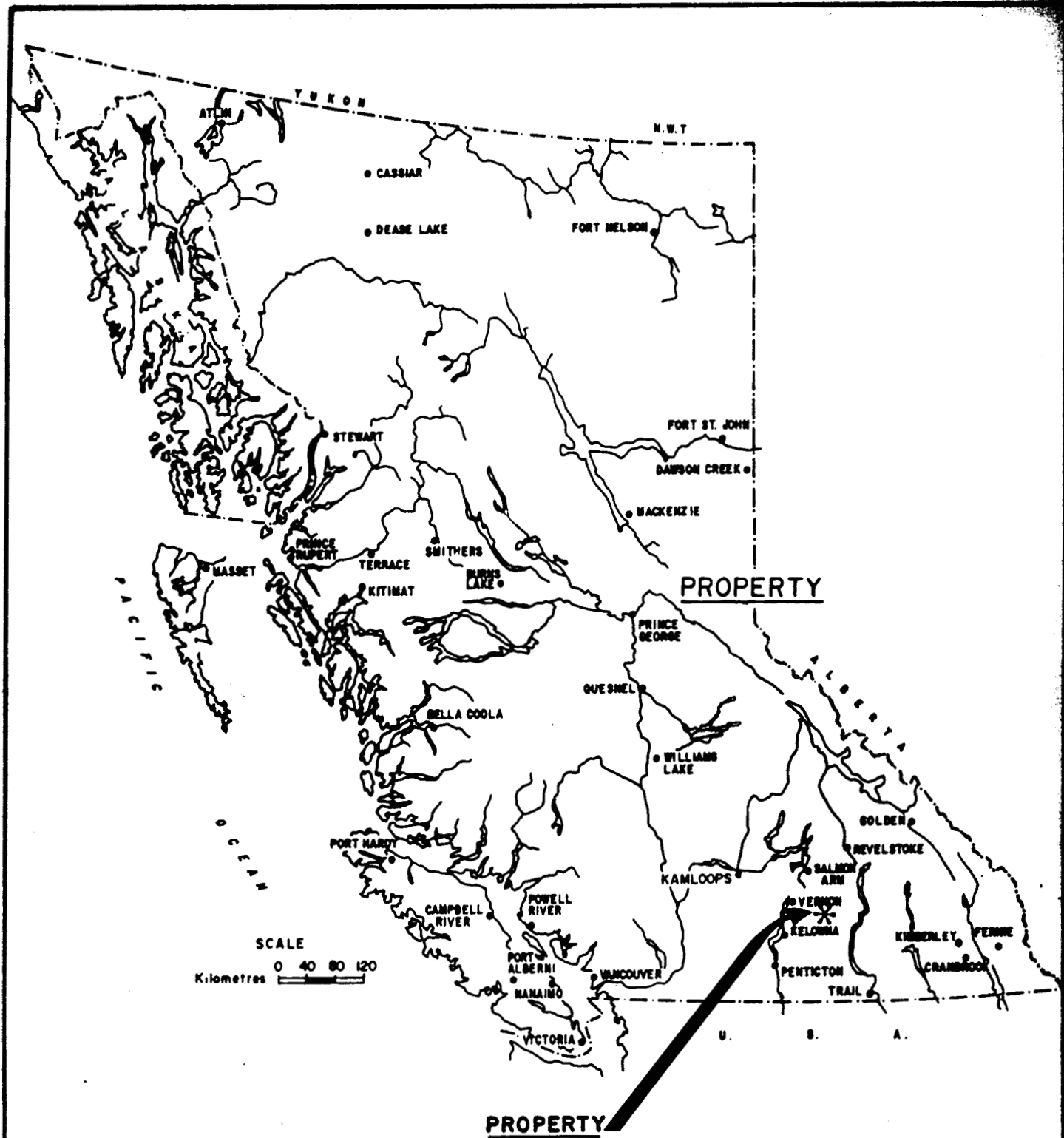

ZALMAC MINES LTD.

**P & Z CLAIMS
LIGHTNING PEAK AREA, B.C.**

LOCATION MAP

Y.-H. Technical Services Ltd.

DATE:
MARCH 1991

SCALE:
1:8,000,000

FIGURE No. 1

Zalmac's P and Z claims surround numerous old Crown Granted mineral claims from some of which high grade silver-base metal and gold ores have been mined. The old Rampalo C.G., from which some high grade silver ore was shipped, was acquired by staking in June of 1992 and now forms part of the Zalmac property. Previous work on this claim includes three adits, two of which are accessible. North-easterly trending quartz veins carrying substantial gold and silver values were the target of this pre 1930 development. A chip sample from the vein in the upper Rampalo adit returned 0.350 o.p.t. gold and 34.88 o.p.t. silver. *

The property consists of 131 units comprised of 49 mineral titles consisting of 6 - four post multi-unit, 44 - two post, and 1 fractional mineral claims covering an effective area of ~2725 hectares.

5. HISTORY:

The Zalmac property covers the majority of the area comprising the historic Lightning Peak mineral camp in which a minimum of 23 mineral showings were documented by Cairnes (GSC 1930 Summary Report, pp 79A - 115A). The Zalmac claims control all but 7 of these mineral showings plus additional mineral showing which have been encountered since 1930.

The Rampalo claim was the first claim to be staked on Lightning Peak (1897). By 1904 The Lightning Peak, Waterloo and Rampalo groups of claims had produced small shipments of high grade ore. By 1917 the Waterloo (C.G. Lot #4815 and the Lightning Peak Group (C.G.'s 3414-16) were being actively mined; while the Killarney, Pay Day, Rampalo, Potosi, Dictator and Lumpy properties were reporting encouraging mineralization. With the exception of the Waterloo, which has seen intermittent exploration, development and production as recently as 1984-85, very little work has been conducted on these properties since 1930.

Numerous mineralized structures cross-cutting the lithology have been identified but remain virtually untested. To date little effort has been made towards exploring the various lithological units for possible skarn or replacement type deposits. To date, work by Zalmac and others, has encountered numerous coincident geophysical and multi-element soil geochemical anomalies; most of which have not been physically explored and none of which have been drill tested. Significant gold, silver and base metal values have been obtained from many samples recently collected.



6. PROPERTY POTENTIAL:

There are several specific zones/areas of interest on the property. The most important of these are:

Rampalo/Victoria Showings-

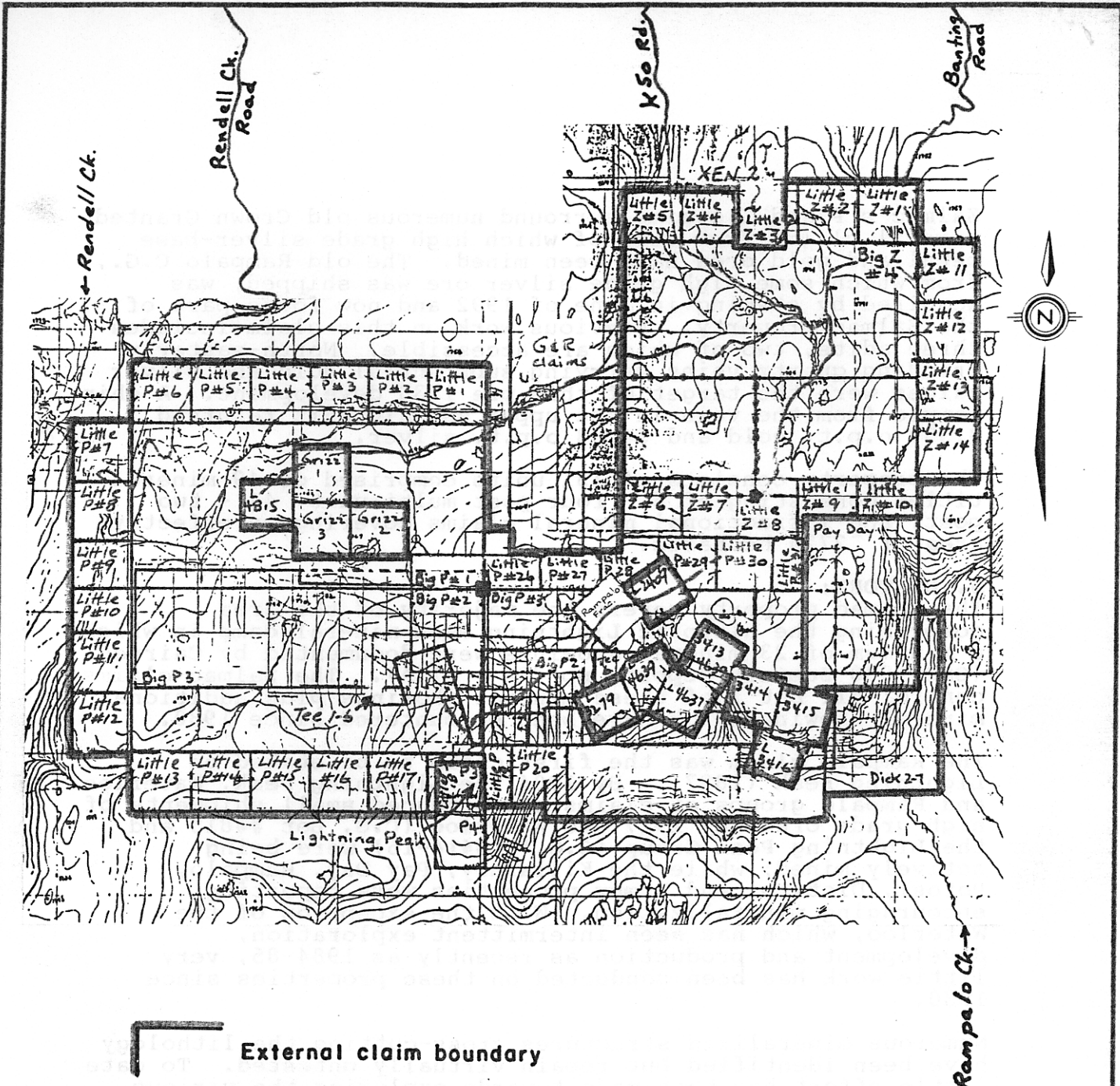
- a) Structurally controlled gold, silver, base metal mineralization assaying up to 0.454 opt. gold, 9.18 opt. silver at the Rampalo workings and 0.525 opt. gold, 13.78 opt. silver at the Victoria workings. Possible high grade shear/vein type deposit(s). North-east/south-west structures extend 1100 metres to the vicinity of the Lumpy Showings. *

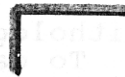

-  External claim boundary
-  Internal claim boundary

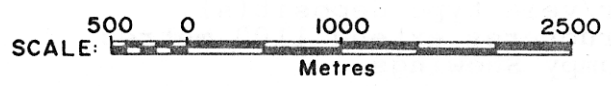

ZALMAC MINES LTD.		
P & Z CLAIMS		
LIGHTNING PEAK AREA, B.C.		
Claim Map		
Y.-H. Technical Services Ltd.		
Date:	Scale:	2
JAN. 1993	1:50,000	

- b) Possible large tonnage low grade gold silver base metal deposit occurring at the intersection of favourable lithological contacts and structures and/or at structural intersections.

Jon, S.E. Jon and Potosi; and Silver Spot Showings-

- a) East-west striking shear filling silver, lead, zinc mineralization extending west from the Waterloo mine. Mineralized float train extends some 300 meters to the west of the Waterloo claim boundary. Float assays range up to 2.48 opt silver, 3.00% lead, 24.7% zinc. The Waterloo mine produced high grade silver ore from workings commencing ~100 meters east of the western of the Waterloo claim boundary and extending east for some 300 meters. Good possibility of high grade shear/vein type deposit being developed both east and west of the Waterloo & Grizz claims.
- b) Structurally controlled gold, silver, base metal veins trending north-south. Samples ranging up to 0.76 opt gold, 0.29 opt silver. Good possibility of high grade deposit being developed at intersection of the north-south and east-west structures. The A.U. showings now located on the Grizz claims saw limited production of vein material returning 1.078 oz/ton gold, 19.6 oz/ton silver, 6.70% lead and 4.7% zinc. *
- c) Intersecting structures and/or intersecting structures with favourable lithological contacts/horizons forming possible large tonnage low grade deposit.

Rich Rock and Lumpy Showings-

- a) Skarn type or contact metasomatic type mineralization near the intrusive/Anarchist contact. Coincident multi-element soil geochem, VLF-EM and I.P.-Resistivity anomalies. Large tonnage deposit potential.
- b) Structurally controlled gold, silver, base metal veins trending north-east towards the Victoria and Rampalo workings.

Big Z #4 Showings-

- a) Large tonnage low grade Porphyry Copper-Molybdenum deposit in the vicinity of the old Pilot and Uta Showings and to the east.
- b) Structurally controlled silver, lead, zinc mineralization in the vicinity of strong multi-element soil geochem anomaly in north-west corner of Big Z #4 claim.

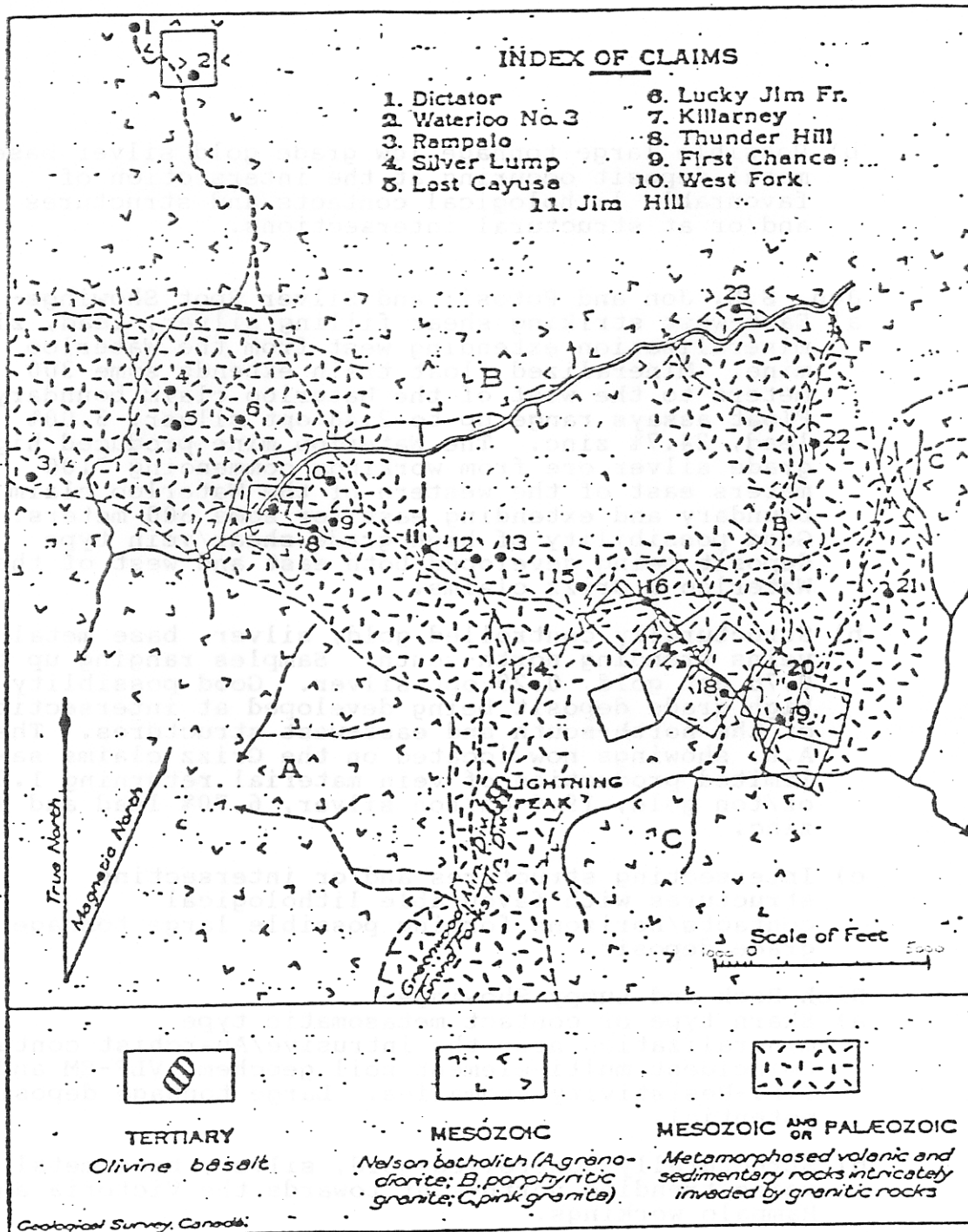

Lightning Peak area, Osoyoos district, British Columbia. Positions of mines, prospects, and other mineral discoveries are indicated by solid circles numbered as in text.

Figure from 1930 report by Cairnes.
Numbers also relate to this report.

ZALMAC MINES LTD.		
P & Z CLAIMS		
LIGHTNING PEAK AREA, B.C.		
Historic Properties & Mineral Discoveries		
Y.-H. Technical Services Ltd.		
Date: MARCH 1991	Scale: 1" = 5000'	Figure No. 4

Other Possibilities-

- a) Skarn type or contact metasomatic type deposits related to limestone rock units extending from the Jon Showings west of the Waterloo mine to the Lumpy Showing. A total distance of 2.5 kms. and four known north-westerly striking limestone units intruded by at least two stages of granitic rocks and one stage of volcanic rocks provide some ten kilometers of favorable contacts which have been transected by north-south, north easterly and east-west structures often known to carry mineralization.

7. RECOMMENDED EXPLORATION:

An Engineer approved exploration program was planned and work commenced in 1991; in order to systematically explore the Zalmac property. Due to lack of financing, progress has been slow; however, the work conducted under the program to date has proven very encouraging. In addition to the work previously recommended it is now evident that work should also be conducted to explore the major set of north-easterly trending faultsshears along which well mineralized vein material has already been encountered. Part of this work would include detailed mapping and sampling of the underground workings on the Rampalo showings.

8. PROPERTY AVAILABILITY:

The owners are actively seeking partners to financially assist in the continued exploration and development of the Lightning Peak property. Said investor group could gain a 50% interest by providing one million dollars (\$1,000,000.00) for exploration and development plus negotiable cash/stock payments over a three year period. Upon earning a 50% vested interest additional interests, up to a total of 80% could be earned by funding the project to the production decision stage. Thereafter the project would continue on an 80/20 joint venture or new company basis.

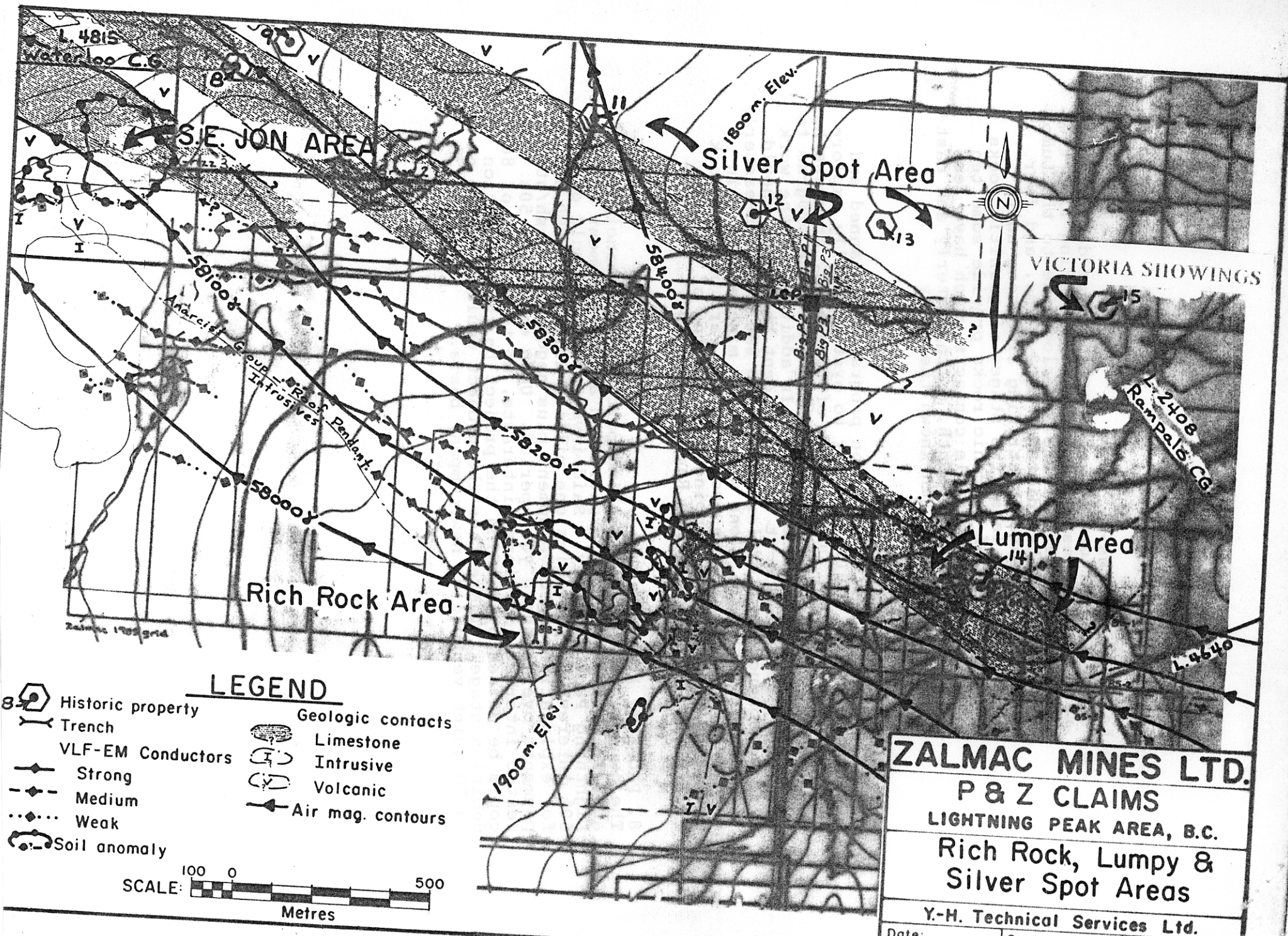

LEGEND

	Historic property		Geologic contacts
	Trench		Limestone
	VLF-EM Conductors		Intrusive
	Strong		Volcanic
	Medium		Air mag. contours
	Weak		
	Soil anomaly		

SCALE: 100 0 500
Metres

ZALMAC MINES LTD.
P & Z CLAIMS
 LIGHTNING PEAK AREA, B.C.
 Rich Rock, Lumpy &
 Silver Spot Areas
 Y.-H. Technical Services Ltd.
 Date: _____