

DIAMOND DRILLING SUMMARY
GOTCHA, GOTCHA 2, GOTCHA 3 CLAIMS
KAMLOOPS MINING DIVISION

82M13E

Lat. $51^{\circ}50'N$; Long. $119^{\circ}42'W$

PROPERTY FILE

for

DIMAC RESOURCE CORP.
(owner & operator)

by

ROBERT A. DICKINSON
(Geologist & President)

February 1, 1980

TABLE OF CONTENTS

	<u>Page</u>
1. INTRODUCTION	1
2. OWNERSHIP	1
3. LOCATION ACCESS & TOPOGRAPHY	1
4. REGIONAL GEOLOGY	4
5. GENERAL GEOLOGY OF THE PROPERTY	5
a) Previous Work	5
b) Rock Types	6
c) Metamorphism and Skarn Formation	9
6. DRILL HOLE DATA	10
7. DRILL HOLE LOGS AND ASSAY RESULTS	11
8. EXPENDITURE STATEMENT	11
9. QUALIFICATION AND CERTIFICATION	12

LIST OF ILLUSTRATIONS

FIGURE 1 - GENERAL LOCATION SKETCH	2
FIGURE 2 - PIT LOCATION AND AREA OF DRILLING	3
MAP 1 - DRILL HOLE LOCATIONS	in pocket
MAP 2 - PIT LOCATION RELATIVE TO TOPOGRAPHY	in pocket

1. INTRODUCTION

This report is a compilation of data obtained during a diamond drill program undertaken through the period, November 5, 1979 - January 17, 1980 on Dimac Resource Corp.'s Gotcha Tungsten Property. A total of 20 BQ diamond drill holes were completed during this program. Total metres drilled were 544 (1799 ft.).

The drill holes were closely spaced and confined to a small open pit area located on the boundary of the Gotcha and Gotcha 2 claims. The location of the pit and drill holes is shown on Figure 2 and Map 1. Map 2 is included in this report only to show the pit's position relative to surveyed topography. The purpose of the drill program was to drill prove reserves indicated possible by previous work.

Financial assistance was provided by the BCDM in the form of MEIP Contract #46.

2. OWNERSHIP

The Gotcha claim group is owned by Dimac Resource Corp. and consists of:

<u>Claim</u>	<u>Record No.</u>	<u>No. of Units</u>
Gotcha	881	1
Gotcha 2	786	9
Gotcha 3	1927	9

3. LOCATION, ACCESS & TOPOGRAPHY

The Gotcha claims are located 20 miles northeast of Clearwater, British Columbia and are within the Kamloops Mining Division (see Figure 1). More specifically, the claims are 2 miles up Maxwell Creek from its junction with Raft River, on the west

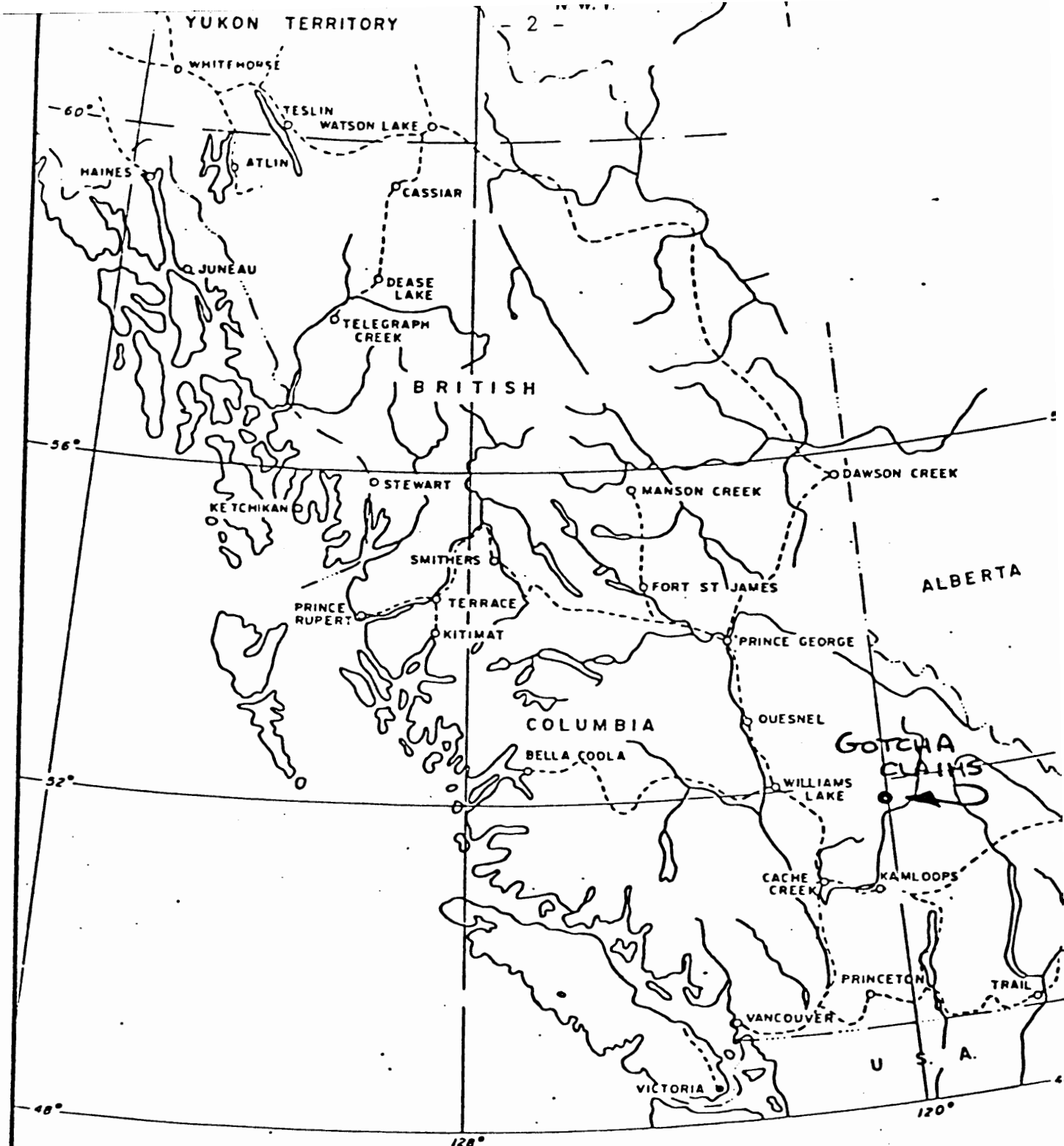

DIMAC RESOURCE CORP.
 GENERAL LOCATION SKETCH

FIGURE 1

SCALE: 1" = 125 MILES

1955 (7)
4757

MAX (5)
1779 (3)

MAX (4)
1778 (3)

MAX (6)
1780 (3)

MAX (3)
1777 (3)

MAX
1593 (11)

MOSQUITO
1731 (3)

MOSQUITO II
139 (10)

MAX (2)
1776 (3)

MOSQUITO III
68 (7)

MOSQUITO IV
1717 (2)

PITTSBURGH
69 (7)

AREA OF
BUG
1718 (2)

GOTCHA 2
LCP
786 (4)

GOTCHA 3
LCP
1145 (2)

GOTCHA 4
#47527

GOTCHA 5
#47528

LOGGING ROAD LCP
TAILINGS
#47533

LCP
RAILROAD
SILENCE LAKE
RAILROAD

TO CLEARWATER
APPROX 21 MILES
33.7 KMS

SI 1
1359 (8)

FIGURE 2

RIM 2 2210 (10)	RIM 1 2209 (10)
RIM 4 2212 (10)	RIM 3 2211 (10)



KANLOOPS M.D.
82 N 13 E

Scale 1:50,000

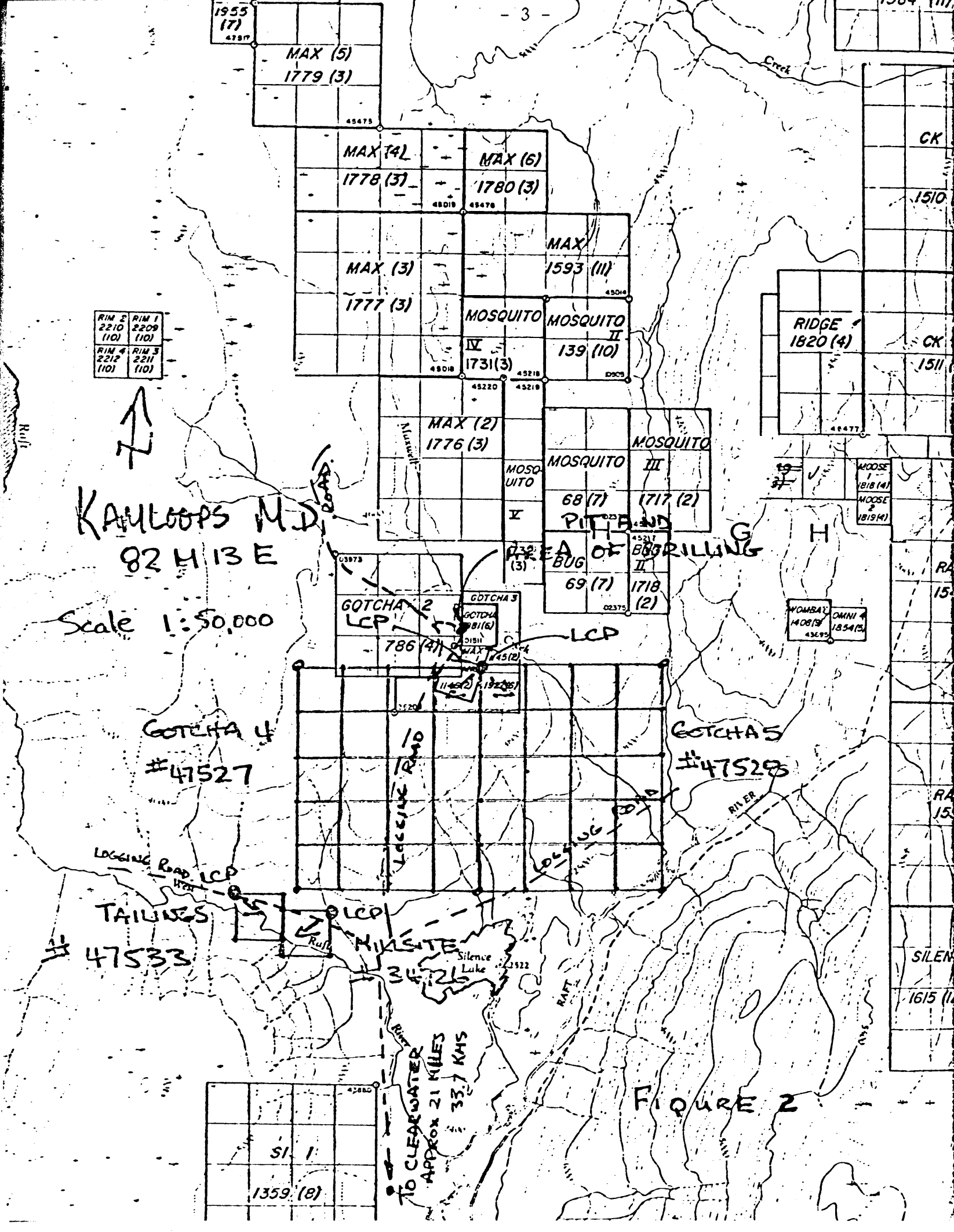

bank of the creek, at an elevation of about 3,750 ft. The claim group is covered by the Raft River map 82M/13E of the 1:50,000 topographic series and by the northwest corner of the Geological Survey of Canada map 48.1963 Adams Lake 82M/W.

A well maintained logging road along the west bank of Raft River and Maxwell Creek provides access to the property. This road adjoins the Yellowhead Highway (Route 5) 4 miles east of Clearwater.

The claims are located on the thickly vegetated west side of the valley which in the area of the claims is sloping at 20° to 45° towards Maxwell Creek.

4. REGIONAL GEOLOGY

The claim group lies within the Omineca Crystalline Belt which is the high grade metamorphic core zone of the Eastern Cordilleran Fold Belt. Rocks in the zone have generally been metamorphosed to upper amphibolite facies and have experienced multiple phases of intense penetrative deformation. The deformation and metamorphism were probably completed by late Jurassic to early Cretaceous times but the stratigraphic age of some of the metasediments is at least 1500 m.yr. Large volumes of "granitic" rock were intruded into the belt during and after the protracted metamorphism and deformation.

The property covers an area of contact between the metasediments and a post metamorphic stock. The metasediments may correlate with the Lower Paleozoic, quartzite, limestone assemblage of the Kootenay Arc to the southwest, though such a correlation is extremely tenuous. The stock may be late Cretaceous or early Tertiary in age based on a single muscovite

potassium-argon age of 64 m.yr. from a phase of the stock.

5. GENERAL GEOLOGY OF THE PROPERTY

a) Previous Work

The property was first found in July 1972 by Union Carbide as a result of a regional stream sampling program. Silts in Maxwell Creek at its confluence with Raft River have anomalously high scheelite content; the anomaly can be traced back up the creek to scheelite bearing boulders in the creek below the present pit. UNION Carbide worked on the property from 1972 to 1974 and called it the Boulder Group. In the summer of 1972 preliminary trenching exposed mineralized skarn and geological mapping revealed the presence of two skarn bands. Diamond drilling of holes 1, 2, 3, 4, 5, 6 & 7 (total length 1,769.3 ft./534 m.) was completed in the winter of 1972/1973. The next summer further mapping and trenching took place. Also a soil sampling grid (7000 ft./2112.9 m. x 4000 ft./1207.4 m., sample spacing 200 ft./604 m.) was established over the property and surrounding ground. Soil samples were collected and panned for scheelite but no major anomalies other than those previously identified in the vicinity of the pit were found. In the winter of 1973/1974 diamond drill holes 8, 9 and 10 were drilled (total length 1,436 ft./433 m.).

The property was restaked by United Mineral Services Ltd. in 1977 who extended some of the trenches and exposed more mineralization. N.C.A. Mineral Corp. optioned the property in 1977 and in January 1978 drilled 18 percussion holes (total length 950 ft./287 m.) before the option was terminated. In 1978 a pit was opened up and about 1500 tons (1364 tonnes) of about 1.5% scheelite ore mined. The pit area was surveyed during July 1979 by Dr. Barry Ryan.

Dimac Resource Corp., a subsidiary of United Mineral Services took over the property and carried out the drill program which is the subject of this report.

b) Rock Types

Most of the outcrop in the area occurs in the pit or in the walls of the trenches. In the rest of the area bedrock is covered by up to 50 feet of till. Outcrops of metasediments, skarns and quartz monzonites. Five main rock types have been identified (1) medium grained biotite-quartz monzonite; (2) medium to coarse grained alaskite or muscovite granite; (3) biotite schist; (4) biotite quartzite; (5) skarn or calc-silicate.

Medium grained, biotite-quartz monzonite - Quartz monzonite outcrops extensively on the access road to the pit as an orange to brown weathering moderately well fractured rock containing no macroscopic fabric. In detail the quartz monzonite is a medium grained, equigranular, biotite (5 to 15%) quartz monzonite. The biotite does not outline a foliation and the rock generally has a very uniform appearance; veins of pegmatite or xenoliths of metasediments are rare. Contacts of quartz monzonite with the metasediments generally appear to be conformable.

Alaskite - Outcrops of alaskite occur in the pit and adjacent to the pit. In the pit fresh boulders are massive and chalky white. The grain size of the alaskite varies from medium to coarse, and the texture is generally equigranular but in places graphitic. Quartz makes up about 60% of the rock, most of the rest is composed of equal proportions of plagioclase and K-feldspar, no mafic minerals are present and muscovite (sericite?) is present in amounts up to 5%. There is no fabric to the rock except for occasional quartz stringers and pegmatite

veins. The upper contact of alaskite with skarn is locally discordant and interfingered by skarn, but over a distance of 60 metres seems to be approximately concordant. There is no distinct border phase, though the upper part of the alaskite may be mixed with a considerable amount of skarn. The lower contact of alaskite with skarn appears to be fairly distinct and concordant.

The alaskite does not extend northwest of the pit and outcrops southeast of the pit along strike are pegmatitic and contain a considerable amount of metasedimentary material.

Muscovite separated from the alaskite has a K-Ar model age of 64 m.yr. +/- 2 m.yr.

Schist - Outcrops of brown weathering, medium banded, well foliated schist account for about 20% of the exposed rock. The schist is medium grained and contains 40% quartz, 20% feldspar and 20% biotite. More exotic minerals are absent and the only major variation from this sample mineralogy is the appearance of large disoriented flakes of sericite in the schist near contacts with the alaskite or quartz monzonite. The schist grades to biotite quartzite with increase in quartz content.

Biotite Quartzite - This rock type forms massive to medium banded, brown weathering outcrops that account for about 10% of the exposed rock. In appearance the quartzite is similar to the schist but banding is coarser and foliation is absent.

Skarn or Calc-silicate - calc-silicate rocks and skarns derived from them, make up about 30% of the exposed rock. Outcrops of calc-silicate have a distinctive grey, pitted surface if the

rock contains significant amounts of calcite or are grey-green and coarse banded if the amount of silica is high. Calc-silicate adjacent to alaskite or quartz monzonite is converted to skarn of which there are 3 major types; types (1) and (3) are scheelite bearing.

- 1) Quartz-garnet (grossularite?)-idocrase skarn
- 2) Wollastonite-garnet-calcite skarn
- 3) Diopside-quartz skarn

Quartz-garnet-idocrase skarn forms massive, rough surfaced, brown outcrops with indistinct layering. In hand specimen it is coarse to very coarse grained containing from 10 to 50% idocrase, 10 to 50% garnet and 10 to 50% quartz. Garnet occurs as clusters of euhedral, medium grained crystals or as coarse grained, subhedral crystals. Often there appears to be two generations of garnets with the subhedral crystals belonging to the earlier generation. Idocrase forms coarse grained, sub-euhedral crystals. Quartz forms a coarse grained matrix to these two mafic minerals.

Wollastonite-garnet-calcite skarn forms chalky white, rough surfaced outcrops. Garnet which makes up 5 to 20% of the rock occurs as medium grained, equigranular crystals clustered together in 1 to 5 cm. diameter masses. Wollastonite forms radiating masses growing outward from the garnet masses. Calcite occurs as medium to coarse grained masses often outlining the indistinct layering.

Diopside-quartz skarn forms massive to medium banded, grey to greenish outcrops. The fine grained nature of the skarn precludes a detailed description of its mineralogy but it certainly contains a high proportion of diopside and probably other minerals such as actinolite and epidote. Fresh samples are dark green to black, medium to fine grained and fine to medium banded.

In the vicinity of the pit, the skarn derived from the calc-silicate forms 5 major bands. Three of these bands contain economic quantities of scheelite mineralization.

c) Metamorphism and Skarn Formation

The rock types have been affected by regional metamorphism of upper amphibolite grade that probably finished by late Jurassic time; by contact metamorphism, caused by intrusion of the quartz monzonite, and possibly at about the same time by metasomatism originating from the alaskite. The contact metamorphism and metasomatism probably occurred 64 m.yr. ago, long after the deformation and regional metamorphism had ceased.

It is difficult to distinguish between the effects of contact metamorphism and metasomatism but in the pit area a sequence of metasomatic changes can tentatively be identified. The quartz-garnet-idocrase skarn seems to be the end result of metasomatism involved introduction of iron and crystallization of garnet probably grossularite. The second stage saw introduction of silica and crystallization of wollastonite. This was followed by continued introduction of silica and crystallization of idocrase and garnet possibly at the expense of wollastonite. The final stage was represented by silica flooding and introduction of tungsten which crystallized as scheelite (powellite has not been observed).

The diopside-quartz skarn apparently has not experienced the same degree of metasomatism though there are vuggy zones in which patches of coarse calcite and idocrase crystals occur. Scheelite seems to be concentrated in these zones but also occurs as coarse grained poikilotic crystals enclosing diopside, scattered through the rock.

6. DRILL HOLE DATA

The following compilation shows pertinent data for the twenty holes drilled. The hole locations are shown on Map 1 in relation to the prominent ~~pit~~ located on the property.

<u>Hole No.</u>	<u>Collar Elevation</u>	<u>Azimuth</u>	<u>Dip</u>	<u>Metres Drilled</u>	<u>Feet Drilled</u>
79-1	3730	160	55	25.05	83
79-2	"	164	55	37.73	125
79-3	"	105	44	35.31	117
79-4	"	105	80	26.56	88
79-5	"	171	55	41.65	138
79-6	3750	179	88	31.09	103
79-7	"	179	54	10.87	36
79-8	"	205	55	10.56	35
79-9	3730	171	80	29.28	97
79-10	"	166	45	26.56	88
79-11	"	197	66	27.47	91
79-12	"	166	80	29.28	97
79-13	"	142	57	33.20	110
79-14	"	116	51	8.15	27
79-15	"	120	60	26.65	85
79-16	"	116	75	23.54	78
79-17	"	174	60	21.13	70
79-18	"	012	44	35.50	111
79-19	"	187	49	31.69	105
79-20	"	265	45	34.71	115
<u>Total</u> 20				<u>544</u>	<u>1799</u>

7. DRILL HOLE LOGS AND ASSAY RESULTS

Field drill logs are presented in this section complete with WO₃ assays made. A total of 118 assays for WO₃ were made on split core sections by Chemex Labs of North Vancouver. All drill core is stored at Dutch Lake Resort, Clearwater, B.C.

8. EXPENDITURE STATEMENT

The total cost of the drill program was \$50,492.07. This expenditure is supported by invoices included in this section and can be allocated as follows:

Drilling

Drill contractors	\$41,626.10	
Core storage	87.79	
Vehicles & water truck	3,863.05	
Room & board	1,171.85	
Supervision	1,109.13	
Site preparation	1,314.75	
Communication	<u>140.40</u>	\$49,313.07

Assaying

WO ₃ Assays		<u>1,179.00</u>
TOTAL		<u>\$50,492.07</u>

Diamond Drill Record

COLLAR: NORTH _____		HOLE SURVEY		
		FOOTAGE	AZIMUTH	DIP
EAST _____		117	105°	44°
ELEVATION 3730'				
LOGGED BY M. McClaren				
DATE LOGGED _____				
MAP REFERENCE NO. _____		METHOD: Brunton		

COMPANY NAME	DIMAC
PROPERTY NAME	GOTCHA
DRILLING CONTRACTOR	EAGLE
ASSAYER	CHEMEX
PURPOSE OF HOLE	_____

HOLE NO.	D-79-3
CLAIM NAME	_____
COMMENCED	_____
FINISHED	_____
PROJECT NO.	_____

FROM	TO	RECOVY	DESCRIPTION	SAMPLE				ASSAYS					
				FROM	TO	WIDTH	NO.	%W ₃					
0'	13'		CASING										
13'	28'	80%	Coarse grained, Garnet-diopside-idocrase-quartz skarn COARSE	13'	18'	5'	22016	0.59					
			SCHEELITE ≈ .5%	18'	28'	10'	22017	1.03					
28'	29'	90%	Quartz 'vein' segregation										
29'	32'6"	95%	Quartz-garnet-diopside-skarn grading into a banded diopside-epidote-tremolite skarn	28'	33'	5'	22018	0.41					
32'6"	33'	95%	Siliceous, garnet-diopside skarn COARSE SCHEELITE ≈ 1%										
33'	35'	95%	Garnet-calcite-diopside skarn										
35'	43'	95%	Wollastonite-garnet-diopside skarn										
43'	49'	50%	Biotite schist (some minor garnet-diopside) C/B 35°										
49'	58'	80%	Biotite schist with highly quartzose sections and a 2½' section that resembles quartzo-feldspathic gneiss										
58'	61½'	95%	Banded, epidote-tremolite-diopside skarn										
61½'	64'	80%	Biotite schist										
64'	83'	80%	Biotite-quartz monzonite										
			Sections show distinct lineation of biotite at C/B 35° Inclusions of biotite schist at 81'										
83'	89'	50%	Biotite schist										
89'	91'	80%	Banded, diopside-tremolite skarn C/B 35°										
91'	96'	95%	Banded, diopside-tremolite skarn COARSE SCHEELITE ≈ .5%	90'	96'6"	6'6"	22019	0.96					

Diamond Drill Record

COLLAR:		HOLE SURVEY		
NORTH _____	FOOTAGE	AZIMUTH	DIP	
EAST _____	138	171°	55°	
ELEVATION <u>3730'</u>				
LOGGED BY <u>M. McClaren</u>				
DATE LOGGED _____				
MAP REFERENCE NO. _____	METHOD: <u>Brunton</u>			

COMPANY NAME DIMAC
 PROPERTY NAME GOTCHA
 DRILLING CONTRACTOR BUCCANEER
 ASSAYER CHEMEX
 PURPOSE OF HOLE _____

HOLE NO. <u>D-79-5</u>
CLAIM NAME _____
COMMENCED _____
FINISHED _____
PROJECT NO. _____

FROM	TO	RECOVY	DESCRIPTION	SAMPLE				ASSAYS					
				FROM	TO	WIDTH	NO.	%WO3					
0	15'		CASING										
15'	27'8"	80%	Alaskite, intensive silicification and sericitization										
27'8"	32'9"	90%	Coarse grained siliceous garnet-diopside-idocrase skarn C/B 35°										
32'9"	46'	90%	Siliceous garnet-diopside skarn	38'6"	46'	8½'	22028	2.10					
			SCHEELITE	32'9"	38'6"	5'9"	22027	0.03					
46'	48'	50%	Contact between 1' section of biotite schist and skarn	46'	51'6"	5'6"	22031	0.98					
48'	51'6"	85%	Siliceous garnet-diopside skarn SCHEELITE										
51'6"	59'6"	90%	Calcite-wollastonite skarn										
59'6"	61'3"	90%	Banded diopside-tremolite skarn										
61'3"	64'7"	90%	Calcite-wollastonite skarn										
64'7"	65'	95%	Banded diopside-tremolite skarn										
65'	70'	95%	"Granite", weathered qtz. monz.										
70'	73'9"	95%	Biotite schist C/B 35°										
73'9"	78'2"	95%	Intermixture sil. sect. & garnet-trem-epid-skarn										
78'2"	81'5"	95%	Biotite schist										
81'5"	88'6"	95%	Intermixture of sil. sect. & garnet skarn & biotite schist										
88'6"	98'9"	95%	Porphyritic quartz monzonite										
98'9"	101'	95%	Banded diopside-biotite skarn SCHEELITE	98'8"	99'8"	1'	22039	0.81					
101'	106'9"	95%	Coarse grained siliceous garnet-diopside	101'11"	102'6"	7"	22041	0.93					
			-idocrase skarn	102'6"	103'6"	1'	22042	0.13					

Diamond Drill Record

COLLAR: ,		HOLE SURVEY		
NORTH _____	FOOTAGE	AZIMUTH	DIP	
EAST _____	97	166	80	
ELEVATION <u>3730'</u>				
LOGGED BY <u>M. McClaren</u>				
DATE LOGGED _____				
MAP REFERENCE NO. _____	METHOD: Brunton			

COMPANY NAME DIMAC
 PROPERTY NAME GOTCHA
 DRILLING CONTRACTOR EAGLE
 ASSAYER CHEMEX
 PURPOSE OF HOLE _____

HOLE NO. <u>D-79-12</u>
CLAIM NAME _____
COMMENCED _____
FINISHED _____
PROJECT NO. _____

FROM	TO	RECOVY	DESCRIPTION	SAMPLE				ASSAYS					
				FROM	TO	WIDTH	NO.	%WO ₃					
0'	12'		CASING										
12'	17'	95%	Banded epidote-tremolite skarn										
17'	20'	90%	Siliceous, chlorite-diopside-epidote skarn										
20'	34'	90%	Biotite schist C/B 60° @ 23' to 27' Siliceous 'granitic'(?) section										
34'	51'	95%	Biotite granodiorite										
51'	56'	50%	Broken ground, Banded, epidote - diopside skarn(?)										
56'	57'8"	95%	Banded, epidote-garnet-diopside skarn	56'	57'8"	1'8"	22169	1.56					
			SCHEELITE										
57'8"	60'1"	95%	Coarse, garnet-idocrase skarn										
			SCHEELITE	57'8"	60'1"	2'3"	22170	3.18					
60'1"	62'	95%	Banded, chlorite-diopside-epidote skarn										
			SCHEELITE C/B	60'1"	62'	1'11"	22171	0.28					
62'	63'7"	95%	Banded chlorite-diopside-epidote skarn SCHEELITE	62'	63'7"	1'7"	22172	3.60					
63'7"	66'2"	95%	Banded chlorite-diopside-epidote skarn V.M. SCHEELITE	63'7"	66'2"	2'7"	22173	0.08					
66'2"	70'10"	80%	Banded chlorite-diopside skarn with silicious garnet sections	66'2"	70'10"	4'8"	22174	2.30					
			SCHEELITE										
70'10"	75'10"	95%	Banded diopside-garnet-chlorite skarn SCHEELITE	70'10"	75'10"	5'	22175	1.93					

Diamond Drill Record

COLLAR:		HOLE SURVEY		
NORTH _____	FOOTAGE	AZIMUTH	DIP	
EAST _____	111	012°	44°	
ELEVATION <u>3730'</u>				
LOGGED BY <u>M. McClaren</u>				
DATE LOGGED _____				
MAP REFERENCE NO. _____	METHOD: <u>Brunton</u>			

COMPANY NAME _____	<u>DIMAC</u>
PROPERTY NAME _____	<u>GOTCHA</u>
DRILLING CONTRACTOR _____	<u>BUCCANEER</u>
ASSAYER _____	<u>CHEMEX</u>
PURPOSE OF HOLE _____	

HOLE NO <u>D-79-18</u>
CLAIM NAME _____
COMMENCED _____
FINISHED _____
PROJECT NO. _____

FROM	TO	RECOVY	DESCRIPTION	SAMPLE				ASSAYS					
				FROM	TO	WIDTH	NO.	%W ₃					
0'	12'		CASING										
12'	13'	95%	Siliceous, garnet-diopside skarn SCHEELITE (BOULDER?)	12'	13'	1'	22137	2.43					
13'	21'	95%	Siliceous "contact" zone										
21'	25'	95%	Coarse grained, garnet-idocrase skarn										
25'	39'6"	95%	Banded epidote-tremolite skarn C/B 70°										
39'6"	40'6"	80%	Quartz segregation										
40'6"	41'3"	90%	Siliceous, garnet-diopside skarn SCHEELITE	40'6"	41'3"	9"	22138	0.21					
41'3"	42'8"	90%	Siliceous, garnet-diopside skarn										
42'8"	46'4"	95%	Calcite-wollastonite-garnet skarn										
46'4"	56'	95%	Siliceous, garnet-diopside skarn										
56'	57'6"	95%	Coarse grained, garnet-diopside skarn										
57'6"	59'1"	95%	Coarse grained, garnet-diopside skarn SCHEELITE	57'6"	59'1"	1'7"	22139	0.70					
59'1"	60'3"	95%	Coarse grained, garnet-diopside-idocrase skarn										
60'3"	65'	95%	Coarse grained, garnet-idocrase skarn SCHEELITE	60'3"	65'	4'9"	22140	0.79					
65'	66'3"	95%	Siliceous, coarse grained, garnet-diopside skarn										
66'3"	66'10"	95%	Siliceous, coarse grained, garnet-diopside-idocrase skarn SCHEELITE	66'3"	66'10"	7"	22141	0.91					
66'10"	67'10"	95%	Siliceous, garnet-diopside skarn										
67'10"	73'7"	95%	Siliceous, garnet-diopside skarn SCHEELITE	67'10"	73'7"	5'9"	22142	1.14					
73'7"	84'6"	95%	Banded epidote-tremolite skarn										
84'6"	98'8"	95%	Siliceous, garnet-diopside skarn	84'6"	92'	7'6"	22143	2.54					

BUCCANEER DIAMOND DRILLING LTD

Box 4891

Williams Lake, B.C.

Date *from 1.7.....1980*

To: *Dinac Resources Corp.*
1376 - 510 W. Hastings
Van B.C.

Re: *Clear water job*

Period: *Jan 1 to 16 1980.*

Ream Casing & Hole Stabilizing.....

Standby.....

Board & Lodgings.....

Cementing.....

Overburden.....

Equipment.....

Other Charges.....

Drilling Detail

Date	Size	From	To	Footage	Rate	Amount
<i>Hole #13.</i>	<i>30</i>	<i>50</i>	<i>110</i>	<i>60</i>	<i>424.50</i>	<i>25470.00</i>
<i>Hole #15</i>		<i>0</i>	<i>85</i>	<i>85</i>	<i>424.50</i>	<i>36082.50</i>
<i>Hole #17</i>		<i>0</i>	<i>70</i>	<i>70</i>	<i>424.50</i>	<i>29715.00</i>
<i>Hole #19</i>		<i>0</i>	<i>105</i>	<i>105</i>	<i>424.50</i>	<i>44572.50</i>
<i>Hole #20</i>		<i>0</i>	<i>115</i>	<i>115</i>	<i>424.50</i>	<i>48817.50</i>
<i>Hole #18</i>		<i>0</i>	<i>111</i>	<i>111</i>	<i>424.50</i>	<i>47119.50</i>

Total:

13377.00
DRILL CONTRACTORS

BUCCANEER DIAMOND DRILLING LTD

Box 4891

Williams Lake, B.C.

Date Dec 22 1979

To: Dima Resources Corp
1326-510 W Hastings
Vancouver BC

Re: *See quote Property*

Period: Dec 1 to 20 1979

Ream Casing & Hole Stabilizing.....	
Standby.....	
Board & Lodgings.....	
Cementing.....	
Overburden.....	
Equipment.....	
Other Charges.....	

Drilling Detail

Date	Size	From	To	Footage	Rate	Amount
11/6	5" P.O.	0	138	138	at 24.50 ft	4338.00
11/6	9" P.O.	0	97	97	at 24.50 ft	2376.50
11/6	13" P.O.	0	50	50	at 24.50 ft	1225.00
11/11	B.O.	0	91	91	at 24.50 ft	2229.50

*Paid by check
thank you*

Total:

29212.00

EMME
DEMOC

DATES DEC 19-79 - JAN 13-80

Shift reports 175 - 184

DDH #12	-97'	@ \$ 16.00	= \$ 1552.00
4 Conelators		@ \$ 6.00	= \$ 24.00
Cement 2 Bags		@ \$ 20.80	= \$ 41.60
" DRILLER 1 1/2 hr		@ \$ 15.00	= \$ 195.00
" HELPER 8 1/2 hr		@ \$ 12.50	= \$ 100.00
" RFB 2 1/2 hr		@ \$ 2.00	= \$ 42.00
			<hr/>
			\$ 1954.60

DDH #14	27'	@ \$ 16.00	= \$ 432.00
1 Conelator		@ \$ 6.00	= \$ 6.00
Move Driller 3 hr		@ \$ 15.00	= \$ 45.00
" Helper 3 1/2 hr		@ \$ 12.50	= \$ 37.50
" RFB 6 hr		@ \$ 2.00	= \$ 12.00
Cement 1 1/4 Bags		@ \$ 20.50	= \$ 57.20
" Driller 2 1/2 hr		@ \$ 15.00	= \$ 37.50
" Helper 2 1/2 hr		@ \$ 12.50	= \$ 31.25
" RFB 5 hr		@ \$ 2.00	= \$ 11.00
			<hr/>
			\$ 616.45

DDH #16	78'	@ \$ 16.00	= \$ 1248.00
3 Conelators		@ \$ 6.00	= \$ 18.00
Move Driller 2 hrs		@ \$ 15.00	= \$ 30.00
" Helper 2 hr		@ \$ 12.50	= \$ 25.00
" RFB 4 hr		@ \$ 2.00	= \$ 8.00
Cement 3/4 Bags		@ \$ 20.50	= \$ 15.60
" Driller 5 1/2 hr		@ \$ 15.00	= \$ 82.50
" Helper 5 1/2 hr		@ \$ 12.50	= \$ 68.75
" RFB 11 hr		@ \$ 2.00	= \$ 22.00
			<hr/>
			\$ 1517.85

191

DDH # 4, 6, 7, 8, 10, 12, 14, 16 = 552'

5 - BQ Imp. Pits	@ \$ 291.20	= \$ 1456.00
2 - IQ 200' "	@ \$ 442.56	= \$ 885.12
3 - BQ Ecure Shells	@ \$ 123.76	= \$ 371.28
6 - BW " Shoes	@ \$ 94.64	= \$ 567.84
1 - BW-BX Sub	@ \$ 28.91	= \$ 28.91
		<hr/>
Tot		= \$ 3309.15

Diamond Costs \$3309.15 ÷ 552' = \$ 5.99
 Contr. Sku ~~sub~~ \$ 500
 Sub \$ 0.99 × 552' = \$ 546.48
 Sub Tot = \$ 4635.38
 Less Bal of Account = \$ 1500.00
 \$ 3135.38

Casing hrs. ?

Paid on acct

\$ 2800.00

DIMAC Resource Corp.
1326 - 510 W. HASTINGS ST.
Vancouver B.C.

Invoice # 2
Dates Dec 3- Dec 18-79

Shift reports 162-174

D-DH # 6	103'	@ \$ 16.00	= \$ 1648.00	
4 Coreboxes	0 \$	6.00	= \$ 24.00	
MOVE 13 hrs Driller	0 \$	15.00	= \$ 195.00	
" 13 " Helper	0 \$	12.50	= \$ 162.50	
R+B 26 "	0 \$	2.00	= \$ 52.00	
			<hr/>	
SUB TOT \$			2081.50	\$ 2081.50

DDH # 7	36'	@ \$ 16.00	= \$ 576.00	
2 Coreboxes	0 \$	6.00	= \$ 12.00	
MOVE 1 hr Driller	0 \$	15.00	= \$ 15.00	
" 1 " Helper	0 \$	12.50	= \$ 12.50	
R+B 2 "	0 \$	2.00	= \$ 4.00	
			<hr/>	
SUB TOT \$			619.50	\$ 619.50

DDH # 8	35'	@ \$ 16.00	= \$ 560.00	
2 Coreboxes	0 \$	6.00	= \$ 12.00	
MOVE 2 hrs Driller	0 \$	15.00	= \$ 30.00	
" 2 " Helper	0 \$	12.50	= \$ 25.00	
R+B 4 "	0 \$	2.00	= \$ 8.00	
Cement 9 " Driller	0 \$	15.00	= \$ 135.00	
" 3 " Helper	0 \$	12.50	= \$ 37.50	
R+B 12 "	0 \$	2.00	= \$ 24.00	
2 Bags Cement	0 \$	20.80	= \$ 41.60	
			<hr/>	
SUB TOT \$			873.10	\$ 873.10

DDH # 10	88'	@ \$ 16.00	= \$ 1408.00	
3 Coreboxes	0 \$	6.00	= \$ 18.00	
MOVE 16 hrs Driller	0 \$	15.00	= \$ 240.00	
" 5 " Helper	0 \$	12.50	= \$ 62.50	
R+B 17 "	0 \$	2.00	= \$ 34.00	
Cement 8 " Driller	0 \$	15.00	= \$ 120.00	
" 8 " Helper	0 \$	12.50	= \$ 100.00	
R+B 16 "	0 \$	2.00	= \$ 32.00	
2 Bags Cement	0 \$	20.80	= \$ 41.60	
			<hr/>	
SUB TOT \$			2056.10	\$ 2056.10

TOT	\$ 5630.20
Less Part of Advance	\$ 1000.00
Bal Due	\$ 4630.20

28

Eagle Drilling Ltd.,
 Box 250
 Wells, B.C.
 VOK 2R0

(19)

Dec. 3, 1979

Mac Resource Corp.,
 1326 - 510 W. Hastings St.,
 Vancouver, B.C.

Invoice # 1

Dates: Nov. 5, 79, - Dec. 2, 79. Shift Reports # 137 - 161

DDH # 1	83'	@ \$ 16.00	= \$ 1328.00		
4 Coreboxes		@ \$ 6.00	= \$ 24.00		
				\$ 1352.00	\$ 1352.00
DDH # 2	125'	@ \$ 16.00	= \$ 2000.00		
5 Coreboxes		@ \$ 6.00	= \$ 30.00		
Move 6 hrs. Driller		@ \$ 15.00	= \$ 90.00		
Move 6 hrs. Helper		@ \$ 12.50	= \$ 75.00		
R & B 12 hrs		@ \$ 2.00	= \$ 24.00		
Cement 12 hrs. Driller		@ \$ 15.00	= \$ 180.00		
Cement 12 hrs. Helper		@ \$ 12.50	= \$ 150.00	RAD.	- 150.00
R & B 3 Days		@ \$ 16.00	= \$ 48.00		
2 Bags Cement		@ \$ 20.80	= \$ 41.60		
				\$ 2638.60	\$ 2638.60
DDH # 3 -	117'	@ \$ 16.00	= \$ 1872.00		
Coreboxes		@ \$ 6.00	= \$ 24.00		
Move 9 hrs. Driller		@ \$ 15.00	= \$ 135.00		
Move 9 hrs. Helper		@ \$ 12.50	= \$ 112.50	RAD.	- 112.50
R & B 2 Days		@ \$ 16.00	= \$ 32.00		
Cement 4 hrs. Driller		@ \$ 15.00	= \$ 60.00		
Cement 4 hrs. Helper		@ \$ 12.50	= \$ 50.00	RAD.	- 50.00
R & B 1 Day		@ \$ 16.00	= \$ 16.00		
1 Bag Cement		@ \$ 20.80	= \$ 20.80		
				\$ 2322.30	\$ 2322.30

Sub total ;..... \$ 6312.90

DDH # 1, 2, 3 = 325'

Diamonds used:	5 BQ Imp. Bits	@ \$ 291.20	= \$ 1456.00		
	2 BQ 200's "	@ \$ 442.56	= \$ 885.12		
	1 BQ Econo Shell"	\$ 123.76	= \$ 123.76		
	3 BW Econo Shoes"	\$ 94.64	= \$ 283.92		
				\$ 2748.80	

Diamond Costs \$ 2748.80 ÷ 325' = \$ 8.46 / ft.
 Contractor's Share \$ 5.00 / ft.

Company's Share \$ 3.46 / ft.

325' x \$ 3.46 = \$ 1124.50

Sub total \$ 7437.40

Sub total Page 1 carried ..

\$ 7437.40

LDH # 4	88'	@ \$ 16.00	= \$ 1408.00
3 Coreboxes		@ \$ 6.00	= \$ 18.00
Cement 2 1/2 Bags		@ \$ 20.80	= \$ 52.00
Driller 16 hrs.		@ \$ 15.00	= \$ 240.00
Helper 16 hrs.		@ \$ 12.50	= \$ 200.00
R & B 32 hrs.		@ \$ 2.00	= \$ 64.00

Sub total \$ 1982.00

\$ 1982.00

Less ^{1/2} part of Advance ^{less} DIMAC CHEQUE # 5

\$ 9419.40
~~312.50~~
 \$ 2500.00

Less Diamonds paid by Dimac

DIMAC cheque # 11

~~\$ 6919.40~~
 \$ 6606.90
3956.11

DIMAC CHEQUE 19
 Balance due

\$ 2650.79

Total footage = 413

9419.40
312.50
 Cost 9106.90

Cost/Ft = \$ 22.05

5000.00 Advance
 3956.11 Diamonds
8956.11

W. Magnussen

Funds held by

CANADIAN IMPERIAL BANK OF COMMERCE

HASTINGS AND GRANVILLE VANCOUVER, B.C.

OCT 29 1979

PAY TO THE ORDER OF

DOLLARS

CURRENT ACCOUNT CHEQUE NUMBER

⑆00010⑉010⑆ 31152

DIYAC RESOURCE CORP

⑆000050000⑆

CERTIFIED

CANADIAN IMPERIAL BANK OF COMMERCE

HASTINGS AND GRANVILLE VANCOUVER, B.C.

CERTIFIED CHEQUE

Nov 28 1979

PAY TO THE ORDER OF

NOT DESTROY

CANADIAN WONG YEAT LTD

3956.11

Three thousand nine hundred fifty six

DOLLARS

CURRENT ACCOUNT CHEQUE NUMBER

⑆00010⑉010⑆ 31152

DIYAC RESOURCE CORP

⑆0000395611⑆

DEC 3 1979



CANADIAN IMPERIAL BANK OF COMMERCE

HASTINGS AND GRANVILLE VANCOUVER, B.C.

PAY TO THE ORDER OF

EAGLE DIAMOND DRILLING LTD \$ 2650.79

two thousand six hundred fifty 79 DOLLARS

DIMAC RESOURCE CORP.

NO. 19

Rt Dickinson

074 000100101 31 15216 0000265079

CANADIAN IMPERIAL BANK OF COMMERCE HASTINGS AND GRANVILLE VANCOUVER, B.C.



CANADIAN IMPERIAL BANK OF COMMERCE

HASTINGS AND GRANVILLE VANCOUVER, B.C.

PAY TO THE ORDER OF

DEC 19 79

... \$ 4630.20

... DOLLARS

DIMAC RESOURCE CORP.

NO. 28

Rt Dickinson

074 000100101 31 15216 0000463020

CANADIAN IMPERIAL BANK OF COMMERCE HASTINGS AND GRANVILLE VANCOUVER, B.C.



CANADIAN IMPERIAL BANK OF COMMERCE

HASTINGS AND GRANVILLE VANCOUVER, B.C.

PAY TO THE ORDER OF

DEC 20 19 79

BUCCANEER DIAMOND DRILLING LTD \$ 9212.00

nine thousand two hundred twelve DOLLARS

DIMAC RESOURCE CORP.

NO. 27

Rt Dickinson

DIAMOND DRILLING GETCEVA 074 000100101 31 15216 0000921200



CANADIAN IMPERIAL
BANK OF COMMERCE

HASTINGS AND GRANVILLE
VANCOUVER, B.C.

PAY TO THE
ORDER OF

EAGLE DIAMOND DRILLING LTD

\$ 2800.00

Two thousand eight hundred ~~xx~~ DOLLARS

DIMAC RESOURCE CORP.

NO. 37

R. Dickinson

⑈074⑈ ⑆100010⑈010⑈ 31⑈ 15216⑈

⑈0000280000⑈



CANADIAN IMPERIAL
BANK OF COMMERCE

HASTINGS AND GRANVILLE
VANCOUVER, B.C.

PAY TO THE
ORDER OF

BUCCANEER DIAMOND DRILLING LTD

\$-13,377.00

thirteen thousand three hundred seventy seven ~~xx~~ DOLLARS

GATCHA PROPERTY

DIMAC RESOURCE CORP.

NO. 38

R. Dickinson

⑈074⑈ ⑆100010⑈010⑈ 31⑈ 15216⑈

⑈0001337700⑈

Jan 17 1980

STATEMENT

NORTH THOMPSON READY MIX LTD.
 BOX 453
 CLEARWATER, B.C. V0E 1N0
 PHONE 674-3573

21

DATE Dec 4 1979

Murray McLaren

DATE	DETAILS	DEBIT	CREDIT	BALANCE
	40 1m ft #4 rebar @ 25 per ft.			10.00
	tax			40
	20 ads @ 10¢ ea.			2.00
	Total.			12.40
	Pa by cheque.			
	Thanks J.M.			

© 1979

CORE STORAGE

CORE STORAGE

CANADIAN IMPERIAL BANK OF COMMERCE

HASTINGS AND GRANVILLE
VANCOUVER - B.C.

PL 08 22 30 79

PAY TO THE
ORDER OF

\$ 60.00

DOLLARS

CURRENT ACCOUNT
CHEQUE NUMBER

000100010: 31 58 16 0000006000



Dec 4 1979

CANADIAN IMPERIAL BANK OF COMMERCE

HASTINGS AND GRANVILLE VANCOUVER, B.C.

PAY TO THE ORDER OF

North Thompson Road [unclear] \$ 12.40
Twelve 40/100 DOLLARS

DIMAC RESOURCE CORP.

NO. 21

M. McCann

⑈074⑈ ⑆00010⑈010⑆ 31⑈ 15216⑈ ⑆0000001240⑆



Dec 4 1979

CANADIAN IMPERIAL BANK OF COMMERCE

HASTINGS AND GRANVILLE VANCOUVER, B.C.

PAY TO THE ORDER OF

North Valley Supply Ltd. \$ 15.39
Fifteen 39/100 DOLLARS

DIMAC RESOURCE CORP.

NO. 20

M. McCann

⑈074⑈ ⑆00010⑈010⑆ 31⑈ 15216⑈ ⑆0000001539⑆

BOW MAC TRUCK RENTALS

80

CIF 51878

58

A DIVISION OF BOWELL McLEAN MOTOR CO. LTD.

56030
INVOICE NUMBER
2700

RENTAL CONTRACT BETWEEN
BOW MAC TRUCK RENTALS (OWNER)

A BRITISH COLUMBIA OWNED AND OPERATED COMPANY

AGENT/CITY CODE

AND Dinac Resources Corp (LESSEE)
ADDRESS 1326 510 W. HASTINGS
CITY Vanc B.C.

P.O. NO. R. Dickenson
THE LESSEE AGREES THAT THE FOLLOWING VEHICLE
TYPE OF VEHICLE 4x4 Pickup UNIT NO. 12603
IS TO BE USED IN OR BETWEEN LOCAL
THE LESSEE AGREES TO RETURN THE VEHICLE TO THE OWNER ON DATE Dec 29 1980
LESSEE RESPONSIBLE FOR ALL WINDSHIELD DAMAGE

REPLACEMENT VEHICLE NO. 61183

All Accidents to be Reported Immediately	REMIT TO: 1154 WEST BROADWAY, VANCOUVER, B.C. V6H 1G5	
	\$100.00 LIABILITY BY SIGNING LESSEE AGREES TO PAY THE OWNER FOR ALL LOSS OF DAMAGE TO VEHICLE LIMITED HOWEVER TO \$1000 PER ACCIDENT PROVIDED VEHICLE IS OPERATED OR USED IN CONFORMITY WITH RENTAL AGREEMENT BUT RENTER SHALL BE FULLY LIABLE FOR ALL SUCH DAMAGE IF SAID VEHICLE IS OPERATED IN VIOLATION OF ANY LAW OR THIS RENTAL CONTRACT EXCLUDES WRECKER OR TOWING CHARGES X _____ LESSEE'S SIGNATURE	\$1,000.00 LIABILITY BY SIGNING LESSEE AGREES TO PAY THE OWNER FOR ALL LOSS OF DAMAGE TO VEHICLE LIMITED HOWEVER TO \$1000 PER ACCIDENT PROVIDED VEHICLE IS OPERATED OR USED IN CONFORMITY WITH RENTAL AGREEMENT BUT RENTER SHALL BE FULLY LIABLE FOR ALL SUCH DAMAGE IF SAID VEHICLE IS OPERATED IN VIOLATION OF ANY LAW OR THIS RENTAL CONTRACT EXCLUDES WRECKER OR TOWING CHARGES X _____ LESSEE'S SIGNATURE

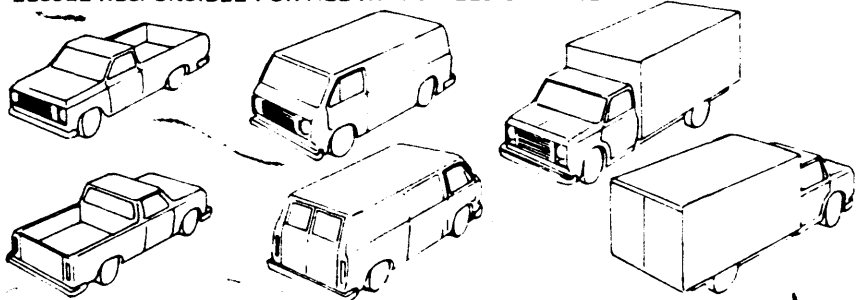

MILES/KM IN	<u>25630</u>	DATE IN	<u>Feb 5</u>	TIME IN	
MILES/KM OUT	<u>21413</u>	DATE OUT	<u>Dec 22</u>	TIME OUT	<u>8:00</u>
MILES/KM RUN	<u>4217</u>	TOTAL DAYS	<u>44</u>	TOTAL HOURS	
MILES/KM ALLOWED EXTRA	<u>2938</u>	<u>2000 km free per month</u>		UNIT NO.	<u>12603</u>
MILES/KM	<u>1279</u>				
1 MONTHS @ <u>650⁰⁰</u> MONTH				<u>65000</u>	
WEEKS @		WEEK			
14 DAYS @ <u>21.67</u> DAY				<u>30338</u>	
1279 MILES/KM @ <u>114</u> MILES/KM				<u>14069</u>	

Damage Description See Damage sheet

- Failure of the Lessee to return the vehicle within three days after the specified time shall constitute an unauthorized taking, use and operation of the vehicle and any costs and expenses incurred by the Owner for seizure and return of the vehicle to the Owner's premises shall be recovered from the Lessee.
- Lessee hereby indemnifies Owner against any fines or penalties assessed against Owner as a result of violation by Lessee of this agreement as to traffic and/or parking violations.
- Lessee agrees to be responsible for all damage to the vehicle while in his possession caused by negligent operation of the vehicle.
I.E. OPERATING VEHICLE WITH LACK OF WATER - OIL - ANTIFREEZE - LUBRICANTS etc.
- Lessee agrees to report all accidents and vehicle failures to the Owner immediately on occurrence.
- LESSEE TO BE ONLY AUTHORIZED DRIVER.
- Lessee agrees that the vehicle herein described must not be used, operated or driven, nor does Owner give its consent, expressed or implied, to the vehicle being used, operated or driven by any other person than the Lessee or such other driver(s) as herein specifically named.
- we hereby agree to be bound and to comply with all of the above terms and conditions which include the terms and conditions on the "REVERSE SIDE" hereof.

PERSONAL ACCIDENT INSURANCE
BY HIS INITIALS, Lessee agrees to pay an additional fee of \$1.00 per day, or part thereof (\$5.00 weekly) for Personal Accident Insurance under a policy arranged by Bow Mac, the Terms and Conditions of which are set forth in the attached Form. Series 40892. Insurance applies during the terms this Rental Agreement is in force.

P.A.I. SIGNATURE			
LESSEE'S SIGNATURE	DEPOSIT PAID		
	DATE	Initial	AMOUNT
DRIVER'S SIGNATURE	<u>11/29/80</u>	<u>[Signature]</u>	<u>5000</u>
DRIVER'S OR CHAUFFER'S LICENSE NO. <u>1223781</u>	<u>From Rental Agreement</u>		
OTHER IDENTIFICATION	REFUND RECEIVED <u>[Signature]</u>		
BUSINESS PHONE	LESSEE'S PHONE <u>685-2753</u>	SIGNATURE OF AUTHORIZED AGENT <u>[Signature]</u>	BALANCE/REFUND

TOTAL	CASH	20001	220	<u>124285</u>
	CHARGE			
DEPOSIT				
TOTAL RENTAL				

OTHER (TAXABLE ONLY)			
SUB TOTAL		445	<u>109407</u>
S.S. TAX <u>4%</u>		324	<u>4376</u>
DAMAGE	MECHANICAL	447.0	
	BODY	447.A	
	TIRES	447.B	
PLUS FUEL <u>Full</u>		448	<u>2440</u>
INSURANCE COVERAGE AS ABOVE <u>55⁰⁰ month</u>		446	<u>8062</u>

paid by cheque dw.

RENT-A-TRUCK from BOW MAC CANADA WIDE LOCATIONS

56030

- | | | | | | | | | |
|------------------|--------------|------------|---------------|------------|-------------|----------------|--------------|----------|
| BRITISH COLUMBIA | FORT NELSON | PENTICTON | TERRACE | YUKON | ALBERTA | GRANDE PRAIRIE | SASKATCHEWAN | MANITOBA |
| ABBOTSFORD | FORT ST JOHN | PR GEORGE | VERNON | MAYO | CALGARY | LETHBRIDGE | REGINA | WINNIPEG |
| CHEWYND | KAMLOOPS | QUESNEL | VICTORIA | ROSS RIVER | EDMONTON | MEDICINE HAT | | |
| CRANBROOK | KELOWNA | REVELSTOCK | VANCOUVER | WHITEHORSE | FT MCMURRAY | RED DEER | | |
| DAWSON CREEK | NELSON | SMITHERS | WILLIAMS LAKE | | | | | |

VEHICLES & WATER
THIS IS YOUR INVOICE

50

TRUCK RENTALS

A DIVISION OF BOWELL McLEAN MOTOR CO. LTD.

INVOICE NUMBER
51269
AGENT/CITY CODE **2700**

RENTAL CONTRACT BETWEEN
MAC TRUCK RENTALS (OWNER)
AND **MAC Resource Corp (LESSEE)**

ADDRESS **21326 51st W. Hastings**
CITY **Vancouver**

P.O. NO. **R. Dickson**
THE LESSEE AGREES THAT THE FOLLOWING VEHICLE
TYPE OF VEHICLE **Van Pop** UNIT NO. **12603**
IS TO BE USED FOR **WORK**
IN OR BETWEEN **WORK**
THE LESSEE AGREES TO RETURN THE VEHICLE TO THE OWNER ON DATE **Dec 29 1979**
LESSEE RESPONSIBLE FOR ALL WINDSHIELD DAMAGE

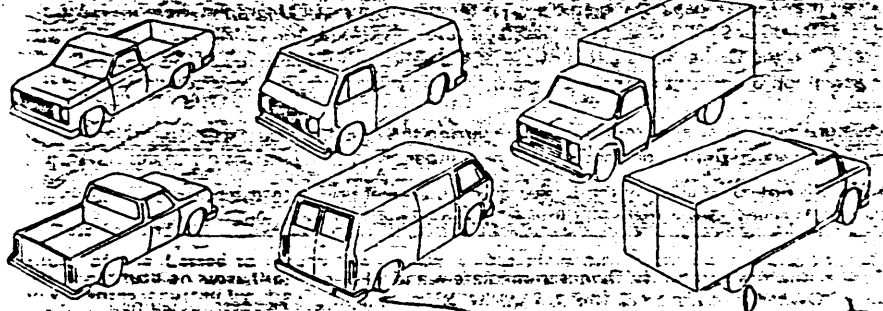

Description **See Damage sheet**

- Failure of the Lessee to return the vehicle within three days after the specified time shall constitute an unauthorized taking, use and operation of the vehicle and any costs and expenses incurred by the Owner for seizure and return of the vehicle to the Owner's premises shall be recovered from the Lessee.
- Lessee hereby indemnifies Owner against any fines or penalties assessed against Owner as a result of violation by Lessee of this agreement as to traffic and/or parking violations.
- Lessee agrees to be responsible for all damage to the vehicle while in his possession caused by negligent operation of the vehicle.

I.E. OPERATING VEHICLE WITH LACK OF WATER - OIL - ANTIFREEZE - LUBRICANTS etc.

- Lessee agrees to report all accidents and vehicle failures to the Owner immediately on occurrence.
- LESSEE TO BE ONLY AUTHORIZED DRIVER.
- Lessee agrees that the vehicle herein described must not be used, operated or driven, nor does Owner give its consent, expressed or implied, to the vehicle being used, operated or driven by any other person than the Lessee or such other driver(s) as herein specifically named.

I/we hereby agree to be bound and to comply with all of the above terms and conditions which include the terms and conditions on the "REVERSE SIDE" hereof.

PERSONAL ACCIDENT INSURANCE

BY HIS INITIALS, Lessee agrees to pay an additional fee of \$1.00 per day, or part thereof (\$5.00 weekly) for Personal Accident Insurance under a policy arranged by Bow Mac, the Terms and Conditions of which are set forth in the attached Form, Series 40892. Insurance applies during the terms this Rental Agreement is in force.

P.A.I. SIGNATURE _____

LESSEE'S SIGNATURE <i>R. Dickson</i>	DEPOSIT PAID <i>500</i>
DRIVER'S SIGNATURE <i>R. Dickson</i>	DATE Initial Amount Cash C.C. <i>11/29/79 500</i>
DRIVER'S OR CHAUFFER'S LICENSE NO. <i>1223781</i>	
OTHER IDENTIFICATION	REFUND RECEIVED

BUSINESS PHONE _____ LESSEE'S PHONE *685-2753* SIGNATURE OF AUTHORIZED AGENT _____

REMIT TO:
1154 WEST BROADWAY, VANCOUVER, B.C. V6H 1G5

All Accidents to be Reported Immediately

ALL TRAFFIC VIOLATIONS AND ALL DAMAGES RESULTING FROM COLLISION WITH AN UNDERPASS OR OTHER OBJECT DUE TO INSUFFICIENT CLEARANCE OF HEIGHT OR WIDTH ARE LESSEE RESPONSIBILITY

\$100.00 LIABILITY: BY SIGNING LESSEE AGREES TO PAY THE DRIVER FOR ALL LOSS OF DAMAGE TO VEHICLE LIMITED HOWEVER TO THREE PER ACCIDENT PROVIDED VEHICLE IS OPERATED OR USED IN CONFORMANCE WITH RENTAL AGREEMENT BUT RENTER SHALL BE FULLY LIABLE FOR ALL SUCH DAMAGE IF SAID VEHICLE IS OPERATED IN VIOLATION OF ANY LAW OR THIS RENTAL CONTRACT. EXCLUDES WRECKER OR TOWING CHARGES.

\$1,000.00 LIABILITY: BY SIGNING LESSEE AGREES TO PAY THE OWNER FOR ALL LOSS OF DAMAGE TO VEHICLE LIMITED HOWEVER TO THREE PER ACCIDENT PROVIDED VEHICLE IS OPERATED OR USED IN CONFORMANCE WITH RENTAL AGREEMENT BUT RENTER SHALL BE FULLY LIABLE FOR ALL SUCH DAMAGE IF SAID VEHICLE IS OPERATED IN VIOLATION OF ANY LAW OR THIS RENTAL CONTRACT. EXCLUDES WRECKER OR TOWING CHARGES.

MILES/KM IN	<i>19805</i>	DATE IN	<i>DEC 29 1979</i>	TIME IN	<i>11:19</i>
MILES/KM OUT	<i>17805</i>	DATE OUT	<i>DEC 29 1979</i>	TIME OUT	<i>11:19</i>
MILES/KM RUN		TOTAL DAYS		TOTAL HOURS	
MILES/KM ALLOWED		<i>2000 Km Free</i>		UNIT NO.	<i>12603</i>
MILES/KM EXTRA					
MONTHS @	<i>650</i>	MONTH			<i>650.00</i>
WEEKS @		WEEK			
DAYS @	<i>21.67</i>	DAY			
MILES/KM @	<i>118</i>	MILES/KM			
OTHER (TAXABLE ONLY)					

SUB TOTAL	445	<i>630.00</i>
S.S. TAX <i>4%</i>	324	<i>26.00</i>
DAMAGE		
MECHANICAL	447.0	
BODY	447.A	
TIRES	447.B	
PLUS FUEL	448	<i>- Full</i>
INSURANCE COVERAGE AS ABOVE <i>5500/mth</i>	446	<i>5500</i>
TOTAL CASH	20001	<i>731.00</i>
TOTAL CHARGE		
DEPOSIT		
TOTAL RENTAL		<i>731.00</i>
BALANCE/REFUND		

51269

CREDIT REFERENCES _____
ADDITIONAL INFORMATION _____
EMPLOYED BY: _____
ADDITIONAL INFORMATION _____

INVOICE NUMBER	51269
CREDIT APPROVED	
AMOUNT	



BOW MAC TRUCK RENTALS

915
51269

51878

A DIVISION OF BOWELL McLEAN MOTOR CO. LTD.

RENTAL CONTRACT BETWEEN
MAC TRUCK RENTALS (OWNER)

A BRITISH COLUMBIA OWNED AND OPERATED COMPANY

INVOICE NUMBER
2700

AGENT/CITY CODE

AND Dima Resources Corp LESSEE

ADDRESS 1326 Sto Wascings

CITY Vancouver

P.O. NO. 2 Dickerson

THE LESSEE AGREES THAT THE FOLLOWING VEHICLE:

TYPE OF VEHICLE 4x4 Pickup UNIT NO. 12603

IS TO BE USED IN OR BETWEEN route

THE LESSEE AGREES TO RETURN THE VEHICLE TO THE OWNER ON DATE Dec 29 1980

LESSEE RESPONSIBLE FOR ALL WINDSHIELD DAMAGE

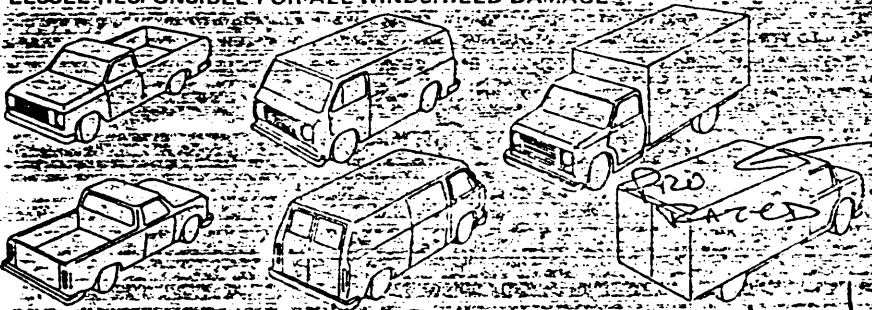

Dan Description See Damage sheet

1. Failure of the Lessee to return the vehicle within three days after the specified time shall constitute an unauthorized taking, use and operation of the vehicle and any costs and expenses incurred by the Owner for seizure and return of the vehicle to the Owner's premises shall be recovered from the Lessee.
2. Lessee hereby indemnifies Owner against any fines or penalties assessed against Owner as a result of violation by Lessee of this agreement as to traffic and/or parking violations.
3. Lessee agrees to be responsible for all damage to the vehicle while in his possession caused by negligent operation of the vehicle.

I.E. OPERATING VEHICLE WITH LACK OF WATER - OIL - ANTIFREEZE - LUBRICANTS etc.

4. Lessee agrees to report all accidents and vehicle failures to the Owner immediately on occurrence.

5. LESSEE TO BE ONLY AUTHORIZED DRIVER.

6. Lessee agrees that the vehicle herein described must not be used, operated or driven, nor does Owner give its consent, expressed or implied, to the vehicle being used, operated or driven by any other person than the Lessee or such other driver(s) as herein specifically named.

I/we hereby agree to be bound and to comply with all of the above terms and conditions which include the terms and conditions on the "REVERSE SIDE" hereof.

PERSONAL ACCIDENT INSURANCE

BY HIS INITIALS, Lessee agrees to pay an additional fee of \$1.00 per day, or part thereof (\$5.00 weekly) for Personal Accident Insurance under a policy arranged by Bow Mac, the Terms and Conditions of which are set forth in the attached Form, Series 40892. Insurance applies during the terms this Rental Agreement is in force.

P.A.I. SIGNATURE

LESSEE'S SIGNATURE [Signature] DEPOSIT PAID [Signature]

DATE 11/24/80 Initial [Initials] AMOUNT 500 Cash [Initials] C.C.

DRIVER'S SIGNATURE [Signature]

DRIVER'S OR CHAUFFER'S LICENSE NO. 1223781 FROM PA 51269

OTHER IDENTIFICATION REFUND RECEIVED

BUSINESS PHONE 685-2753 LESSEE'S PHONE 685-2753 SIGNATURE OF AUTHORIZED AGENT [Signature]

All Accidents to be Reported Immediately		REMIT TO: 1154 WEST BROADWAY, VANCOUVER, B.C. V6H 1G5	
ALL TRAFFIC VIOLATIONS AND ALL DAMAGES RESULTING FROM COLLISION WITH AN UNDERPASS OR OTHER OBJECT DUE TO INSUFFICIENT CLEARANCE OF HEIGHT OR WIDTH ARE LESSEE'S RESPONSIBILITY		<p>\$100.00 LIABILITY</p> <p>BY SIGNING, LESSEE AGREES TO PAY THE OWNER FOR ALL LOSS OR DAMAGE TO VEHICLE LIMITED HOWEVER, TO \$100.00 PER ACCIDENT PROVIDED VEHICLE IS OPERATED OR USED IN CONFORMANCE WITH RENTAL AGREEMENT. BUT RENTER SHALL BE FULLY RESPONSIBLE FOR ALL SUCH DAMAGE IF SAID VEHICLE IS OPERATED IN VIOLATION OF ANY LAW OR THIS RENTAL CONTRACT.</p> <p>EXCLUDES BROKER OR TOWING CHARGES</p> <p>LESSEE SIGNATURE: _____</p>	<p>\$1,000.00 LIABILITY</p> <p>BY SIGNING, LESSEE AGREES TO PAY THE OWNER FOR ALL LOSS OR DAMAGE TO VEHICLE LIMITED HOWEVER, TO \$1,000.00 PER ACCIDENT PROVIDED VEHICLE IS OPERATED OR USED IN CONFORMANCE WITH RENTAL AGREEMENT. BUT RENTER SHALL BE FULLY LIABLE FOR ALL SUCH DAMAGE IF SAID VEHICLE IS OPERATED IN VIOLATION OF ANY LAW OR THIS RENTAL CONTRACT.</p> <p>EXCLUDES BROKER OR TOWING CHARGES</p> <p>LESSEE SIGNATURE: _____</p>

MILES/KM IN	<u>21483</u>	DATE	<u>Nov 22</u>	TIME	<u>1430</u>
MILES/KM OUT	<u>19805</u>	DATE	<u>Dec 29</u>	TIME	<u>089</u>
MILES/KM RUN	<u>1608</u>	TOTAL DAYS	<u>24</u>	TOTAL HOURS	
MILES/KM ALLOWED EXTRA	<u>1608</u>	<u>2000 Km free</u>		UNIT NO.	<u>12603</u>
MONTHS @	<u>6.50</u>	00 MONTH			
WEEKS @		WEEK			
<u>24</u> DAYS @	<u>21.67</u>	DAY		<u>520</u>	<u>08</u>
MILES/KM @	<u>114</u>	MILES/KM			
OTHER (TAXABLE ONLY)					

SUB TOTAL		445	520	08
S.S. TAX <u>4%</u>		324	20	80
DAMAGE	MECHANICAL	447.0		
	BODY	447.A		
	TIRES	447.B		
PLUS FUEL		448		<u>Full</u>
INSURANCE COVERAGE AS ABOVE <u>550</u>		446	43	92
TOTAL	CASH	20001	220	584
	CHARGE			80
DEPOSIT				
TOTAL RENTAL				
BUSINESS PHONE				
LESSEE'S PHONE				
SIGNATURE OF AUTHORIZED AGENT				
BALANCE/REFUND				

51878

CREDIT REFERENCES

EMPLOYED BY:

ADDITIONAL INFORMATION

SEE REVERSE SIDE - ORIGINAL COPY

INVOICE NUMBER
CREDIT APPROVED
AMOUNT



BOW MAC TRUCK RENTALS

A DIVISION OF BOWELL McLEAN MOTOR CO. LTD.

A BRITISH COLUMBIA OWNED AND OPERATED COMPANY

AGENT/CITY CODE

INVOICE NUMBER

RENTAL CONTRACT BETWEEN BOW MAC TRUCK RENTALS (OWNER)

TOTAL \$ 1015.00
C/F 49061
51261
2700

AND MALIBOR MINES (LESSEE)

ADDRESS 1326 STOKWASTA ST

CITY VANCOUVER BC

P.O. NO. _____

THE LESSEE AGREES THAT THE FOLLOWING VEHICLE

TYPE OF VEHICLE DATSUN UNIT NO. 60199

IS TO BE USED IN OR BETWEEN _____

THE LESSEE AGREES TO RETURN THE VEHICLE TO THE OWNER ON _____

DATE _____ 19 _____

LESSEE RESPONSIBLE FOR ALL WINDSHIELD DAMAGE

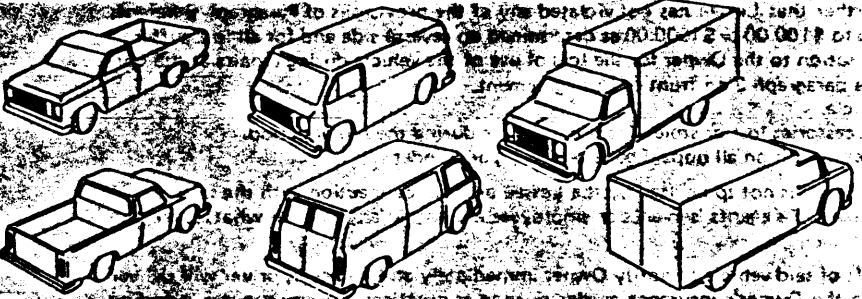

Age Description _____

1. Failure of the Lessee to return the vehicle within three days after the specified time shall constitute an unauthorized taking, use and operation of the vehicle and any costs and expenses incurred by the Owner for seizure and return of the vehicle to the Owner's premises shall be recovered from the Lessee.
 2. Lessee hereby indemnifies Owner against any fines or penalties assessed against Owner as a result of violation by Lessee of this agreement as to traffic and/or parking violations.
 3. Lessee agrees to be responsible for all damage to the vehicle while in his possession caused by negligent operation of the vehicle, I.E. OPERATING VEHICLE WITH LACK OF WATER - OIL - ANTIFREEZE - LUBRICANTS
 4. Lessee agrees to report all accidents and vehicle failures to the Owner immediately on occurrence.
 5. LESSEE TO BE ONLY AUTHORIZED DRIVER
 6. Lessee agrees that the vehicle herein described must not be used, operated or driven, nor does Owner give its consent, expressed or implied, to the vehicle being used, operated or driven by any other person than the Lessee or such other driver(s) as herein specifically named.
- I/we hereby agree to be bound and to comply with all of the above terms and conditions which include the terms and conditions on the "REVERSE SIDE" hereof.

PERSONAL ACCIDENT INSURANCE

BY HIS INITIALS, Lessee agrees to pay an additional fee of \$1.00 per day, or part thereof (\$5.00 weekly) for Personal Accident Insurance under a policy arranged by Bow Mac, the Terms and Conditions of which are set forth in the attached Form, Series 40892, Insurance applies during the terms this Rental Agreement is in force.

P.A.I. SIGNATURE _____

LESSEE'S SIGNATURE _____	DEPOSIT PAID			
DRIVER'S SIGNATURE _____	DATE	Initial	AMOUNT	Cash C.C.
DRIVER'S OR CHAUFFERS LICENSE NO. _____	<u>Paid Nov 29 1979</u>			
OTHER IDENTIFICATION _____				
BUSINESS PHONE _____	LESSEE'S PHONE _____	SIGNATURE OF AUTHORIZED AGENT _____		BALANCE/REFUND _____

REMIT TO: 1154 WEST BROADWAY, VANCOUVER B.C. V6H 1G5	RENTAL CONTRACT NO. 51261						
ALL ACCIDENTS TO BE REPORTED IMMEDIATELY							
ALL TRAFFIC VIOLATIONS AND ALL DAMAGES RESULTING FROM COLLISION WITH AN UNDERPASS OR OTHER OBJECT DUE TO INSUFFICIENT CLEARANCE OF HEIGHT OR WIDTH ARE LESSEE RESPONSIBILITY	<table border="1"> <tr> <td>\$100.00 LIABILITY</td> <td>\$1,000.00 LIABILITY</td> </tr> <tr> <td>BY ORIGINAL LESSEE AGREES TO PAY THE OWNER FOR ALL LOSS OR DAMAGE TO VEHICLE LIMITED HOWEVER TO EXCEED PER AGREEMENT. PROVIDED VEHICLE IS OPERATED OR USED IN CONFORMITY WITH RENTAL AGREEMENT, BUT RENTER SHALL BE FULLY LIABLE FOR ALL SUCH DAMAGE IF SAID VEHICLE IS OPERATED IN VIOLATION OF ANY LAW OR THIS RENTAL CONTRACT.</td> <td>BY SIGNING LESSEE AGREES TO PAY THE OWNER FOR ALL LOSS OR DAMAGE TO VEHICLE LIMITED HOWEVER TO EXCEED PER AGREEMENT. PROVIDED VEHICLE IS OPERATED OR USED IN CONFORMITY WITH RENTAL AGREEMENT, BUT RENTER SHALL BE FULLY LIABLE FOR ALL SUCH DAMAGE IF SAID VEHICLE IS OPERATED IN VIOLATION OF ANY LAW OR THIS RENTAL CONTRACT.</td> </tr> <tr> <td>LESSEE SIGNATURE _____</td> <td>LESSEE SIGNATURE _____</td> </tr> </table>	\$100.00 LIABILITY	\$1,000.00 LIABILITY	BY ORIGINAL LESSEE AGREES TO PAY THE OWNER FOR ALL LOSS OR DAMAGE TO VEHICLE LIMITED HOWEVER TO EXCEED PER AGREEMENT. PROVIDED VEHICLE IS OPERATED OR USED IN CONFORMITY WITH RENTAL AGREEMENT, BUT RENTER SHALL BE FULLY LIABLE FOR ALL SUCH DAMAGE IF SAID VEHICLE IS OPERATED IN VIOLATION OF ANY LAW OR THIS RENTAL CONTRACT.	BY SIGNING LESSEE AGREES TO PAY THE OWNER FOR ALL LOSS OR DAMAGE TO VEHICLE LIMITED HOWEVER TO EXCEED PER AGREEMENT. PROVIDED VEHICLE IS OPERATED OR USED IN CONFORMITY WITH RENTAL AGREEMENT, BUT RENTER SHALL BE FULLY LIABLE FOR ALL SUCH DAMAGE IF SAID VEHICLE IS OPERATED IN VIOLATION OF ANY LAW OR THIS RENTAL CONTRACT.	LESSEE SIGNATURE _____	LESSEE SIGNATURE _____
\$100.00 LIABILITY	\$1,000.00 LIABILITY						
BY ORIGINAL LESSEE AGREES TO PAY THE OWNER FOR ALL LOSS OR DAMAGE TO VEHICLE LIMITED HOWEVER TO EXCEED PER AGREEMENT. PROVIDED VEHICLE IS OPERATED OR USED IN CONFORMITY WITH RENTAL AGREEMENT, BUT RENTER SHALL BE FULLY LIABLE FOR ALL SUCH DAMAGE IF SAID VEHICLE IS OPERATED IN VIOLATION OF ANY LAW OR THIS RENTAL CONTRACT.	BY SIGNING LESSEE AGREES TO PAY THE OWNER FOR ALL LOSS OR DAMAGE TO VEHICLE LIMITED HOWEVER TO EXCEED PER AGREEMENT. PROVIDED VEHICLE IS OPERATED OR USED IN CONFORMITY WITH RENTAL AGREEMENT, BUT RENTER SHALL BE FULLY LIABLE FOR ALL SUCH DAMAGE IF SAID VEHICLE IS OPERATED IN VIOLATION OF ANY LAW OR THIS RENTAL CONTRACT.						
LESSEE SIGNATURE _____	LESSEE SIGNATURE _____						

MILES/KM IN	2110	DATE IN	NOV 27	TIME IN	
MILES/KM OUT	1910	DATE OUT	NOV 27	TIME OUT	
MILES/KM RUN	2000	TOTAL DAYS		TOTAL HOURS	
MILES/KM ALLOWED EXTRA	2000			UNIT NO.	
1 MONTH	\$360	1 MONTH	360		
WEEKS		WEEK			
DAYS		DAY			
MILES/KM		MILES/KM			
OTHER (TAXABLE ONLY)			360		
SUB TOTAL			445	360.00	
S.S. TAX			324	14.40	
DAMAGE		MECHANICAL	447.0		
		BODY	447.0		
		TIRES	447.0		
PLUS FUEL			448		
INSURANCE COVERAGE AS ABOVE			446		
CASH CHARGE	20001		220	429.40	
DEPOSIT					
TOTAL RENTAL					

RENT-A-TRUCK from BOW MAC 51261

CANADA WIDE LOCATIONS

BRANCHES IN VANCOUVER, B.C. AND SEATTLE, WASH.

CERTIFIED
NOV 29 1979
PAY TO THE ORDER OF
CANADIAN IMPERIAL BANK OF COMMERCE
HASTINGS AND GRANVILLE VANCOUVER, B.C.



CANADIAN IMPERIAL BANK OF COMMERCE
HASTINGS AND GRANVILLE VANCOUVER, B.C.

NOV 29 1979

HOW MAC TRUCK RENTAL \$ 429.40
four hundred twenty nine and 40/100 DOLLARS

CANADIAN IMPERIAL BANK OF COMMERCE
PAID
NOV 29 1979
HASTINGS AND GRANVILLE VANCOUVER, B.C.

DIMAC RESOURCE CORP.

NO. 14

Rt Dickinson

⑈074⑈ ⑆00010⑈010⑆ 31⑈1521⑈ ⑆0000042940⑆

11 10 09 08 07 06 05 04 03 02 01
11 OF C
HASTINGS AND GRANVILLE VANCOUVER, B.C.

CANADIAN IMPERIAL BANK OF COMMERCE
HASTINGS AND GRANVILLE VANCOUVER, B.C.

NOV 30 1979

PAY TO THE ORDER OF

Howard Horning \$ 500.00
five hundred xx DOLLARS

DIMAC RESOURCE CORP.

NO. 16

Rt Dickinson

⑈074⑈ ⑆00010⑈010⑆ 31⑈1521⑈ ⑆0000050000⑆



Don's Auto Towing Ltd.

671 W. ATHABASCA ST., KAMLOOPS, B.C. V2H 1C5

24 HOUR SERVICE

PHONE 374-6281

MILEAGE _____

Date Jan 12 1990

TRUCK No 108

KEYS Yes No Open Locked

Make 6x6

Color _____ 2 Dr 4 Dr 19 _____

Licence _____

Prov. _____ Order No. _____

DRIVER scattered

JOB No. _____

Dinas Resource Corp.

Time In 9:30 a.m. p.m. Date Jan 12

Time Out 1:00 a.m. p.m.

Claim/Card No. _____

Expires _____

From no 9 rd at Clearwater

To Dallas Kamloops

Previous Tow _____

Charges Paid Out To 7 1/2 hrs \$375.00

Reason motor

M.V.A. HFO Bylaw Bailiff 4-6 PI Stuck 7-9

Recovery Drill pipe Change No. 35

Axles Driveshaft Trans. Linkage Trailer Dolleys

Cash Charge Credit Card Overcharge

P.C. No. _____ F.E.L. R.E.L. Storage _____

Time-D _____ a.m. p.m. Standby _____ p.m. Travel _____

Property Dinas Resource Corp

Owners Phone 1326-5100

Name Shirley B.C. 16B-168

Address 24 195-2753

NOT RESPONSIBLE FOR WEAK OR DEFECTIVE BUMPERS OR VEHICLES AND CONTENT IN CARE, CUSTODY OR CONTROL OF THE ABOVE CARRIER.
TERMS: NET CASH UNLESS CREDIT IS ESTABLISHED.
DISCOUNT WILL BE REVOKED ON OVERDUE ACCOUNTS.
(30 DAYS) AND 1 1/2% PER MONTH SERVICE CHARGED.

64513

35

Richard Dickinson

SIGNATURE

C STOCKFORMS LTD. AUTO TOWING



CANADIAN IMPERIAL BANK OF COMMERCE 0 2 8 7

Jan 12 1980

PAY TO THE ORDER OF

HASTINGS AND GRANVILLE VANCOUVER, B.C.

Don's Auto Towing LTD \$ 375.00

three hundred ⁵ seventy five ^{xx} DOLLARS

DIMAC RESOURCE CORP.

NO. 35

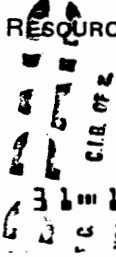

T.A. Dickinson

074 00010010 31 5216

0000037500

CANADIAN IMPERIAL BANK OF COMMERCE



HASTINGS AND GRANVILLE
VANCOUVER, B.C.

Nov 20 1979

PAY TO THE
ORDER OF

DUTCH LAKE RESORT

293.15

two hundred ninety three

15 DOLLARS

CURRENT ACCOUNT -
CHEQUE NUMBER

9

P. Dickman
DICKMAN
VANCOUVER B.C.

DUTCH LAKE RESORT

RESOURCE CORP

Room & Board

⑆00010⑆010⑆

⑆000029315⑆

Room & Board

⑈074⑈ ⑆00010⑈010⑈ 3115216⑈ ⑆074⑈ ⑆00010⑈010⑈ 3115216⑈

NO. 26

M.H. Co.

DIMAC RESOURCE CORP.

One Hundred & Seventy Three - 20/100 DOLLARS

\$ 173.20

PAY TO THE ORDER OF

BANK OF COMMERCE
CANADIAN IMPERIAL
HASTINGS AND GRANVILLE
VANCOUVER, B.C.

DEC 16 1979

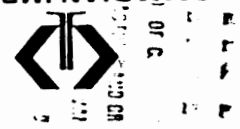

DEC 5 1979

BANK OF COMMERCE
HASTINGS AND GRANVILLE
VANCOUVER, B.C.

PAY TO THE ORDER OF

Dutch Lake Resort

\$ 344.05

three hundred forty four DOLLARS

DIMAC RESOURCE CORP.

NO. 22

R.D. Dickinson

⑈074⑈ ⑆00010⑈010⑈ 3115216⑈ ⑆0000034405⑈



BANK OF COMMERCE
HASTINGS AND GRANVILLE
VANCOUVER, B.C.

DEC 20 1979
R.D.

PAY TO THE ORDER OF

DUTCH LAKE RESORT LTD

\$ 104.75

one hundred four 75 DOLLARS

DIMAC RESOURCE CORP.

NO. 29

R.D. Dickinson

⑈074⑈ ⑆00010⑈010⑈ 3115216⑈ ⑆0000010475⑈



CANADIAN IMPERIAL
BANK OF COMMERCE
HASTINGS AND GRANVILLE
VANCOUVER, B.C.

Jan 20 19 80

PAY TO THE
ORDER OF

DUTCH LAKE RESORT \$ 42.90
forty two and 90/100 DOLLARS

DIMAC RESOURCE CORP.

NO. 39

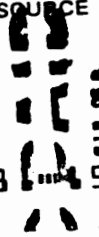

R. Dickman

⑈074⑈ ⑆00010⑈010⑆ 31⑈5216⑈

⑈0000004290⑈



CANADIAN IMPERIAL
BANK OF COMMERCE
HASTINGS AND GRANVILLE
VANCOUVER, B.C.

Jan 16 19 80

PAY TO THE
ORDER OF

Dutch Lake Resort \$ 213.80
Two Hundred Thirteen DOLLARS

DIMAC RESOURCE CORP.

NO. _____

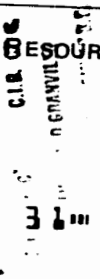

R. J. McCowan

⑈074⑈ ⑆00010⑈010⑆ 31⑈5216⑈

⑈0000021380⑈

BRIAN MOUNTFORD AND ASSOCIATES LTD.

811 - 675 WEST HASTINGS STREET, VANCOUVER, B.C. V6B 1N2
TELEPHONE 681-2377

December 28th 1979

Dimac Resource Corp.
1326 - 510 West Hastings Street
Vancouver, B.C.
V6B 1L8

Attention R.A. Dickinson

Dear Bob

Please find below our invoice for work carried out on your behalf during the month of December 1979.

Gotcha Property:

Visited property, discussed drilling requirements for proving ore and generally considered metallurgical programme.

3 days @ \$300 per day		900.00
December 11th - Airfare to Kamloops	88.55	
Car rental and taxis	68.58	
Meals and entertaining	<u>52.00</u>	<u>209.13</u>
TOTAL THIS INVOICE		<u>\$1,109.13</u>

Respectfully submitted

B. Mountford

B. Mountford

SUPERVISION

48

SUPERVISION



CANADIAN IMPERIAL
BANK OF COMMERCE
HASTINGS AND GRANVILLE
VANCOUVER, B.C.

Feb 4 1980

PAY TO THE
ORDER OF

Brian Mountford & Associates Ltd. | \$ 1,109.13
— one thousand one hundred nine — ¹³ DOLLARS

DIMAC RESOURCE CORP.

NO. 48.

Rt Dickman

⑈074⑈ ⑆00010⑈010⑆ 31⑈15216⑈

SUPERVISION

Statement

Wadlegger Logging & Construction Ltd.

Box 42 - Clearwater, B.C.

Jan 25/80

To Dimac Resource Corp
1326 - 510 Westhastings
Vancouver B.C.

Dec 1/79	DIF - Road	9	5		
Dec 16/79	branching	2 1/2	7 1/2		
18		2			
				25/2	
				@ \$ 50.75/hr	
					1,294.-
					(46)



CANADIAN IMPERIAL
BANK OF COMMERCE
HASTINGS AND GRANVILLE
VANCOUVER, B.C.

Feb 4 1980

PAY TO THE
ORDER OF

Wadlegger Logging & Construction Ltd \$ 1294.00

one thousand two hundred ninety four ⁰⁰/₁₀₀ DOLLARS

DIMAC RESOURCE CORP.

NO. 46

P. Dickinson

⑈074⑈ ⑆00010⑆010⑆ 31⑆15216⑈

SITE PREPARATION

CLEARWATER TIMBER PRODUCTS LTD.

DATE JAN 21, 1980

JOB No. DIMAR RESOURCES CORP.
 DELIVER AND CHARGE TO 1326-510 WEST HASTINGS, VANC.

Quant.	Description	@	Price
	TO INVOICE YOU FOR RADIO RENTAL FOR YOUR EXPLORATION CREW IN THE CLEARWATER, B.C. AREA: -		
	DEC. 1/79 - JAN 16/80 INCLUSIVE: -		
	2 - PORTABLE RADIOS @ \$45.00 EA.		
	FOR 1-1/2 MONTH.		135.00
		PST @ 4%	5.40
	(NOTE - NO FURTHER STATEMENTS TO BE ISSUED)		Total Charge <u>\$140.40</u>

RECEIVED
By.....

Times Printing, Clearwater.

RADIO RENTAL

(52)

(53)

COMMUNICATION



INVOICE

CHEMEX LABS LTD.

212 BROOKSBANK AVE.
NORTH VANCOUVER, B.C.
CANADA V7J 2C1
TELEPHONE: 985-0649 984-0221
AREA CODE: 604
TELEX: 043-52597

• ANALYTICAL CHEMISTS • GEOCHEMISTS • REGISTERED ASSAYERS

TO: Dimac Resource Corp.,
1326 - 510 W. Hastings St.,
Vancouver, B.C.
V6B 1L8
ATTN: R. A. Dickinson

CERTIFICATE NO. 67080
INVOICE NO. 34154
DATE Dec. 5/79

Table with 4 columns: Item No., Description, Sub-Total, Total. Row 1: 15, Assayed for W03 @ \$9.00, \$135.00, \$135.00

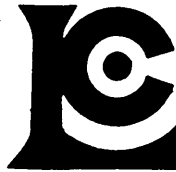

INVOICE

CHEMEX LABS LTD.

212 BROOKSBANK AVE.
NORTH VANCOUVER, B.C.
CANADA V7J 2C1
TELEPHONE: 985-0649 984-0221
AREA CODE: 604
TELEX: 043-52597

• ANALYTICAL CHEMISTS • GEOCHEMISTS • REGISTERED ASSAYERS

TO: Dimac Resources
1326 - 510 W. Hastings St.
Vancouver, B.C.
ATTN:

CERTIFICATE NO. 67154
INVOICE NO. 34276
DATE Dec. 14/79

Table with 4 columns: Item No., Description, Sub-Total, Total. Row 1: 6, Assayed for W03 @ \$9.00, \$54.00, \$54.00

ASSAYING.



INVOICE

CHEMEX LABS LTD.

212 BROOKSBANK AVE.
NORTH VANCOUVER, B.C.
CANADA V7J 2C1
TELEPHONE: 885-0648 984-0221
AREA CODE: 604
TELEX: 043-52597

• ANALYTICAL CHEMISTS ••GEOCHEMISTS ••REGISTERED ASSAYERS

TO: Dimac Resources
1326 - 510 W. Hastings .,
Vancouver, B.C.
V6B 1L8
ATTN:

CERTIFICATE NO. 67194
INVOICE NO. 34482
DATE Jan. 8/80

Table with 4 columns: Item No., Description, Sub-Total, Total. Row 7: Assayed for WO3 @ \$ 9.00, \$63.00, \$63.00.

TERMS-NET 30 DAYS
1% Per Month (18% Per Annum) Charged on Overdue Accounts

78-040



CHEMEX LABS LTD.

TELEPHONE: 885-0648 984-0221
AREA CODE: 604
TELEX: 043-52597

• ANALYTICAL CHEMISTS • GEOCHEMISTS • REGISTERED ASSAYERS

TO: Dimac Resources
1326 - 510 W. Hastings St.
Vancouver, B.C.
V6B 1L8
ATTN: Robert A. Dickinson

CERTIFICATE NO. 67120
INVOICE NO. 34268
DATE Dec. 13/79

Table with 4 columns: Item No., Description, Sub-Total, Total. Row 11: Assayed for WO3 @ \$9.00, \$99.00, \$99.00.



INVOICE

CHEMEX LABS LTD.

212 BROOKSBANK AVE.
NORTH VANCOUVER, B.C.
CANADA V7J 2C1
TELEPHONE: 985-0648
AREA CODE: 604
TELEX: 043-52597

• ANALYTICAL CHEMISTS • GEOCHEMISTS • REGISTERED ASSAYERS

TO: **Dimac Resources**
1326 - 510 W. Hastings.,
Vancouver, B.C.
V6B 1L8

ATTN:

CERTIFICATE NO. **67281**
INVOICE NO. **34581**
DATE **Jan. 16/80**

	DESCRIPTION	SUB-TOTAL	TOTAL
25	Assayed for WO_3 @ \$9.00	\$225.00	\$225.00

TERMS-NET 30 DAYS

78-040

1½% Per Month (18% Per Annum) Charged on Overdue Accounts

TO: **Dimac Resources**
1326 - 510 W. Hastings St.
Vancouver, B.C.
V6B 1L8

ATTN:

CERTIFICATE NO. **67207**
INVOICE NO. **34508**
DATE **Jan. 9, 1980**

	DESCRIPTION	SUB-TOTAL	TOTAL
32	Assayed for WO_3 @ \$9.00	\$288.00	\$288.00



INVOICE

CHEMEX LABS LTD.

212 BROOKSBANK AVE.
NORTH VANCOUVER, B.C.
-CANADA V7J 2C1
TELEPHONE: 9 984-0221
AREA CODE: 604
TELEX: 043-52597

••ANALYTICAL CHEMISTS ••GEOCHEMISTS ••REGISTERED ASSAYERS

TO: **Dimac Resources**
1326 - 510 W. Hastings.,
Vancouver, B.C.
V6B 1L8

CERTIFICATE NO. **67323**
INVOICE NO. **34678**
DATE **Jan. 29/80**

ATTN:

	DESCRIPTION	SUB-TOTAL	TOTAL
35	Assayed for WO ₃ @ \$9.00	\$315.00	\$315.00

TERMS-NET 30 DAYS

78-040

1½% Per Month (18% Per Annum) Charged on Overdue Accounts



CANADIAN IMPERIAL
BANK OF COMMERCE
HASTINGS AND GRANVILLE
VANCOUVER, B.C.

DEC 27 1979

PAY TO THE
ORDER OF

CHEMEX LABS LTD | \$ 288.00

— two hundred eighty eight — DOLLARS

INV NO 34276, 34154, 34268

DIMAC RESOURCE CORP.

NO. 32

R. Dickerson

⑈074⑈ ⑆00010⑈010⑆ 31⑈15216⑈

⑈0000028800⑈



Feb 4 1930

CANADIAN IMPERIAL
BANK OF COMMERCE

HASTINGS AND GRANVILLE
VANCOUVER, B.C.

PAY TO THE
ORDER OF

Chemex Labs Ltd

\$ 891.00

eight hundred ninety one

xx DOLLARS

DIMAC RESOURCE CORP.

NO.

49

Rt Dickinson

⑈074⑈ ⑆00010⑈010⑆ 31⑈15216⑈

QUALIFICATION AND CERTIFICATION

I, Robert A. Dickinson, with permanent address at 1395 Ottawa Avenue, West Vancouver, B.C. declare:

1. That I graduated from the University of British Columbia with a B.Sc. degree in honours geology in 1972 and a M.Sc. degree in Business Administration in 1974.
2. That since graduation I have been employed as an exploration geologist in British Columbia, Saskatchewan, Territories, and Washington, U.S.A.
3. That I am president and exploration geologist of Dimac Resource Corp. Ltd. whose office is located at 1326 - 510 West Hastings Street, Vancouver, B.C. V6B 1L8
4. That I have an interest in the Gotcha Property.
5. That the data of this report is based on data collected by me on the property and by presentations of contractors to me during the period November 5, 1979 to January 17, 1980.
6. That to the best of my knowledge and belief the Expenditure Statement is correct.

VANCOUVER, B.C.
February 1, 1980

R.A. DICKINSON, President
DIMAC RESOURCES CORP.

MAP 1

DIAMOND DRILL HOLE LOCATIONS

DIMAC RESOURCE CORP

1" = 10'

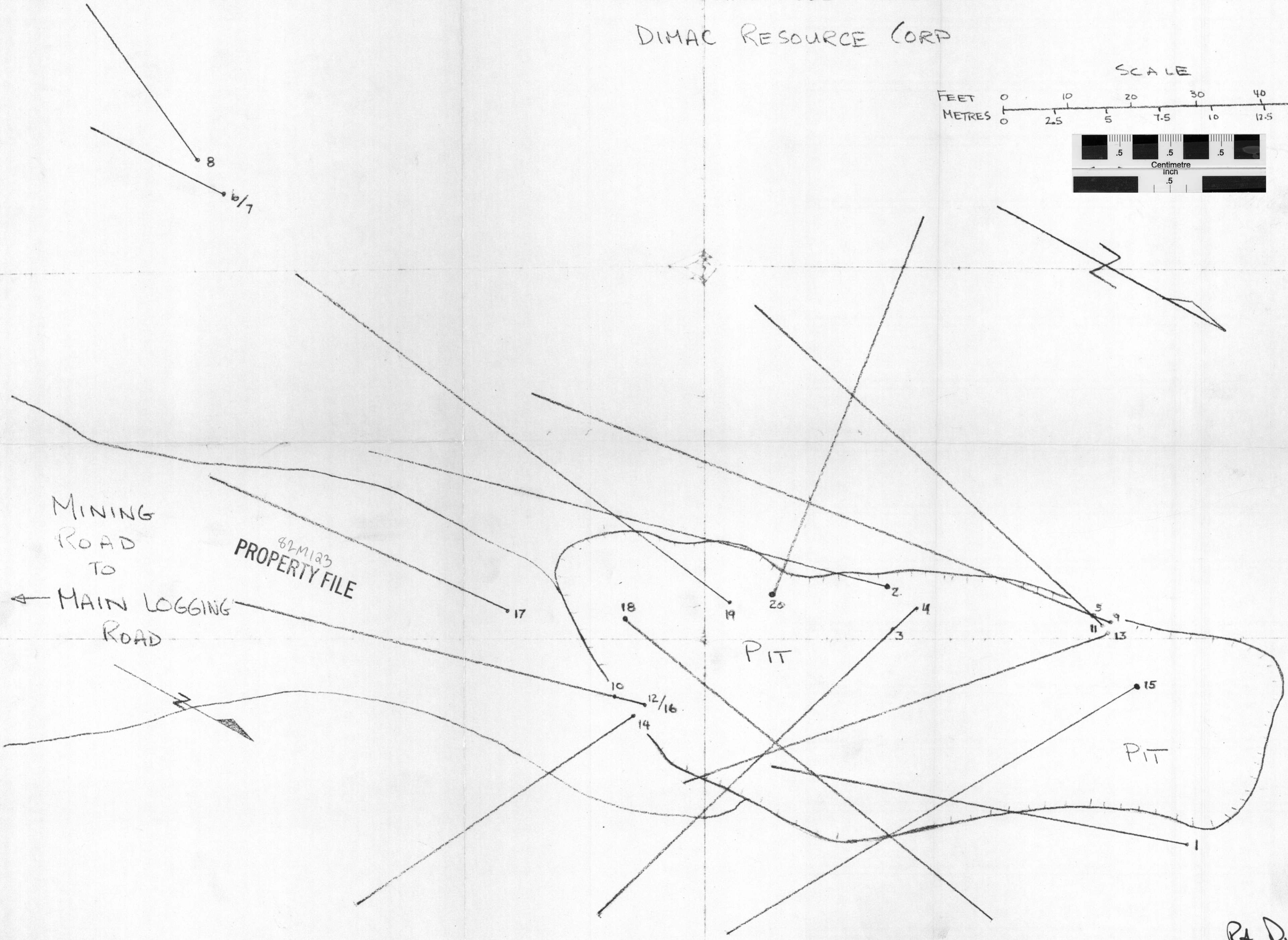
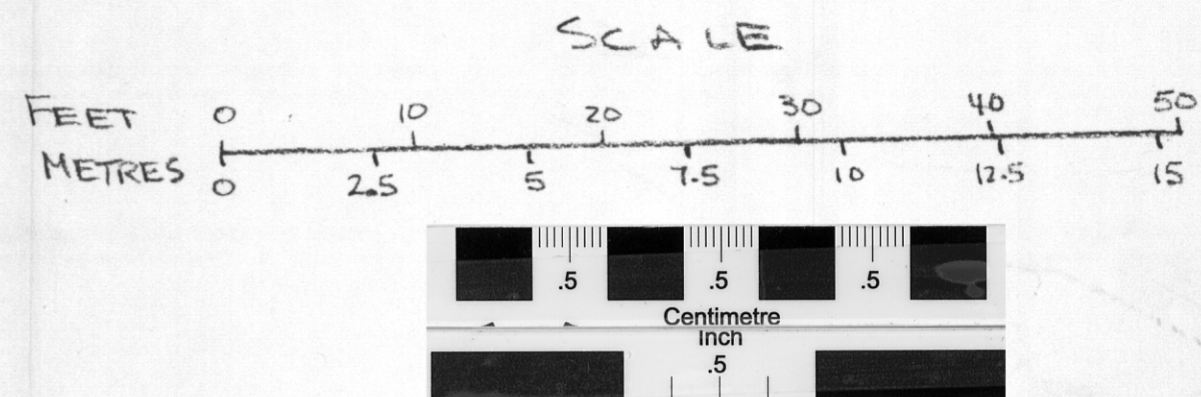

Rt Dickson
Feb 12/80

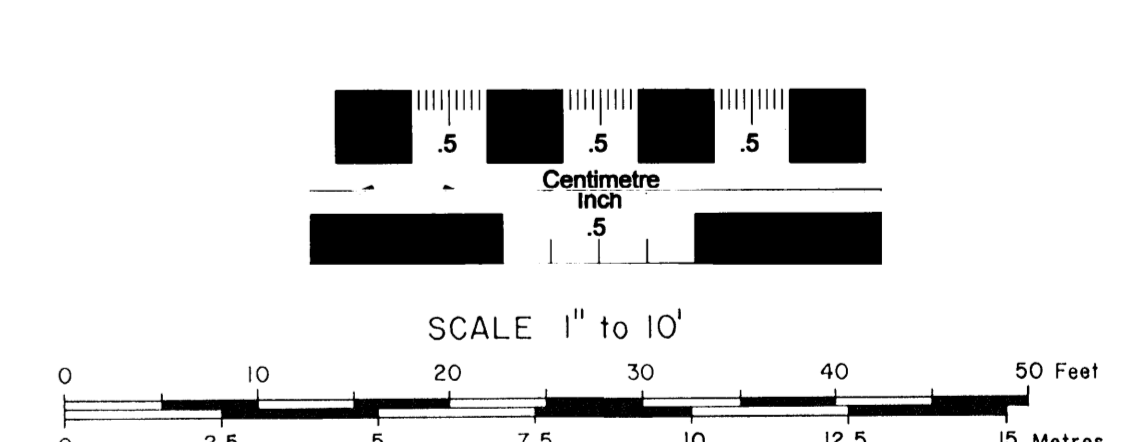
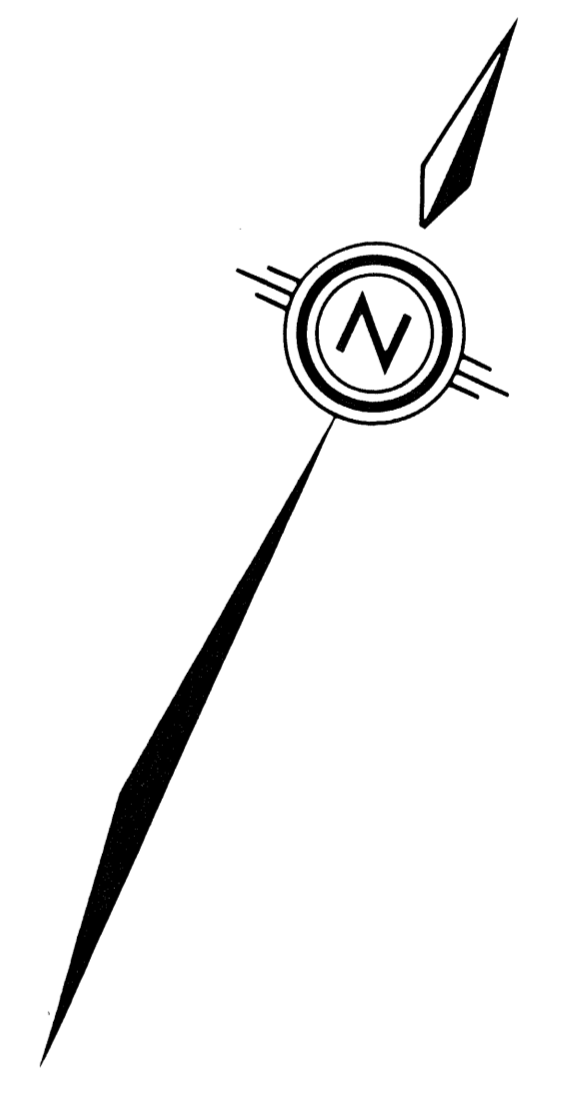


- LEGEND**
- PHYSIOGRAPHY**
- Road
 - Pit
 - Contour in feet, interval 10 ft
- STRUCTURAL INFORMATION**
- Layering or foliation
 - Fracture zone or alteration zone or fault
 - Drenulation lineation
 - Lithologic contacts estimated projected
- DRILL INFORMATION AND SAMPLE LINES**
- P1-2 Proposed percussion point for drill hole 1 to base skarn 2
 - Chip sample line
 - △ PDH Percussion drill hole
 - △ DDH Diamond drill hole
 - ⊙ Proposed drill site
- SURVEY INFORMATION**
- 23 Survey station with spot elevation
- NOTE:** Elevation of station 1 arbitrarily set to 5732 feet back sighted survey loop. Closure errors indicated at station 4 on map.
- ROCK TYPES**
- PROPERTY FILE**
- SKARN VARIETIES:**
- c - coarse grained, m - medium to fine grained, b - banded,
 - G - Garnet, W - Wollastonite, Q - Quartz, T - Talcose,
 - D - Diopside, O - Quartz, So - Gosan
 - C.S. - uninterfered Calc Silicate
- Reference number for Skarn bands 1 to 5
- B1**
- Alaskite
 - Blakite Quartz Monzonite
 - Blakite Schist
 - Blakite Quartzite
 - Pegmatite or Pegmatite + Schist (P/S)

MAP 2
By DR. BARRY RYAN
1979.